

- > Port size: 1/4" or 3/8" (ISO G/PTF)
- > Excelon design allows in-line installation or modular installation with other Excelon products
- > High efficiency oil and particle removal
- > Quick release bayonet bowl
- > Service indicator standard



**Technical features**

**Medium:**  
Compressed air only

**Maximum operating pressure:**  
Transparent bowl:  
10 bar (145 psi)  
Metal bowl:  
17 bar (250 psi)  
Metal and transparent bowl with automatic drain:  
8 bar (116 psi)

**Remaining oil content:**  
0,01 mg/m<sup>3</sup> at +21°C (+69°F)

**Particle removal:**  
To 0,01 µm

**Port size:**  
G1/4, G3/8, 1/4" or 3/8" PTF

**Flow:**  
4,5 dm<sup>3</sup>/s at port size: G1/4

Operating pressure: 6,3 bar (91 psi)

**Drain:**  
Manual, automatic or semi automatic

**Automatic drain operating conditions (float operated):**  
Bowl pressure required to close drain: > 0,35 bar (5 psi)  
Bowl pressure required to open drain: ≤ 0,2 bar (2.9 psi)  
Minimum air flow required to close drain: 0,1 dm<sup>3</sup>/s (0.2 scfm)  
Manual operation: depress pin inside drain outlet to drain bowl

**Semi automatic drain operating conditions (pressure operated):**  
Bowl pressure required to close drain: Greater than 0,1 bar (1.5 psig)

Bowl pressure required to open drain: Less than 0,1 bar (1.5 psig)  
Minimum air flow required to close drain: 0,5 dm<sup>3</sup>/s (1 scfm)

**Ambient/Media temperature:**  
Transparent bowl:  
-34 ... +50°C (-29 ... +122°F)  
Metal bowl:  
-34 ... +65°C (-29 ... +149°F)  
Air supply must be dry enough to avoid ice formation at temperatures below +2°C (+35°F).

**Materials:**  
Body: Zinc  
Transparent bowl: PC  
Metal bowl: Zinc  
Liquid level indicator lens (metal bowl): Transparent nylon  
Element: Synthetic fibre & PU foam  
Elastomers: CR & NBR  
Service life indicator: Transparent PA body, Acetal internal parts, stainless steel spring, NBR elastomers

Note:  
Install an F72G filter with a 5 µm filter element upstream of the F72C filter for maximum service life.

**Technical data - standard models**

Symbol	Port size	Size	Drain	Bowl	Weight (kg)	Weight (lbs)	Model
	G1/4	Basic	Manual	PC (transparent)	0,40		F72C-2GD-QT0
	G3/8	—	Manual	PC (transparent)	0,40		F72C-3GD-QT0
	G1/4	Basic	Automatic	PC (transparent)	0,40		F72C-2GD-AL0
	G3/8	—	Automatic	PC (transparent)	0,40		F72C-3GD-AL0

**Option selector**

Port size	Substitute
1/4"	2
3/8"	3
Thread form	Substitute
PTF	A
ISO G parallel (standard)	G
Service life indicator	Substitute
With (visual, standard)	D
With (electrical)	E
Without	N
Drain	Substitute
Manual	Q
Semi automatic	S
Automatic*1)	A *1)

F72C-★ ★ ★ ★ ★ 0

Bowl *1)	Substitute
Metal (long) with liquid level indicator	E
Transparent	T
Transparent (long)	L
Transparent with guard	W
Metal with liquid level indicator	D

\*1) Supplied with long bowl option only

**Typical performance characteristics**

Inlet pressure (bar)	Maximum flow dm <sup>3</sup> /s*
1	1,8
3	3,1
5	4
6,3	4,5
7	4,7
9	5,4

\* Maximum flow to maintain stated oil removal performance

**Flow characteristics**

Port size: 1/4", dry element

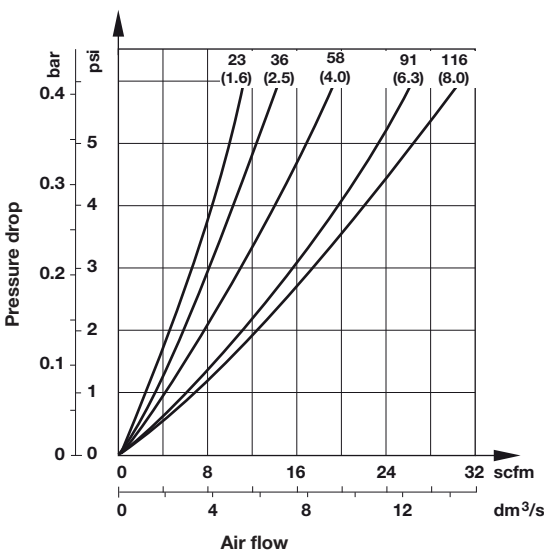

Port size: 1/4", saturated element

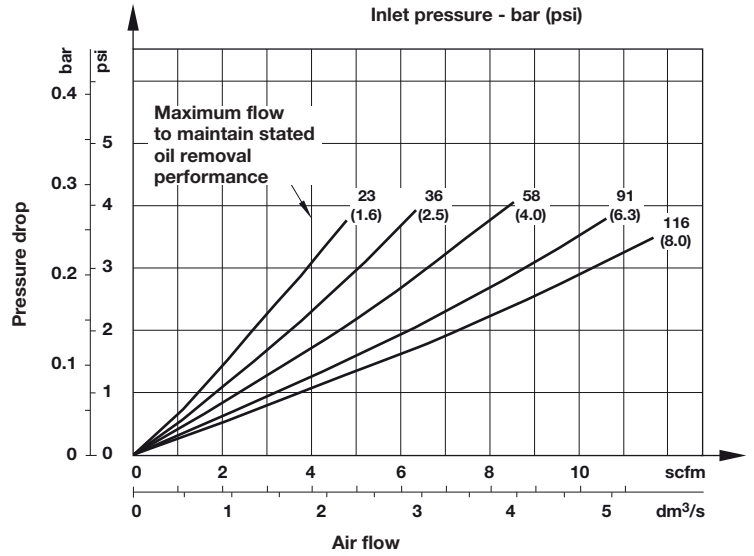

**Accessories**

Wall mounting bracket	Quikclamp®	Quikclamp with wall bracket®	Quikmount pipe adaptor *1)	Porting block with three alternative 1/4" ports	2/2 Shut-off valves (for full technical specification see datasheet 8.160.600)	3/2 Shut-off valves (for full technical specification see datasheet 8.160.600)
Page 3	Page 3	Page 3	Page 3	Page 3	Page 3	Page 3
4224-50	4214-51	4214-52	G1/4: 4215-08 G3/8: 4215-09 1/4 PTF: 4215-02 3/8 PTF: 4215-03	G1/4: 4216-52 1/4 PTF: 4216-50	G1/4: T72B-2GA-P1N G3/8: T72B-3GA-P1N 1/4 PTF: T72B-2AA-P1N 3/8 PTF: T72B-3AA-P1N	G1/4: T72T-2GA-P1N G3/8: T72T-3GA-P1N 1/4 PTF: T72T-2AA-P1N 3/8 PTF: T72T-3AA-P1N

\*1) Please use a Quikmount pipe adaptor if the Quikclamp be mounted at inlet or outlet side.

**Pressure switch**



**Padlock**



**Padlock (brass) with two keys \*1)**

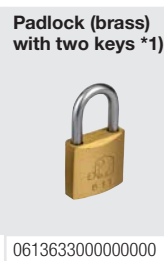

\*1) for shut-off valves

**Service kits**



**Replacement element**



**Drawings**

Dimensions in mm  
Projection/First angle

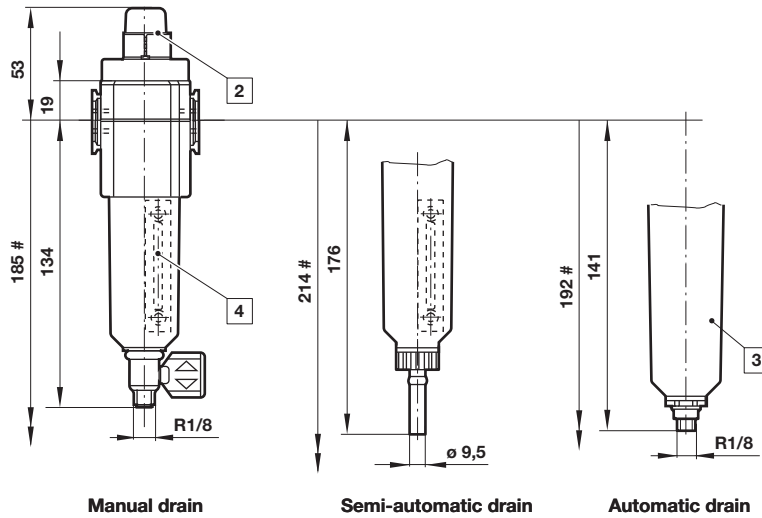

**Manual drain**

**Semi-automatic drain**

**Automatic drain**

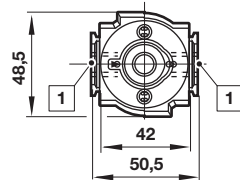

# Minimum clearance required to remove bowl

- 1 Main ports 1/4" or 3/8"
- 2 Service life indicator
- 3 Transparent bowl
- 4 Metal bowl with liquid level indicator lens

**Accessories**  
**Quikclamp®**

**Quikclamp® with wall bracket**

**Porting block**

**Pipe adapter**

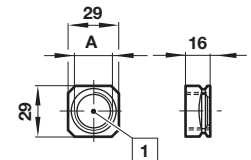
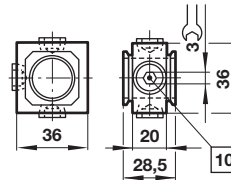
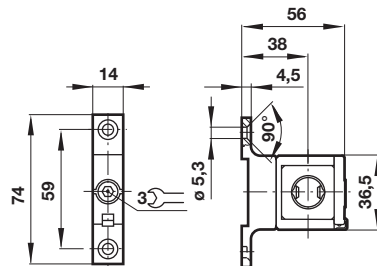
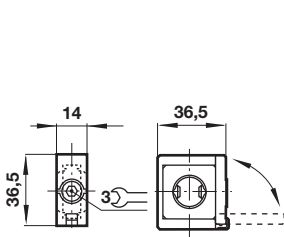

10 Ports (G1/4 or 1/4 NPT) plugged

- 1 Main ports 1/4" or 3/8" ISO G/PTF

**Wall mounting bracket**

**Shut-off valves**

**Porting block for pressure switch**

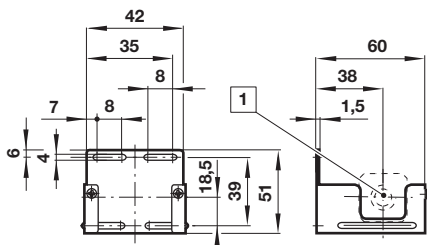

- 1 Main ports

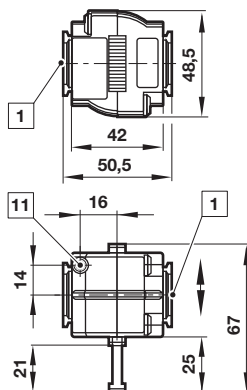

- 1 Main ports 1/4" or 3/8" ISO G/PTF
- 11 Exhaust port M5 at 3/2 valve only

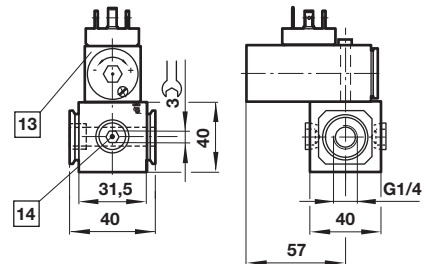

- 13 Pressure switch is not in scope of delivery
- 14 Alternative G1/4 ports plugged

## Warning

These products are intended for use in industrial compressed air systems only. Do not use these products where pressures and temperatures can exceed those listed under

»**Technical features/data**«.

Before using these products with fluids other than those specified, for non-industrial applications, life-support systems or other applications not within published specifications, consult

IMI Precision Engineering, Norgren Inc.

Through misuse, age, or malfunction, components used in fluid power systems can fail in various modes.

The system designer is warned to consider the failure modes of all component parts used in fluid power systems and to provide adequate safeguards to prevent personal injury or damage to equipment in the event of such failure.

System designers must provide a warning to end users in the system instructional manual if protection against a failure mode cannot be adequately provided.

System designers and end users are cautioned to review specific warnings found in instruction sheets packed and shipped with these products.