

FIRST CIRCUIT MARK  
(NOT SHOWING ON 2  
AND 3 CIRCUITS SERIES)

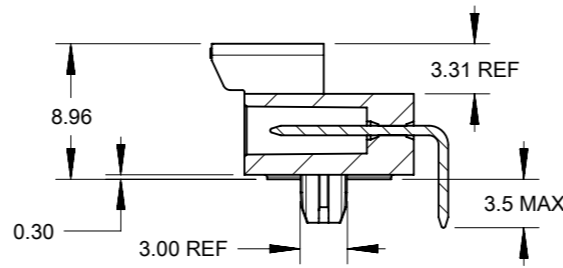

SECTION Y-Y

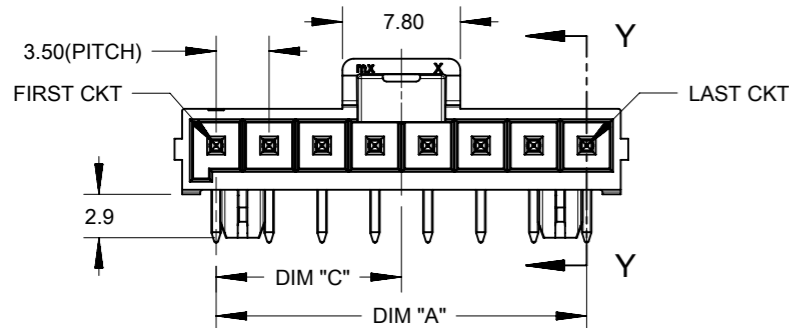
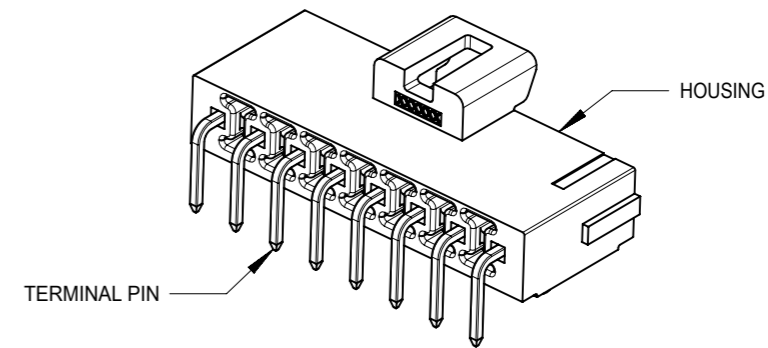
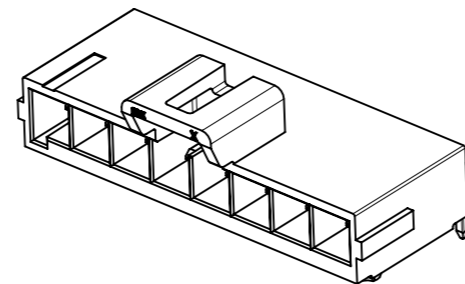
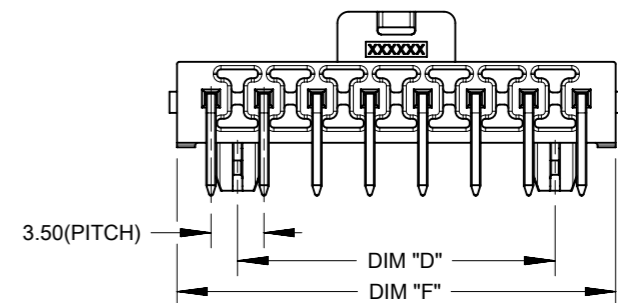

NOTES:

1. MATERIAL :  
HOUSING  
OPTION 1: LCP BLACK, UL94 V-0  
OPTION 2: LCP NATURAL, UL94 V-0  
TERMINAL: COPPER ALLOY
2. PLATING FINISH:  
OPTION 1 - 1.5µm(60µin)-2.5µm(100µin) TIN OVER  
1.25µm(50µin)-2.5µm(100µin) NICKEL OVERALL  
OPTION 2 - 0.35µm(15µin) GOLD CONTACT AREA,  
1.5µm(60µin)-2.5µm(100µin) TIN TAIL AREA OVER  
1.25µm(50µin)-2.5µm(100µin) NICKEL OVERALL  
OPTION 3 - 0.70µm(30µin) GOLD CONTACT AREA,  
1.5µm(60µin)-2.5µm(100µin) TIN TAIL AREA OVER  
1.25µm(50µin)-2.5µm(100µin) NICKEL OVERALL
2. PARTS TO BE PACKAGED PER PK-172310-9001
3. PRODUCT SPECIFICATION PS-172323-0001
4. PART MATES WITH MOLEX RECEPTACLE HOUSING  
172256 AND 172260
5. PART CONFORMS TO CLASS "C" REQUIREMENTS OF SPECIFICATION  
PS-45499-002 WITH 0.13 MM MAXIMUM FLASH ALLOWED IN CORE  
HOLES AND FRONT SURFACE.
6. DISCOLORATION IN THE BANDOLIER AREA OF THE PIN IS  
INHERENT TO THE PLATING PROCESS AND IS DUE TO THE MASKING  
EFFECT OF THE CARRIER. THIS DISCOLORATION IS IN A NON-FUNCTIONAL  
AREA OF THE PIN AND WILL NOT AFFECT THE PERFORMANCE OF THE  
HEADER ASSEMBLY.
7. ASSEMBLY SPECIFICATION: AS-172323-0001

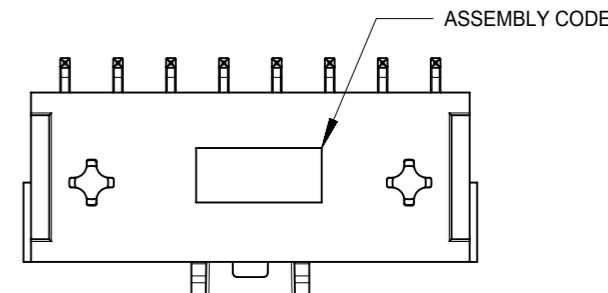
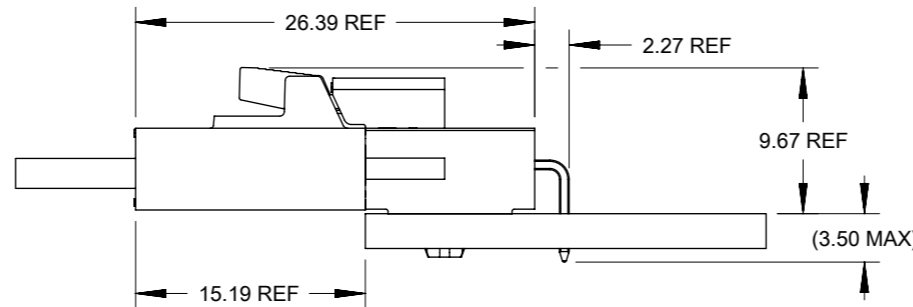

FUNCTIONAL SYMBOLS	THIS DRAWING CONTAINS INFORMATION THAT IS PROPRIETARY TO MOLEX ELECTRONIC TECHNOLOGIES, LLC AND SHOULD NOT BE USED WITHOUT WRITTEN PERMISSION			
	DIMENSION UNITS	SCALE		
$\nabla_A = 0$	mm			
$\nabla_F = 0$	GENERAL TOLERANCES (UNLESS SPECIFIED)			
$\nabla_E = 0$	ANGULAR TOL ± °			
DIVISIONAL SYMBOLS	4 PLACES ±	EC NO: 704776	2022/04/05	
	3 PLACES ±	DRWN: SUGEEB	2022/05/24	
	2 PLACES ± 0.25	CHK'D: GGA	2022/05/24	
	1 PLACE ± 0.5	APPR: GGA		
	0 PLACES ±	INITIAL REVISION:		
DRAFT WHERE APPLICABLE MUST REMAIN WITHIN DIMENSIONS		DRWN: DROSCA	2014/03/05	
THIRD ANGLE PROJECTION		APPR: JCOMERCI	2014/04/24	
DRAWING		SERIES	DOCUMENT NUMBER	
A3-SIZE		172310	SD-172310-1000	
MATERIAL NUMBER		CUSTOMER	DOC TYPE   DOC PART   REVISION	
		GENERAL MARKET	PSD   000   C4	
			SHEET NUMBER	
			1 OF 3	

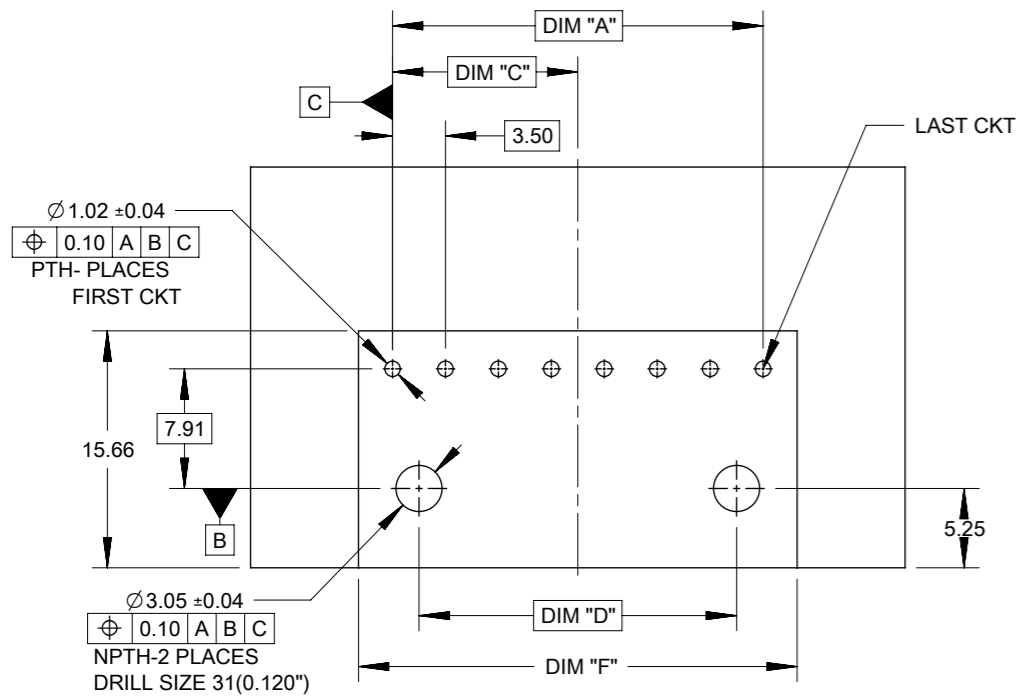

PCB LAYOUT 4,5,6,7 AND 8 COMPONENT SIDE  
RECOMENDED PCB THICKNESS 1.60MM-2.40MM

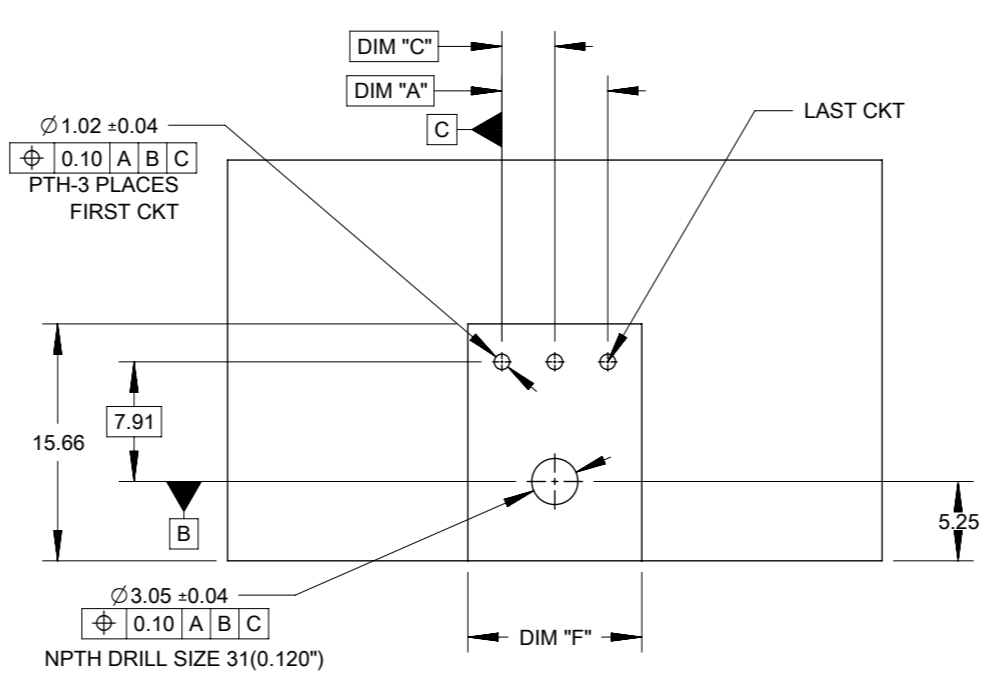

PCB LAYOUT 3 CIRCUIT COMPONENT SIDE  
RECOMENDED PCB THICKNESS 1.60MM-2.40MM

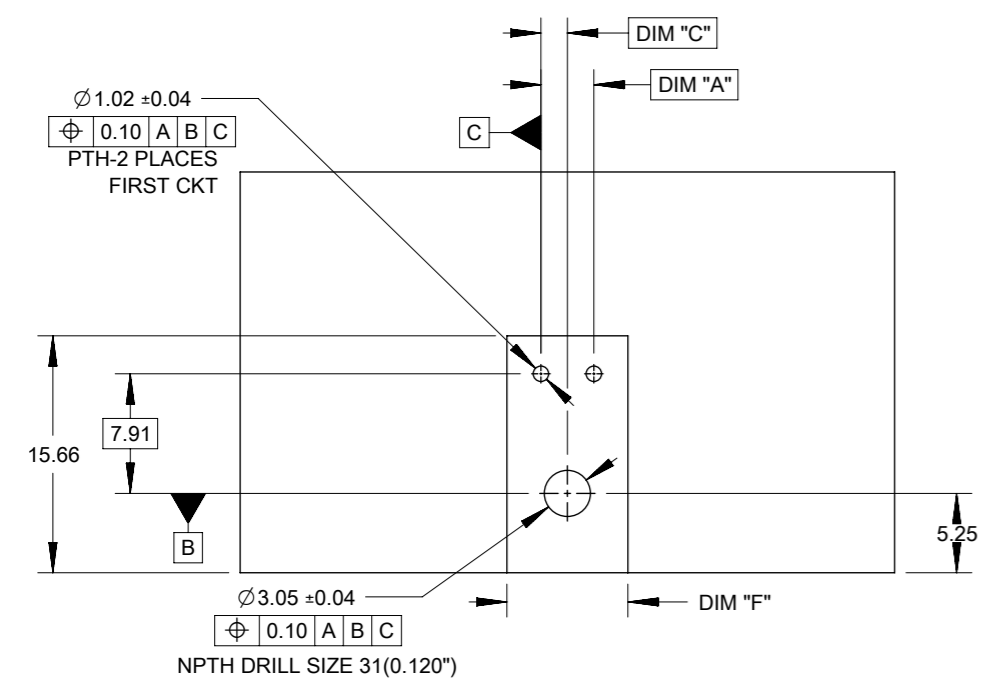

PCB LAYOUT 2 CIRCUIT COMPONENT SIDE  
RECOMENDED PCB THICKNESS 1.60MM-2.40MM

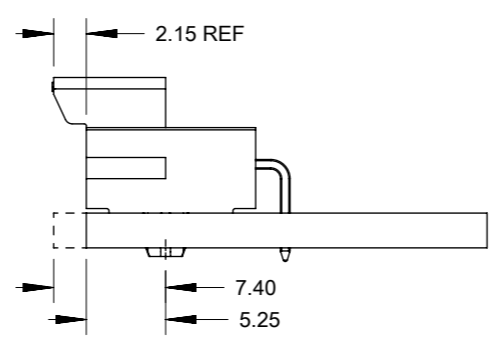

OPTION 1: LATCH FLUSH WITH PCB EDGE  
OPTION 2: HOUSING BODY FLUSH WITH PCB EDGE

NOTE: DATUM -A- IS ON PCB COMPONENT SIDE

TIN PLATING							
PART NO.	COLOR	CIRCUIT SIZE	KEY OPTION	DIM A	DIM F	DIM C	DIM D
172310-1102	BLACK	2	KEY A	3.50	8.00	1.75	0.00
172310-1103	BLACK	3	KEY A	7.00	11.50	3.50	0.00
172310-1104	BLACK	4	KEY A	10.50	15.00	5.25	7.00
172310-1105	BLACK	5	KEY A	14.00	18.50	7.00	10.50
172310-1106	BLACK	6	KEY A	17.50	22.00	8.75	14.00
172310-1107	BLACK	7	KEY A	21.00	25.50	10.50	17.50
172310-1108	BLACK	8	KEY A	24.50	29.00	12.25	21.00
172310-2105	NATURAL	5	KEY B	14.00	18.50	7.00	10.50

15 MICROINCH GOLD PLATING							
PART NO.	COLOR	CIRCUIT SIZE	KEY OPTION	DIM A	DIM F	DIM C	DIM D
172310-1202	BLACK	2	KEY A	3.50	8.00	1.75	0.00
172310-1203	BLACK	3	KEY A	7.00	11.50	3.50	0.00
172310-1204	BLACK	4	KEY A	10.50	15.00	5.25	7.00
172310-1205	BLACK	5	KEY A	14.00	18.50	7.00	10.50
172310-1206	BLACK	6	KEY A	17.50	22.00	8.75	14.00
172310-1207	BLACK	7	KEY A	21.00	25.50	10.50	17.50
172310-1208	BLACK	8	KEY A	24.50	29.00	12.25	21.00
172310-2204	NATURAL	4	KEY B	10.50	15.00	5.25	7.00
172310-2205	NATURAL	5	KEY B	14.00	18.50	7.00	10.50
172310-2207	NATURAL	7	KEY B	21.00	25.50	10.50	17.50

30 MICROINCH GOLD PLATING							
PART NO.	COLOR	CIRCUIT SIZE	KEY OPTION	DIM A	DIM F	DIM C	DIM D
172310-1302	BLACK	2	KEY A	3.50	8.00	1.75	0.00
172310-1303	BLACK	3	KEY A	7.00	11.50	3.50	0.00
172310-1304	BLACK	4	KEY A	10.50	15.00	5.25	7.00
172310-1305	BLACK	5	KEY A	14.00	18.50	7.00	10.50
172310-1306	BLACK	6	KEY A	17.50	22.00	8.75	14.00
172310-1307	BLACK	7	KEY A	21.00	25.50	10.50	17.50
172310-1308	BLACK	8	KEY A	24.50	29.00	12.25	21.00
172310-2304	NATURAL	4	KEY B	10.50	15.00	5.25	7.00

FUNCTIONAL SYMBOLS FA = 0 FE = 0 FP = 0	THIS DRAWING CONTAINS INFORMATION THAT IS PROPRIETARY TO MOLEX ELECTRONIC TECHNOLOGIES, LLC AND SHOULD NOT BE USED WITHOUT WRITTEN PERMISSION		CURRENT REV DESC: OBSOLETE PART NUMBER AS PER PCN#509988		<b>molex</b>				
	DIMENSION UNITS: mm		SCALE:						
	GENERAL TOLERANCES (UNLESS SPECIFIED)								
	ANGULAR TOL ± °								
DIVISIONAL SYMBOLS	4 PLACES ±	EC NO: 704776	2022/04/05		ULTRA-FIT R/A HEADER 2-8 CKTS SINGLE ROW				
	3 PLACES ±	DRWN: SUGEEB	2022/05/24						
	2 PLACES ± 0.25	CHK'D: GGA	2022/05/24						
	1 PLACE ± 0.5	APPR: GGA	2022/05/24						
0 PLACES ±	INITIAL REVISION:	2014/03/05		DOCUMENT NUMBER	DOC TYPE	DOC PART	REVISION		
DRAFT WHERE APPLICABLE MUST REMAIN WITHIN DIMENSIONS		DRWN: DROSCA	2014/04/24		SD-172310-1000		PSD	000	C4
THIRD ANGLE PROJECTION		DRAWING	SERIES	MATERIAL NUMBER	CUSTOMER	SHEET NUMBER			
A3-SIZE		172310	GENERAL MARKET	2 OF 3					

10

9

8

7

6

5

4

3

2

1

F

F

E

E

D

D

C

C

B

B

A

A

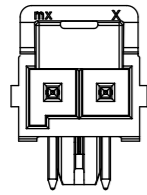

2 CKT

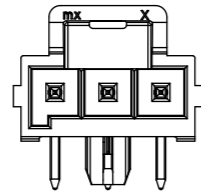

3 CKT

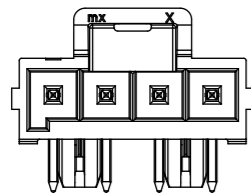

4 CKT

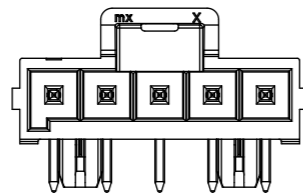

5 CKT

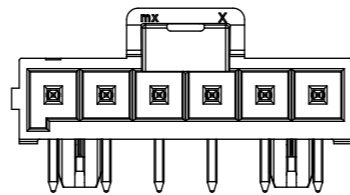

6 CKT

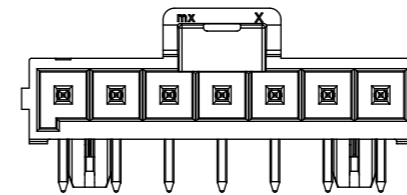

7 CKT

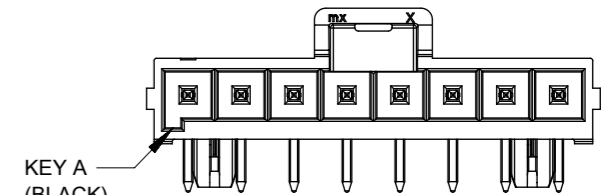

8 CKT

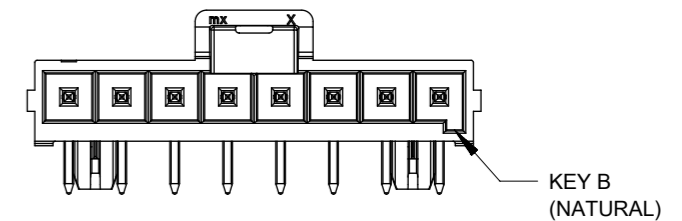

KEY B (NATURAL)

FUNCTIONAL SYMBOLS	THIS DRAWING CONTAINS INFORMATION THAT IS PROPRIETARY TO MOLEX ELECTRONIC TECHNOLOGIES, LLC AND SHOULD NOT BE USED WITHOUT WRITTEN PERMISSION										
	$\nabla_A = 0$ $\nabla_F = 0$ $\nabla_P = 0$	DIMENSION UNITS <b>mm</b>	SCALE	CURRENT REV DESC: OBSOLETE PART NUMBER AS PER PCN#509988							
GENERAL TOLERANCES (UNLESS SPECIFIED)		EC NO: 704776		DRWN: SUGEEB		2022/04/05		ULTRA-FIT R/A HEADER 2-8 CKTS SINGLE ROW			
ANGULAR TOL ± °		4 PLACES ±		CHK'D: GGA		2022/05/24				PRODUCT CUSTOMER DRAWING	
DIVISIONAL SYMBOLS		3 PLACES ±		APPR: GGA		2022/05/24		DOCUMENT NUMBER <b>SD-172310-1000</b>			
2 PLACES ± 0.25		1 PLACE ± 0.5		INITIAL REVISION:		2014/03/05				DOC TYPE	DOC PART
0 PLACES ±		DRAFT WHERE APPLICABLE MUST REMAIN WITHIN DIMENSIONS		THIRD ANGLE PROJECTION		DRAWING	SERIES	MATERIAL NUMBER	CUSTOMER	SHEET NUMBER	
					A3-SIZE	172310		GENERAL MARKET	3 OF 3		

DOCUMENT STATUS	P1	RELEASE DATE	2022/05/24	10:34:52
-----------------	----	--------------	------------	----------

9

8

7

6

5

4

3

2

1

FORMAT: master-b-prod-A3

REVISION: 11

DATE: 2021/05/01