

PART NUMBER

SHELL	A±0.38	B±0.12	C±0.10	D±0.25	E±0.07	200 Mating cycles	500 Mating cycles
09	30.81	24.99	16.96	16.21	10.96	D09S33E4GX00**	D09S33E6GX00**
15	39.14	33.32	25.18	24.54	19.18	D15S33E4GX00**	D15S33E6GX00**
25	53.03	47.04	39.12	38.25	33.12	D25S33E4GX00**	D25S33E6GX00**
37	69.32	63.50	55.68	54.71	49.68	D37S33E4GX00**	D37S33E6GX00**

LF FOR LEAD FREE

PC card drilling dimensions(after plating)  
(thickness 1.60±0.20mm)

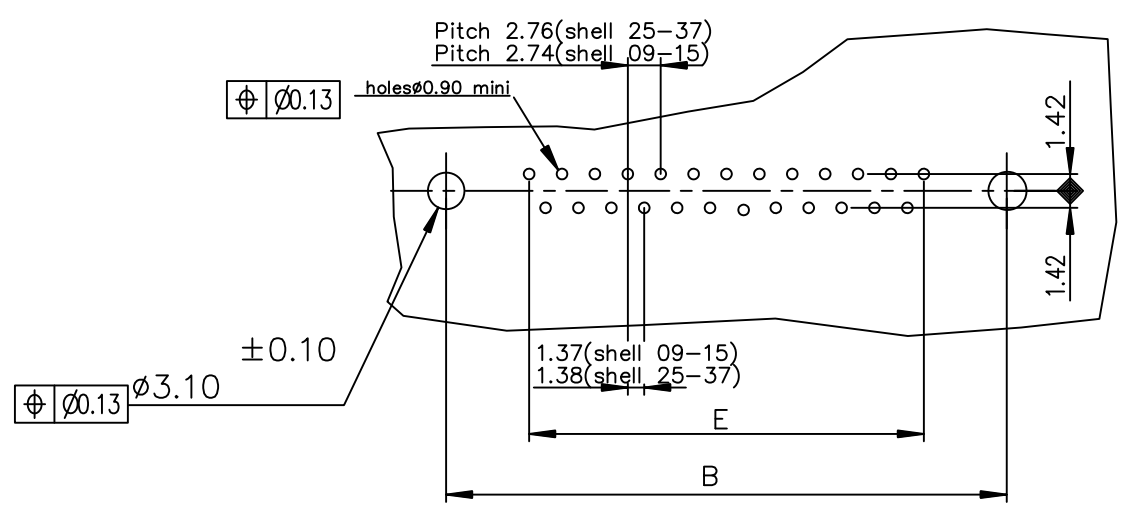

GENERAL CHARACTERISTICS : SEE DRAWING C01-8646-0000

mat'l. code				surface ISO 1302 ✓		tolerance ISO 406 ISO 1101		projection		product family D-SUB	
-								MM		title	
D ELX-I-19243 AB 2014-10-29				tolerances unless otherwise specified						SOCKET CONNECT. DELTA-D R/A WITH NUT, HARPOON & METAL PLATE	
				angles linear		.0±0.1		scale 2:1		dwg no	
				0°±2'		.00±0.1		FCI		sheet 1 of 1 size	
						.000±0.1				C01-8646-0823 A3	
				dr JOHN SLEEBA 1994-10-14						type Product Customer Drawing	
				enr ALIAS BABU 2014-10-29							
				chr MITHUN PAUL 2014-10-29							
				app BIJU K PAUL 2014-10-29							
sheet index		revision sheet		D 1							

# Mouser Electronics

Authorized Distributor

Click to View Pricing, Inventory, Delivery & Lifecycle Information:

[FCI / Amphenol:](#)

[D09S33E4GX00LF](#) [D09S33E6GX00LF](#) [D15S33E4GX00LF](#) [D15S33E6GX00LF](#) [D25S33E4GX00LF](#)  
[D25S33E6GX00LF](#) [D37S33E4GX00LF](#) [D37S33E6GX00LF](#)