

**Olympian Plus
Filter
G¹/₄ to G³/₄**

- Olympian Plus plug in design
- High efficiency water and particle removal
- Quick release bayonet bowl
- High visibility prismatic sight glass*
- Optional service indicator

* UK and other patents pending

Technical Data

Medium:

Compressed Air

Maximum pressure:

17 bar metal bowl

10 bar guarded transparent bowl

Operating Temperature:

-20°C* to +80°C metal bowl

-20°C* to +50°C guarded transparent bowl

* Consult our technical service for use below +2°C

Filter Element:

40 µm nominal standard

5 µm nominal optional

Maximum flow with 6,3 bar inlet pressure and pressure drop of 0,5 bar:

75 dm³/s

Materials:

Aluminium bowl standard, guarded polycarbonate bowl optional.

Zinc alloy body and yoke. Synthetic rubber elastomeric materials. Sintered plastic filter element. Grilamid prismatic sight glass lens standard. Pyrex sight glass optional for metal bowl.

Ordering Information

To order a standard Olympian Plus filter, quote model number from table overleaf.

For non-standard models substitute appropriate digits as instructed.

ISO Symbols



Automatic drain



Manual drain

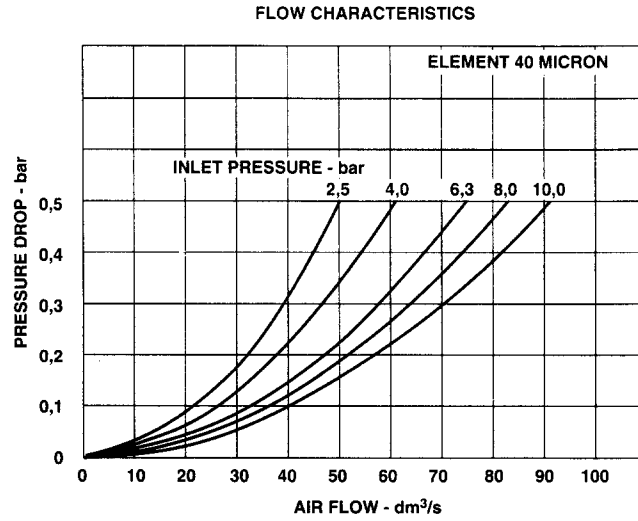

Typical Performance Characteristics



Ordering Information

Drain Type	Port Size	Model	Weight kg
Automatic	G $\frac{1}{4}$	F64G-2GN-AD3	1,42
	G $\frac{3}{8}$	F64G-3GN-AD3	1,40
	G $\frac{1}{2}$	F64G-4GN-AD3	1,37
	G $\frac{3}{4}$	F64G-6GN-AD3	1,73
Manual	G $\frac{1}{4}$	F64G-2GN-MD3	1,40
	G $\frac{3}{8}$	F64G-3GN-MD3	1,38
	G $\frac{1}{2}$	F64G-4GN-MD3	1,35
	G $\frac{3}{4}$	F64G-6GN-MD3	1,71

For replacement Filter (without yoke) substitute 'N' at the 5th and 6th digits eg: F64G-NNN-AD3.

Alternative Models

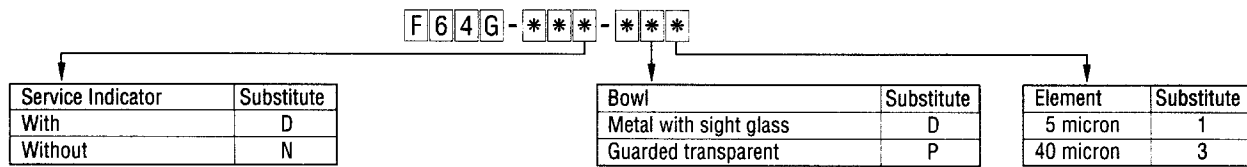

Please contact our technical service for details of non standard models including other thread forms and metal bowl with pyrex sight glass.

Accessories

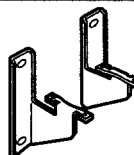
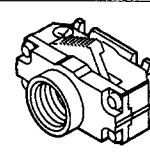
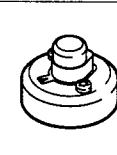
 Bracket Kit 74504-50	 3/2 Shut-off Valve* G $\frac{1}{4}$ T64T-2GB-P1N G $\frac{3}{8}$ T64T-3GB-P1N G $\frac{1}{2}$ T64T-4GB-P1N G $\frac{3}{4}$ T64T-6GB-P1N	 Service indicator Factory fit option only See alternative models table
--	--	---

* UK and other patents pending



Dimensions (mm)

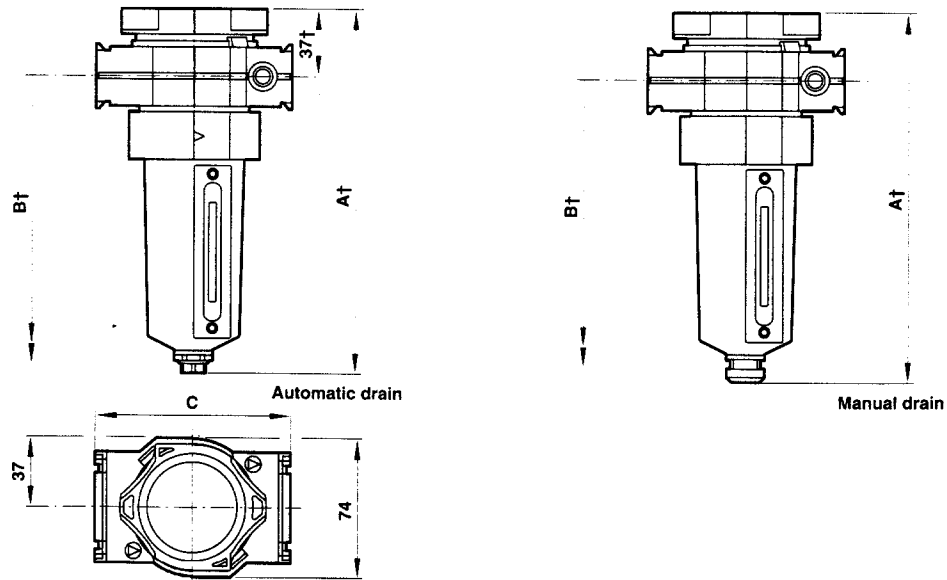

Dimension	Description	Drain	
		Automatic	Manual
A†	Maximum overall height	201	208
B†	Minimum clearance to remove unit	217	224
C	For port sizes G ¼, G ⅜, G ½, (G ¾)	105 (157)	105 (157)

† Add 23 mm for unit with service drop indicator.

Bracket Mounting

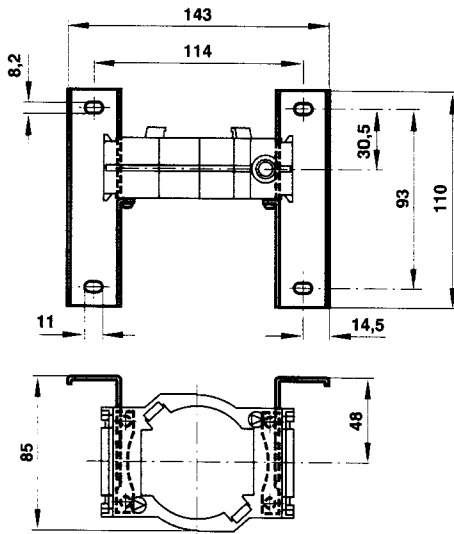

Bracket Kit Reference

Model	Part No.
All Models	74504-50

Service Kits

Item	Type	Part number
Service kit	All models	4380-200
Replacement elements	40 µm	4338-02
	5 µm	4338-01
Replacement sight glass	Prismatic (standard)	4380-040
	Pyrex	4380-041
Replacement drains	Automatic	3000-97
	Manual	684-84
Service Indicator		5797-50

Service kit includes port seals, louvre 'O' ring, bowl 'O' ring and drain gasket.



F64G

Warning

These products are intended for use in industrial compressed air systems only. Do not use these products where *pressures* and *temperatures* can exceed those listed under 'Technical Data'.

Before using these products with fluids other than those specified, for non-industrial applications, life-support systems, or other applications not within published specifications, consult NORGREN.

Through misuse, age, or malfunction, components used in fluid power systems can fail in various modes. The system designer is warned to consider the failure modes of all component parts used in fluid power systems and to provide adequate safeguards to prevent personal injury or damage to equipment in the event of such failure.

System designers must provide a warning to end users in the system instructional manual if protection against a failure mode cannot be adequately provided.

System designers and end users are cautioned to review specific warnings found in instruction sheets packed and shipped with these products.