



Crimp & Poke – D*U Series – Metal Shell

Features

Features

Offered in 9, 15, 25, 37, and 50 position plugs and sockets.

- Available with gold flash or 30 μ in. gold plating.
- Offered with .120 mounting holes, optional 4-40 clinch nuts.
- RoHS version available.
- Approvals:
 - UL Recognized – Files E170218 (UL1977) and E130965 (UL1863).
 - CSA Approved – File LR31996.

Materials

- Insulator Material: Glass-filled nylon (black), UL 94 V-O rated
- Connector Shell: Steel with zinc plating and yellow chromate finish, RoHS version zinc with clear chromate or tin plating (grounding indents on plug)
- 4-40 Clinch Nut: Steel with cadmium plating and yellow chromate finish
- Contact Material: Plug & Socket: Copper Alloy (machined).
- Contact Plating: Machined Plugs and Sockets: Gold flash or 30 μ in gold. All over nickel.

Mechanical

- Individual Contact Insertion and Separation Force (minimum/maximum): 0.7 oz./12 oz.
- Durability: 500 mating cycles

Electrical

- Withstanding Voltage: Minimum 1000V RMS @ sea level
- Current Rating: 5 Amps
- Contact Resistance: 2.7 milliohms maximum
- Insulation Resistance: 5000 megohms maximum (initial); 1000 megohms (minimum) after environmental testing

Environmental

- Operating Temperature: -65°C to + 125°C
- Shock: 50G peak per MIL-STD-202, Method 213, Condition G
- Vibration: 12 cycles in three perpendicular directions @ 10-2000Hz, per MIL-STD-202, Method 204, Condition D
- Moisture Resistance: 90-95% relative humidity @ 40°C for 96 hours per MIL-STD-202, Method 103

Additional Information

Machined contacts supplied loose with connector or can be ordered separately. Use with 20-24 AWG wire.

Materials

- Contact Material: copper alloy (machined). Socket – copper alloy (machined).
- Contact Plating:
 - Machined Plugs and Sockets: Gold flash or 30 μ in. gold. All over nickel.

Termination Tooling

- Contact Insertion/Extraction: #CIET-20-HDB.
- Loose Contact Crimp Tool:
 - Machined Contact – #M22520/2-01.
 -

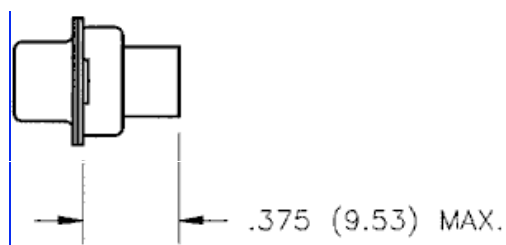

Part Numbers

Zinc-Plated Shell with Yellow Chromate Finish – Plugs

Position	Mounting Holes		4-40 Clinch Nuts	
	Contacts Included	Without Contacts	Contacts Included	Without Contacts
9	DEU-9P	DEU-9P-FO	DEUE-9-P	DEUE-9P-FO
15	DAU-15P	DAU-15P-FO	DAUE-15-P	DAUE-15-P-FO
25	DBU-25P	DBU-25P-FO	DBUE-25-P	DBUE-25P-FO
37	DCU-37P	DCU-37P-FO	DCUE-37-P	DCUE-37P-FO
50	DDU-50P	DDU-50P-FO	DDUE-50-P	DDUE-50P-FO

Tin-Plated Shell with Grounding Indents – Plugs

Position	Mounting Holes		4-40 Clinch Nuts	
	Contacts Included	Without Contacts	Contacts Included	Without Contacts
9	DEU-9PTI	DEU-9PTI-FO	DEUE-9PTI	DEUE-9PTI-FO
15	DAU-15PTI	DAU-15PTI-FO	DAUE-15PTI	DAUE-15PTI-FO
25	DBU-25PTI	DBU-25PTI-FO	DBUE-25PTI	DBUE-25PTI-FO
37	DCU-37PTI	DCU-37PTI-FO	DCUE-37PTI	DCUE-37PTI-FO
50	DDU-50PTI	DDU-50PTI-FO	DDUE-50PTI	DDUE-50PTI-FO

Zinc-Plated Shell with Yellow Chromate Finish – Sockets

Position	Mounting Holes		4-40 Clinch Nuts	
	Contacts Included	Without Contacts	Contacts Included	Without Contacts
9	DEU-9S	DEU-9S-FO	DEUE-9S	DEUE-9S-FO
15	DAU-15S	DAU-15S-FO	DAUE-15S	DAUE-15S-FO
25	DBU-25S	DBU-25S-FO	DBUE-25S	DBUE-25S-FO
37	DCU-37S	DCU-37S-FO	DCUE-37S	DCUE-37S-FO
50	DDU-50S	DDU-50S-FO	DDUE-50S	DDUE-50S-FO

Ordering Information

Tin-Plated Shell – Sockets

Position	Mounting Holes		4-40 Clinch Nuts	
	Contacts Included	Without Contacts	Contacts Included	Without Contacts
9	DEU-9ST	DEU-9ST-FO	DEUE-9ST	DEUE-9ST-FO
15	DAU-15ST	DAU-15ST-FO	DAUE-15ST	DAUE-15ST-FO
25	DBU-25ST	DBU-25ST-FO	DBUE-25ST	DBUE-25ST-FO
37	DCU-37ST	DCU-37ST-FO	DCUE-37ST	DCUE-37ST-FO
50	DDU-50ST	DDU-50ST-FO	DDUE-50ST	DDUE-50ST-FO

Ordering Information

Loose-Piece Machined Contacts

Pin	Gold Flash 030-1952-000	30 μ in. Gold 030-1952-030
Socket	030-1953-000	030-1953-030

RoHS Version – Zinc Plated Shell w/Clear Chromate Finish – Plug

Position	Drawings	Mounting Hole		4-40 Clinch Nuts	
		Contacts Included	Without Contacts	Contacts Included	w/o Contacts
9	9 pos. drawing	DEUH-9P	DEUH-9P-FO	DEUEH-9P	DEUEH-9P-FO
15	15 pos. drawing	DAUH-15P	DAUH-15P-FO	DAUEH-15P	DAUEH-15P-FO
25	25 pos. drawing	DBUH-25P	DBUH-25P-FO	DBUEH-25P	DBUEH-25P-FO
37	37 pos. drawing	DCUH-37P	DCUEH-37P-FO	DCUEH-37P	DCUEH-37P-FO
50	50 pos. drawing	DDUH-50P	DDUH-50P-FO	DDUEH-50P	DDUEH-50P-FO

RoHS Version – Zinc Plated Shell w/Clear Chromate Finish – Socket

Position	Drawings	Mounting Holes		4-40 Clinch Nuts	
		Contacts Included	Without Contacts	Contacts Included	w/o Contacts
9	9 pos. drawing	DEUH-9S	DEUH-9S-FO	DEUEH-9S	DEUEH-9S-FO
15	15 pos. drawing	DAUH-15S	DAUH-15S-FO	DAUEH-15S	DAUEH-15S-FO
25	25 pos. drawing	DBUH-25S	DBUH-25S-FO	DBUEH-25S	DBUEH-25S-FO
37	37 pos. drawing	DCUH-37S	DCUH-37S-FO	DCUEH-37S	DCUEH-37S-FO
50	50 pos. drawing	DDUH-50S	DDUH-50S-FO	DDUEH-50S	DDUEH-50S-FO