

# Series 80 Mighty Mouse Contacts and Tools

## Size #23 Removable Crimp Contacts



### Size #23 crimp contacts for AWG 22 to 30 gauge

Standard size #23 contacts accept #22 to #28 AWG wire. Choose "small bore" versions for #26 to #30 AWG wire. For thermocouple applications, specify alumel or chromel contacts. Contacts are bulk packaged. Terminate with standard M22520 crimper with special positioner.

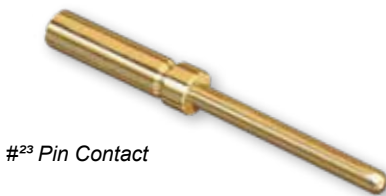

#23 Pin Contact



#23 Socket Contact

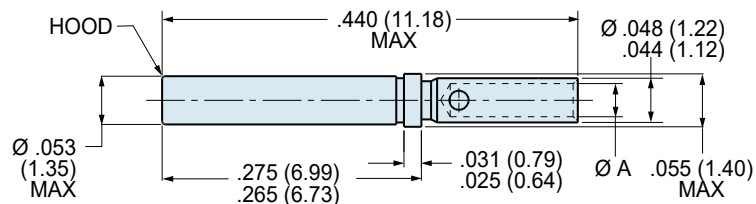
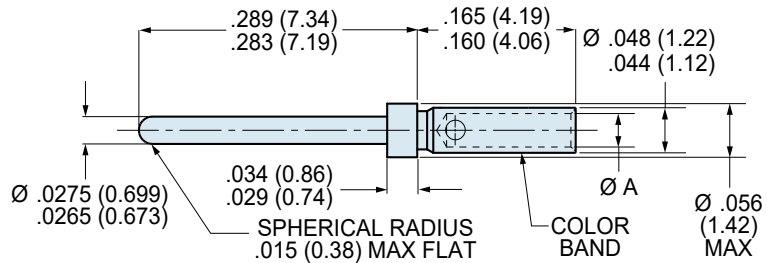

#### NOTES

##### Material and Finish

- Beryllium copper alloy per ASTM B196 or B197, 50 microinches gold plated per ASTM B 488 over nickel underplate. Crimp area may have less plating.
- Thermocouple contacts: alumel or chromel alloy, unplated, per ANSI 96.1
- Socket contact hood: stainless steel, passivated per AMS-QQ-P-35

##### Specifications

- Current Rating: 5 Amps maximum
- Voltage Drop (at 5 Amps and 25° C): 70 millivolts maximum
- Temperature Range: -65° to +175° C
- Socket Contact Minimum Separation Force: 0.5 ounces

##### Crimp Tools and Insertion/Removal Tools

- Crimper: 809-015
- Positioner: 809-005 (standard). Use P/N 809-057 for small bore contacts 809-042 and 809-043
- Standard Insertion/Removal Tool: 809-088

Size #23 Removable Crimp Contacts							
Contact Type	Wire Size	Material	Part Number	Ø A		Color Band	Tool Code
				In.	mm.		
Pin	#22 - #28	BeCu	809-001	.0335-.0355	0.851-0.902	None	A, C
Pin	#26 - #30	BeCu	809-042	.0229-.0245	0.582-0.622	Blue	A, D
Pin	#22 - #28	Alumel	809-065A	.0335-.0355	0.851-0.902	None	A, C
Pin	#22 - #28	Chromel	809-065C	.0335-.0355	0.851-0.902	None	A, C
Socket	#22 - #28	BeCu	809-002	.0335-.0355	0.851-0.902	None	A, C
Socket	#26 - #30	BeCu	809-043	.0229-.0245	0.582-0.622	Blue	A, D
Socket	#22 - #28	Alumel	809-066A	.0335-.0355	0.851-0.902	None	A, C
Socket	#22 - #28	Chromel	809-066C	.0335-.0355	0.851-0.902	None	A, C

Crimp Tensile Strength (Values are in pounds and are minimums.)					
Wire Gage	Silver or Tin Coated Copper Wire	Nickel Coated Copper Wire	Wire Gage	Silver or Tin Coated Copper Wire	Nickel Coated Copper Wire
#22	12	8	#28	3	2
#24	8	6	#30	1.5	1.5
#26	5	3			

Dimensions in Inches (millimeters) are subject to change without notice.