

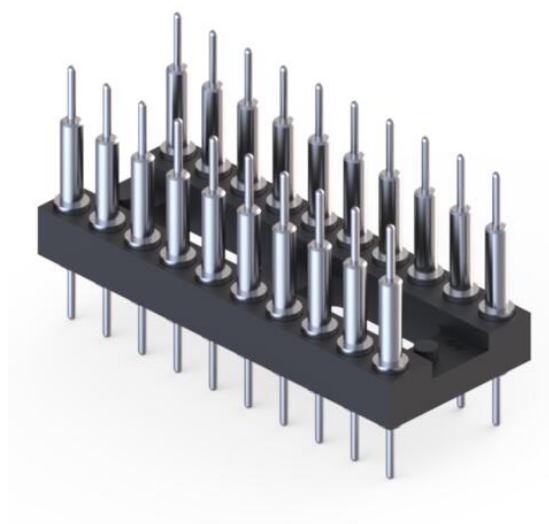

PRODUCT NUMBER: 142-90-320-00-592000

www.mill-max.com  
DATA SHEET

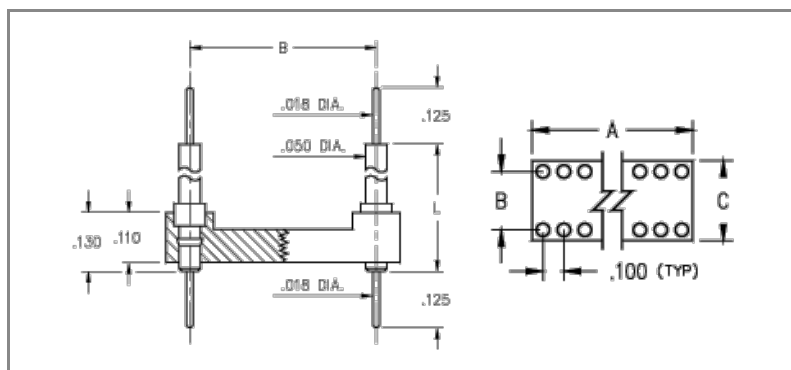

### 142-90-320-00-592000- SPECIFICATIONS

General Info	
<b>Description<sup>1</sup>:</b>	Board Stacking DIP Header .018" (0,457mm) Pin Head
<b>Type:</b>	DIP
<b>Category:</b>	Dual In Line Header
<b>Mounting Style:</b>	Through Hole Solder Mount
<b># Pins:</b>	20
<b>Packaging:</b>	Packaged in Tubes
<b>Qty Tube:</b>	40
<b>RoHS:</b>	No
<b>Product Lifecycle:</b>	Active

Materials	
<b>Shell Plating:</b>	200 μ" Tin/Lead(93/7) over 100 μ" Nickel
<b>Inner Plating:</b>	
<b>Loose Pin/Receptacle Used:</b>	4259 (Brass Alloy)
<b>Insulator Material:</b>	PCT

Technical Specs	
<b>Temperature Range<sup>2</sup>:</b>	-55/+125° C
<b>Pitch:</b>	.100" (2,540mm)
<b>A Dim:</b>	1" (25,400mm)
<b>B Dim:</b>	.300" (7,620mm)
<b>C Dim:</b>	.400" (10,160mm)
<b>L Dim:</b>	.335" (8,509mm)

## NOTES:

1. Standard Tolerances:

Assembly tolerance: +/- .010" (.25mm)

Insulator length: +/- .005 (.13mm)

Insulator width: +/- .005 (.13mm)

Insulator height: +/- .005 (.13mm)

Pin Length: +/- .005 (.13mm)

Pin Diameter: +/- .002 (.051mm)

Pin Angle: +/- 2°

Co-planarity of SMT connectors: .005" (.13mm) up to 1" (25.4mm) in connector length

Insulator Flatness: .005" (.13mm) up to 1" (25.4mm) in connector length

2. Per IEC 60512-11-(4,-9,-10,-12)

## ADDITIONAL NOTES AND SPECIFICATIONS

In the interest of improved design, quality and performance, Mill-Max reserves the right to make changes in its specifications without prior notice. Specifications and tolerances are provided wherever possible. The tolerance on dimensions of critical to function features is typically held tighter than the stated standard tolerances, such as press-fits, holes and lengths affecting the coplanarity of SMT products. Due to the wide variety of interconnects Mill-Max offers, the specific tolerances vary from product to product. If you need information regarding the tolerance of a particular part, please contact Technical Services.

## RELATED LINKS AND DOCUMENTS

Environmental Compliance: ( <https://www.mill-max.com/rohs> )