

**RECEPTACLE**

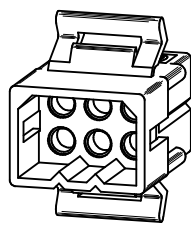

**PLUG**

<b>UPDATE REV. LEVEL</b>	EC NO: UCP2011-1525
DRWN: AELHAG	2010/11/23
CHKD: JBELL	2010/11/24
APPR: FSMITH	2010/12/03
REV	DESCRIPTION
X4	

<b>QUALITY SYMBOLS</b>	$\nabla=0$ $\nabla=0$
------------------------	--------------------------

<b>GENERAL TOLERANCES (UNLESS SPECIFIED)</b>	<table border="1"> <tr> <th></th> <th>mm</th> <th>INCH</th> </tr> <tr> <td>4 PLACES ±</td> <td>---</td> <td>±---</td> </tr> <tr> <td>3 PLACES ±</td> <td>---</td> <td>±.007</td> </tr> <tr> <td>2 PLACES ±</td> <td>0.18</td> <td>±0.10</td> </tr> <tr> <td>1 PLACE ±</td> <td>0.25</td> <td>±---</td> </tr> </table>		mm	INCH	4 PLACES ±	---	±---	3 PLACES ±	---	±.007	2 PLACES ±	0.18	±0.10	1 PLACE ±	0.25	±---
	mm	INCH														
4 PLACES ±	---	±---														
3 PLACES ±	---	±.007														
2 PLACES ±	0.18	±0.10														
1 PLACE ±	0.25	±---														
	ANGULAR ± 2°															
DRAFT WHERE APPLICABLE MUST REMAIN WITHIN DIMENSIONS																

<b>DIMENSION STYLE</b>	IN/MM
<b>DRAWN BY</b>	AELHAG
<b>DATE</b>	2010/11/23
<b>CHECKED BY</b>	JBELL
<b>DATE</b>	2010/11/24
<b>APPROVED BY</b>	FSMITH
<b>DATE</b>	2010/12/03
<b>MATERIAL NO.</b>	SEE CHART

<b>SCALE</b>	2:1
<b>DESIGN UNITS</b>	INCH
<b>THIRD ANGLE PROJECTION</b>	
TITLE .093/(2.36) HOUSING, PLUG AND RECEPTACLE, 6 CKT., .198/(5.03)CTRS.	
MOLEX INCORPORATED	
<b>DOCUMENT NO.</b>	SD-1261-*
<b>SHEET NO.</b>	1 OF 2
THIS DRAWING CONTAINS INFORMATION THAT IS PROPRIETARY TO MOLEX INCORPORATED AND SHOULD NOT BE USED WITHOUT WRITTEN PERMISSION	

PLUG	
PART NO.	ENG. NO.
03-09-2061	I261-P
23-09-2061	I261-P-100
03-09-2062	I261-P1
23-09-2062	I261-P1-100
03-09-7061	I261-PBK
03-09-7062	I261-PIBK
27-09-2093	I261-P1-200

RECEPTACLE	
PART NO.	ENG. NO.
03-09-1061	I261-R
23-09-1061	I261-R-100
03-09-1062	I261-R1
23-09-1062	I261-R1-100
03-09-1063	I261-R2
23-09-1063	I261-R2-100
03-09-1064	I261-R3
27-09-1063	I261-R2-200
03-09-6064	I261-R3BK
03-09-6063	I261-R2BK
03-09-6062	I261-R1BK
03-09-6061	I261-RBK

**LEGEND: PLUG**

I261-P\*\*\*-\*\*\*  
 P = PLUG  
 I = PLUG WITHOUT MOUNTING EARS  
 BLANK = PLUG WITH PREBENT MOUNTING EARS  
 COLOR: BLANK=NATURAL COLOR  
 AM=AMBER BK=BLACK BU=BLUE  
 BN=BROWN GY=GRAY GN=GREEN  
 OR=ORANGE RD=RED YW=YELLOW  
 MATERIAL: BLANK = NYLON 6/6, U.L. 94V-2  
 100 = POLYPROPYLENE, U.L. 94V-0  
 200 = NYLON 6/6, U.L. 94V-0, RED

**LEGEND: RECEPTACLE**

I261-R\*\*\*-\*\*\*  
 R = RECEPTACLE  
 BLANK = WITH STD. MOUNTING EARS, WITH LOCK RAMPS  
 1 = WITH STD. MOUNTING EARS, WITHOUT LOCK RAMPS  
 2 = WITHOUT MOUNTING EARS, WITHOUT LOCK RAMPS  
 3 = WITHOUT MOUNTING EARS, WITH LOCK RAMPS  
 4 = WITH PREBENT MOUNTING EARS, WITH LOCK RAMPS  
 5 = WITH PREBENT MOUNTING EARS, WITHOUT LOCK RAMPS  
 COLOR: BLANK=NATURAL COLOR  
 AM=AMBER BK=BLACK BU=BLUE  
 BN=BROWN GY=GRAY GN=GREEN  
 OR=ORANGE RD=RED YW=YELLOW  
 MATERIAL: BLANK = NYLON 6/6, U.L. 94V-2  
 100 = POLYPROPYLENE, U.L. 94V-0  
 200 = NYLON 6/6, U.L. 94V-0, RED

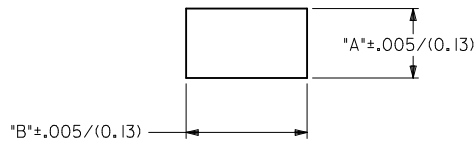
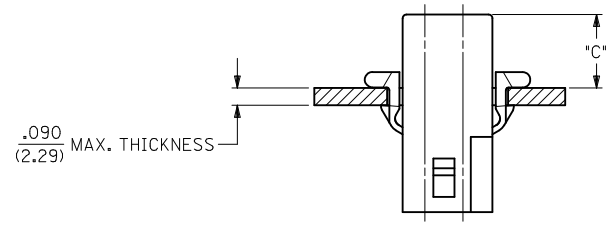

MOUNTING HOLE CUTOUT

HOUSING	DIM. "A"	DIM. "B"	DIM. "C" (STD. EAR)	DIM. "C" (PREBENT)
PLUG	.750/(19.05)	.695/(17.65)	.39/(9.9)	.40/(10.1)
RECEPTACLE	.718/(18.24)	.600/(15.24)	.40/(10.1)	.41/(10.3)

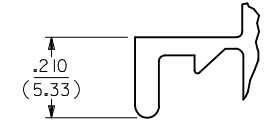

**DETAIL 3**

.093/(2.36) STANDARD MOUNTING EAR  
 (SCALE 4:1)

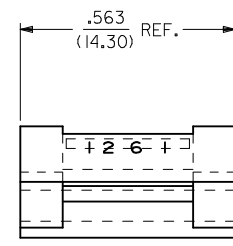

**DETAIL 4**

.093/(2.36)PREBENT MOUNTING EAR  
 (SCALE 4:1)

**NOTES:**

- MATERIAL: SEE LEGEND
- FINISH: NONE.
- PRODUCT SPECIFICATION: PS-43660-9999
- PACKAGING INFORMATION: PK-1261-001
- HOUSINGS FOR USE WITH MOLEX .093/(2.36) PIN AND SOCKET TERMINALS.
- CIRCUIT I.D. NUMBERS ON SIDE OF HOUSING APPEAR ON PARTS FROM TOOLS BUILT AFTER 9/3/91.
- WHERE DENOTED IN CHART, TOOLS ARE BUILT WITH PREBENT MOUNTING EARS PER DETAIL 4 AND SUPERSEDE ALL TOOLS PREVIOUSLY BUILT WITH THE STANDARD MOUNTING EAR.
- TEXT AND CIRCUIT IDENTIFIERS ARE SHOWN IN APPROXIMATE LOCATION BUT MAY VARY TO ACCOMMODATE TOOLING.

<b>DEL. UV MAT'L &amp; P/N</b> EC NO: UCP2011-1525 DRWN: AELHAG 2010/11/23 CHKD: JBELL 2010/11/24 APPR: FSMITH 2010/12/03	QUALITY SYMBOLS = 0 = 0	GENERAL TOLERANCES (UNLESS SPECIFIED)		DIMENSION STYLE <b>IN/MM</b>		SCALE <b>4:1</b>	DESIGN UNITS <b>INCH</b>	THIRD ANGLE PROJECTION			
		4 PLACES ± --- ± ---	3 PLACES ± --- ± .007	2 PLACES ± 0.18 ± .010	1 PLACE ± 0.25 ± ---	DRAWN BY AELHAG	DATE 2010/11/23	TITLE <b>.093/(2.36) HOUSING, PLUG AND RECEPTACLE, 6 CKT., .198/(5.03)CTRS.</b>			
		ANGULAR ± 2 °				CHECKED BY JBELL	DATE 2010/11/24	<b>MOLEX MOLEX INCORPORATED</b>			
		DRAFT WHERE APPLICABLE MUST REMAIN WITHIN DIMENSIONS				APPROVED BY FSMITH	DATE 2010/12/03	MATERIAL NO. <b>SEE CHART</b>		DOCUMENT NO. SD-1261-*	SHEET NO. 2 OF 2

THIS DRAWING CONTAINS INFORMATION THAT IS PROPRIETARY TO MOLEX INCORPORATED AND SHOULD NOT BE USED WITHOUT WRITTEN PERMISSION