



| TABLE OF CONTENTS |                               |
|-------------------|-------------------------------|
| SHEET NO.         | SHEET DESCRIPTION             |
| 1                 | NOTES AND BOM                 |
| 2                 | CONFIGURATIONS                |
| 3-4               | KEY CONFIGURATIONS            |
| 5                 | RECEPTACLE CONNECTOR ASSEMBLY |
| 6                 | BACKSHELL NOTES               |
| 7                 | BACKSHELL                     |
| 8                 | BACKSHELL CONFIGURATIONS      |

NOTES: VALID UNLESS OTHERWISE SPECIFIED

1. GENERAL:
    - a. APPLICATION SPECIFICATION SEE: AS-33472-100
      - CONTAINS: PRODUCT INTRODUCTION, PRODUCT SUMMARY, CONNECTOR ASSEMBLY, PACKAGING INFORMATION, CONNECTOR MATING, SERVICE INSTRUCTIONS, ELECTRICAL CONTINUITY CHECKING, CRIMPING, AND TROUBLESHOOTING.
      - DESIGNED TO MATE WITH DEVICE OR CONNECTOR AS SPECIFIED IN THE MATING INTERFACE/CONNECTOR DRAWINGS CHART.
      - \*DENOTES DRAWINGS THAT CAN BE ACCESSED AT <http://ewcap.uscarteams.org/>.
      - ASSEMBLY SHIPPED WITH PLR IN PRE-LOCK POSITION (SEE PLR PRE-LOCK VIEW SHEET 5).
    - b. PRODUCT SPECIFICATION SEE:
      - STANDARD CONFIGURATION PS-33472-000
      - TRANSMISSION CONFIGURATION TS-160038-0001
        - CONTAINS: PRODUCT INTRODUCTION, PRODUCT SUMMARY, RATINGS (CURRENT, TEMPERATURE, SEALING, AND FLAMMABILITY), TERMINALS, WIRE DIAMETER RANGE, PRODUCT VALIDATION, AND PRODUCT DEVIATIONS.
    - c. PACKAGING SPECIFICATION PER MOLEX DRAWING; SEE PACKAGING CHART
    - d. PARTS MUST BE IN COMPLIANCE TO MOLEX CHEMICAL SUBSTANCES FOR PRODUCTS AND PACKAGING SPECIFICATION: QEHS-699000-301
    - e. DATA MUST BE SUBMITTED UNDER THE MOLEX PART NUMBER TO IMDS (COMPANY ID#13255)
  2. DESIGN - MATERIALS:
    - a. FOR BILL OF MATERIALS SEE:
      - STANDARD CONFIGURATION SD-33472-0002
      - TRANSMISSION CONFIGURATION SD-160038-0002
    - b. TRANSMISSION CONNECTOR COMPONENTS MUST MEET THE MATERIAL REQUIREMENTS SPECIFIED IN TS-160038-0001
  3. DESIGN - GEOMETRY:
    - a. THE 3-D CAD DATA IS BASIC (WITHOUT TOLERANCE) AND MASTER FOR THIS PART WITH THE EXCEPTION OF UNDERLINED DIMENSIONS. DIMENSIONAL INFORMATION NOT SHOWN ON THIS DRAWING IS DEFINED BY THE DATA FILE AT ITS LATEST REVISION.
    - b. GEOMETRIC DIMENSIONS AND TOLERANCES PER ASME Y14.5M-2009
    - c. EDGES AND UNDIMENSIONED DETAILS PER ISO13715
    - d. CORNERS SHOWN AS SHARP TO BE R 0.2 MAX.
    - e. LETTERING SHALL BE 0.15 MAX RAISED IN 0.25 MAX RECESS PAD. THIS INCLUDES RECYCLING CODE, CAVITY ID, VENDOR IDENTIFICATION, AND CUSTOMER MATERIAL NUMBER.
    - f. VISUAL DEFECTS SHALL MEET COSMETIC STANDARD PS-45499-002 (Class B).
    - g. LASER MARKING:
      1. PART NUMBER
      2. DAY OF THE YEAR
      3. SHIFT
      4. YEAR
- FOR ADDITIONAL INFORMATION SEE SECTION 5 UNDER PROCEDURES IN ES-34735-008.

| PACKAGING   |              |
|-------------|--------------|
| DESCRIPTION | DRAWING NO.  |
| 2X2         | PK-31300-635 |
| 2X3         | PK-31300-903 |
| 2X4         | PK-31300-903 |
| 2X6         | PK-31300-903 |
| 2X8         | PK-31300-903 |
| 2X10        | PK-31300-903 |

| MATING INTERFACE/CONNECTOR DRAWINGS |                      |               |
|-------------------------------------|----------------------|---------------|
| DESCRIPTION                         | INTERFACE DEFINITION | MOLEX INLINE  |
| STANDARD 2X2                        | *150-S-004-2-Z02     | SD-33482-041  |
| STANDARD 2X3                        | *150-S-006-2-Z02     | SD-33482-061  |
| TRANSMISSION 2X3                    | *150-S-006-2-Z02     | N/A           |
| STANDARD 2X4                        | *150-S-008-2-Z02     | SD-33482-081  |
| STANDARD 2X6                        | *150-S-012-2-Z01     | SD-33482-0001 |
| STANDARD 2X8                        | *150-S-016-2-Z01     | SD-33482-0001 |
| STANDARD 2X10                       | SD-33472-201         | SD-33482-0001 |

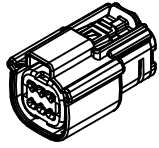

2x3

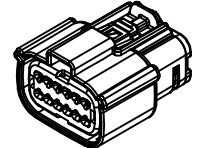

2x6

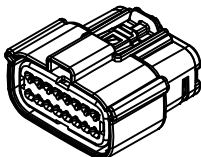

2x8

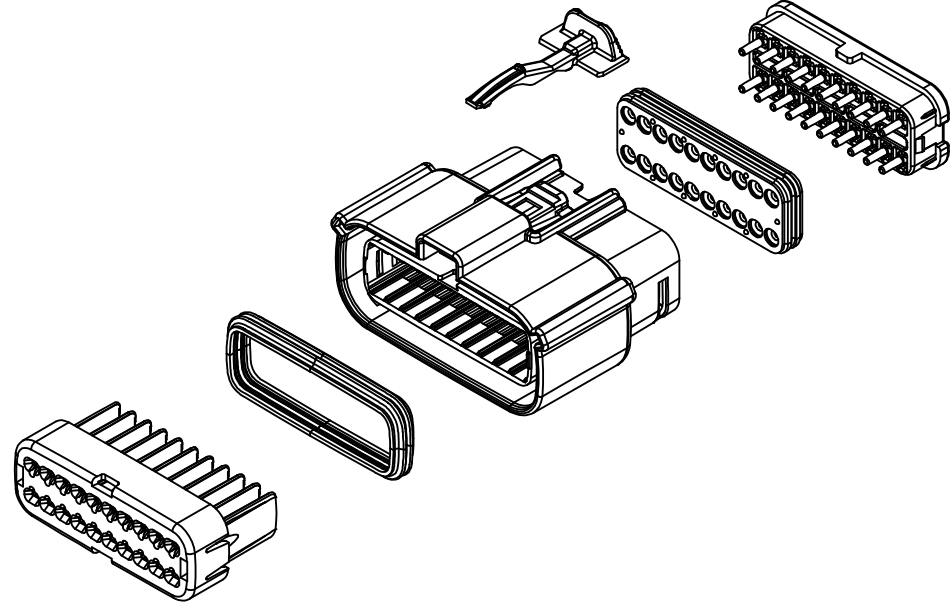

| INSPECTION NUMBER LOG |  |
|-----------------------|--|
| LAST NUMBER: 10       |  |
| ADDED:                |  |
| REMOVED:              |  |

|    |                                                               |
|----|---------------------------------------------------------------|
| A3 | ADDED 2X3 CONFIGURATIONS                                      |
| A2 | UPDATED 2X8 BLD DRAWINGS                                      |
| A1 | FIXED TYPO IN NOTE 1a, UPDATED 2X6 MOLEX INLINE BLADE DRAWING |
| A  | INITIAL RELEASE                                               |

|                                                                                                               |                                      |                                       |                                                      |                            |               |                                                                                                                                             |                                                                    |                                                                                                              |                     |
|---------------------------------------------------------------------------------------------------------------|--------------------------------------|---------------------------------------|------------------------------------------------------|----------------------------|---------------|---------------------------------------------------------------------------------------------------------------------------------------------|--------------------------------------------------------------------|--------------------------------------------------------------------------------------------------------------|---------------------|
| ENTER DESCRIPTION<br>EC NO: UAU2014-0981<br>DRWNG: ZAZELSKI 2015/03/19<br>CHKD: A3<br>APPR: VKOSHY 2015/04/17 | QUALITY SYMBOLS<br>▽=0<br>▽=0<br>▽=0 | GENERAL TOLERANCES (UNLESS SPECIFIED) |                                                      | DIMENSION STYLE<br>MM ONLY |               | DRAWN BY DATE<br>APPROFITT 2014/05/14<br>CHECKED BY DATE<br>APPROVED BY DATE<br>VKOSHY 2014/06/27<br>MATERIAL NO.<br>SEE NOTE 2a.<br>SIZE 1 | SCALE<br>1.5:1<br>DESIGN UNITS<br>METRIC<br>THIRD ANGLE PROJECTION | TITLE<br>MX150 RCPT<br>DUAL ROW SEALED ASSEMBLY<br>MAT SEAL<br><b>molex</b><br>DOCUMENT NO.<br>SD-33472-0001 | SHEET NO.<br>1 OF 8 |
|                                                                                                               |                                      | 4 PLACES ± .--- ± .---                | mm                                                   | INCH                       | ANGULAR ± 1 ° |                                                                                                                                             |                                                                    |                                                                                                              |                     |
|                                                                                                               |                                      | 3 PLACES ± .--- ± .---                | DRAFT WHERE APPLICABLE MUST REMAIN WITHIN DIMENSIONS |                            |               |                                                                                                                                             |                                                                    |                                                                                                              |                     |
|                                                                                                               |                                      | 2 PLACES ± 0.10 ± .---                |                                                      |                            |               |                                                                                                                                             |                                                                    |                                                                                                              |                     |

**SHEET DESCRIPTION**

**CONFIGURATIONS**

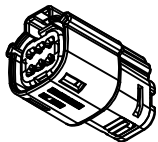

2X3 - STANDARD (STD)

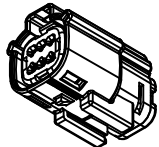

2X3 - STANDARD (STD)  
WITH CLIPSLOT \*

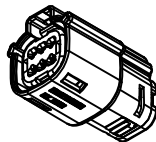

2X3 - TRANSMISSION FLUID CONFIGURATION †

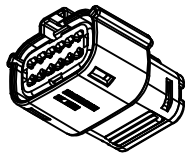

2X6 - STANDARD (STD)

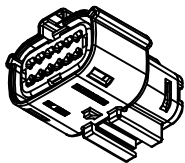

2X6 - STANDARD (STD)  
WITH CLIPSLOT \*

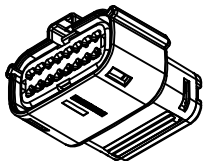

2X8 - STANDARD (STD)

\* WITH CLIPSLOT CONFIGURATION DOES NOT MEET THE USCAR PACKAGING FRAME REQUIREMENTS

† SAME GEOMETRY AS STANDARD CONFIGURATION. SEE NOTES 2b-c FOR MORE INFORMATION

|                                                                                                                             |                     |                                                      |                                   |                                                                                                                               |                               |                                                                      |
|-----------------------------------------------------------------------------------------------------------------------------|---------------------|------------------------------------------------------|-----------------------------------|-------------------------------------------------------------------------------------------------------------------------------|-------------------------------|----------------------------------------------------------------------|
| <b>ENTER DESCRIPTION</b><br>EC NO: UAU2014-0981<br>DRWN: ZIZELSKI 2015/03/19<br>CHKD:<br>APPR: VKOSHY 2015/04/17<br>REV: A3 | QUALITY SYMBOLS     | GENERAL TOLERANCES (UNLESS SPECIFIED)                | DIMENSION STYLE<br><b>MM ONLY</b> | SCALE<br><b>1.5:1</b>                                                                                                         | DESIGN UNITS<br><b>METRIC</b> | THIRD ANGLE PROJECTION                                               |
|                                                                                                                             | ▽=0                 | 4 PLACES ± --- ± ---                                 | mm INCH                           | DRAWN BY<br>APPROFIT                                                                                                          | DATE<br>2014/05/14            | TITLE<br><b>MX150 RCPT<br/>DUAL ROW SEALED ASSEMBLY<br/>MAT SEAL</b> |
|                                                                                                                             | ▽=0                 | 3 PLACES ± --- ± ---                                 |                                   | CHECKED BY                                                                                                                    | DATE                          |                                                                      |
|                                                                                                                             | ▽=0                 | 2 PLACES ± 0.10 ± ---                                |                                   | APPROVED BY<br>VKOSHY                                                                                                         | DATE<br>2014/06/27            |                                                                      |
| ▽=0                                                                                                                         | 1 PLACE ± 0.2 ± --- | ANGULAR ± 1 °                                        | MATERIAL NO.                      | DOCUMENT NO.                                                                                                                  | SHEET NO.                     |                                                                      |
|                                                                                                                             |                     | DRAFT WHERE APPLICABLE MUST REMAIN WITHIN DIMENSIONS | SEE NOTE 2a.                      | THIS DRAWING CONTAINS INFORMATION THAT IS PROPRIETARY TO MOLEX INCORPORATED AND SHOULD NOT BE USED WITHOUT WRITTEN PERMISSION |                               | 2 OF 8                                                               |

**SHEET DESCRIPTION**  
KEY CONFIGURATIONS

**2X2 (SEE SD-33472-041)**

**2X3**

**2X4 (SEE SD-33472-081)**

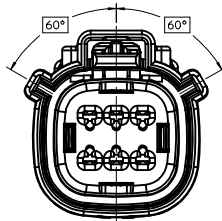

KEY A

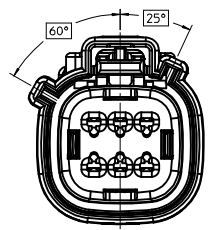

KEY B

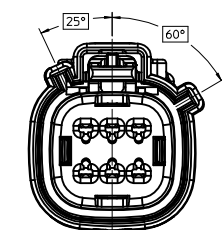

KEY C

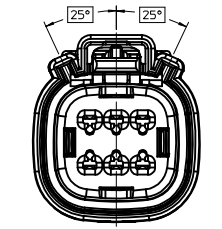

KEY D

**ENTER DESCRIPTION**  
EC NO: UAI2014-0981  
DRWN: ZIZELSKI 2015/03/19  
CHKD: APPR: WKOSHY 2015/04/17

| REV | DESCRIPTION |
|-----|-------------|
| A3  |             |

| QUALITY SYMBOLS | GENERAL TOLERANCES (UNLESS SPECIFIED) |       |
|-----------------|---------------------------------------|-------|
|                 | mm                                    | INCH  |
| $\nabla=0$      | 4 PLACES ± ---                        | ± --- |
| $\nabla=0$      | 3 PLACES ± ---                        | ± --- |
| $\nabla=0$      | 2 PLACES ± 0.10                       | ± --- |
| $\nabla=0$      | 1 PLACE ± 0.2                         | ± --- |
| $\nabla=0$      | 0 PLACE ± ---                         | ± --- |

| DIMENSION STYLE |            |
|-----------------|------------|
| MM ONLY         |            |
| DRAWN BY        | DATE       |
| APPROFIT        | 2014/05/14 |
| CHECKED BY      | DATE       |
| APPROVED BY     | DATE       |
| WKOSHY          | 2014/06/27 |

| SCALE                                                                                                                            | DESIGN UNITS | THIRD ANGLE PROJECTION |
|----------------------------------------------------------------------------------------------------------------------------------|--------------|------------------------|
| 3:1                                                                                                                              | METRIC       |                        |
| TITLE                                                                                                                            |              | DOCUMENT NO.           |
| MX150 RCPT<br>DUAL ROW SEALED ASSEMBLY<br>MAT SEAL                                                                               |              | SD-33472-0001          |
| MATERIAL NO.                                                                                                                     |              | SHEET NO.              |
| SEE NOTE 2a.                                                                                                                     |              | 3 OF 8                 |
| THIS DRAWING CONTAINS INFORMATION THAT IS PROPRIETARY TO MOLEX<br>INCORPORATED AND SHOULD NOT BE USED WITHOUT WRITTEN PERMISSION |              |                        |

**SHEET DESCRIPTION**  
KEY CONFIGURATIONS CONT.

**2X6**

**2X8**

**2X10 (SEE SD-33472-201)**

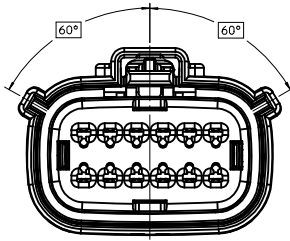

KEY A

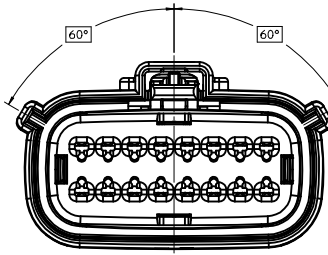

KEY A

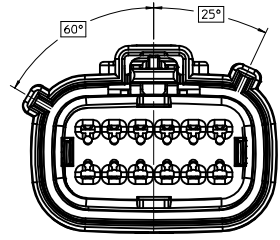

KEY B

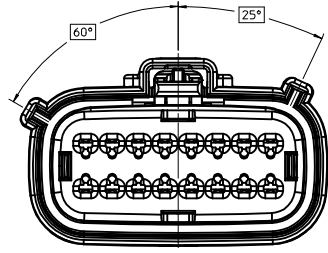

KEY B

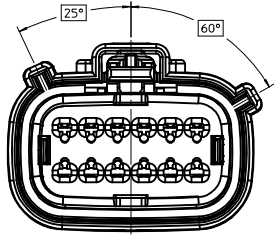

KEY C

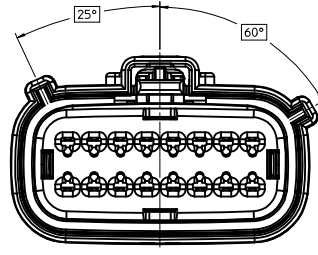

KEY C

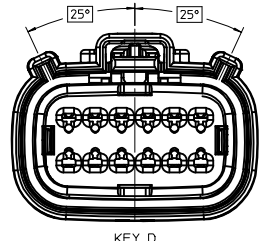

KEY D

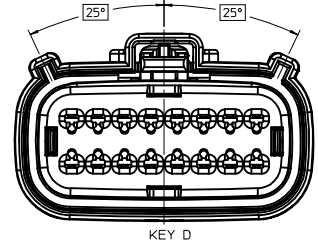

KEY D

ENTER DESCRIPTION  
 EEC NO: UAU2014-0981  
 DRAWN: ZAJELSKI 2015/03/19  
 CHKD:  
 APPR: VKOSHY 2015/04/17

| REV | DESCRIPTION     |
|-----|-----------------|
| 1   | QUALITY SYMBOLS |
| 2   | QUALITY SYMBOLS |
| 3   | QUALITY SYMBOLS |

| GENERAL TOLERANCES (UNLESS SPECIFIED) |        |
|---------------------------------------|--------|
| mm                                    | INCH   |
| 4 PLACES ± .---                       | ± .--- |
| 3 PLACES ± .---                       | ± .--- |
| 2 PLACES ± 0.10                       | ± .--- |
| 1 PLACE ± 0.2                         | ± .--- |
| 0 PLACE ± .---                        | ± .--- |
| ANGULAR ± 1 °                         |        |

| DIMENSION STYLE |            |
|-----------------|------------|
| MM ONLY         |            |
| DRAWN BY        | DATE       |
| APPROFIT        | 2014/05/14 |
| CHECKED BY      | DATE       |
| APPROVED BY     | DATE       |
| VKOSHY          | 2014/06/27 |
| MATERIAL NO.    |            |
| SEE NOTE 2a.    |            |

| SCALE                                              | DESIGN UNITS | THIRD ANGLE PROJECTION              |
|----------------------------------------------------|--------------|-------------------------------------|
| 3:1                                                | METRIC       | <input checked="" type="checkbox"/> |
| TITLE                                              |              |                                     |
| MX150 RCPT<br>DUAL ROW SEALED ASSEMBLY<br>MAT SEAL |              |                                     |
| <b>molex</b>                                       |              |                                     |
| DOCUMENT NO.                                       | SHEET NO.    |                                     |
| SD-33472-0001                                      | 4 OF 8       |                                     |

THIS DRAWING CONTAINS INFORMATION THAT IS PROPRIETARY TO MOLEX INCORPORATED AND SHOULD NOT BE USED WITHOUT WRITTEN PERMISSION

**SHEET DESCRIPTION**  
RECEPTACLE CONNECTOR ASSEMBLY

| DESCRIPTION      | DIMENSIONS |      |       |       |       |       |           |
|------------------|------------|------|-------|-------|-------|-------|-----------|
|                  | A          | B    | C     | D     | E     | F     | G         |
| ZX3 W/ CLIPSLOT  | 22.25      | 3.50 | 30.50 | N/A   | 37.65 | 27.96 | 4.0±0.4   |
| ZX3 W/O CLIPSLOT | 22.25      | 3.50 | 26.24 | 24.90 | 37.65 | N/A   | 4.0±0.4   |
| ZX6 W/ CLIPSLOT  | 32.75      | 1.75 | 35.58 | N/A   | 37.65 | 27.76 | 2.75±0.50 |
| ZX6 W/O CLIPSLOT | 32.75      | 1.75 | 35.58 | 24.90 | 37.65 | N/A   | 2.75±0.40 |
| ZX8 W/O CLIPSLOT | 39.80      | 1.75 | 42.25 | 24.90 | 37.65 | N/A   | 4.0±0.4   |

LASER MARKING ON THIS SURFACE  
SEE NOTE 3g.

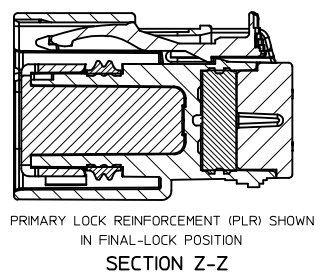
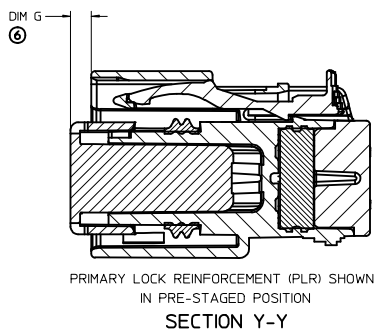
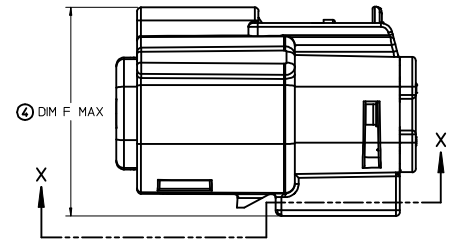
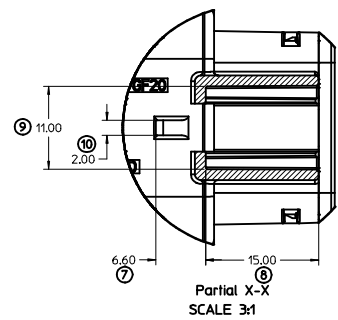
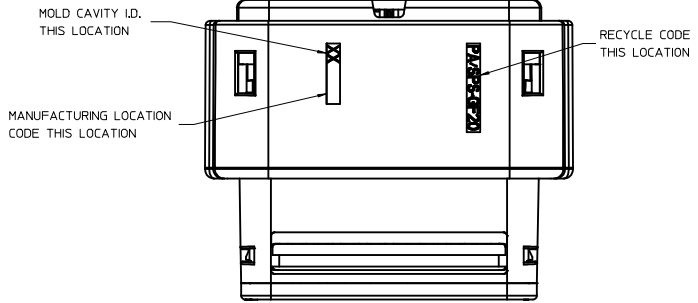
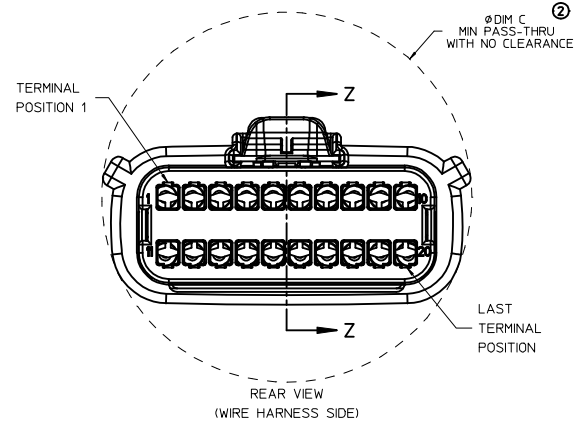
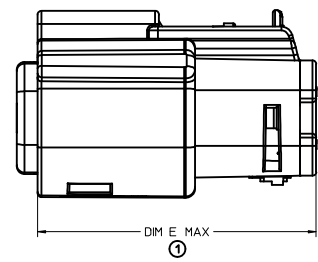
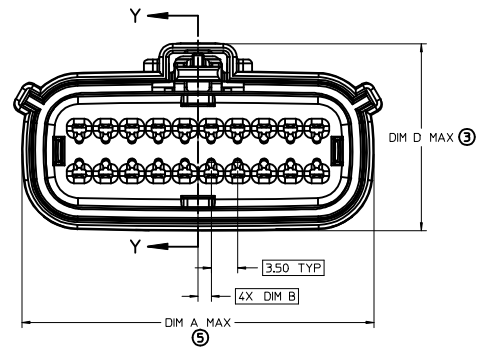
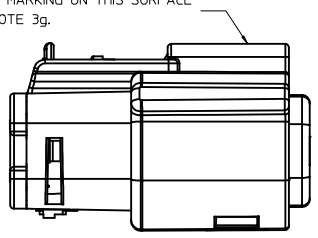

|                                                                                                                  |                                                      |                                       |                        |               |              |                        |
|------------------------------------------------------------------------------------------------------------------|------------------------------------------------------|---------------------------------------|------------------------|---------------|--------------|------------------------|
| <b>ENTER DESCRIPTION</b><br>EC NO: UAU2014-0981<br>DRWN: ZUZELSKI 2015/03/19<br>CHKD:<br>APPR: VKOSHY 2015/04/17 | QUALITY SYMBOLS                                      | GENERAL TOLERANCES (UNLESS SPECIFIED) | DIMENSION STYLE        | SCALE         | DESIGN UNITS | THIRD ANGLE PROJECTION |
|                                                                                                                  | ▽=0                                                  | mm INCH                               | MM ONLY                | 3:1           | METRIC       | ☉                      |
|                                                                                                                  | ▽=0.1                                                | 4 PLACES ± --- ± ---                  | DRAWN BY DATE          |               |              |                        |
|                                                                                                                  | ▽=0.2                                                | 3 PLACES ± --- ± ---                  | APPROFF ITT 2014/05/14 |               |              |                        |
| ▽=0                                                                                                              | 2 PLACES ± 0.10 ± ---                                | CHECKED BY DATE                       |                        |               |              |                        |
| ▽=0                                                                                                              | 1 PLACE ± 0.2 ± ---                                  | APPROVED BY DATE                      |                        |               |              |                        |
|                                                                                                                  | 0 PLACE ± --- ± ---                                  | VKOSHY 2014/06/27                     |                        |               |              |                        |
|                                                                                                                  | ANGULAR ± 1 °                                        | MATERIAL NO.                          | SEE NOTE 2a.           | DOCUMENT NO.  |              |                        |
|                                                                                                                  | DRAFT WHERE APPLICABLE MUST REMAIN WITHIN DIMENSIONS | SEE NOTE 2a.                          |                        | SD-33472-0001 |              |                        |
|                                                                                                                  |                                                      |                                       |                        |               |              |                        |

**SHEET DESCRIPTION**  
BACKSHELL NOTES

BACKSHELL NOTES: VALID UNLESS OTHERWISE SPECIFIED

1. GENERAL:  
 a. APPLICATION SPECIFICATION SEE: AS-34951-001  
 -DESIGNED TO MATE WITH RECEPTACLE SEALED ASSEMBLY SPECIFIED IN MOLEX DRAWING SD-33472-0001.  
 -SYSTEM TO BE USED WITH WIRE WITHIN DIAMETER RANGE OF 1.2mm TO 2.69mm.  
 -COMPONENTS ARE OPTIONAL AND MUST BE PURCHASED SEPERATELY.  
 -BACKSHELL DESIGN IS OWNED BY SCHLEMMER.  
 -FOR ADDITIONAL INFORMATION SEE THE BACKSHELL COMPONENT DRAWING SD-34951-0001.

BACKSHELL CUSTOMER MODEL NUMBER LEGEND

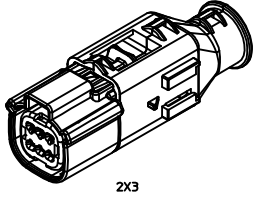
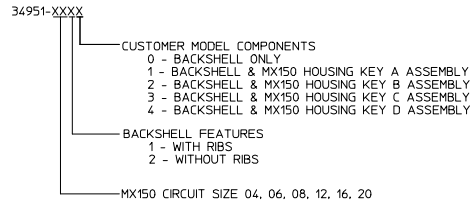

2X3

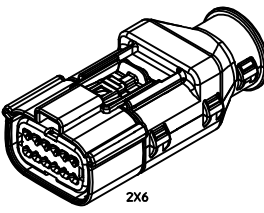

2X6

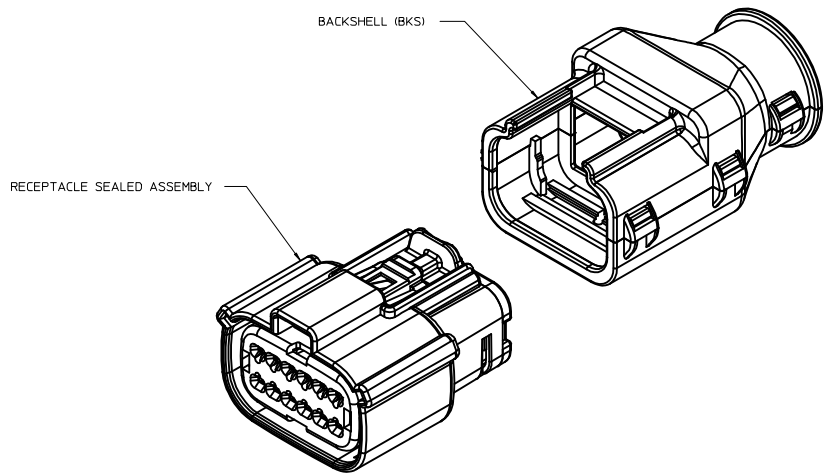

|                                                                                                                                |                     |                                                      |                  |                                   |                                                                                                                               |              |                        |                        |
|--------------------------------------------------------------------------------------------------------------------------------|---------------------|------------------------------------------------------|------------------|-----------------------------------|-------------------------------------------------------------------------------------------------------------------------------|--------------|------------------------|------------------------|
| ENTER DESCRIPTION<br>ELEC NO: 0402014-0981<br>DRAWN: JAZELSKI 2015/03/19<br>CHKD: A3<br>APPR: VKOSHY 2015/04/17<br>DESCRIPTION | QUALITY SYMBOLS     | GENERAL TOLERANCES (UNLESS SPECIFIED)                |                  | DIMENSION STYLE<br><b>MM ONLY</b> |                                                                                                                               | SCALE<br>4:1 | DESIGN UNITS<br>METRIC | THIRD ANGLE PROJECTION |
|                                                                                                                                | ▽=0                 | 4 PLACES ± --- ± ---                                 | mm INCH          | DRAWN BY DATE                     | TITLE                                                                                                                         |              |                        |                        |
|                                                                                                                                | ▽=0                 | 3 PLACES ± --- ± ---                                 |                  | APPROFIT 2014/05/14               | MX150 RCPT DUAL ROW SEALED ASSEMBLY MAT SEAL                                                                                  |              |                        |                        |
|                                                                                                                                | ▽=0                 | 2 PLACES ± 0.10 ± ---                                |                  | CHECKED BY DATE                   | <b>molex</b><br>DOCUMENT NO. SD-33472-0001 SHEET NO. 6 OF 8                                                                   |              |                        |                        |
| ▽=0                                                                                                                            | 1 PLACE ± 0.2 ± --- |                                                      | APPROVED BY DATE |                                   |                                                                                                                               |              |                        |                        |
|                                                                                                                                |                     | 0 PLACE ± --- ± ---                                  |                  | VKOSHY 2014/06/27                 |                                                                                                                               |              |                        |                        |
|                                                                                                                                |                     | ANGULAR ± 1 °                                        |                  | MATERIAL NO.                      | SEE NOTE 2a.                                                                                                                  |              |                        |                        |
|                                                                                                                                |                     | DRAFT WHERE APPLICABLE MUST REMAIN WITHIN DIMENSIONS |                  | SIZE 1                            | THIS DRAWING CONTAINS INFORMATION THAT IS PROPRIETARY TO MOLEX INCORPORATED AND SHOULD NOT BE USED WITHOUT WRITTEN PERMISSION |              |                        |                        |

**SHEET DESCRIPTION**

BACKSHELL

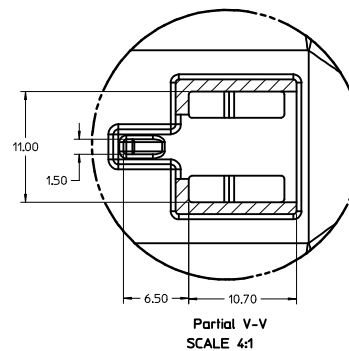
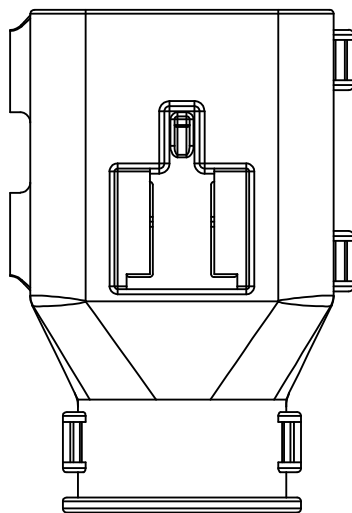
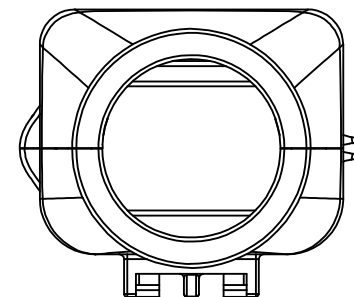
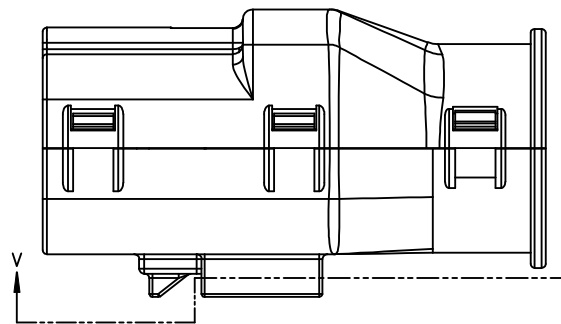
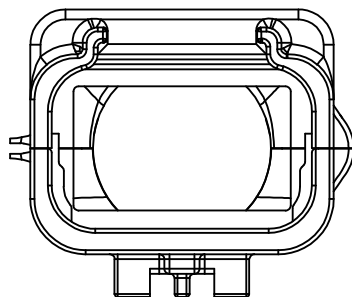
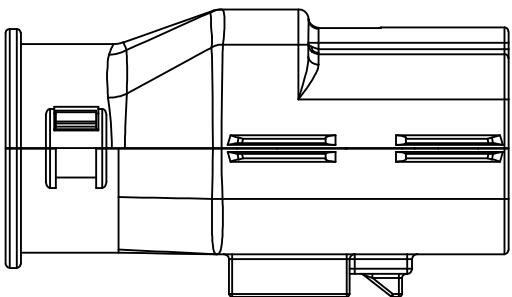

|                                                                                                                             |                       |                                                      |                     |       |              |                                                                                                                               |
|-----------------------------------------------------------------------------------------------------------------------------|-----------------------|------------------------------------------------------|---------------------|-------|--------------|-------------------------------------------------------------------------------------------------------------------------------|
| <b>ENTER DESCRIPTION</b><br>ELEC NO: UA02014-0981<br>DRAWN: ZAJELSKI 2015/03/19<br>CHKD:<br>APPR: VKOSHY 2015/04/17<br>REV: | QUALITY SYMBOLS       | GENERAL TOLERANCES (UNLESS SPECIFIED)                | DIMENSION STYLE     | SCALE | DESIGN UNITS | THIRD ANGLE PROJECTION                                                                                                        |
|                                                                                                                             | ▽=0                   | mm INCH                                              | MM ONLY             | 4:1   | METRIC       |                                                                                                                               |
|                                                                                                                             | ▽=1                   | 4 PLACES ± --- ± ---                                 | DRAWN BY DATE       |       |              |                                                                                                                               |
|                                                                                                                             | ▽=2                   | 3 PLACES ± --- ± ---                                 | APPROFIT 2014/05/14 |       |              |                                                                                                                               |
| ▽=3                                                                                                                         | 2 PLACES ± 0.10 ± --- | CHECKED BY DATE                                      |                     |       |              | TITLE                                                                                                                         |
| ▽=4                                                                                                                         | 1 PLACE ± 0.2 ± ---   | APPROVED BY DATE                                     |                     |       |              | MX150 RCPT<br>DUAL ROW SEALED ASSEMBLY<br>MAT SEAL                                                                            |
| ▽=5                                                                                                                         | 0 PLACE ± --- ± ---   | VKOSHY 2014/06/27                                    |                     |       |              | <b>molex</b>                                                                                                                  |
|                                                                                                                             | ANGULAR ± 1°          | DRAFT WHERE APPLICABLE MUST REMAIN WITHIN DIMENSIONS | SEE NOTE 2a.        |       |              | DOCUMENT NO. SD-33472-0001                                                                                                    |
|                                                                                                                             |                       |                                                      |                     |       |              | SHEET NO. 7 OF 8                                                                                                              |
|                                                                                                                             |                       |                                                      |                     |       |              | THIS DRAWING CONTAINS INFORMATION THAT IS PROPRIETARY TO MOLEX INCORPORATED AND SHOULD NOT BE USED WITHOUT WRITTEN PERMISSION |



**SHEET DESCRIPTION**  
BACKSHELL CONFIGURATIONS

| CHARTED DIMENSIONS |            |
|--------------------|------------|
| DESCRIPTION        | DIMENSIONS |
|                    | H          |
| 2X3 W/ CLIPSLOT    | TBD        |
| 2X3 W/O CLIPSLOT   | 28,50      |
| 2X6 W/O CLIPSLOT   | 35,83      |

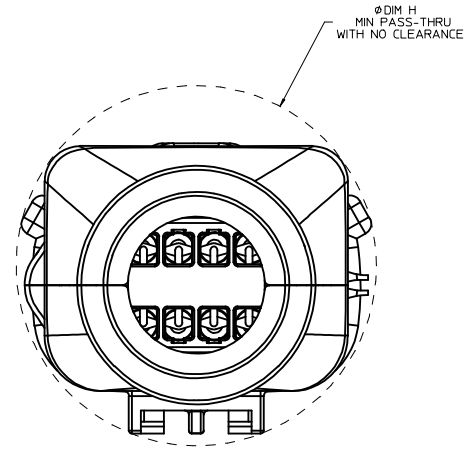
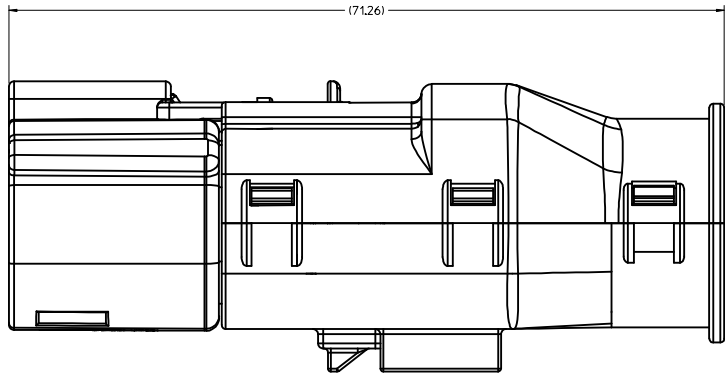

RECEPTACLE SEALED ASSEMBLY WITH RECEPTACLE BACKSHELL

|                                                                                                                        |                                                      |                                       |                                                                                                                               |                                                    |              |                        |
|------------------------------------------------------------------------------------------------------------------------|------------------------------------------------------|---------------------------------------|-------------------------------------------------------------------------------------------------------------------------------|----------------------------------------------------|--------------|------------------------|
| <b>ENTER DESCRIPTION</b><br>ELEC NO: UAU2014-0981<br>DRAWN: ZAZELSKI 2015/03/19<br>CHKD: A3<br>APPR: VKOSHY 2015/04/17 | QUALITY SYMBOLS                                      | GENERAL TOLERANCES (UNLESS SPECIFIED) | DIMENSION STYLE                                                                                                               | SCALE                                              | DESIGN UNITS | THIRD ANGLE PROJECTION |
|                                                                                                                        | ▽=0                                                  | mm INCH                               | MM ONLY                                                                                                                       | 4:1                                                | METRIC       |                        |
|                                                                                                                        | ▽=0                                                  | 4 PLACES ± --- ± ---                  | DRAWN BY DATE                                                                                                                 | TITLE                                              |              |                        |
|                                                                                                                        | ▽=0                                                  | 3 PLACES ± --- ± ---                  | APPROFF ITT 2014/05/14                                                                                                        | MX150 RCPT<br>DUAL ROW SEALED ASSEMBLY<br>MAT SEAL |              |                        |
| ▽=0                                                                                                                    | 2 PLACES ± 0.10 ± ---                                | CHECKED BY DATE                       | DOCUMENT NO.                                                                                                                  |                                                    |              |                        |
|                                                                                                                        | 1 PLACE ± 0.2 ± ---                                  | APPROVED BY DATE                      | SD-33472-0001                                                                                                                 |                                                    |              |                        |
|                                                                                                                        | 0 PLACE ± --- ± ---                                  | VKOSHY 2014/06/27                     | SHEET NO.                                                                                                                     |                                                    |              |                        |
|                                                                                                                        | ANGULAR ± 1 °                                        | MATERIAL NO.                          | 8 OF 8                                                                                                                        |                                                    |              |                        |
|                                                                                                                        | DRAFT WHERE APPLICABLE MUST REMAIN WITHIN DIMENSIONS | SEE NOTE 2a.                          | THIS DRAWING CONTAINS INFORMATION THAT IS PROPRIETARY TO MOLEX INCORPORATED AND SHOULD NOT BE USED WITHOUT WRITTEN PERMISSION |                                                    |              |                        |

| TABLE OF CONTENTS |                            |
|-------------------|----------------------------|
| SHEET NO.         | SHEET DESCRIPTION          |
| 1                 | NOTES                      |
| 2                 | KEY CONFIGURATIONS         |
| 3                 | RECEPTACLE SEALED ASSEMBLY |
| 4                 | BACKSHELL NOTES            |
| 5                 | BACKSHELL                  |
| 6                 | BACKSHELL CONFIGURATIONS   |
| 7-8               | BOM                        |

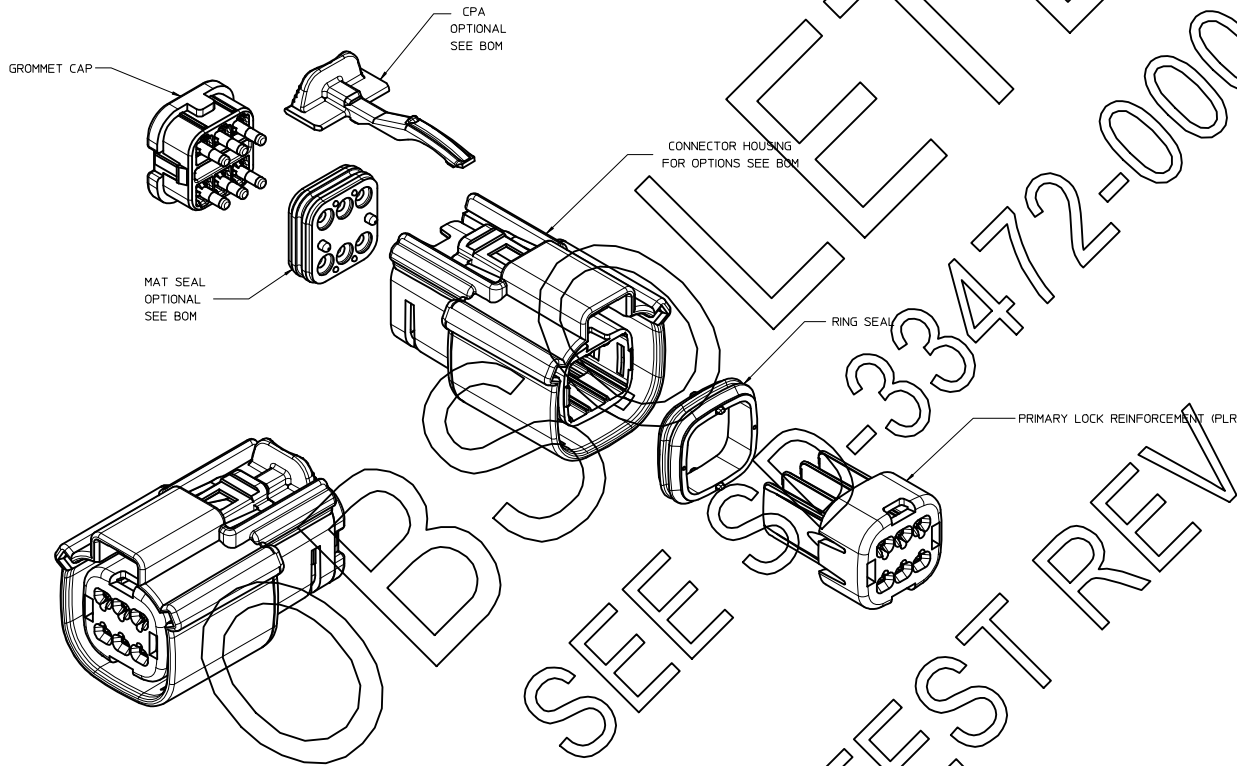

NOTES: VALID UNLESS OTHERWISE SPECIFIED

1. GENERAL:
- a. APPLICATION SPECIFICATION SEE: AS-33472-100  
 CONTAINS: PRODUCT INTRODUCTION, PRODUCT SUMMARY, CONNECTOR ASSEMBLY, PACKAGING INFORMATION, CONNECTOR MATING, SERVICE INSTRUCTIONS, ELECTRICAL CONTINUITY CHECKING, CRIMPING AND TROUBLESHOOTING.  
 -DESIGNED TO MATE WITH DEVICE CONNECTION AS SPECIFIED IN DRAWING EWCAP 150-S-006-2-202, AVAILABLE AT <http://ewcap.uscarteams.org/>.  
 -DESIGNED TO MATE WITH BLADE SEALED ASSEMBLY AS SPECIFIED IN DRAWING SD-33482-061  
 -FOR 15mm RECEPTACLE TERMINALS TO BE USED WITH THIS ASSEMBLY SEE MOLEX DRAWING SD-33012-002  
 - SYSTEM TO BE USED WITH WIRE WITHIN DIAMETER RANGE OF 1.2mm TO 2.69mm.  
 -ASSEMBLY SHIPPED WITH PLR AND CPA IN PRE-LOCK POSITION (SEE SECTION 2-2 PRE-LOCK)  
 -IN THE EVENT THAT THE PLR IS FOUND IN THE SEATED (FINAL LOCK) POSITION, REFER TO MOLEX SPECIFICATION PS-34646-001, AVAILABLE AT <http://www.molex.com> <http://www.molex.com>  
 -ASSEMBLY CONFORMS TO SAE/USCAR-2 REV.4 WITH THE FOLLOWING EXCEPTIONS: ENGAGEMENT FORCE TO MOVE CPA FROM PRE-LOCK TO FINAL LOCK POSITION WHEN UNMATED: 40N MIN. DISENGAGEMENT FORCE TO MOVE CPA FROM FINAL LOCK TO PRE-LOCK POSITION: 3N MIN. 40N MAX. TERMINAL INSERTION FORCE FOR WIRE DIAMETER ABOVE 2.5mm NOT EXCEEDING 2.69mm SHALL NOT EXCEED 40 NEWTONS. PLR REMOVAL LOCK TO PRE-LOCK POSITION SHALL NOT EXCEED 130 NEWTONS.
- b. PRODUCT SPECIFICATION SEE: PS-33472-000  
 CONTAINS: PRODUCT INTRODUCTION, PRODUCT SUMMARY, RATINGS (CURRENT, TEMPERATURE, SEALING, AND FLAMMABILITY), AND PRODUCT VALIDATION.
- c. PACKAGING SPECIFICATION PER MOLEX DRAWING PK-31300-903
- d. PARTS MUST BE IN COMPLIANCE TO MOLEX CHEMICAL SUBSTANCES FOR PRODUCTS AND PACKAGING SPECIFICATION ES-40000-504
- e. DATA MUST BE SUBMITTED UNDER THE MOLEX PART NUMBER TO IMDS (COMPANY ID#1325)
- f. FOR INFORMATION ON 2X3 RECEPTACLE SEALED ASSEMBLY WITH CLIPSLOT SEE SD-33472-071
2. DESIGN - MATERIALS:  
 a. SEE BOM TABLE
3. DESIGN - GEOMETRY:  
 a. THIS IS A 100% CAD GENERATED PART. THE CAD MATHEMATICAL DATA IS THE MASTER FOR THIS PART. FOR DIMENSIONAL OR ANY INFORMATION NOT SHOWN ON THIS DRAWING, ANALYZE THE CAD MODEL.  
 b. GEOMETRIC DIMENSIONS AND TOLERANCES PER ASME Y14.5M - 1994  
 c. EDGES AND UNDIMENSIONED DETAILS PER ISO13715  
 d. CORNERS SHOWN AS SHARP TO BE R 0.2 MAX.  
 e. LETTERING SHALL BE 0.15 MAX RAISED IN 0.25 MAX RECESS PAD. THIS INCLUDES RECYCLING CODE, CAVITY ID, VENDOR IDENTIFICATION, AND CUSTOMER MATERIAL NUMBER.  
 f. VISUAL DEFECTS SHALL MEET COSMETIC STANDARD PS-45499-002 (Class B)  
 g. LASER MARKING TBD

INSPECTION NUMBER LOG  
 LAST NUMBER USED:  
 ADDED:  
 REMOVED:

| Y   | DESCRIPTION                                                                         |
|-----|-------------------------------------------------------------------------------------|
| X19 | UPDATE VIEWS.                                                                       |
| X18 | ADD NEW P/N 33472-0691 33472-0692                                                   |
| X17 | ADD NEW P/N 33472-0690                                                              |
| X16 | ADD NEW P/N 33472-0689                                                              |
| X15 | UPDATED VIEWS                                                                       |
| X14 | ADD NEW P/N 33472-0687 33472-0688                                                   |
| X13 | ADD NEW P/N 33472-0684 33472-0685 33472-0686                                        |
| X12 | ADD NEW P/N 33472-0683                                                              |
| X11 | ADD NEW P/N 33472-0682                                                              |
| X10 | CHANGE THE STATUS TO SELEABLE FROM TOOLED BUT NOT VALIDATED FOR DK GREY AND ST GREY |
| X9  | UPDATED BACKSHELL INFORMATION                                                       |
| X8  | ADD NEW P/N 33472-0681                                                              |
| X7  | UPDATED BACKSHELL                                                                   |
| X6  | RENAMED BACKSHELLS                                                                  |
| X5  | ADD NEW P/N 33472-0678 33472-0679 33472-0680                                        |
| X4  | UPDATED VIEWS                                                                       |
| X3  | UPDATED NOMENCLATURE SHEET 3                                                        |
| X2  | ADD NEW P/N 33472-0677                                                              |
| X1  | UPDATED NOTES                                                                       |
| X   | REDRAWN, ADDED BACKSHELL                                                            |

|                                                                                                                             |                                             |                                                                                                                                                                                                                                                 |                                                                                                                                                                |                                                            |                                                                        |                                                   |                  |
|-----------------------------------------------------------------------------------------------------------------------------|---------------------------------------------|-------------------------------------------------------------------------------------------------------------------------------------------------------------------------------------------------------------------------------------------------|----------------------------------------------------------------------------------------------------------------------------------------------------------------|------------------------------------------------------------|------------------------------------------------------------------------|---------------------------------------------------|------------------|
| <b>ENTER DESCRIPTION</b><br>IEC NO. UAU2014-0981<br>DRAWN: JZUZELSKI 2015/04/03<br>CHKD:<br>APPR: VKOSHY 2015/04/17<br>REV: | <b>QUALITY SYMBOLS</b><br>∇=0<br>∇=0<br>∇=0 | <b>GENERAL TOLERANCES (UNLESS SPECIFIED)</b><br>mm INCH<br>4 PLACES ± --- ± ---<br>3 PLACES ± 0.10 ± ---<br>2 PLACES ± 0.3 ± ---<br>1 PLACE ± ± ---<br>0 PLACE ± ± ---<br>ANGULAR ± 3 °<br>DRAFT WHERE APPLICABLE MUST REMAIN WITHIN DIMENSIONS | <b>DIMENSION STYLE</b><br>MM ONLY<br>DRAWN BY DATE<br>DGRIF1 ITHS 06-05-03<br>CHECKED BY DATE<br>DGRIF1 ITHS 06-05-03<br>APPROVED BY DATE<br>VKOSHY 2010/03/04 | SCALE 3:1<br>DESIGN UNITS METRIC<br>THIRD ANGLE PROJECTION | TITLE<br>MX150 2X3 RECEPTACLE SEALED ASSEMBLY MAT SEAL<br><b>molex</b> | MATERIAL NO. SEE BOM<br>DOCUMENT NO. SD-33472-061 | SHEET NO. 1 OF 9 |
|                                                                                                                             |                                             |                                                                                                                                                                                                                                                 |                                                                                                                                                                |                                                            |                                                                        |                                                   |                  |

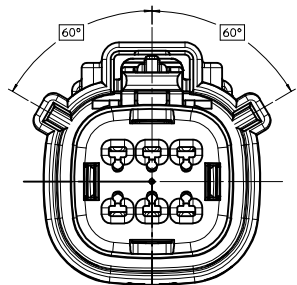

KEY A

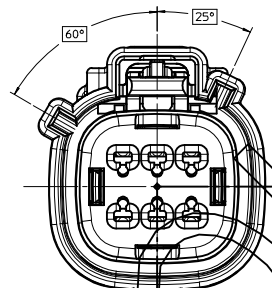

KEY B

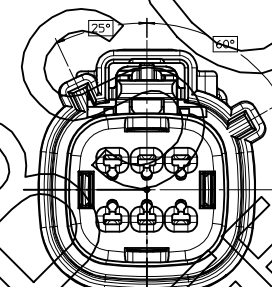

KEY C

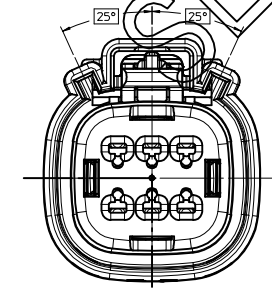

KEY D

OBSOLETE SD-33472-0001  
 LATEST REV.

|                                                                                                                      |                                                                                                                                      |  |                                                                                                                                |  |                                                                                                                                  |  |                     |              |                                                              |
|----------------------------------------------------------------------------------------------------------------------|--------------------------------------------------------------------------------------------------------------------------------------|--|--------------------------------------------------------------------------------------------------------------------------------|--|----------------------------------------------------------------------------------------------------------------------------------|--|---------------------|--------------|--------------------------------------------------------------|
| ENTER DESCRIPTION<br>IEC NO. UAU2014-0981<br>DRAWN BY ZUZELSKI<br>CHKD:<br>APPR: VKOSHY<br>2015/04/17<br>DESCRIPTION | QUALITY SYMBOLS                                                                                                                      |  | GENERAL TOLERANCES (UNLESS SPECIFIED)                                                                                          |  | DIMENSION STYLE                                                                                                                  |  | SCALE               | DESIGN UNITS | THIRD ANGLE PROJECTION                                       |
|                                                                                                                      | ∇=0<br>∇=0<br>∇=0                                                                                                                    |  | mm      INCH<br>4 PLACES ±      ±<br>3 PLACES ±      ±<br>2 PLACES ±0.10 ±      ±<br>1 PLACE ±0.3 ±      ±<br>0 PLACE ±      ± |  | MM ONLY<br>DRAWN BY DATE<br>DGRIFITHS 06-05-03<br>CHECKED BY DATE<br>DGRIFITHS 06-05-03<br>APPROVED BY DATE<br>VKOSHY 2010/03/04 |  | 4:1                 | METRIC       | TITLE<br>MX150 2X3 RECEPTACLE<br>SEALED ASSEMBLY<br>MAT SEAL |
|                                                                                                                      | ANGULAR ± 3 °<br>DRAFT WHERE APPLICABLE<br>MUST REMAIN<br>WITHIN DIMENSIONS                                                          |  | MATERIAL NO.<br>SEE BOM                                                                                                        |  | DOCUMENT NO.<br>SD-33472-061                                                                                                     |  | SHEET NO.<br>2 OF 9 |              |                                                              |
|                                                                                                                      | SIZE D THIS DRAWING CONTAINS INFORMATION THAT IS PROPRIETARY TO MOLEX INCORPORATED AND SHOULD NOT BE USED WITHOUT WRITTEN PERMISSION |  |                                                                                                                                |  |                                                                                                                                  |  |                     |              |                                                              |

LASER MARKING ON THIS SURFACE  
SEE NOTE 3g.

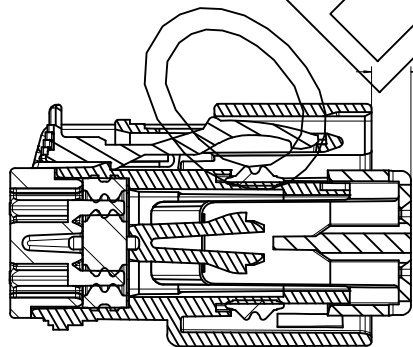
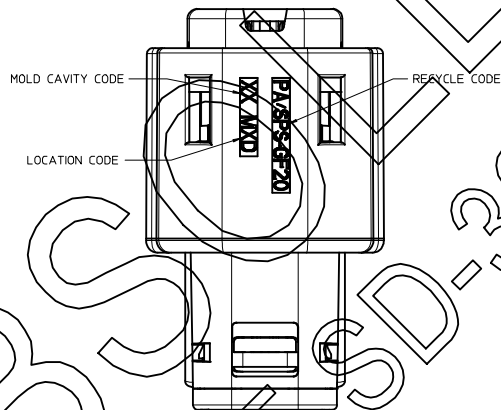
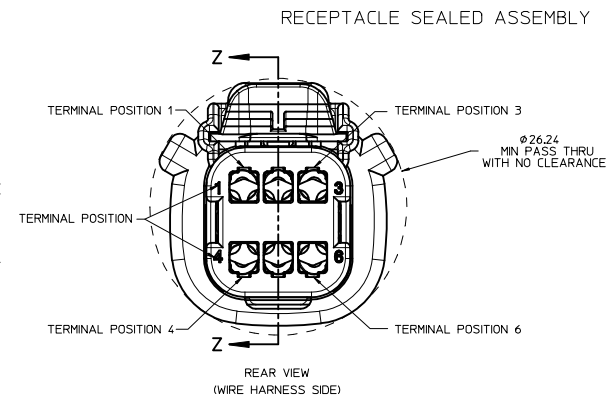
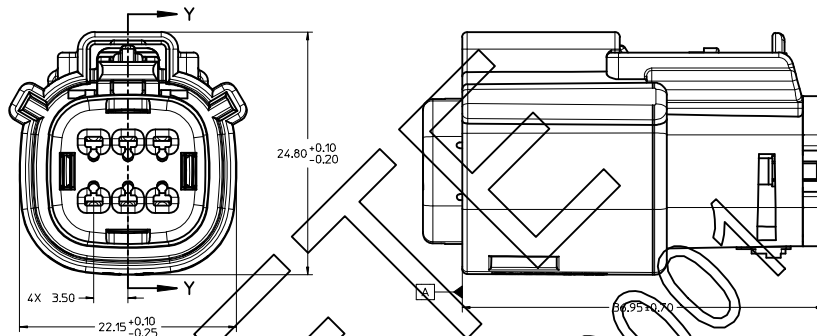
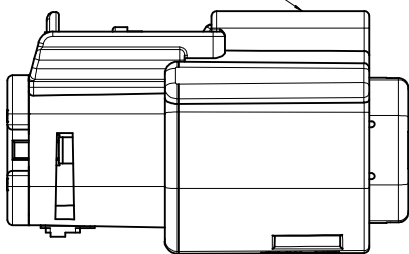

PRIMARY LOCK REINFORCEMENT (PLR) SHOWN  
IN PRE-STAGED POSITION  
SECTION Z-Z

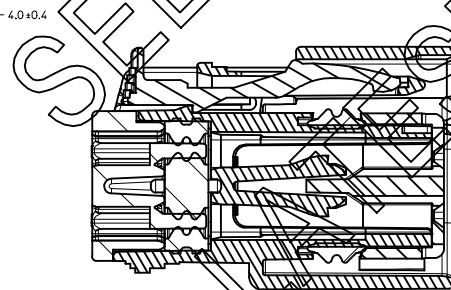

PRIMARY LOCK REINFORCEMENT (PLR) SHOWN  
IN FINAL-LOCK POSITION  
SECTION Y-Y

BS SEE SD-33472-0001  
 SEE SD-33472-0001 REV.

|                                                                                                           |                                                                                                                                  |                                                                                                                    |                                                                                                                             |                         |                                                              |                                  |                     |
|-----------------------------------------------------------------------------------------------------------|----------------------------------------------------------------------------------------------------------------------------------|--------------------------------------------------------------------------------------------------------------------|-----------------------------------------------------------------------------------------------------------------------------|-------------------------|--------------------------------------------------------------|----------------------------------|---------------------|
| ENTER DESCRIPTION<br>IEC NO. UAU2014-0981<br>DRAWN: JIZELSKI<br>CHKD:<br>APPR: VKOSHY<br>DATE: 2015/04/17 | QUALITY SYMBOLS                                                                                                                  | GENERAL TOLERANCES (UNLESS SPECIFIED)                                                                              | DIMENSION STYLE                                                                                                             | SCALE                   | DESIGN UNITS                                                 | THIRD ANGLE PROJECTION           |                     |
|                                                                                                           | ∇=0<br>∇=0<br>∇=0                                                                                                                | mm    INCH<br>4 PLACES ±    ±<br>3 PLACES ±    ±<br>2 PLACES ±0.10 ±    ±<br>1 PLACE ±0.3 ±    ±<br>0 PLACE ±    ± | MM ONLY                                                                                                                     | 4:1                     | METRIC                                                       | ☉    □<br>THIRD ANGLE PROJECTION |                     |
|                                                                                                           | DRAFT WHERE APPLICABLE<br>MUST REMAIN<br>WITHIN DIMENSIONS                                                                       | ANGULAR ± 3 °<br>DRAFT WHERE APPLICABLE<br>MUST REMAIN<br>WITHIN DIMENSIONS                                        | DRAWN BY: DGRIFITHS<br>DATE: 06-05-03<br>CHECKED BY: DGRIFITHS<br>DATE: 06-05-03<br>APPROVED BY: VKOSHY<br>DATE: 2010/03/04 | MATERIAL NO.<br>SEE BOM | TITLE<br>MX150 2X3 RECEPTACLE<br>SEALED ASSEMBLY<br>MAT SEAL | DOCUMENT NO.<br>SD-33472-061     | SHEET NO.<br>3 OF 9 |
|                                                                                                           | THIS DRAWING CONTAINS INFORMATION THAT IS PROPRIETARY TO MOLEX<br>INCORPORATED AND SHOULD NOT BE USED WITHOUT WRITTEN PERMISSION |                                                                                                                    |                                                                                                                             |                         |                                                              |                                  | molex               |

BACKSHELL NOTES

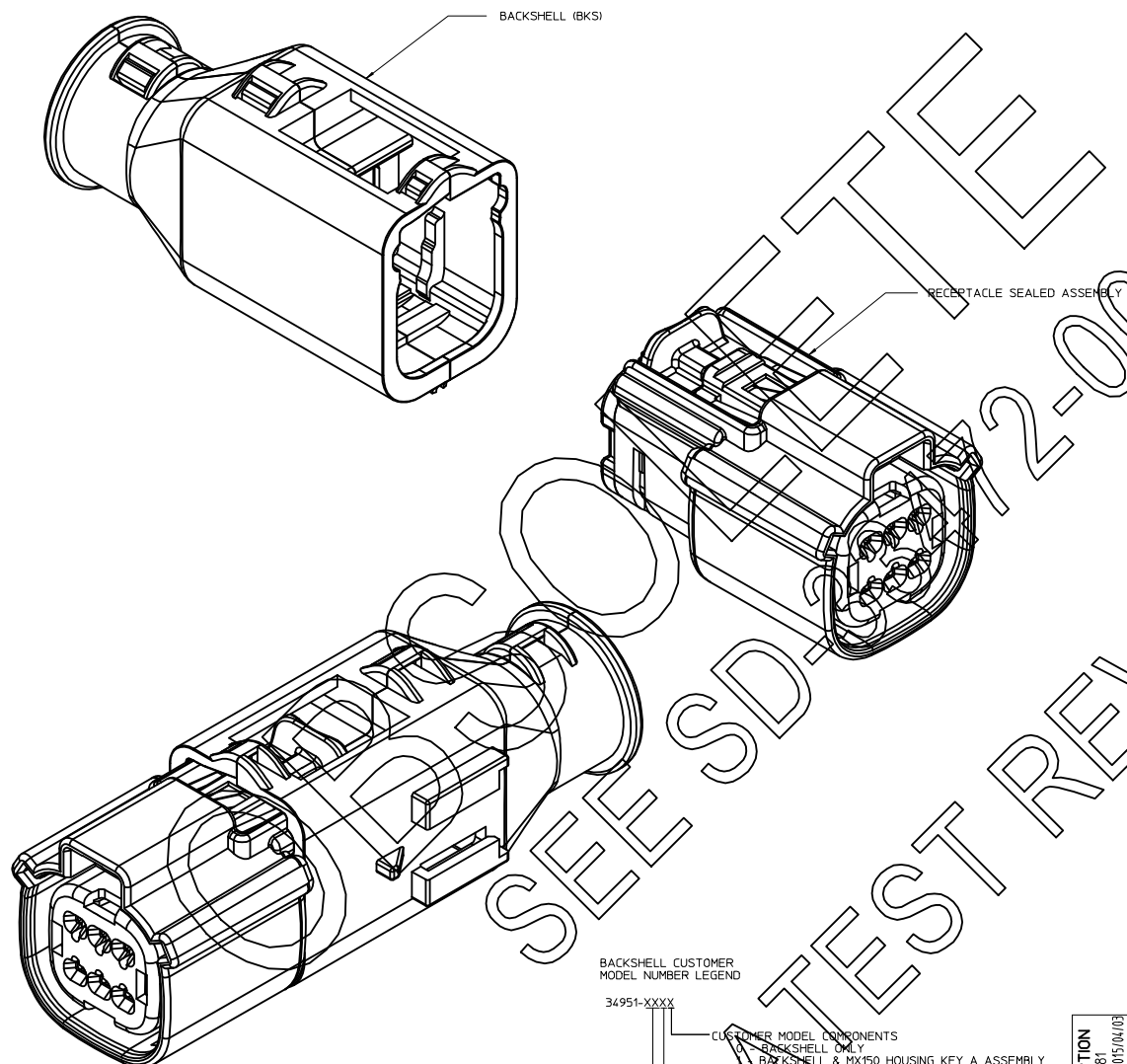

BACKSHELL NOTES: VALID UNLESS OTHERWISE SPECIFIED

- 1. GENERAL:
- 2. APPLICATION SPECIFICATION SEE: AS-34951-001
- DESIGNED TO MATE WITH RECEPTACLE SEALED ASSEMBLY AS SPECIFIED IN DRAWING SD-33472-061
- SYSTEM TO BE USED WITH WIRE WITHIN DIAMETER RANGE OF 1.2 mm TO 2.69 mm.
- COMPONENTS ARE OPTIONAL AND MUST BE PURCHASED SEPARATELY
- BACKSHELL DESIGN IS OWNED BY SCHLEMMER
- FOR ADDITIONAL INFORMATION SEE THE BACKSHELL COMPONENT DRAWING SD-34951-0001

BACKSHELL CUSTOMER MODEL NUMBER LEGEND

34951-XXXX

- CUSTOMER MODEL COMPONENTS
- 1. BACKSHELL ONLY
  - 2. BACKSHELL & MX150 HOUSING KEY A ASSEMBLY
  - 3. BACKSHELL & MX150 HOUSING KEY B ASSEMBLY
  - 4. BACKSHELL & MX150 HOUSING KEY C ASSEMBLY
  - 5. BACKSHELL & MX150 HOUSING KEY D ASSEMBLY

- BACKSHELL FEATURES
- 1. WITH RIBS
  - 2. WITHOUT RIBS

MX150 CIRCUIT SIZE 04, 06, 08, 12, 16, 20

|                                                                                                            |                                             |                                                      |                       |                                   |                                                        |                              |                        |                                                                                                                               |  |
|------------------------------------------------------------------------------------------------------------|---------------------------------------------|------------------------------------------------------|-----------------------|-----------------------------------|--------------------------------------------------------|------------------------------|------------------------|-------------------------------------------------------------------------------------------------------------------------------|--|
| <b>ENTER DESCRIPTION</b><br>IEC NO. UAU2014-0981<br>DRAWN: JIZELSKI<br>CHKD:<br>APPR: VKOSHY<br>2015/04/17 | <b>QUALITY SYMBOLS</b><br>∇=0<br>∇=0<br>∇=0 | <b>GENERAL TOLERANCES (UNLESS SPECIFIED)</b>         |                       | <b>DIMENSION STYLE</b><br>MM ONLY | SCALE<br>4:1                                           | DESIGN UNITS<br>METRIC       | THIRD ANGLE PROJECTION |                                                                                                                               |  |
|                                                                                                            |                                             | mm    INCH                                           | DRAWN BY<br>DGRIFITHS | DATE<br>06-05-03                  | TITLE<br>MX150 2X3 RECEPTACLE SEALED ASSEMBLY MAT SEAL |                              |                        |                                                                                                                               |  |
|                                                                                                            |                                             | 4 PLACES ± --- ± ---                                 | 3 PLACES ± --- ± ---  | CHECKED BY<br>DGRIFITHS           | DATE<br>06-05-03                                       | MATERIAL NO.<br>SEE BOM      |                        |                                                                                                                               |  |
|                                                                                                            |                                             | 2 PLACES ± 0.10 ± ---                                | 1 PLACE ± 0.3 ± ---   | APPROVED BY<br>VKOSHY             | DATE<br>2010/03/04                                     | DOCUMENT NO.<br>SD-33472-061 |                        |                                                                                                                               |  |
|                                                                                                            |                                             | 0 PLACE ± ±                                          | ANGULAR ± 3 °         | SIZE<br>D                         |                                                        | SHEET NO.<br>4 OF 9          |                        |                                                                                                                               |  |
|                                                                                                            |                                             | DRAFT WHERE APPLICABLE MUST REMAIN WITHIN DIMENSIONS |                       |                                   |                                                        |                              |                        | THIS DRAWING CONTAINS INFORMATION THAT IS PROPRIETARY TO MOLEX INCORPORATED AND SHOULD NOT BE USED WITHOUT WRITTEN PERMISSION |  |

20 19 18 17 16 15 14 13 12 11 10 9 8 7 6 5 4 3 2 1

BACKSHELL  
THE VIEWS ON THIS SHEET ARE  
IN THE CLOSED UN-ASSEMBLED POSITION

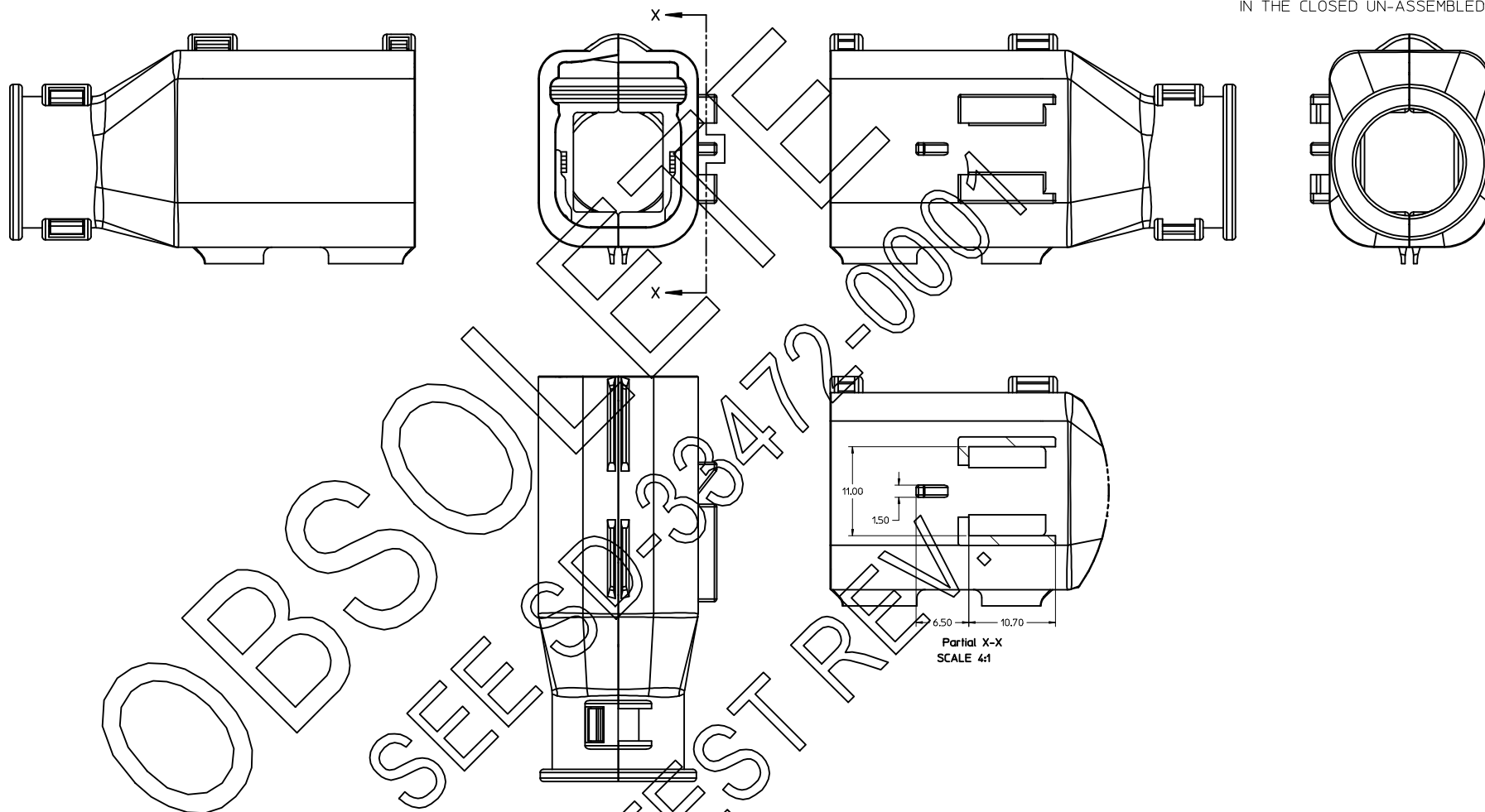

Partial X-X  
SCALE 4:1

|                                                                                                                                       |                                                                                                                               |                                                                                                                                                                                                                                              |                                                                                                                                                     |                                                                  |                                                                        |                         |                              |                     |
|---------------------------------------------------------------------------------------------------------------------------------------|-------------------------------------------------------------------------------------------------------------------------------|----------------------------------------------------------------------------------------------------------------------------------------------------------------------------------------------------------------------------------------------|-----------------------------------------------------------------------------------------------------------------------------------------------------|------------------------------------------------------------------|------------------------------------------------------------------------|-------------------------|------------------------------|---------------------|
| <b>ENTER DESCRIPTION</b><br>IEC NO. UAU2014-0981<br>DRAWN: JIZELSKI 2015/04/03<br>CHKD:<br>APPR: VKOSHY<br>REV DESCRIPTION 2015/04/17 | QUALITY SYMBOLS<br>∇=0<br>∇=0<br>∇=0                                                                                          | GENERAL TOLERANCES (UNLESS SPECIFIED)<br>mm INCH<br>4 PLACES ± --- ± ---<br>3 PLACES ± --- ± ---<br>2 PLACES ± 0.10 ± ---<br>1 PLACE ± 0.3 ± ---<br>0 PLACE ± ± ---<br>ANGULAR ± 3 °<br>DRAFT WHERE APPLICABLE MUST REMAIN WITHIN DIMENSIONS | DIMENSION STYLE<br>MM ONLY<br>DRAWN BY DATE<br>DGRIFITHS 06-05-03<br>CHECKED BY DATE<br>DGRIFITHS 06-05-03<br>APPROVED BY DATE<br>VKOSHY 2010/03/04 | SCALE<br>4:1<br>DESIGN UNITS<br>METRIC<br>THIRD ANGLE PROJECTION | TITLE<br>MX150 2X3 RECEPTACLE SEALED ASSEMBLY MAT SEAL<br><b>molex</b> | MATERIAL NO.<br>SEE BOM | DOCUMENT NO.<br>SD-33472-061 | SHEET NO.<br>5 OF 9 |
|                                                                                                                                       | THIS DRAWING CONTAINS INFORMATION THAT IS PROPRIETARY TO MOLEX INCORPORATED AND SHOULD NOT BE USED WITHOUT WRITTEN PERMISSION |                                                                                                                                                                                                                                              |                                                                                                                                                     |                                                                  |                                                                        |                         |                              |                     |

19 18 17 16 15 14 13 12 11 10 9 8 7 6 5 4 3 2 1

20 19 18 17 16 15 14 13 12 11 10 9 8 7 6 5 4 3 2 1

BACKSHELL CONFIGURATIONS

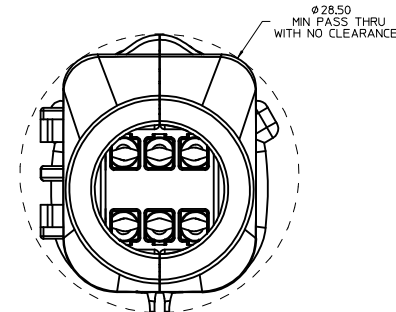
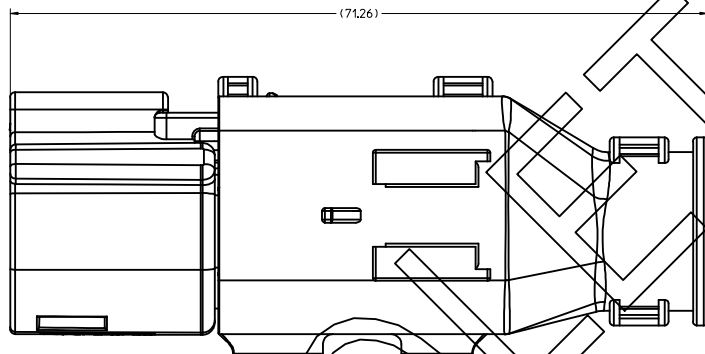

RECEPTACLE SEALED ASSEMBLY WITH RECEPTACLE BACKSHELL

OBSOLETE  
SEE SD-33472-0001  
LATEST REV.

| <b>ENTER DESCRIPTION</b><br>IEC NO. UAU2014-0981<br>DRAWN: JIZELSKI 2015/04/03<br>CHKD:<br>APPR: VKOSHY<br>REV. DESCRIPTION 2015/04/17 | <b>QUALITY SYMBOLS</b><br>∇=0<br>∇=0<br>∇=0 |        | <b>GENERAL TOLERANCES (UNLESS SPECIFIED)</b><br><table border="1"> <thead> <tr> <th></th> <th>mm</th> <th>INCH</th> </tr> </thead> <tbody> <tr> <td>4 PLACES</td> <td>± .10</td> <td>± .004</td> </tr> <tr> <td>3 PLACES</td> <td>± .15</td> <td>± .005</td> </tr> <tr> <td>2 PLACES</td> <td>± 0.10</td> <td>± .004</td> </tr> <tr> <td>1 PLACE</td> <td>± 0.3</td> <td>± .012</td> </tr> <tr> <td>0 PLACE</td> <td>±</td> <td>±</td> </tr> </tbody> </table> |                                                               |              | mm                                  | INCH | 4 PLACES | ± .10 | ± .004 | 3 PLACES | ± .15 | ± .005 | 2 PLACES | ± 0.10 | ± .004 | 1 PLACE | ± 0.3 | ± .012 | 0 PLACE | ± | ± | <b>DIMENSION STYLE</b><br>MM ONLY | <b>SCALE</b><br>4:1 | <b>DESIGN UNITS</b><br>METRIC | THIRD ANGLE PROJECTION |
|----------------------------------------------------------------------------------------------------------------------------------------|---------------------------------------------|--------|----------------------------------------------------------------------------------------------------------------------------------------------------------------------------------------------------------------------------------------------------------------------------------------------------------------------------------------------------------------------------------------------------------------------------------------------------------------|---------------------------------------------------------------|--------------|-------------------------------------|------|----------|-------|--------|----------|-------|--------|----------|--------|--------|---------|-------|--------|---------|---|---|-----------------------------------|---------------------|-------------------------------|------------------------|
|                                                                                                                                        |                                             | mm     | INCH                                                                                                                                                                                                                                                                                                                                                                                                                                                           |                                                               |              |                                     |      |          |       |        |          |       |        |          |        |        |         |       |        |         |   |   |                                   |                     |                               |                        |
|                                                                                                                                        | 4 PLACES                                    | ± .10  | ± .004                                                                                                                                                                                                                                                                                                                                                                                                                                                         |                                                               |              |                                     |      |          |       |        |          |       |        |          |        |        |         |       |        |         |   |   |                                   |                     |                               |                        |
|                                                                                                                                        | 3 PLACES                                    | ± .15  | ± .005                                                                                                                                                                                                                                                                                                                                                                                                                                                         |                                                               |              |                                     |      |          |       |        |          |       |        |          |        |        |         |       |        |         |   |   |                                   |                     |                               |                        |
| 2 PLACES                                                                                                                               | ± 0.10                                      | ± .004 |                                                                                                                                                                                                                                                                                                                                                                                                                                                                |                                                               |              |                                     |      |          |       |        |          |       |        |          |        |        |         |       |        |         |   |   |                                   |                     |                               |                        |
| 1 PLACE                                                                                                                                | ± 0.3                                       | ± .012 |                                                                                                                                                                                                                                                                                                                                                                                                                                                                |                                                               |              |                                     |      |          |       |        |          |       |        |          |        |        |         |       |        |         |   |   |                                   |                     |                               |                        |
| 0 PLACE                                                                                                                                | ±                                           | ±      |                                                                                                                                                                                                                                                                                                                                                                                                                                                                |                                                               |              |                                     |      |          |       |        |          |       |        |          |        |        |         |       |        |         |   |   |                                   |                     |                               |                        |
| ANGULAR ± 3 °<br>DRAFT WHERE APPLICABLE MUST REMAIN WITHIN DIMENSIONS                                                                  |                                             |        | DRAWN BY: DGRIFITHS<br>DATE: 06-05-03<br>CHECKED BY: DGRIFITHS<br>DATE: 06-05-03<br>APPROVED BY: VKOSHY<br>DATE: 2010/03/04                                                                                                                                                                                                                                                                                                                                    | <b>TITLE</b><br>MX150 2X3 RECEPTACLE SEALED ASSEMBLY MAT SEAL |              | <b>DOCUMENT NO.</b><br>SD-33472-061 |      |          |       |        |          |       |        |          |        |        |         |       |        |         |   |   |                                   |                     |                               |                        |
| MATERIAL NO. SEE BOM                                                                                                                   |                                             |        | SHEET NO. 6 OF 9                                                                                                                                                                                                                                                                                                                                                                                                                                               |                                                               | <b>molex</b> |                                     |      |          |       |        |          |       |        |          |        |        |         |       |        |         |   |   |                                   |                     |                               |                        |
| THIS DRAWING CONTAINS INFORMATION THAT IS PROPRIETARY TO MOLEX INCORPORATED AND SHOULD NOT BE USED WITHOUT WRITTEN PERMISSION          |                                             |        |                                                                                                                                                                                                                                                                                                                                                                                                                                                                |                                                               |              |                                     |      |          |       |        |          |       |        |          |        |        |         |       |        |         |   |   |                                   |                     |                               |                        |

19 18 17 16 15 14 13 12 11 10 9 8 7 6 5 4 3 2 1

| ASSEMBLY DESCRIPTION            | ASSEMBLY PART NUMBER | A | B | C | D | C | D | C | D | C | D | C | D | C | D | 1 | 2 | 3 | 4 | 5 | 6 | STATUS          | COMMENTS               | BACKSHELL WITH RIBS | BACKSHELL WITHOUT RIBS |
|---------------------------------|----------------------|---|---|---|---|---|---|---|---|---|---|---|---|---|---|---|---|---|---|---|---|-----------------|------------------------|---------------------|------------------------|
| VOID KEY                        | 33472-0640           |   |   |   |   |   |   |   |   |   |   |   |   |   |   |   |   |   |   |   |   |                 |                        |                     |                        |
| KEY D, GREEN                    | 33472-0639           |   |   |   | D |   |   |   |   |   |   |   |   |   |   |   |   |   |   |   |   | NOT RECOMMENDED |                        | 34951-0610          | 34951-0620             |
| KEY C, BROWN                    | 33472-0638           |   |   |   | C |   |   |   |   |   |   |   |   |   |   |   |   |   |   |   |   | NOT RECOMMENDED |                        | 34951-0610          | 34951-0620             |
| KEY B, LIGHT GRAY               | 33472-0637           |   |   |   | B |   |   |   |   |   |   |   |   |   |   |   |   |   |   |   |   | NOT RECOMMENDED |                        | 34951-0610          | 34951-0620             |
| KEY A, BLACK                    | 33472-0636           |   |   |   | A |   |   |   |   |   |   |   |   |   |   |   |   |   |   |   |   | SALEABLE        |                        | 34951-0610          | 34951-0620             |
| VOID KEY                        | 33472-0635           |   |   |   |   |   |   |   |   |   |   |   |   |   |   |   |   |   |   |   |   |                 |                        |                     |                        |
| KEY D, W/O MAT SEAL, GREEN      | 33472-0634           |   |   |   | D |   |   |   |   |   |   |   |   |   |   |   |   |   |   |   |   | NOT RECOMMENDED | NOT VALIDATED          | 34951-0610          | 34951-0620             |
| KEY C, W/O MAT SEAL, BROWN      | 33472-0633           |   |   |   | C |   |   |   |   |   |   |   |   |   |   |   |   |   |   |   |   | NOT RECOMMENDED | NOT VALIDATED          | 34951-0610          | 34951-0620             |
| KEY B, W/O MAT SEAL, LIGHT GRAY | 33472-0632           |   |   |   | B |   |   |   |   |   |   |   |   |   |   |   |   |   |   |   |   | NOT RECOMMENDED | NOT VALIDATED          | 34951-0610          | 34951-0620             |
| KEY A, W/O MAT SEAL, BLACK      | 33472-0631           |   |   |   | A |   |   |   |   |   |   |   |   |   |   |   |   |   |   |   |   | NOT RECOMMENDED | NOT VALIDATED          | 34951-0610          | 34951-0620             |
| VOID KEY                        | 33472-0630           |   |   |   |   |   |   |   |   |   |   |   |   |   |   |   |   |   |   |   |   |                 |                        |                     |                        |
| KEY D, W/ CPA, GREEN            | 33472-0629           |   |   |   | D |   |   |   |   |   |   |   |   |   |   |   |   |   |   |   |   | NOT RECOMMENDED |                        | 34951-0610          | 34951-0620             |
| KEY C, W/ CPA, BROWN            | 33472-0628           |   |   |   | C |   |   |   |   |   |   |   |   |   |   |   |   |   |   |   |   | NOT RECOMMENDED |                        | 34951-0610          | 34951-0620             |
| KEY B, W/ CPA, LIGHT GRAY       | 33472-0627           |   |   |   | B |   |   |   |   |   |   |   |   |   |   |   |   |   |   |   |   | NOT RECOMMENDED |                        | 34951-0610          | 34951-0620             |
| KEY A, W/ CPA, BLACK            | 33472-0626           |   |   |   | A |   |   |   |   |   |   |   |   |   |   |   |   |   |   |   |   | SALEABLE        |                        | 34951-0610          | 34951-0620             |
| VOID KEY                        | 33472-0625           |   |   |   |   |   |   |   |   |   |   |   |   |   |   |   |   |   |   |   |   |                 |                        |                     |                        |
| KEY D, GREEN                    | 33472-0624           |   |   |   | D |   |   |   |   |   |   |   |   |   |   |   |   |   |   |   |   | NOT RECOMMENDED |                        | 34951-0610          | 34951-0620             |
| KEY C, BROWN                    | 33472-0623           |   |   |   | C |   |   |   |   |   |   |   |   |   |   |   |   |   |   |   |   | NOT RECOMMENDED |                        | 34951-0610          | 34951-0620             |
| KEY B, LIGHT GRAY               | 33472-0622           |   |   |   | B |   |   |   |   |   |   |   |   |   |   |   |   |   |   |   |   | NOT RECOMMENDED |                        | 34951-0610          | 34951-0620             |
| KEY A, BLACK                    | 33472-0621           |   |   |   | A |   |   |   |   |   |   |   |   |   |   |   |   |   |   |   |   | SALEABLE        |                        | 34951-0610          | 34951-0620             |
| VOID KEY                        | 33472-0620           |   |   |   |   |   |   |   |   |   |   |   |   |   |   |   |   |   |   |   |   |                 |                        |                     |                        |
| KEY D, W/ CPA, GREEN            | 33472-0619           |   |   |   | D |   |   |   |   |   |   |   |   |   |   |   |   |   |   |   |   | NOT RECOMMENDED |                        | 34951-0610          | 34951-0620             |
| KEY C, W/ CPA, BROWN            | 33472-0618           |   |   |   | C |   |   |   |   |   |   |   |   |   |   |   |   |   |   |   |   | NOT RECOMMENDED |                        | 34951-0610          | 34951-0620             |
| KEY B, W/ CPA, LIGHT GRAY       | 33472-0617           |   |   |   | B |   |   |   |   |   |   |   |   |   |   |   |   |   |   |   |   | NOT RECOMMENDED |                        | 34951-0610          | 34951-0620             |
| KEY A, W/ CPA, BLACK            | 33472-0616           |   |   |   | A |   |   |   |   |   |   |   |   |   |   |   |   |   |   |   |   | SALEABLE        |                        | 34951-0610          | 34951-0620             |
| VOID KEY                        | 33472-0615           |   |   |   |   |   |   |   |   |   |   |   |   |   |   |   |   |   |   |   |   |                 |                        |                     |                        |
| KEY D, GREEN                    | 33472-0614           |   |   |   | D |   |   |   |   |   |   |   |   |   |   |   |   |   |   |   |   | NOT RECOMMENDED |                        | 34951-0610          | 34951-0620             |
| KEY C, BROWN                    | 33472-0613           |   |   |   | C |   |   |   |   |   |   |   |   |   |   |   |   |   |   |   |   | NOT RECOMMENDED |                        | 34951-0610          | 34951-0620             |
| KEY B, LIGHT GRAY               | 33472-0612           |   |   |   | B |   |   |   |   |   |   |   |   |   |   |   |   |   |   |   |   | NOT RECOMMENDED |                        | 34951-0610          | 34951-0620             |
| KEY A, BLACK                    | 33472-0611           |   |   |   | A |   |   |   |   |   |   |   |   |   |   |   |   |   |   |   |   | SALEABLE        | SAME AS P/N 33472-0658 | 34951-0610          | 34951-0620             |
| VOID KEY                        | 33472-0610           |   |   |   |   |   |   |   |   |   |   |   |   |   |   |   |   |   |   |   |   |                 |                        |                     |                        |
| KEY D, W/ CPA, GREEN            | 33472-0609           |   |   |   | D |   |   |   |   |   |   |   |   |   |   |   |   |   |   |   |   | NOT RECOMMENDED | SEE P/N 33472-0671     | 34951-0610          | 34951-0620             |
| KEY C, W/ CPA, BROWN            | 33472-0608           |   |   |   | C |   |   |   |   |   |   |   |   |   |   |   |   |   |   |   |   | NOT RECOMMENDED | SEE P/N 33472-0670     | 34951-0610          | 34951-0620             |
| KEY B, W/ CPA, LIGHT GRAY       | 33472-0607           |   |   |   | B |   |   |   |   |   |   |   |   |   |   |   |   |   |   |   |   | NOT RECOMMENDED |                        | 34951-0610          | 34951-0620             |
| KEY A, W/ CPA, BLACK            | 33472-0606           |   |   |   | A |   |   |   |   |   |   |   |   |   |   |   |   |   |   |   |   | SALEABLE        |                        | 34951-0610          | 34951-0620             |
| VOID KEY                        | 33472-0605           |   |   |   |   |   |   |   |   |   |   |   |   |   |   |   |   |   |   |   |   |                 |                        |                     |                        |
| KEY D, GREEN                    | 33472-0604           |   |   |   | D |   |   |   |   |   |   |   |   |   |   |   |   |   |   |   |   | NOT RECOMMENDED | SEE P/N 33472-0669     | 34951-0610          | 34951-0620             |
| KEY C, BROWN                    | 33472-0603           |   |   |   | C |   |   |   |   |   |   |   |   |   |   |   |   |   |   |   |   | NOT RECOMMENDED | SEE P/N 33472-0668     | 34951-0610          | 34951-0620             |
| KEY B, LIGHT GRAY               | 33472-0602           |   |   |   | B |   |   |   |   |   |   |   |   |   |   |   |   |   |   |   |   | NOT RECOMMENDED |                        | 34951-0610          | 34951-0620             |
| KEY A, BLACK                    | 33472-0601           |   |   |   | A |   |   |   |   |   |   |   |   |   |   |   |   |   |   |   |   | SALEABLE        |                        | 34951-0610          | 34951-0620             |
| ASSEMBLY DESCRIPTION            | ASSEMBLY PART NUMBER | A | B | C | D | C | D | C | D | C | D | C | D | C | D | 1 | 2 | 3 | 4 | 5 | 6 | STATUS          | COMMENTS               | BACKSHELL WITH RIBS | BACKSHELL WITHOUT RIBS |

| DESCRIPTION             | COLOR        | MATERIAL                       |
|-------------------------|--------------|--------------------------------|
| RING SEAL               | BURNT ORANGE | INHERENTLY LUBRICATED SILICONE |
| PLR                     | NATURAL      | SPS/NYLON GF20                 |
| GROMMET CAP             | BLACK        | SPS/NYLON GF20                 |
| MAT SEAL                | LIGHT BLUE   | INHERENTLY LUBRICATED SILICONE |
| CPA                     | RED          | PBT GF30                       |
| HOUSING KEYING OPTION D | STONE GRAY   | SPS/NYLON GF20                 |
| HOUSING KEYING OPTION C | DARK GRAY    | SPS/NYLON GF20                 |
| HOUSING KEYING OPTION B | GREEN        | SPS/NYLON GF20                 |
| HOUSING KEYING OPTION A | BROWN        | SPS/NYLON GF20                 |
| HOUSING KEYING OPTION Z | LIGHT GRAY   | SPS/NYLON GF20                 |
| HOUSING KEYING OPTION Y | BLACK        | SPS/NYLON GF20                 |

BOM/APPLICABLE COMPONENTS TABLE

| ABBREVIATION | COMPONENT     |
|--------------|---------------|
| A            | HOUSING KEY A |
| B            | HOUSING KEY B |
| C            | HOUSING KEY C |
| D            | HOUSING KEY D |
| GC           | GROMMET CAP   |
| M            | MAT SEAL      |
| R            | RING SEAL     |
| P            | PLR, STANDARD |
| CPA          | CPA           |
| BKS          | BACKSHELL     |

|                                                                                                                      |                                             |                                                                                                                                                           |                            |                                                            |                                                        |
|----------------------------------------------------------------------------------------------------------------------|---------------------------------------------|-----------------------------------------------------------------------------------------------------------------------------------------------------------|----------------------------|------------------------------------------------------------|--------------------------------------------------------|
| <b>ENTER DESCRIPTION</b><br>IEC NO. UAU2014-0981<br>DRAWN: ZUZELSKI 2015/04/03<br>CHKD: Y<br>APPR: VKOSHY 2015/04/17 | <b>QUALITY SYMBOLS</b><br>∇=0<br>∇=0<br>∇=0 | GENERAL TOLERANCES (UNLESS SPECIFIED)<br>mm      INCH<br>4 PLACES ±      ±<br>3 PLACES ±      ±<br>2 PLACES ±0.10 ±<br>1 PLACE ±0.3 ±<br>0 PLACE ±      ± | DIMENSION STYLE<br>MM ONLY | SCALE<br>DESIGN UNITS<br>METRIC                            | THIRD ANGLE PROJECTION                                 |
|                                                                                                                      |                                             | DRAFT WHERE APPLICABLE MUST REMAIN WITHIN DIMENSIONS                                                                                                      | MATERIAL NO.<br>SEE BOM    | DATE<br>06-05-03<br>DATE<br>06-05-03<br>DATE<br>2010/03/04 | TITLE<br>MX150 2X3 RECEPTACLE SEALED ASSEMBLY MAT SEAL |





| ASSEMBLY DESCRIPTION                                     | ASSEMBLY PART NUMBER | A | B | C | D | E | F | G | H | I | J | K | L | M | N | O | P | STATUS                               | COMMENTS | BACKSHELL WITH RIBS | BACKSHELL WITHOUT RIBS |
|----------------------------------------------------------|----------------------|---|---|---|---|---|---|---|---|---|---|---|---|---|---|---|---|--------------------------------------|----------|---------------------|------------------------|
| KEY A, W/CPA, BLACK                                      | 33472-0692           | A |   |   |   |   |   |   |   |   |   |   |   |   |   |   |   | SALEABLE                             |          | 34951-0610          | 34951-0620             |
| KEY A, W/CPA, BLACK                                      | 33472-0691           | A |   |   |   |   |   |   |   |   |   |   |   |   |   |   |   | SALEABLE                             |          | 34951-0610          | 34951-0620             |
| KEY B, W/CPA, LIGHT GRAY                                 | 33472-0690           | B |   |   |   |   |   |   |   |   |   |   |   |   |   |   |   | SALEABLE                             |          | 34951-0610          | 34951-0620             |
| KEY A, W/CPA, BLACK                                      | 33472-0689           | A |   |   |   |   |   |   |   |   |   |   |   |   |   |   |   | SALEABLE                             |          | 34951-0610          | 34951-0620             |
| KEY A, W/CPA, BLACK                                      | 33472-0688           | A |   |   |   |   |   |   |   |   |   |   |   |   |   |   |   | SALEABLE                             |          | 34951-0610          | 34951-0620             |
| KEY A, BLACK                                             | 33472-0687           | A |   |   |   |   |   |   |   |   |   |   |   |   |   |   |   | SALEABLE                             |          | 34951-0610          | 34951-0620             |
| KEY B, W/CPA, LIGHT GRAY                                 | 33472-0686           | B |   |   |   |   |   |   |   |   |   |   |   |   |   |   |   | SALEABLE                             |          | 34951-0610          | 34951-0620             |
| KEY B, W/CPA, LIGHT GRAY                                 | 33472-0685           | B |   |   |   |   |   |   |   |   |   |   |   |   |   |   |   | SALEABLE                             |          | 34951-0610          | 34951-0620             |
| KEY A, W/CPA, BLACK                                      | 33472-0684           | A |   |   |   |   |   |   |   |   |   |   |   |   |   |   |   | SALEABLE                             |          | 34951-0610          | 34951-0620             |
| KEY A, BLACK                                             | 33472-0683           | A |   |   |   |   |   |   |   |   |   |   |   |   |   |   |   | SALEABLE                             |          | 34951-0610          | 34951-0620             |
| KEY A, W/CPA, YELLOW                                     | 33472-0682           | A |   |   |   |   |   |   |   |   |   |   |   |   |   |   |   | SALEABLE                             |          | 34951-0610          | 34951-0620             |
| ASSEMBLY DESCRIPTION                                     | ASSEMBLY PART NUMBER | A | B | C | D | E | F | G | H | I | J | K | L | M | N | O | P | STATUS                               | COMMENTS | BACKSHELL WITH RIBS | BACKSHELL WITHOUT RIBS |
| BLOCKED TERMINAL                                         |                      |   |   |   |   |   |   |   |   |   |   |   |   |   |   |   |   |                                      |          |                     |                        |
| CAVITY WITH A NUMBER INDICATES BLOCKED TERMINAL POSITION |                      |   |   |   |   |   |   |   |   |   |   |   |   |   |   |   |   | OPTIONAL ATTACHMENTS SOLD SEPARATELY |          |                     |                        |
| CAVITY WITHOUT A NUMBER INDICATES OPEN TERMINAL POSITION |                      |   |   |   |   |   |   |   |   |   |   |   |   |   |   |   |   |                                      |          |                     |                        |

| DESCRIPTION             | COLOR        | MATERIAL                       |
|-------------------------|--------------|--------------------------------|
| RING SEAL               | BURNT ORANGE | INHERENTLY LUBRICATED SILICONE |
| PLR                     | NATURAL      | SPS/NYLON GF20                 |
| GROMMET CAP             | BLACK        | SPS/NYLON GF20                 |
| MAT SEAL                | LIGHT BLUE   | INHERENTLY LUBRICATED SILICONE |
| CPA                     | RED          | PBT GF30                       |
| HOUSING KEYING OPTION A | YELLOW       | SPS/NYLON GF20                 |
| HOUSING KEYING OPTION D | STONE GRAY   | SPS/NYLON GF20                 |
| HOUSING KEYING OPTION C | DARK GRAY    | SPS/NYLON GF20                 |
| HOUSING KEYING OPTION D | GREEN        | SPS/NYLON GF20                 |
| HOUSING KEYING OPTION C | BROWN        | SPS/NYLON GF20                 |
| HOUSING KEYING OPTION B | LIGHT GRAY   | SPS/NYLON GF20                 |
| HOUSING KEYING OPTION A | BLACK        | SPS/NYLON GF20                 |
| DESCRIPTION             | COLOR        | MATERIAL                       |

BOM/APPLICABLE COMPONENTS TABLE

OBC SEE LATEST

0001

|                                                                                                                            |                                                                                                                         |                                                                                                                                                                                                                                                                |                                                                                                                               |              |                                                                        |                        |
|----------------------------------------------------------------------------------------------------------------------------|-------------------------------------------------------------------------------------------------------------------------|----------------------------------------------------------------------------------------------------------------------------------------------------------------------------------------------------------------------------------------------------------------|-------------------------------------------------------------------------------------------------------------------------------|--------------|------------------------------------------------------------------------|------------------------|
| <b>ENTER DESCRIPTION</b><br>IEC NO. UAU2014-0981<br>DRAWN: JIZELSKI 2015/04/03<br>CHKD:<br>APPR: VKOSHY 2015/04/17<br>REV: | QUALITY SYMBOLS<br>∇=0<br>∇=0<br>∇=0                                                                                    | GENERAL TOLERANCES (UNLESS SPECIFIED)<br>mm INCH<br>4 PLACES ± 0.10 ± 0.004<br>3 PLACES ± 0.15 ± 0.005<br>2 PLACES ± 0.20 ± 0.008<br>1 PLACE ± 0.30 ± 0.012<br>0 PLACE ± 0.50 ± 0.020<br>ANGULAR ± 3 °<br>DRAFT WHERE APPLICABLE MUST REMAIN WITHIN DIMENSIONS | DIMENSION STYLE<br>MM ONLY                                                                                                    | SCALE<br>4:1 | DESIGN UNITS<br>METRIC                                                 | THIRD ANGLE PROJECTION |
|                                                                                                                            | DRAWN BY DATE<br>DGRIF ITHS 06-05-03<br>CHECKED BY DATE<br>DGRIF ITHS 06-05-03<br>APPROVED BY DATE<br>VKOSHY 2010/03/04 |                                                                                                                                                                                                                                                                | MATERIAL NO. 999999999<br>DOCUMENT NO. SD-33472-061                                                                           |              | TITLE<br>MX150 2X3 RECEPTACLE SEALED ASSEMBLY MAT SEAL<br><b>molex</b> |                        |
|                                                                                                                            | SHEET NO. 9 OF 9                                                                                                        |                                                                                                                                                                                                                                                                | THIS DRAWING CONTAINS INFORMATION THAT IS PROPRIETARY TO MOLEX INCORPORATED AND SHOULD NOT BE USED WITHOUT WRITTEN PERMISSION |              |                                                                        |                        |