

TECHNICAL SPECIFICATIONS

Material: UL 94 V-0 Plastic Material
Operating Temperature: -55°C to +110°C
Cable Entry: Top Entry
Cable O.D: Up to 9mm
Colour: Black
Jackscrew: UNC 4-40
 Male or Female Version

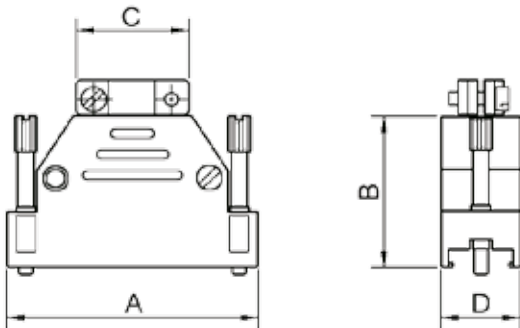
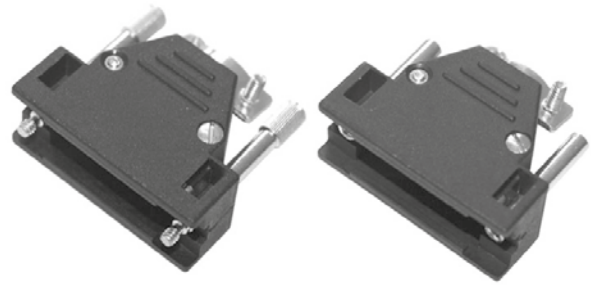

Features:

- Suitable for sizes 9, 15, 25 and 37
- Easy to re-open
- Male or female Jackscrew

Size	A	B	C	D	E
9	31,4	24,0	14,5	38,0	18,2
15	42,0	30,0	14,5	38,0	18,2
25	55,5	36,0	25,1	38,0	18,2
37	69,8	38,0	39,2	38,0	18,2

Ordering information: Male Jackscrew

Size:	P/N - Kitted:	Product Code:
9-way, Male JS	2801-0102-01	MHED-D09T-K
15-way, Male JS	2801-0102-02	MHED-D15T-K
25-way, Male JS	2801-0102-03	MHED-D25T-K
37-way, Male JS	2801-0102-04	MHED-D37T-K

Ordering information: Female Jackscrew

Size:	P/N - Kitted:	Product Code:
9-way, Female JS	2801-0102-11	MHED-D09TF-K
15-way, Female JS	2801-0102-12	MHED-D15TF-K
25-way, Female JS	2801-0102-13	MHED-D25TF-K
37-way, Female JS	2801-0102-14	MHED-D37TF-K