

**Fuse-holder
Terminal blocks**
for 5 x 20 mm and 5 x 25 mm fuses
EN 50045 (DIN 46277 /2) rail
**Compression clamp - Compression
clamp**
DIN 2

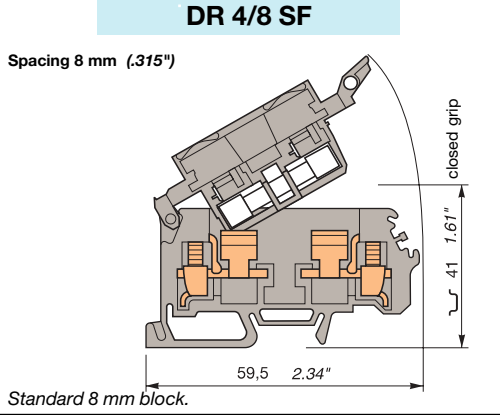

End stop th. 6,5 mm **BADRL** 0199 420.21
Rail 15 x 5 x 1 **PR2** 0101 673.00
Other accessories: See Accessories section

Notes

Some accessories can decrease the block's voltage rating.

This block can be equipped with blown fuse indicator (24, 48, 115, 230, and 400 V rating).

Consult us for information.

Accessories

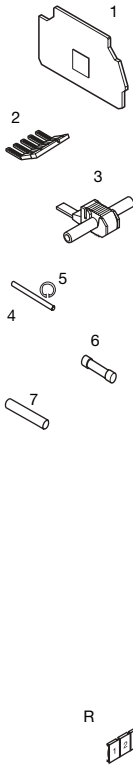

1	End section	grey
2	Comb-type jumper bar	
3	IDC jumper	
4	Assembly rod	
5	Assembly ring	
6	5 x 20 fuses - 250 V	
	5 x 25 fuses - 250 V	
7	Disconnect link bar	
R	See section on markers marking method	

--	--

Color	Type	Part number	Color	Type	Part number
Grey	DR 4/8 SF	0110 368.12			

Characteristics

Wire size	Wire size			
	IEC NFC DIN	UL	CSA	
Screw	Solid	0,5-4 mm ²	22-12 AWG	18-12 AWG
	Stranded	0,5-4 mm ²	22-12 AWG	18-12 AWG

Voltage			
Rated	630 V (1)	600 V	300 V
Pulse	8 kV		
Pollution degree	3		

Current			
Rated	6,3 A	6,3 A	6,3 A

Wire size			
Rated / Gauge	4 mm ² / A4	12 AWG	12 AWG
Wire stripping length	Recomm. screwdriver 4 mm	Recomm. torque 0,5-0,8 Nm	Protection IP 20
	.37"	4.4-7.1 lb.in	NEMA 1 (2)

Characteristics

Wire size	Wire size		
	IEC NFC DIN	UL	CSA
Screw	Solid		
	Stranded		

Voltage			
Rated			
Pulse			
Pollution degree			

Current			
Rated			

Wire size			
Rated/gauge			
Wire stripping length	Recomm. screwdriver	Recomm. torque	Protection

Type	Part number	Type	Part number
FEM8S	th. 1,5 mm 0116 951.15		
PC81	35 A 10 poles 0173 523.11		
AD 2,5	0114 205.20		
TGA8	2 poles 0168 672.11		
TGA8	3 poles 0168 673.12		
TGA8	4 poles 0168 674.13		
ANT	0168 675.14		
FU520	0,5 A 0008 288.15		
FU520	1 A 0008 290.13		
FU520	2 A 0008 291.00		
FU520	3,15 A 0008 289.16		
FU520	5 A 0008 292.01		
FU525	0,5 A 0167 546.22		
FU525	2 A 0167 547.23		
FU525	2,5 A 0167 548.04		
FU525	4 A 0167 549.05		
FU525	6,3 A 0167 550.02		
CN5	0179 371.16		

(6) RC610 on top (11) RC810 block side

(1) Terminal block insulation voltage. Working voltage in accordance with fuse rating.
(2) Available for fuse terminal block.