

61083-AA B C D E G W V F F

AA	NO. OF POSITIONS
02	2X10
04	2X20
06	2X30
08	2X40
10	2X50
12	2X60
14	2X70
16	2X80
18	2X90
20	2X100

NOTE 10

G	DATE CODE
/	STANDARD, NOT PRINT D/C
P	PRINT DATE CODE

W	TRANSPORT CODE
/	NOT MANDATORY
W	FOR OCEAN SHIPPING

V	MANDATORY CODE
/	STANDARD, NOT MANDATORY P/N
V	ONLY FOR DEDICATED CUSTOMER
H	ONLY FOR DEDICATED CUSTOMER
L	ONLY FOR DEDICATED CUSTOMER

E	PACKAGING
0	TUBE WITHOUT METAL CAP
2	T&R WITH METAL CAP
9	TUBE WITH METAL CAP
6	T&R WITH KAPTON TAPE
7	T&R WITH PLASTIC CAP
Q	T&R WITHOUT CAP

NOTE 10
NOTE 10
NOTE 11
NOTE 10

D	PEG
0	YES
2	NO

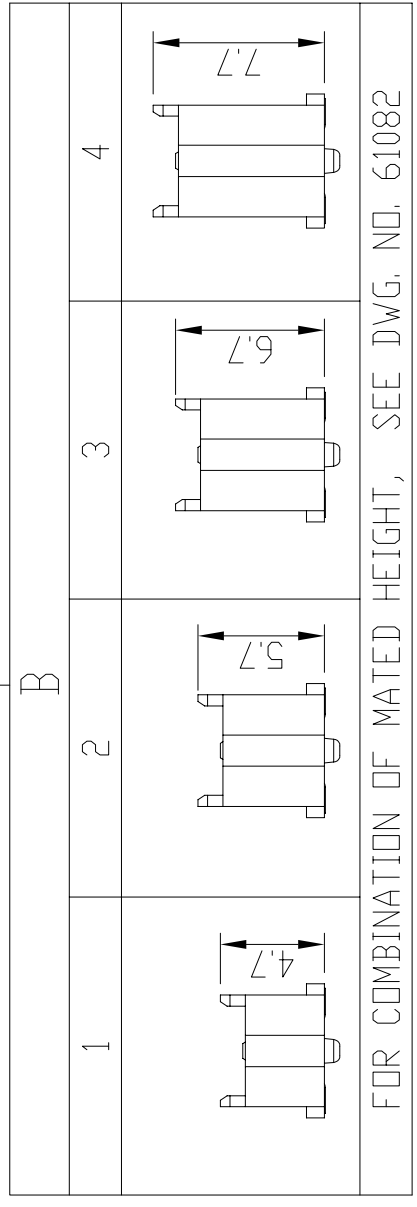

NOTE:

- MATERIAL: HOUSING: G.F. LCP, NATURAL, UL94-V0
TERMINAL: BRASS
- PLATING: AS SHOWN IN TABLE NICKEL UNDERPLATE OVERALL 1.27um.MIN.
- SEE GS-12-547 FOR PRODUCT SPEC.
- PACKAGING OPTION 2: NOT ALL SIZES ARE AVAILABLE, CHECK WITH FACTORY.
- THIS PRODUCT MEETS THE EUROPEAN UNION DIRECTIVES AND OTHER COUNTRY REGULATIONS AS DESCRIBED IN GS-22-008.
- THE HOUSING WILL WITHSTAND EXPOSURE UP TO 260~ PEAK TEMPERATURE FOR 30 SECONDS IN A CONVECTION, INFRA-RED OR VAPOR PHASE REFLOW OVEN.
- PLATING OPTION "4" IS LEADFREE ALTERNATIVE FOR OPTION "D", AND OPTION "6" IS LEADFREE ALTERNATIVE FOR OPTION " 1".
- HIGH PRECISION COPLANARITY IS AVAILABLE FOR 2X80 TO 2X100 POS, ALL HEIGHTS. PLS REFER TO PRINT 10069525.
- THE P/N 61083-***** OR 61083-*****LF NOT PRINT DATE CODE.
THE P/N 61083-*****P OR 61083-*****PLF NEED PRINT DATE CODE.
- POSITION 2X10 TYPE ONLY APPLY TO PLUG 1 AND PLUG 3.
PACKAGING WITH METAL CAP AND PLASTIC CAP DOES NOT APPLY TO 2X10 POSITION.
KAPTON TAPE ONLY APPLY TO POSITION 2X10~2X20.

C	PLATING ON CONTACT AREA / ON SOLDER TAIL AREA	FF
0	GOLD 0.2um MIN ON CONTACT AREA / TIN LEAD 2.5um MIN ON SOLDER TAIL	NONE
1	GOLD FLASH (0.065um MIN) OVER PALLADIUM-NICKEL 0.69um MIN ON CONTACT AREA / TIN LEAD 2.5um MIN ON SOLDER TAIL	NONE
4	GOLD 0.2um MIN ON CONTACT AREA / MATT TIN 2.5um MIN ON SOLDER TAIL	LF
5	GOLD 0.38um MIN ON CONTACT AREA / MATT TIN 2.5um MIN ON SOLDER TAIL	LF
6	GOLD FLASH 0.065um MIN OVER PALLADIUM-NICKEL 0.69um MIN ON CONTACT AREA / MATT TIN 2.5um MIN ON SOLDER TAIL	LF
7	GOLD 0.76um MIN ON CONTACT AREA / MATT TIN 2.5um MIN ON SOLDER TAIL	LF
9	GOLD 0.2um MIN ON CONTACT AREA / GOLD 0.05um MIN ON SOLDER TAIL	LF
B	GOLD 1.27um MIN ON CONTACT AREA / GOLD 0.05~0.25um ON SOLDER TAIL	LF
C	GOLD 1.27um MIN ON CONTACT AREA / MATT TIN 2.5um MIN ON SOLDER TAIL	LF

mat'l. code		surface	tolerance	projection	product family	
ISO 1302	ISO 406	ISO 1101	ISO 1101	BERGSTAK HPL545		
ecn no	dr	date	tolerances unless otherwise specified	angles	linear	
AP ELX-N-33922	Bob	2019-07-05	.0±.2	mm	mm	
AR ELX-N-34967	Bob	2019-09-26	.00±.15	scale 1:1		
AS ELX-N-35593	Bob	2020-01-10	.000±.10	dr	GuoMin Sun	
AL ELX-N-26381	Bob	2017-03-17	2014-10-21	engf	Bob Gu	
AM ELX-N-30796	Bob	2018-05-28	2020-01-10	chr	LQ Lei	
AN ELX-N-30741	Bob	2018-11-22	2020-01-10	appd	Tim Yao	
sheet index	revision	AL	AM	AN	AR	AS
1~6	1~6	1	1	1	1	1

PLUG ASSY
BERGSTAK 0.8MM

dwg no 61083
sheet 1 of 6 size A3
type Product Customer Drawing

1 | 2 | 3 | 4 | 5 | 6

PRODUCT NO.	NO. OF POSITION	DIMENSION		
		A	B	C
61083-021***	2X10	7.2	13.8	12.2
61083-041***	2X20	15.2	21.8	20.2
61083-061***	2X30	23.2	29.8	28.2
61083-081***	2X40	31.2	37.8	36.2
61083-101***	2X50	39.2	45.8	44.2
61083-121***	2X60	47.2	53.8	52.2
61083-141***	2X70	55.2	61.8	60.2
61083-161***	2X80	63.2	69.8	68.2
61083-181***	2X90	71.2	77.8	76.2
61083-201***	2X100	79.2	85.8	84.2

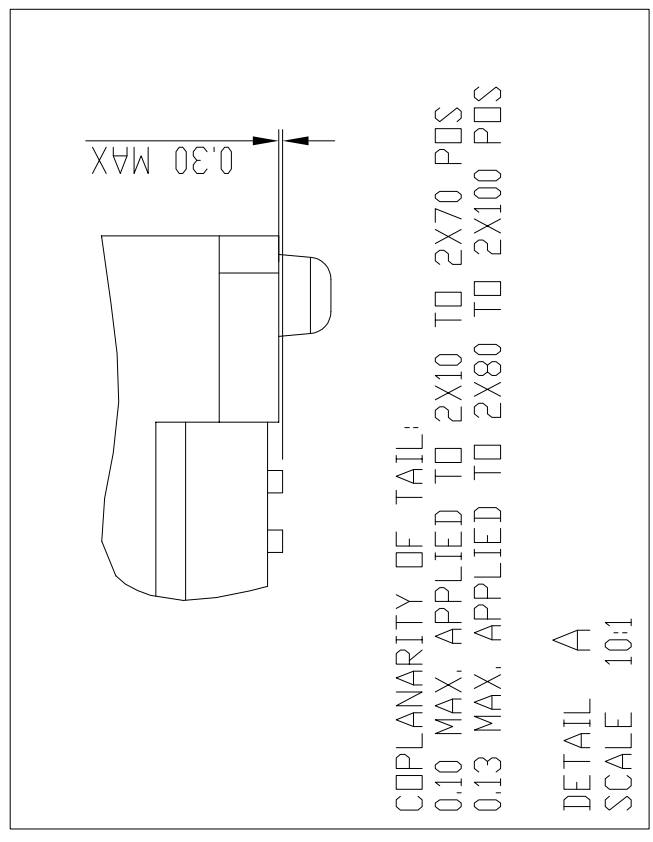
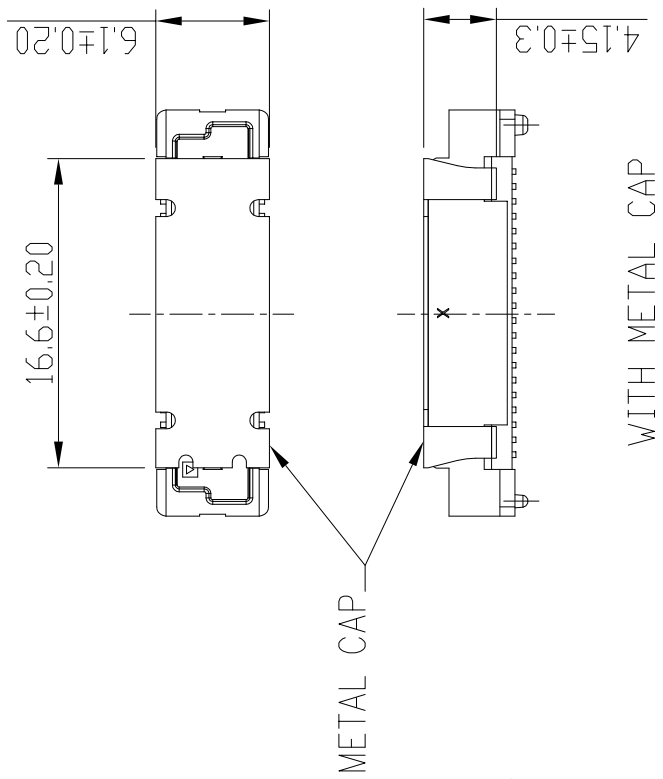
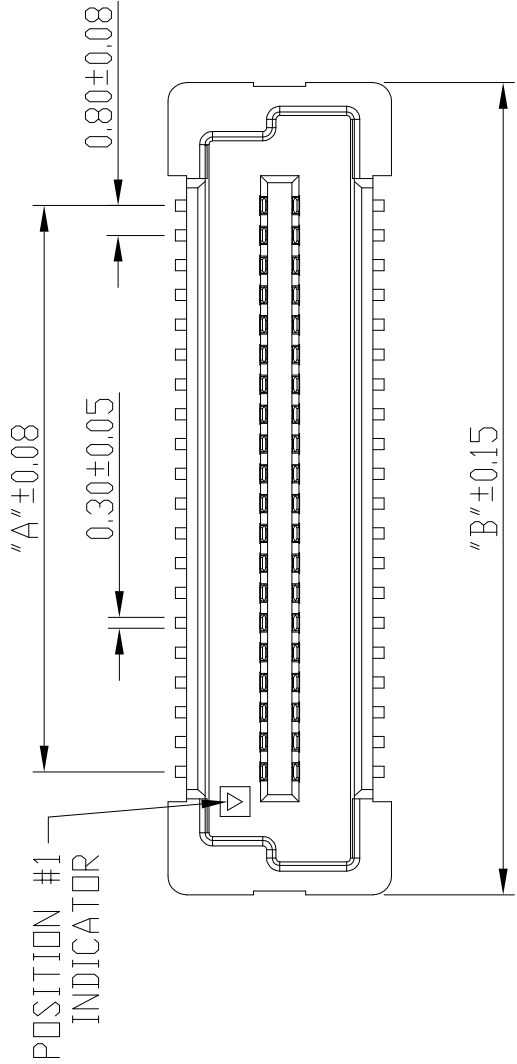

DATE CODE: XXXXXX
 DAY(01~31)
 MONTH(01~12)
 YEAR(00~99)

DETAIL AA

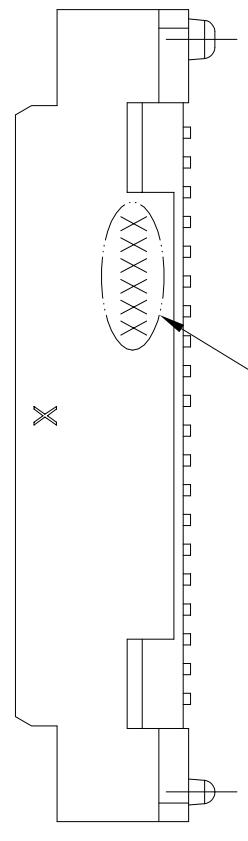
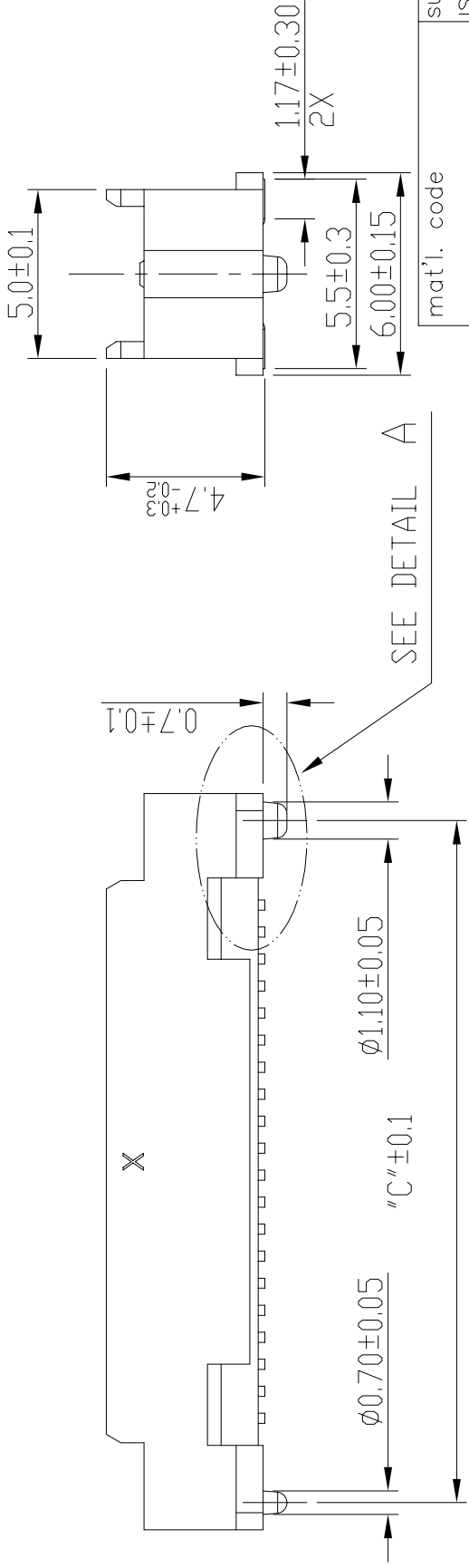

SEE DETAIL AA
 PLUG 1

mat'l. code		surface	tolerance	projection	product family
itr	ecn no dr	ISO 1302	ISO 406	ISO 1101	BERGSTAK HPL545
AS		tolerances unless otherwise specified	linear	mm	
	date	angles	.0±.2		
		0°±3°	.00±.15		
			.000±.10	scale 1:1	
		dr	GuoMin Sun	2014-10-21	dwg no
		engf	Bob Gu	2020-01-10	sheet2 of 6
		chr	LQ Lei	2020-01-10	A3
		appd	Tim Yao	2020-01-10	61083
sheet index	revision	type			
AS	1	Product Customer Drawing			

PLUG ASSY
 BERGSTAK 0.8MM

Amphenol
 FCI



1 2 3 4 5 6

PRODUCT NO.	NO. OF POSITION	DIMENSION		
		A	B	C
61083-042***	2X20	15.2	21.8	20.2
61083-062***	2X30	23.2	29.8	28.2
61083-082***	2X40	31.2	37.8	36.2
61083-102***	2X50	39.2	45.8	44.2
61083-122***	2X60	47.2	53.8	52.2
61083-142***	2X70	55.2	61.8	60.2
61083-162***	2X80	63.2	69.8	68.2
61083-182***	2X90	71.2	77.8	76.2
61083-202***	2X100	79.2	85.8	84.2

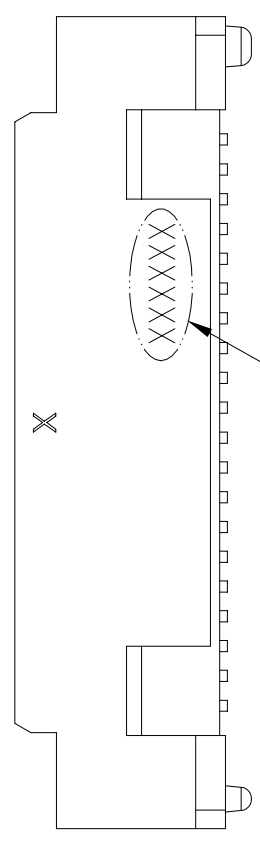
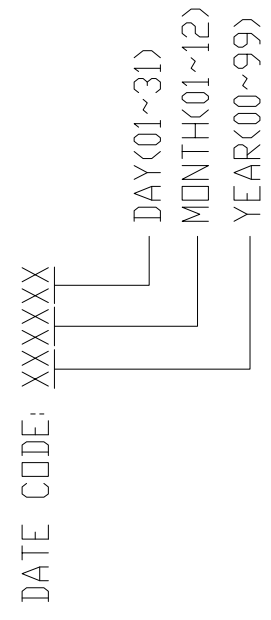
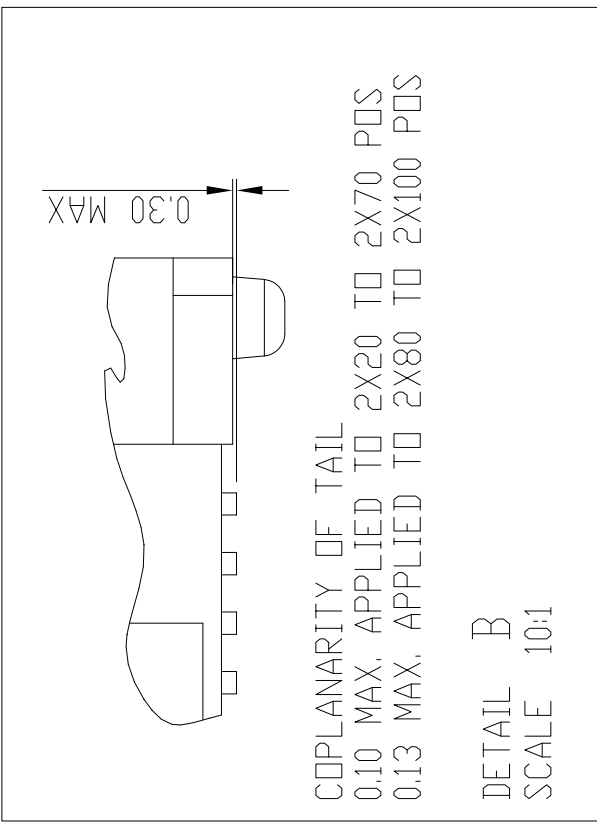
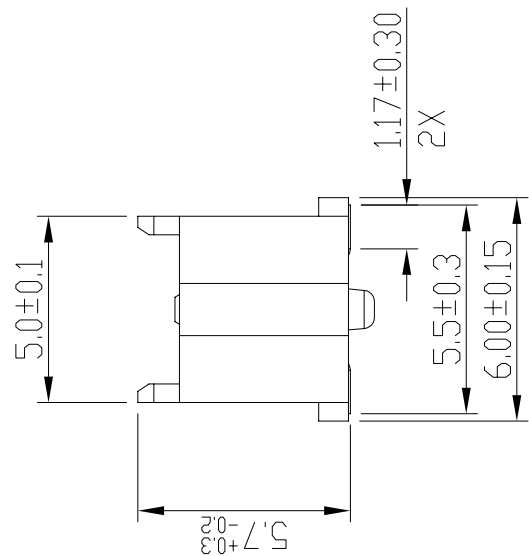
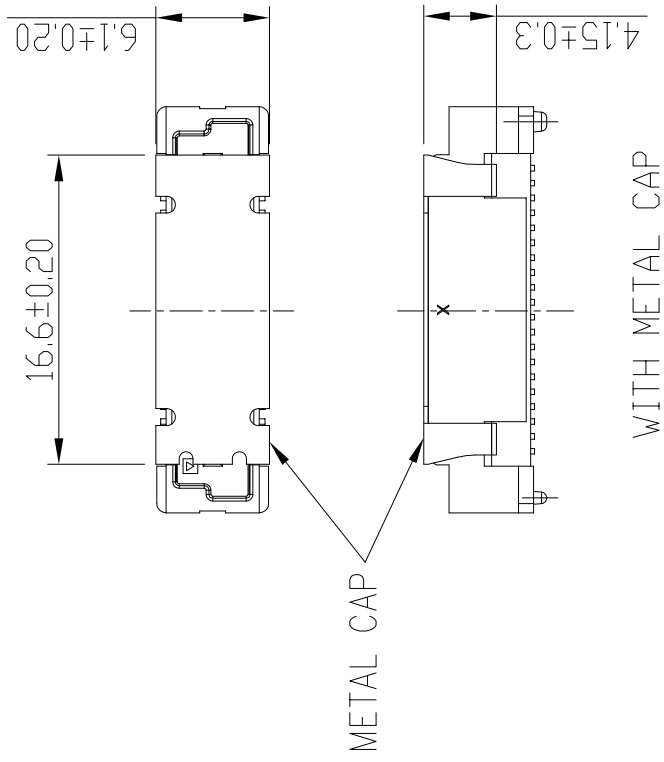
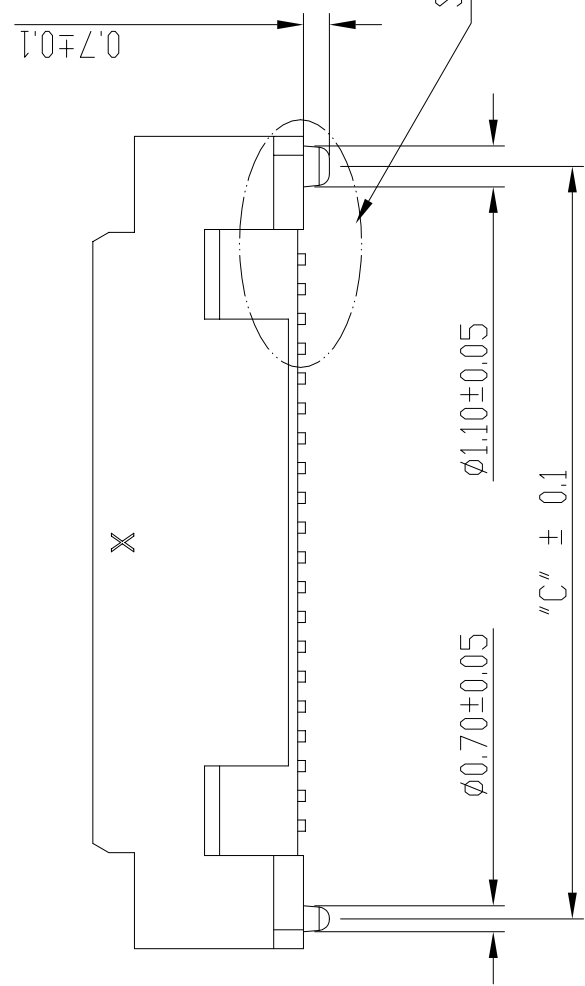
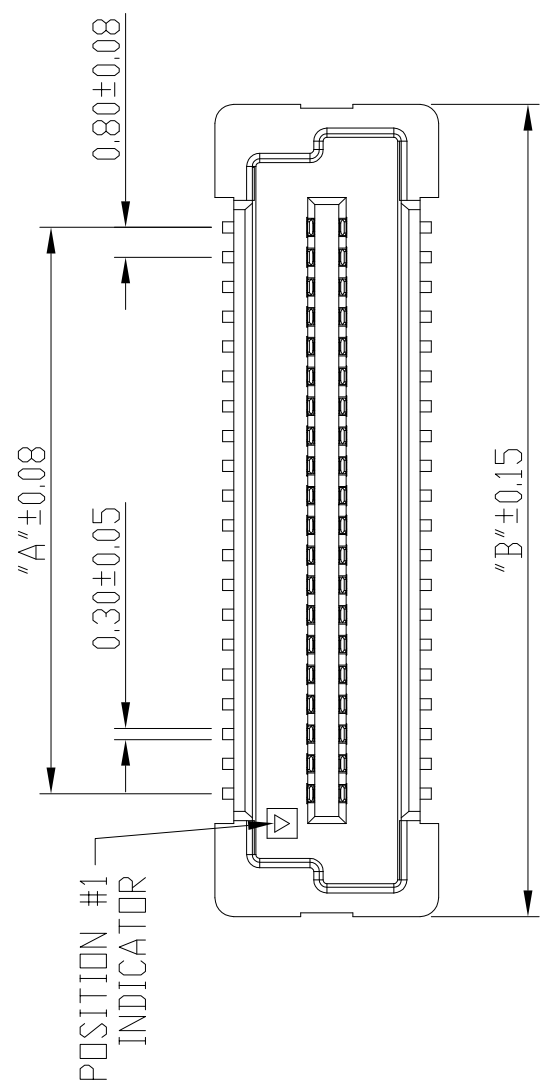

mat'l. code		surface	tolerance	projection	product family
itr	ecn no dr	ISO 1302	ISO 406	ISO 1101	BERGSTAK HPL545
AS	date	tolerances unless otherwise specified	linear	mm	title
		angles	.0±.2	mm	PLUG ASSY
		0°±3°	.00±.15	scale 1:1	BERGSTAK 0.8MM
		dr	GuoMin Sun	2014-10-21	dwg no
		engf	Bob Gu	2020-01-10	sheet 3 of 6
		chr	LQ Lei	2020-01-10	A3
		appd	Tim Yao	2020-01-10	61083
sheet index	revision	AS			type
1	1				Product Customer Drawing

1 | 2 | 3 | 4 | 5 | 6

PRODUCT NO.	NO. OF POSITION	DIMENSION		
		A	B	C
61083-023***	2X10	7.2	13.8	12.2
61083-043***	2X20	15.2	21.8	20.2
61083-063***	2X30	23.2	29.8	28.2
61083-083***	2X40	31.2	37.8	36.2
61083-103***	2X50	39.2	45.8	44.2
61083-123***	2X60	47.2	53.8	52.2
61083-143***	2X70	55.2	61.8	60.2
61083-163***	2X80	63.2	69.8	68.2
61083-183***	2X90	71.2	77.8	76.2
61083-203***	2X100	79.2	85.8	84.2

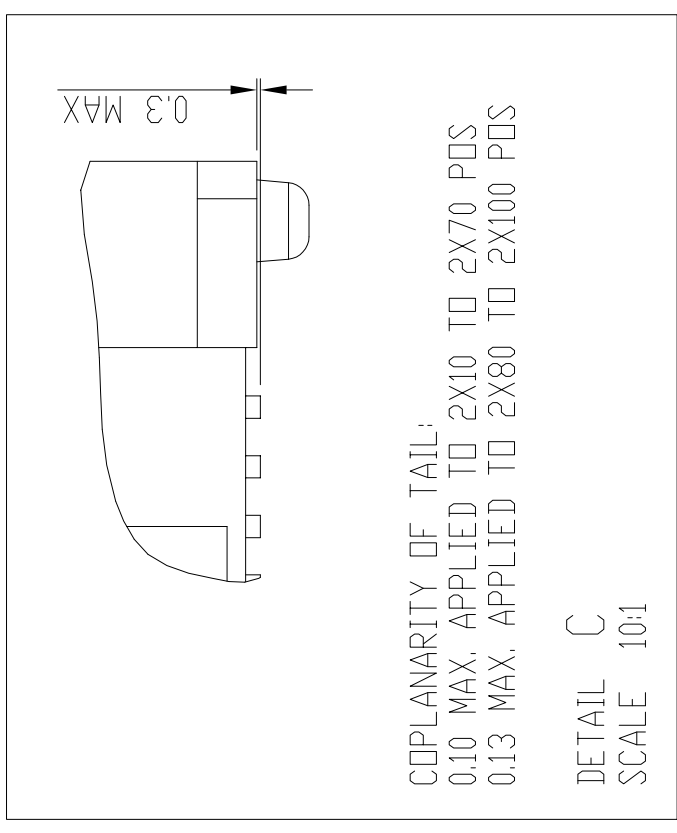
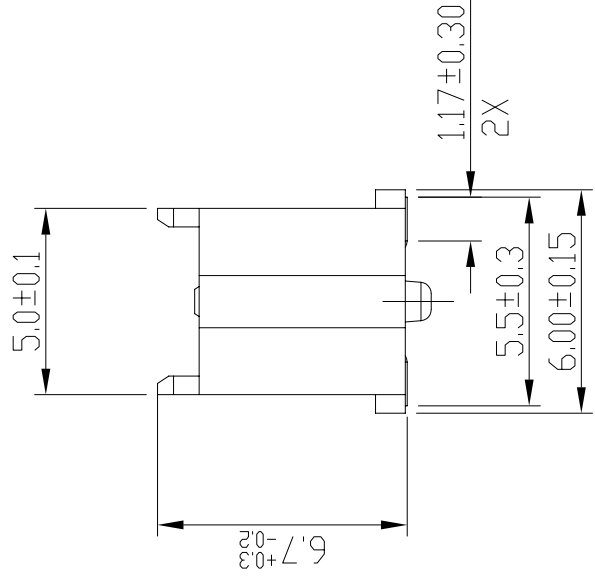
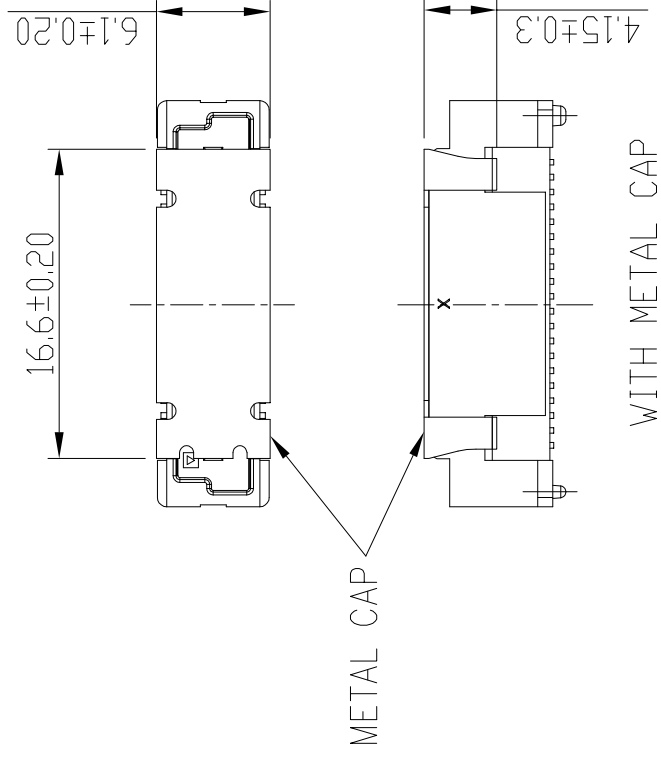
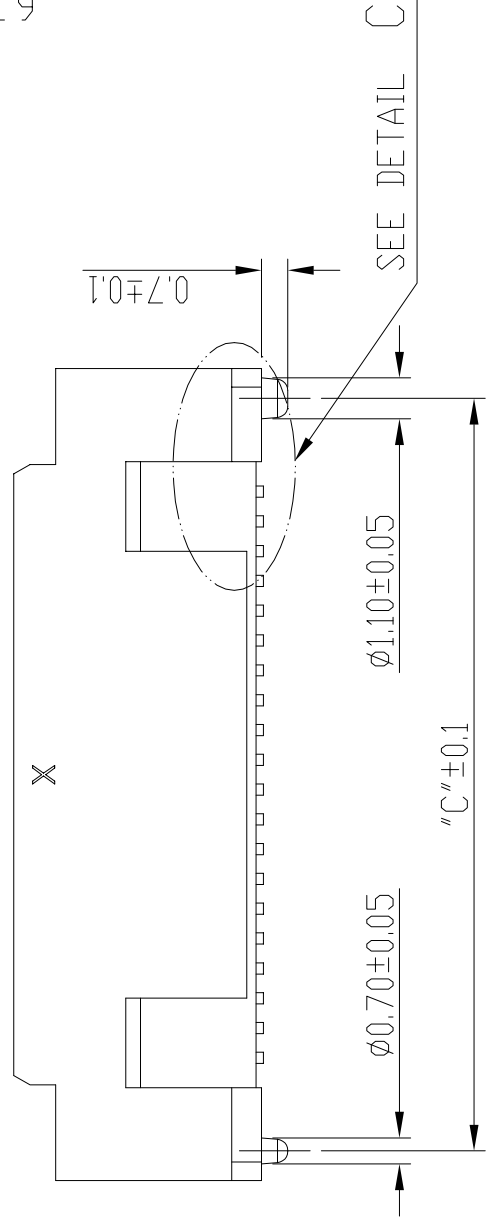
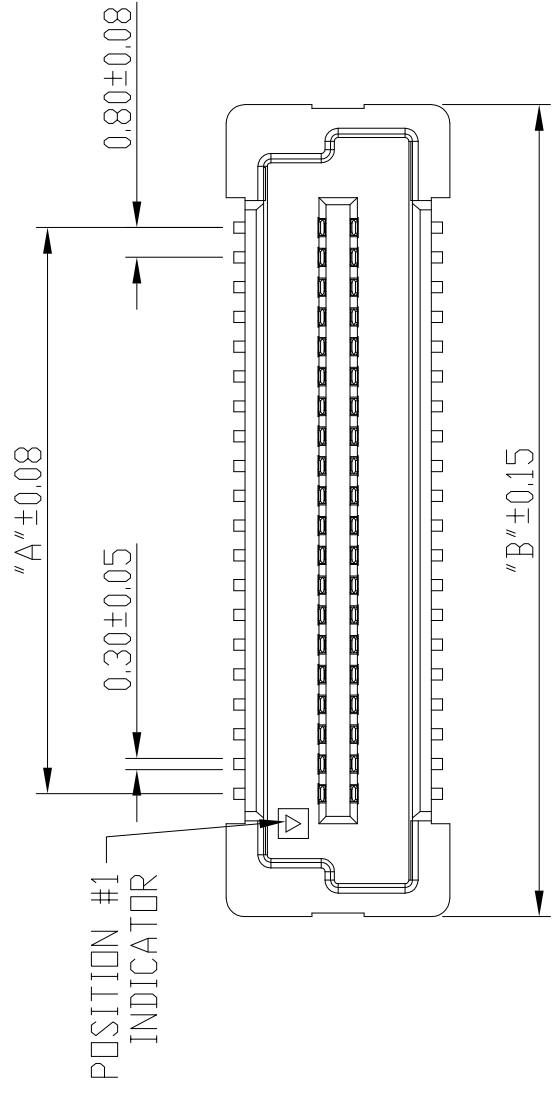

DATE CODE: XXXXXX

DAY(01~31)
MONTH(01~12)
YEAR(00~99)

DETAIL CC

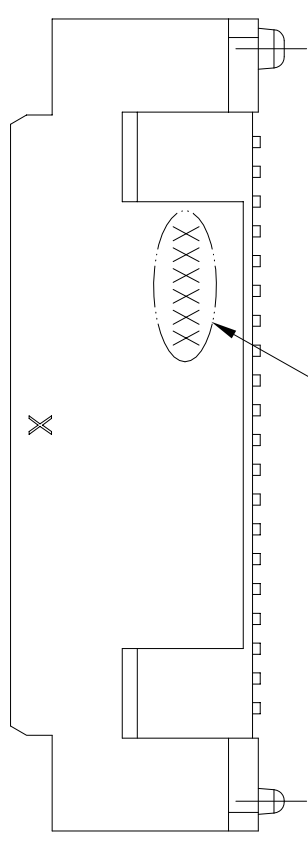

SEE DETAIL CC

PLUG 3

mat'l. code		surface	tolerance	projection	product family
itr	ecn no	ISO 1302	ISO 406	ISO 1101	BERGSTAK HPL545
AS		tolerances unless otherwise specified	linear	mm	title
	date	angles	.0±.2	mm	PLUG ASSY
		linear	.00±.15	scale 1:1	BERGSTAK 0.8MM
		0°±3°	.000±.10		dwg no
		dr	GuoMin Sun	2014-10-21	sheet4 of 6
		engf	Bob Gu	2020-01-10	A3
		chr	LQ Lei	2020-01-10	61083
		appd	Tim Yao	2020-01-10	type
sheet index	revision				Product Customer Drawing
	AS				
sheet 1	1				

1 | 2 | 3 | 4 | 5 | 6

PRODUCT NO.	NO. OF POSITION	DIMENSION		
		A	B	C
61083-044***	2X20	15.2	21.8	20.2
61083-064***	2X30	23.2	29.8	28.2
61083-084***	2X40	31.2	37.8	36.2
61083-104***	2X50	39.2	45.8	44.2
61083-124***	2X60	47.2	53.8	52.2
61083-144***	2X70	55.2	61.8	60.2
61083-164***	2X80	63.2	69.8	68.2
61083-184***	2X90	71.2	77.8	76.2
61083-204***	2X100	79.2	85.8	84.2

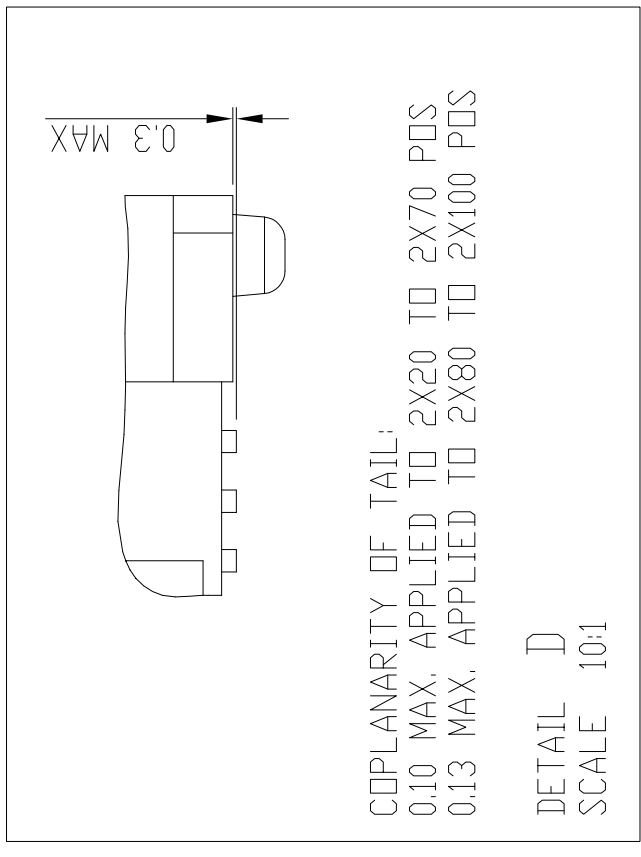
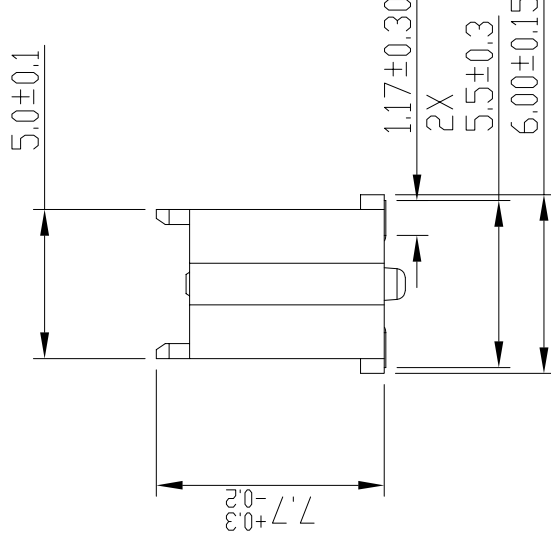
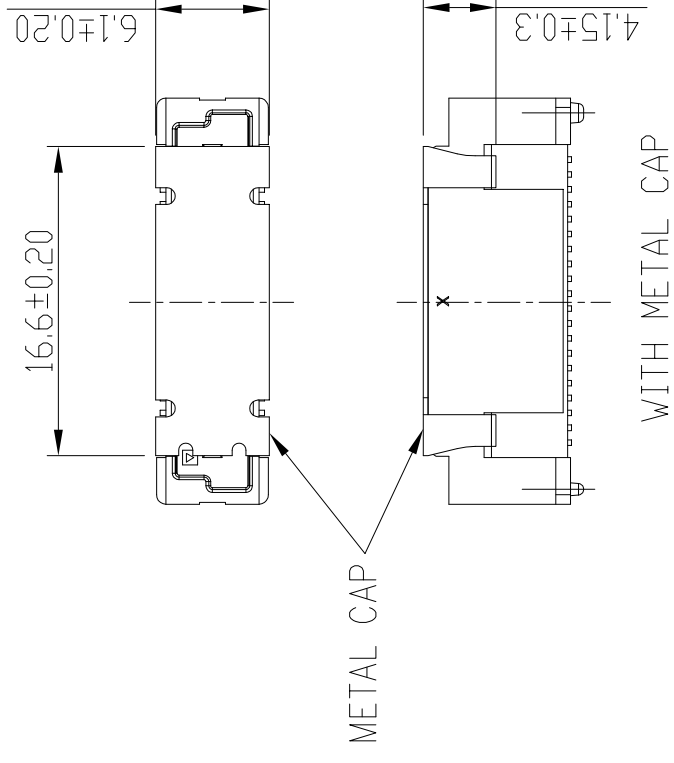
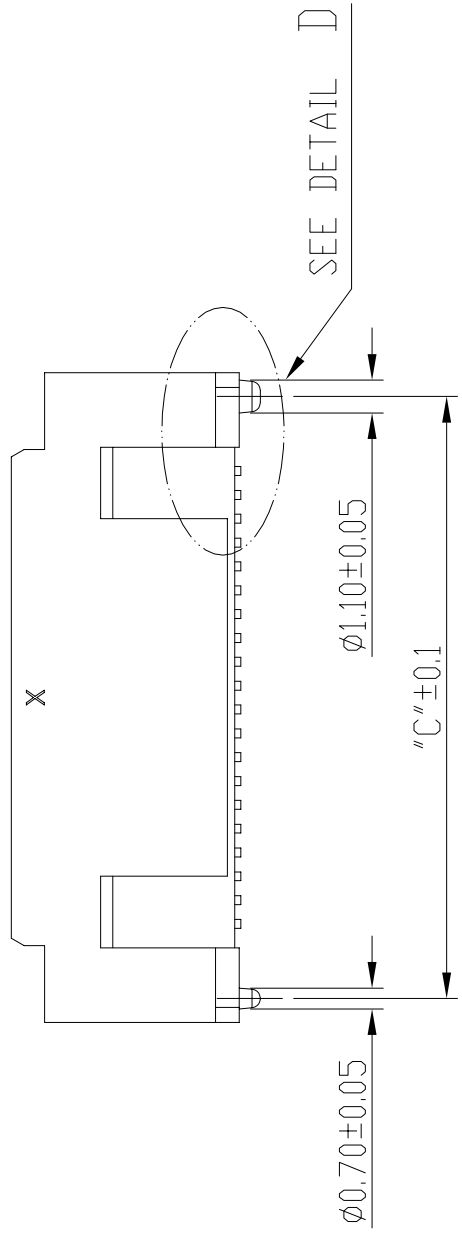
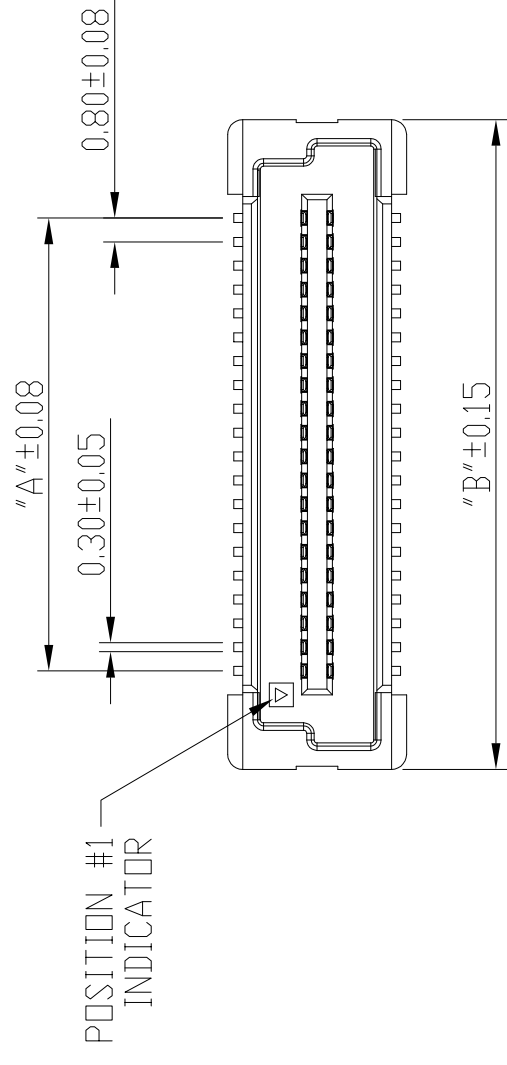

COPLANARITY OF TAIL:
 0.10 MAX, APPLIED TO 2X20 TO 2X70 POS
 0.13 MAX, APPLIED TO 2X80 TO 2X100 POS

DETAIL D
 SCALE 10:1

DATE CODE: XXXXXX

DAY(01~31)
 MONTH(01~12)
 YEAR(00~99)

DETAIL DD

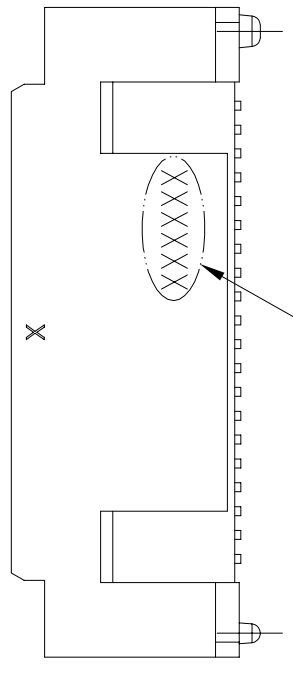

mat'l. code		surface	tolerance	projection	product family
ISO 1302	ISO 406	ISO 1101	ISO 1101	BERGSTAK HPL545	BERGSTAK HPL545
AS	AS	AS	AS	AS	AS
ecn no	dr	date	tolerances unless otherwise specified	angles	linear
			.0±.2	0°±3°	mm
			.00±.15		scale 1:1
			.000±.10		
dr	GuoMin	Sun	2014-10-21	Amphenol	FCI
engf	Bob	Gu	2020-01-10	PLUG ASSY	BERGSTAK 0.8MM
chr	LQ	Lei	2020-01-10		
appd	Tim	Yao	2020-01-10		
sheet index	revision	AS			
1	1				

PLUG 4

SEE DETAIL DD

product family: BERGSTAK HPL545

title: PLUG ASSY BERGSTAK 0.8MM

dwg no: 61083

sheet 5 of 6

size: A3

type: Product Customer Drawing

FOR PLUG 1/2/3/4

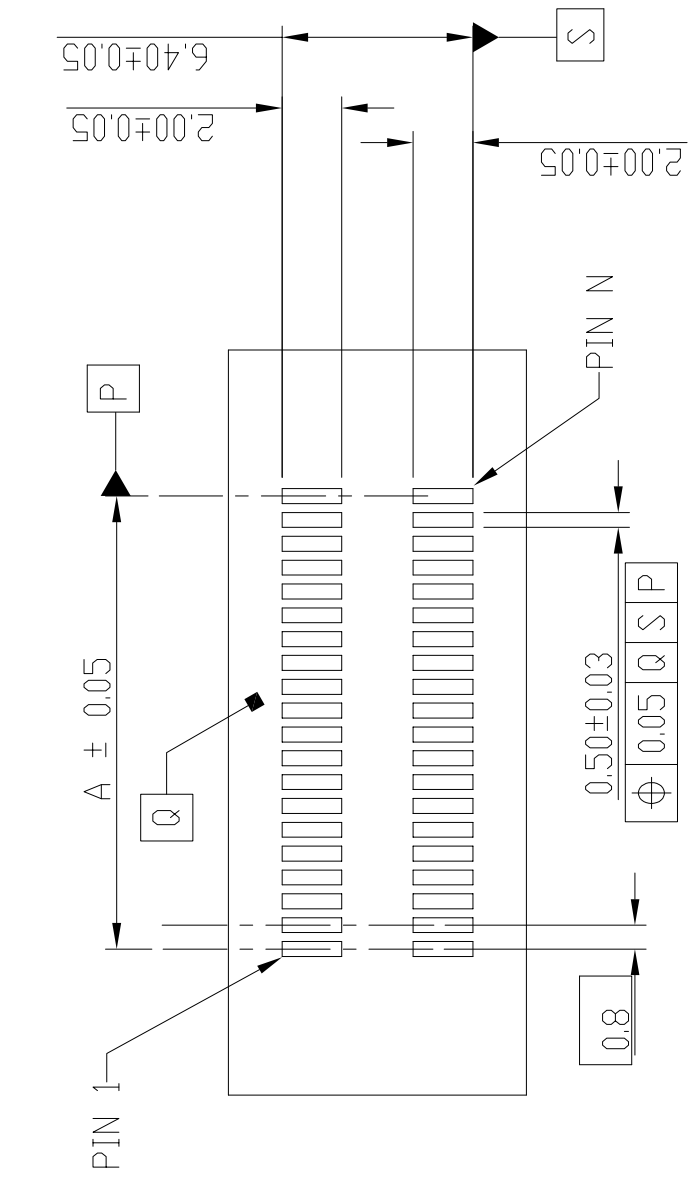

RECOMMENDED PCB LAYOUT WITHOUT PEG FOR
NO. OF POS 2X10, 2X20, 2X30, 2X40, 2X50 2X60

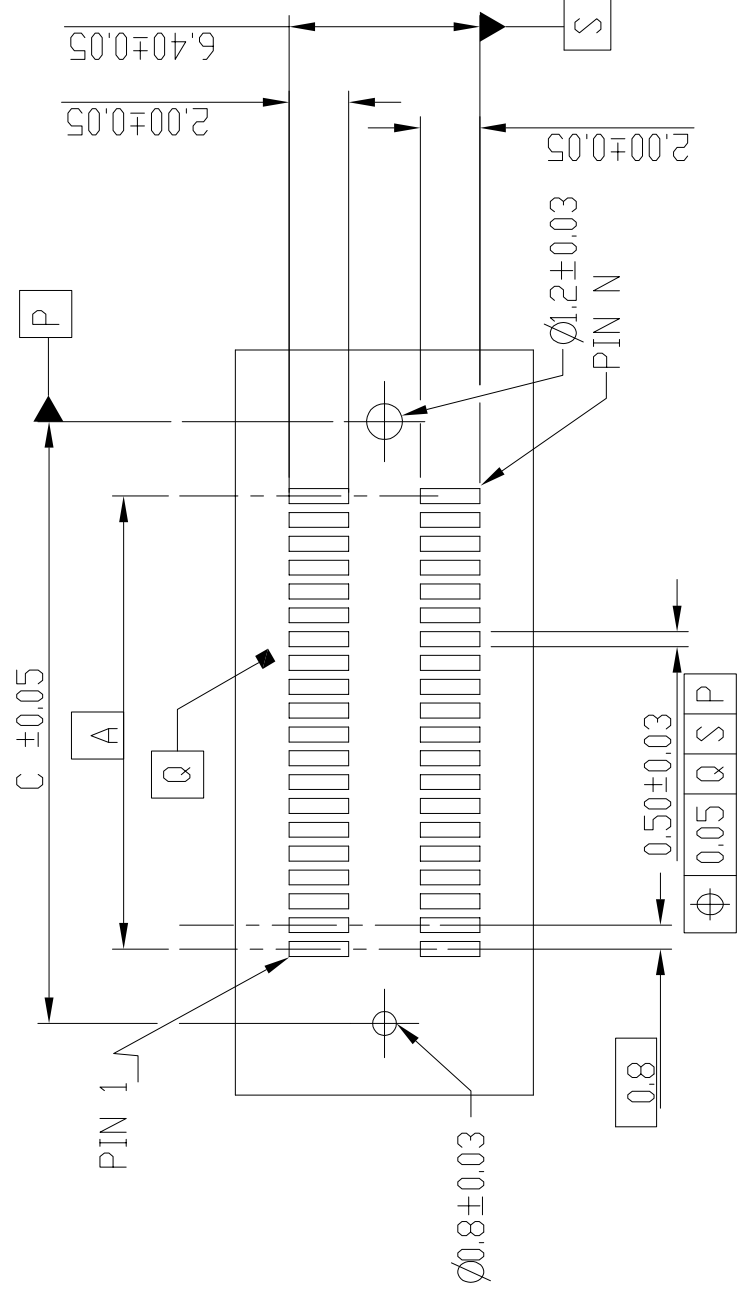

RECOMMENDED PCB LAYOUT WITH PEG FOR
NO. OF POS 2X10, 2X20, 2X30, 2X40, 2X50 2X60

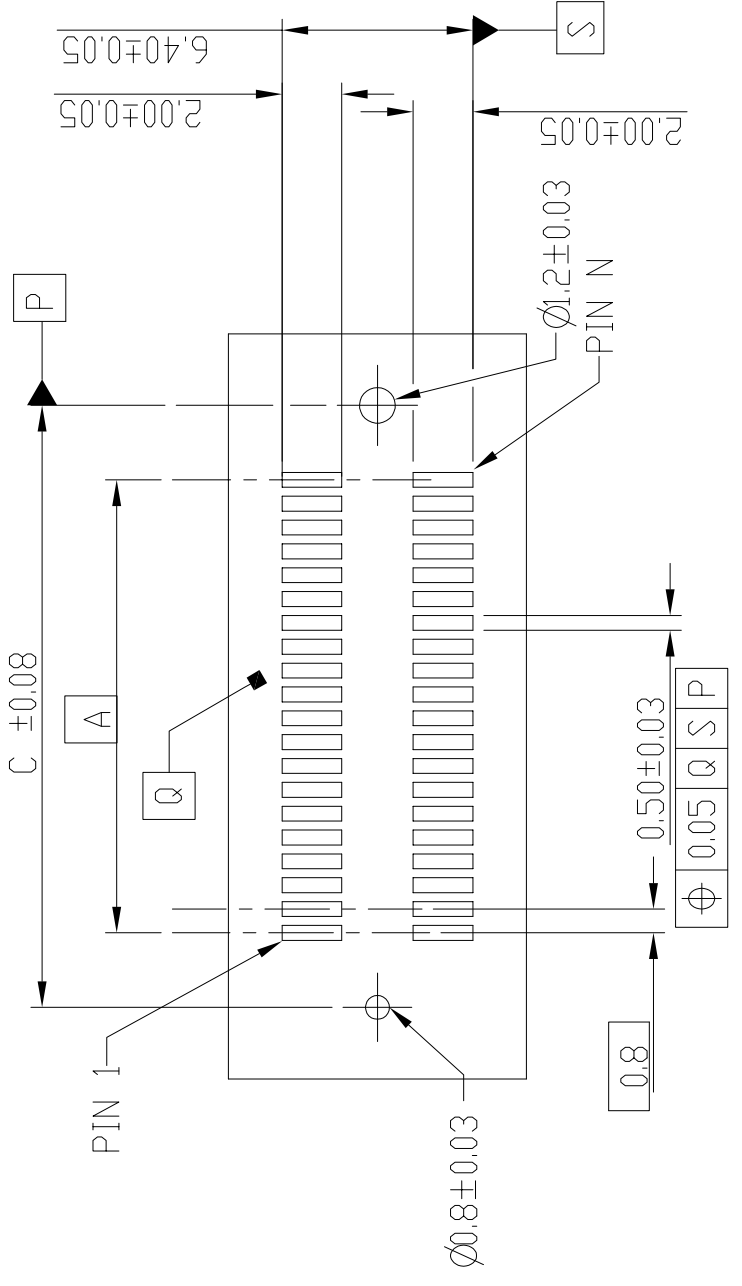

RECOMMENDED PCB LAYOUT WITH PEG FOR
NO. OF POS 2X70, 2X80, 2X90, 2X100

mat'l. code		surface	tolerance	projection	product family
itr	ecn no	ISO 1302	ISO 406	ISO 1101	BERGSTAK HPL545
AS	no dr	tolerances unless otherwise specified	ISO 1101	mm	
	date	angles	.0±.2	linear	
		0°±3°	.00±.15	scale 1:1	
		dr	GuoMin Sun	2014-10-21	PLUG ASSY
		engf	Bob Gu	2020-01-10	BERGSTAK 0.8MM
		chr	LQ Lei	2020-01-10	
		appd	Tim Yao	2020-01-10	
sheet index	revision AS				dwg no
1	1				sheet 6 of 6
					size
					A3
					61083
					type
					Product Customer Drawing