

REV  
NC 0460-245-12\*\*

REVISIONS			
SYM	DESCRIPTION	DATE	APPROVED
NC	NEW RELEASE PER E.O. P19398	11-17-06	RDC

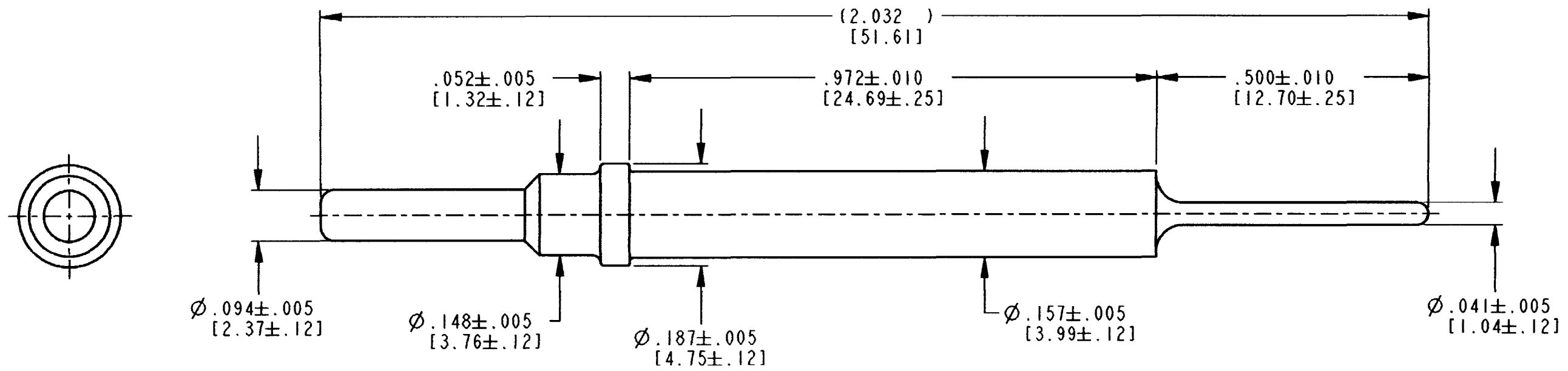

- NOTES:
1. DIMENSIONS ARE IN INCHES [mm].
  2. WHEN \*\* = 31: PLATING IS GOLD.  
WHEN \*\* = 90: PLATING IS TIN.
  3. FOR CONTACT APPLICATION, SEE DRAWING 0425-202-0000.

SIGNATURE & DATE	
DR	J. APOSTOL 25OCT2006
CHK	[Signature] 11/02/06
PE	D. Meyer 10/21/06
APPD	[Signature] 11-17-06
SCALE	NONE
WT	

CONTACT PIN  
SIZE 12  
EXTENSION

ENVELOPE

EP	MATL. CODE
	<b>The Deutch Company</b> DEUTSCH I.P.D. 3850 INDUSTRIAL AVE. HEMET, CALIF. 92545
<b>B</b>	<b>0460-245-12**</b>
DWG SIZE	CODE 11139 SHEET   OF

# Mouser Electronics

Authorized Distributor

Click to View Pricing, Inventory, Delivery & Lifecycle Information:

[TE Connectivity:](#)

[0460-245-1290](#)