

THIS COPY IS PROVIDED ON A RESTRICTED BASIS AND IS NOT TO BE USED IN ANY WAY DETRIMENTAL TO THE INTERESTS OF PANDUIT CORP.

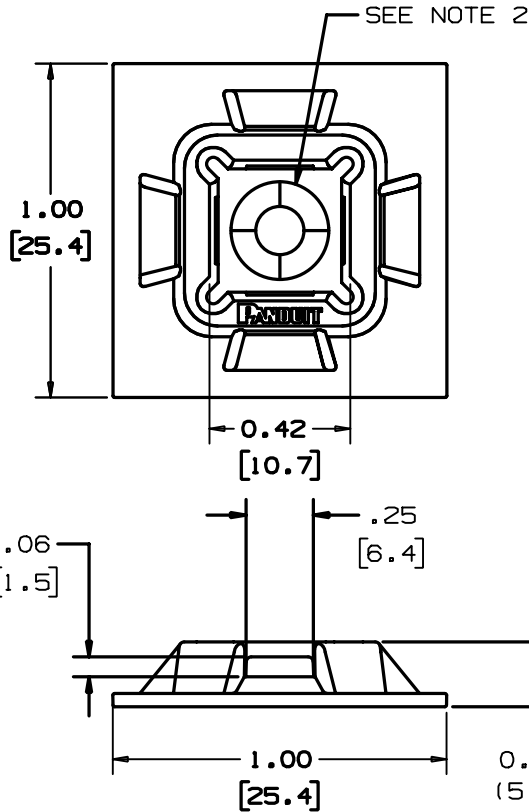

PANDUIT PART NUMBER*	MAT'L SUFFIX	MATERIAL	WEIGHT lbs/100 pcs (g)/100 pcs
ABM100-S6	NONE	NYLON 6/6 (WHITE)	0.26 [119]
	-0	WEATHER RESISTANT NYLON (BLACK)	
	-69	FLAME RETARDANT NYLON (IVORY)	

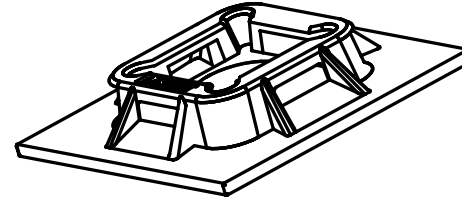

NOTES:

- *1. SEE CURRENT PRICE SHEET FOR PART NUMBER SUFFIX DESIGNATION FOR PACKAGE SIZE.
- 2. HOLE FOR STANDARD S6 FLAT HEAD SCREW.
- 3. USE MOUNTS WITH THESE CABLE TIES CROSS SECTIONS:

M, I, S
SG200, SG250, SG300

DIMENSIONS IN BRACKETS ARE METRIC [mm]

CAD FILENAME/LAYER G00239DB_DC_ABM100S6_04

PANDUIT

CORP. TINLEY PARK, ILLINOIS

ABM100-S6
4 WAY MOUNT

UNLESS OTHERWISE SPECIFIED,
DIMENSIONAL TOLERANCES ARE:
(.X) ±0.05 (1.3) (.XXX) ±0.010 (0.25)
(.XX) ±0.02 (0.5) ANGLES ± 5°

UNLESS OTHERWISE SPECIFIED,
ALL DIMENSIONS ARE GIVEN
IN INCHES, THIRD ANGLE PROJECTION.

DRAWN BY

CJG

MAT'L:

SCALE

2X

DATE

5/14/98

SEE TABLE

DRAWING NO.

G00239DB

DWG

A

SIZE

REV	DATE	BY	CHK	DESCRIPTION	ECN	R	CUST	SUP
4	3/3/05	JAD		UPDATE CABLE TIE WINDOW DIMENSIONS FOR NEW SUPER GRIP TIES, ADD NOTE 3	G80239DB	4		
3	05/09/01	LGG		REMOVED -14 AND -15 MATERIAL BOTH ARE OBS	G80239DB	3		
2	12-19-98	CGSM		CHANGED DIMENSION TOLERANCES REMOVED HOLE DIMENSIONS, ADDED NOTE 2	G80239DB	2		
1	12/16/98	AJV		MODIFIED PART GEOMETRY AND ADDED	G80239DB	1		
				MATERIAL TABLE				
R	5/14/98	CJG		INITIAL RELEASE	G80239DB	R		

Mouser Electronics

Authorized Distributor

Click to View Pricing, Inventory, Delivery & Lifecycle Information:

[Panduit:](#)

[ABM100-S6-C](#) [ABM100-S6-D](#) [ABM100-S6-D69](#) [ABM100-S6-C69](#)