

CIRC. 08

TAPD 4 SIZE BS

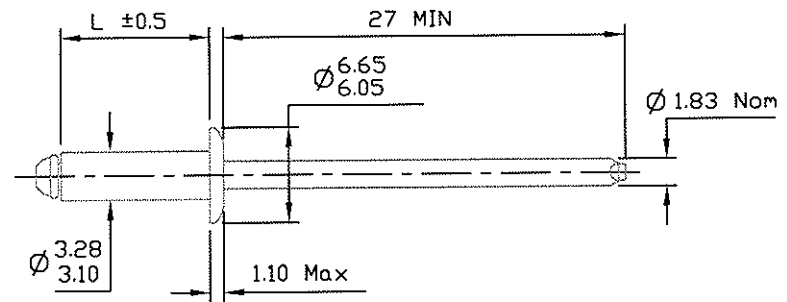

FOR FINISH DETAILS SEE DRG 300816

| PRODUCT CODE | L | GRIP RANGE |
|--------------|------|-------------|
| TAPD 402 BS | 4.5 | - 1.6 |
| TAPD 404 BS | 6.0 | 1.6 - 3.2 |
| TAPD 406 BS | 8.0 | 3.2 - 4.8 |
| TAPD 408 BS | 9.7 | 4.8 - 6.4 |
| TAPD 410 BS | 11.5 | 6.4 - 7.9 |
| TAPD 412 BS | 13.5 | 7.9 - 9.5 |
| TAPD 414 BS | 15.0 | 9.5 - 11.1 |
| TAPD 416 BS | 17.0 | 11.1 - 12.7 |
| TAPD 418 BS | 18.5 | 12.7 - 14.3 |
| TAPD 421 BS | 20.0 | 14.3 - 16.7 |
| TAPD 425 BS | 24.0 | 16.7 - 20.7 |

| | | | | | |
|--|------------------------|-------------------------------|-------|---|----|
| SHEAR STRENGTH 800N | TENSILE STRENGTH 1200N | HOLE SIZE $\text{Ø } 3.3/3.4$ | | | |
| MATERIAL MANDREL GALVANISED CARBON STEEL | | 22JAN09 | 20612 | 8 | RE |
| BODY EN573-3ALUMINIUM:EN AW-5154A (AlMg3.5%) | | 29OCT08 | 20564 | 7 | RE |

CIRC 08 (EMHART TEKNIK)

SSD 4 SIZE SSBS

SSD 4 SIZE BS

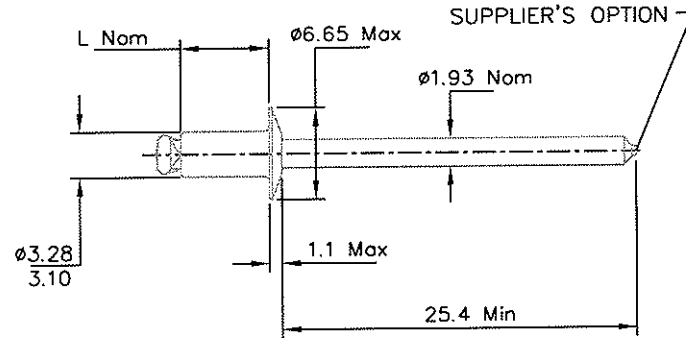

For Finish details see 300816

| PRODUCT CODE | L | GRIP RANGE |
|--------------|------|------------|
| SSD 41 | 4.8 | 0.8 - 1.6 |
| SSD 42 | 6.4 | 1.6 - 3.2 |
| SSD 43 | 8.0 | 3.2 - 4.8 |
| SSD 44 | 9.5 | 4.8 - 6.4 |
| SSD 46 | 12.7 | 6.4 - 9.5 |
| SSD 48 | 15.9 | 9.5 - 12.7 |

Manufacturing Drawing SHELTON R2004 Holes Size 3.3 to 3.4

Shear Strength 2400 N Tensile Strength 3000 N

| MATERIAL | DATE | EIN No | ISSUE | APPROVED |
|---|----------|--------|-------|----------|
| Body Stainless Steel Grade 305 | | | | |
| Mandrel type SSBS Stainless Steel Grade 302 | 04/01/02 | 18466 | 4 | SD |
| Mandrel type BS Carbon Steel | 13/03/01 | 18134 | 3 | SD |

| | | | | | | |
|--|---------|---------------------------------------|----------|----------|---|-----|
| This drawing is the property of Tucker Fasteners Ltd. It is confidential and must not be lent or copied except by written consent. | TITLE | 'POP' OPEN DOMED HEAD STAINLESS STEEL | 02/02/00 | 17485 | 2 | DWA |
| | DATE | EIN No | ISSUE | APPROVED | | |
| | 16/8/99 | 17157 | 1 | SD | | |

ALL DIMENSIONS ARE IN MILLIMETRES SCALE 3 : 1 DR S.Dean Date AUG99

| | | |
|--------------|--|-------------|
| SHEET 1 OF 1 | © TUCKER FASTENERS Ltd. EMHART FASTENING TECHNOLOGIES Walsall Road, Birmingham B42 1BP, England. A ● BLACK & DECKER COMPANY | DRAWING No. |
| CUSTOMER A4 | | 303183 |

CIRC. 08

SSD 5 SIZE SSBS

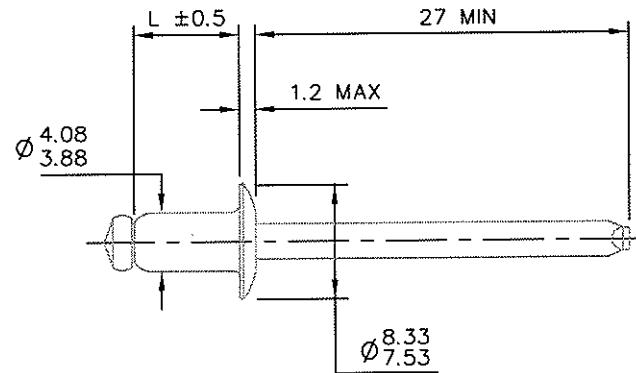

FOR FINISH DETAILS SEE DRG 300816

| PRODUCT CODE | L | GRIP RANGE |
|---|--|---------------------------------|
| SSD 52 SSBS | 7.0 | 1.6 - 3.2 |
| SSD 53 SSBS | 8.6 | 3.2 - 4.7 |
| SSD 54 SSBS | 10.2 | 3.2 - 6.4 |
| SSD 56 SSBS | 13.3 | 6.4 - 9.5 |
| SHEAR STRENGTH 4000N | | TENSILE STRENGTH 5000N |
| MATERIAL | | HOLE SIZE \varnothing 4.1/4.2 |
| MANDREL : STAINLESS STEEL GRADE 302 | | |
| BODY : STAINLESS STEEL GRADE 305 | | |
| This drawing is the property of Tucker Fasteners Ltd. It is confidential and must not be lent or copied except by written consent. | TITLE | |
| | 'POP' OPEN STAINLESS STEEL 5 SIZE DOMED HEAD | |
| ALL DIMENSIONS ARE IN MILLIMETRES | | SCALE 3 : 1 |
| DR R.EVERILL | | Date 13APR05 |
| SHEET 1 OF 2 | | DRAWING No. |
| A4 | 303829 | |
| © TUCKER FASTENERS Ltd. EMHART FASTENING TECHNOLOGIES Walsall Road, Birmingham B42 1BP, England. A ● BLACK & DECKER COMPANY | | |

CIRC. 08

SSD 6 SIZE SSBS

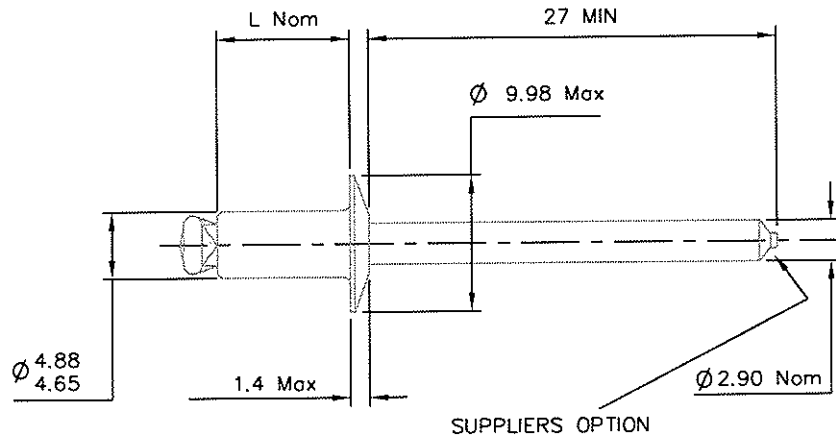

For Finish details see 300816

| PRODUCT CODE | L | GRIP RANGE |
|--------------|------|------------|
| SSD 62 SSBS | 7.6 | 1.6 - 3.2 |
| SSD 64 SSBS | 10.8 | 3.2 - 6.4 |
| SSD 66 SSBS | 14.0 | 6.4 - 9.5 |
| SSD 68 SSBS | 17.2 | 9.5 - 12.7 |

| | | | | | |
|--|------------------------|--|--------|---------------------|----------|
| Manufacturing Drawing SHELTON R2004 | | HOLE SIZE Ø 4.9/5.0 | | | |
| SHEAR STRENGTH 4400N | | TENSILE STRENGTH 6100N | | | |
| MATERIAL MANDREL STAINLESS STEEL - GRADE 302 | | | | | |
| BODY STAINLESS STEEL - GRADE 305 | | | | | |
| This drawing is the property of Tucker Fasteners Ltd. It is confidential and must not be lent or copied except by written consent. | TITLE 'POP' OPEN RIVET | 04-02-00 | 17490 | 2 | DWA |
| | 6 SIZE STAINLESS STEEL | 25-9-96 | 15113 | 1 | |
| | DOMED HEAD | ECN DATE | ECN No | ISSUE | APPROVED |
| ALL DIMENSIONS ARE IN MILLIMETRES | | SCALE 3 : 1 | | DR S.H. Date SEP 96 | |
| SHEET 1 OF 1 | | © TUCKER FASTENERS Ltd. | | DRAWING No. 302757 | |
| A4 | | EMHART FASTENING TECHNOLOGIES | | | |
| | | Walsall Road, Birmingham B42 1BP, England. | | | |
| | | A ● BLACK & DECKER COMPANY | | | |

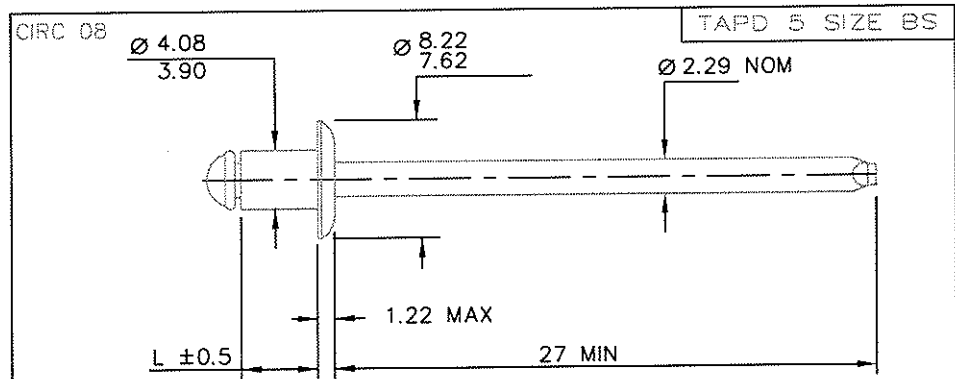

FOR FINISH DETAILS SEE DRG 300816

| PRODUCT CODE | L | GRIP RANGE |
|-----------------------|--|---------------------------|
| TAPD 502 BS | 5.00 | - 1.6 |
| TAPD 503 BS | 6.30 | - 2.9 |
| TAPD 504 BS | 7.00 | 1.6 - 3.2 |
| TAPD 506 BS | 8.50 | 3.2 - 4.8 |
| TAPD 508 BS | 10.50 | 4.8 - 6.4 |
| TAPD 510 BS | 12.20 | 6.4 - 7.9 |
| TAPD 512 BS | 14.00 | 7.9 - 9.5 |
| TAPD 514 BS | 15.70 | 9.5 - 11.1 |
| TAPD 516 BS | 17.50 | 11.1 - 12.7 |
| TAPD 517 BS | 18.50 | 12.7 - 13.5 |
| TAPD 518 BS | 19.40 | 12.7 - 14.5 |
| TAPD 520 BS | 20.20 | 13.5 - 15.9 |
| TAPD 522 BS | 22.50 | 15.9 - 17.4 |
| TAPD 525 BS | 24.70 | 17.4 - 19.8 |
| SHEAR STRENGTH 1330 N | | TENSILE STRENGTH 1910 N |
| HOLE SIZE Ø 4.1 / 4.2 | | |
| MATERIAL | MANDREL GALVANISED CARBON STEEL | 29OCT08 20564 14 RE |
| | BODY EN573-3ALUMINIUM:EN AW-5154A (AlMg3.5%) | 25JUL07 20311 13 RE |

CIRC. 08

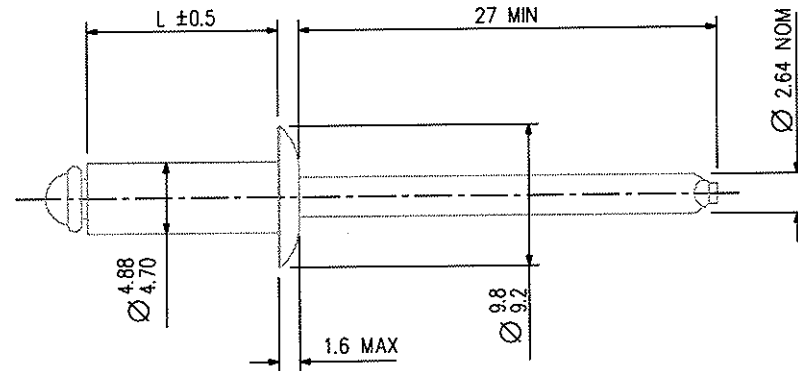

FOR FINISH DETAILS SEE 300816

| PRODUCT CODE | L | GRIP RANGE |
|--------------|------|-------------|
| TAPD 603 BS | 6.5 | - 2.4 |
| TAPD 604 BS | 7.5 | 2.4 - 3.2 |
| TAPD 606 BS | 9.2 | 3.2 - 4.8 |
| TAPD 607 BS | 10.0 | - 5.6 |
| TAPD 608 BS | 11.0 | 4.8 - 6.4 |
| TAPD 610 BS | 12.7 | 6.4 - 7.9 |
| TAPD 612 BS | 14.7 | 7.9 - 9.5 |
| TAPD 614 BS | 16.5 | 9.5 - 11.1 |
| TAPD 616 BS | 18.0 | 11.1 - 12.7 |
| TAPD 617 BS | 19.0 | 11.1 - 13.5 |
| TAPD 625 BS | 25.5 | 13.5 - 19.8 |
| TAPD 633 BS | 32.0 | 19.8 - 26.2 |

| | | | | | |
|--|--|-------------|---------|-----------|----------|
| SHEAR STRENGTH 2020N | TENSILE STRENGTH 2800N | HOLE SIZE Ø | 4.9/5.0 | | |
| MATERIAL | MANDREL GALVANISED CARBON STEEL | 21NOV08 | 20585 | 14 | RE |
| | BODY EN573-JALUMINIUM:EN AW-5154A (AlMg3.5%) | 30SEP04 | 19468 | 13 | RE |
| This drawing is the property of Tucker Fasteners Ltd. It is confidential and must not be lent or copied except by written consent. | TITLE ALUMINIUM ALLOY 'POP' OPEN RIVET 6 SIZE DOMED HEAD GALVANISED MANDREL | 22JUN04 | 19382 | 12 | RE |
| | | 29SEP03 | 19135 | 11 | RE |
| | | ECN DATE | ECN No | ISSUE | APPROVED |
| ALL DIMENSIONS ARE IN MILLIMETRES | SCALE 3:1 | DR | GJ | Date 7/94 | |