

THIS IS ISSUED IN STRICT CONFIDENCE THAT IT IS NOT USED AS A BASIS FOR MANUFACTURE OR SALE AND THAT IT IS NOT COPIED, REPRINTED OR DISCLOSED TO A THIRD PARTY EITHER WHOLLY OR IN PART WITHOUT THE PRIOR WRITTEN CONSENT OF CAL TEST ELECTRONICS, INC.

- DO-IT-YOURSELF (DIY) 4mm RETRACTILE SLEEVE STACKING BANANA PLUG, SCREW ATTACHMENT
- SPECIFICATIONS:  
 INSULATOR BODY: POLYAMIDE (NYLON)  
 PLUG BODY: BRASS, NICKEL PLATED  
 CONTACT SPRING: BERYLLIUM COPPER ALLOY, NICKEL PLATED
- RATING:  
 IEC: <33 V AC / <70 V DC  
 VOLTAGE: 1,200 V NON-HANDHELD  
 CURRENT: 36 A MAX.  
 TEMPERATURE: -20° C TO +80° C.
- MAXIMUM WIRE SIZES:  
 CONDUCTOR:  $\varnothing$ .090 (12AWG)  
 INSULATION:  $\varnothing$ .156 (5/32")  
 STRIP LENGTH: .25 (6.4)

REVISIONS			
REV.	DESCRIPTIONS	DATE	APPROVED
-	CLASS A RELEASED	7/12/99	
A	UPDATED FORMAT w/ CAGE CODE	4/18/04	

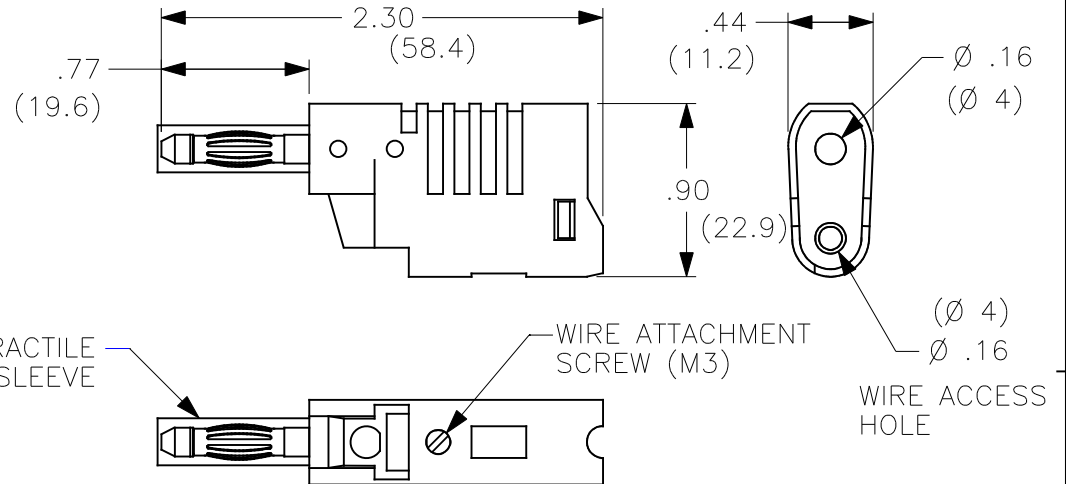

**MODEL NUMBER**

**CT2015-#**

- COLOR: 0 - BLACK  
 2 - RED  
 4 - YELLOW  
 5 - GREEN  
 6 - BLUE  
 9 - WHITE

THIRD ANGLE PROJECTION		UNLESS OTHERWISE SPECIFIED DIMENSIONS ARE IN INCHES TOLERANCES ARE: FRACTIONS DECIMALS $\pm 1/32$ .XX $\pm .02$ .XXX $\pm .005$ DO NOT SCALE DRAWING	CONTRACT NO.		<b>Cal Test Electronics</b> 22820 Savi Ranch Parkway Yorba Linda, CA 92887-4610			
			APPROVALS	DATE	TITLE			
MATERIAL		DRAWN	WDH	7/12/99	DIY 4mm RETRACTILE PLUG, SCREW ATTACHMENT			
FINISH		CHECKED			SIZE	CAGE CODE	DWG. NO.	REV.
NEXT ASSY	USED ON	ENGR.			A	43F45	P201500	-
APPLICATION		DESIGN ACTIVITY			SCALE	1:1	SHEET	1 OF 1

# Mouser Electronics

Authorized Distributor

Click to View Pricing, Inventory, Delivery & Lifecycle Information:

[Cal Test Electronics:](#)

[CT2015-4](#) [CT2015-5](#) [CT2015-6](#) [CT2015-9](#) [CT2015-0](#) [CT2015-2](#)