

# GEORG FISCHER +GF+ Piping Systems

21 96 01

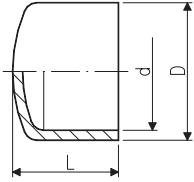

**Datasheet**  
**Industry, PVC-U ISO/DIN, Fittings, Pipe Fittings for solvent cement jointing, Caps, PVC-U ISO/DIN**

PF 2 30 152

| d   | PN | Code               | SP | GP  | kg    | D     | L    |
|-----|----|--------------------|----|-----|-------|-------|------|
| 12  | 16 | <b>721 960 104</b> | 10 | 500 | 0,004 | 19    | 15   |
| 16  | 16 | <b>721 960 105</b> | 10 | 100 | 0,006 | 22,5  | 21   |
| 20  | 16 | <b>721 960 106</b> | 10 | 100 | 0,009 | 26,5  | 23,5 |
| 25  | 16 | <b>721 960 107</b> | 10 | 100 | 0,014 | 32,5  | 28   |
| 32  | 16 | <b>721 960 108</b> | 10 | 100 | 0,023 | 40    | 32   |
| 40  | 16 | <b>721 960 109</b> | 10 | 100 | 0,043 | 47    | 38   |
| 50  | 16 | <b>721 960 110</b> | 10 | 100 | 0,050 | 58,5  | 45   |
| 63  | 16 | <b>721 960 111</b> | 5  | 50  | 0,092 | 73,5  | 55,5 |
| 75  | 16 | <b>721 960 112</b> | -  | 50  | 0,152 | 87    | 65   |
| 90  | 16 | <b>721 960 113</b> | -  | 5   | 0,263 | 105   | 77   |
| 110 | 16 | <b>721 960 114</b> | -  | 5   | 0,640 | 127,5 | 94   |
| 140 | 10 | <b>721 960 116</b> | -  | 10  | 0,880 | 164   | 92   |
| 160 | 10 | <b>721 960 117</b> | -  | 2   | 1,490 | 188   | 130  |

Materials: PVC-U, PVC-U

ISO 9001 certified quality management system

The technical data given are for first-hand information purposes only. They are non-binding and subject to change. Our general sales conditions apply.

© Georg Fischer Rohrleitungssysteme AG, CH-8201 Schaffhausen/Schweiz

03-30-1999

RLS SH 0499