

# A SERIES

## Battery Connector for Industrial Vehicles

- 80 - 160 - 320 Sizes • UL and CSA Rated • RoHS Compliant
- Acid & Impact Resistant • Industrial Applications



**APP**  
Anderson Power Products®

An IDEAL Company

# A SERIES BATTERY CONNECTOR

The Anderson™ family of A Series Battery Connectors are expertly designed for ease of use and incorporate an innovative contact carrier to simplify assembly. The A Series connectors include standard 80, 160, and 320 sizes. Robust design and materials offer superior performance. All Materials chosen are RoHS compliant and selected to ensure years of reliability in adverse industrial environments. These attributes make the A Series connectors the ideal choice for a wide range of industrial applications in Material Handling, Battery Charging, Utility Vehicles, Motive Power, and Sweepers/Scrubbers amongst many others.



## KEY ATTRIBUTES

**Safety Agency Approvals** - UL and CSA.



**Voltage Keying** - A series connectors offer keys for Dry-Cell, Wet-Cell, and Universal applications coded for 24/36/48/72/80 and 96 volts DC applications.

**Sturdy Advanced Polymer Housings** - Provide superior resistance to impact, acid and temperature extremes.

**Silver Plated Copper Contacts** - Provide excellent conductivity and superior mating cycle performance.

© 2020 Anderson Power Products, Inc. All rights reserved. APP®, Anderson Power Products®, SB®, SBE®, SBX®, SBS® and the APP Logo are registered trademarks of Anderson Power Products, Inc. Anderson™ is a trademark of Anderson Power Products, Inc.

Anderson will use reasonable efforts to include accurate and up-to-date content in the catalog. All product information contained in the catalog including ordering information, illustrations, specifications, and dimensions, are believed to be reliable as of the date of publishing, but is subject to change without notice. Anderson makes no warranty or representation as to its accuracy. Content in the catalog may contain technical inaccuracies, typographical errors and may be changed or updated without notice. Anderson may also make improvements and/or changes to the products and/or to the programs described in the content at any time without notice. Current sales drawings and specifications are available upon request.

Neither Anderson nor any party involved in creating, producing, or delivering this catalog shall be liable for any direct, incidental, consequential, indirect, or punitive damages arising out of your use of this catalog or any errors or omissions in its content.

# SPECIFICATIONS

## ELECTRICAL

### Current Ratings (Amperes)

Wire Size:	A80		A160		A320	
	CSA*	UL**	CSA*	UL**	CSA*	UL**
10 mm <sup>2</sup>	70	90	N/A	N/A	N/A	N/A
16 mm <sup>2</sup>	90	120	90	120	N/A	N/A
25 mm <sup>2</sup>	110	140	120	160	N/A	N/A
35 mm <sup>2</sup>	120	160	140	180	N/A	N/A
50 mm <sup>2</sup>	N/A	N/A	160	220	165	220
1/0 AWG	N/A	N/A	N/A	N/A	190	270
70 mm <sup>2</sup>	N/A	N/A	N/A	N/A	200	260
3/0 AWG	N/A	N/A	N/A	N/A	240	300
95 mm <sup>2</sup>	N/A	N/A	N/A	N/A	245	425
4/0 AWG	N/A	N/A	N/A	N/A	250	425
120 mm <sup>2</sup>	N/A	N/A	N/A	N/A	260	450

\* CSA allows for maximum temperature rise = 30°C

\*\* UL allows for total temperature (based on min. 25°C ambient) = 105°C

### Voltage Ratings

	A80		A160		A320	
	CSA	UL	CSA	UL	CSA	UL
AC / DC	600V	600V	600V	600V	600V	600V
DWV (AC)	2200		2200		2200	

### Wire Range

	A80		A160		A 20	
	mm <sup>2</sup>	AWG	mm <sup>2</sup>	AWG	mm <sup>2</sup>	AWG
Power - Min.	10	#8	16	#6	50	1/0
Power - Max.	35	#2	50	1/0	120	4/0
Upper Aux. - Min.	1.5	#18	4	#12	4	#12
Upper Aux. - Max.	2.5	#14	4	#12	4	#12
Lower Pilot Aux. - Min.	1.5	#18	6	#10	6	#10
Lower Pilot Aux. - Max.	2.5	#14	6	#10	6	#10

### Average Initial Contact Resistance Across Mated Connector- micro-ohms

	A80	A160	A320
<b>Avg. Contact Resistance - Power</b>	65	55	30
<b>Avg. Contact Resistance - Aux.</b>	1100	920	1000

Operating Temperature (all Series): -25 to 75°C

## MECHANICAL

### Misc. Data

	A80	A160	A320
<b>Avg. Mating Force N (lb)</b>	68 (15.3)	170 (38.2)	71 (16.0)
<b>Contact Retention N (lb)</b>	134 (30) min	445 (100) min	445 (100) min
<b>Degree of Protection</b>	IP23	IP23	IP23
<b>Flammability</b>	UL94 HB, Horizontal Burn		

## MATERIALS

	A80 - A160 - A320
<b>Housings</b>	PA6 (Nylon) glass filled
<b>Contacts</b>	Copper alloy silver plate
<b>Contact Plating - Power (min.)</b>	Silver Plating - 6 microns
<b>Contact Plating - Auxiliary (min.)</b>	Silver Plating - 6 microns
<b>Hardware</b>	Steel, zinc chromate plate

# A SERIES Battery Connector

# TEMPERATURE CHARTS

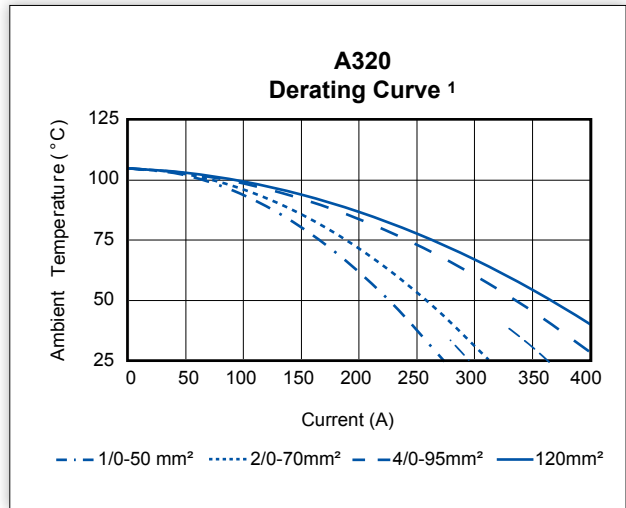
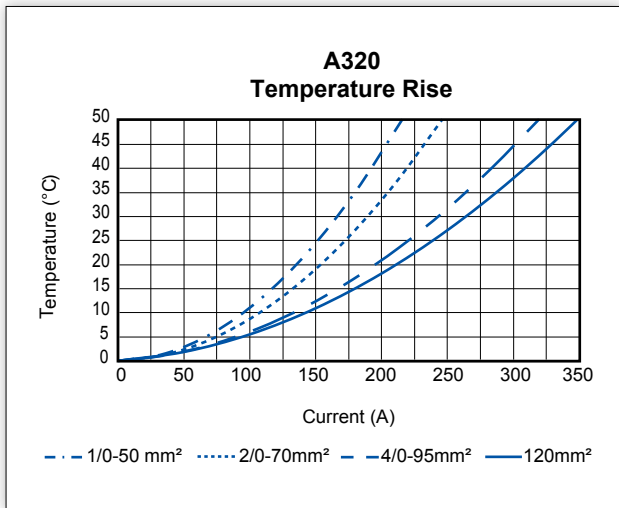
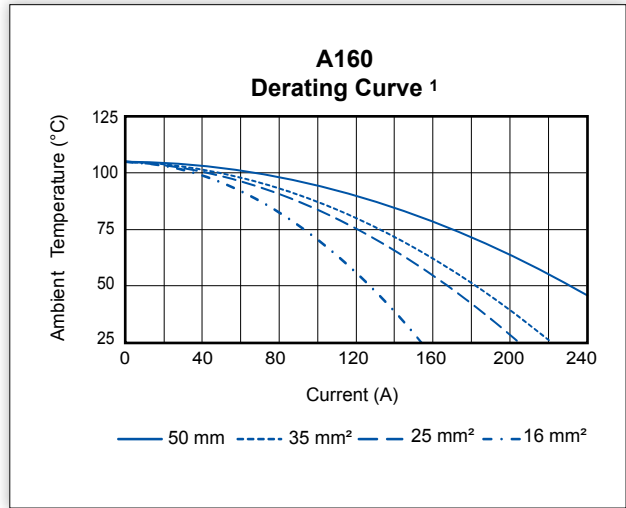
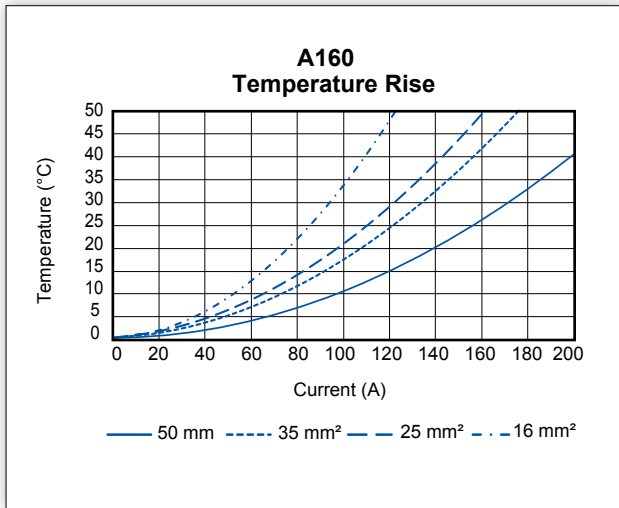
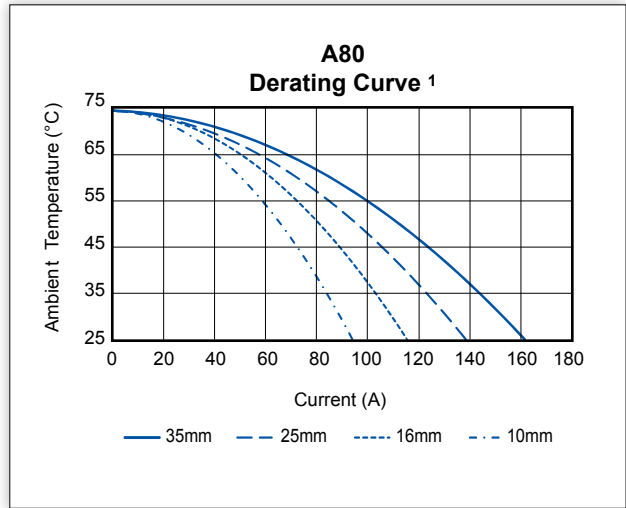
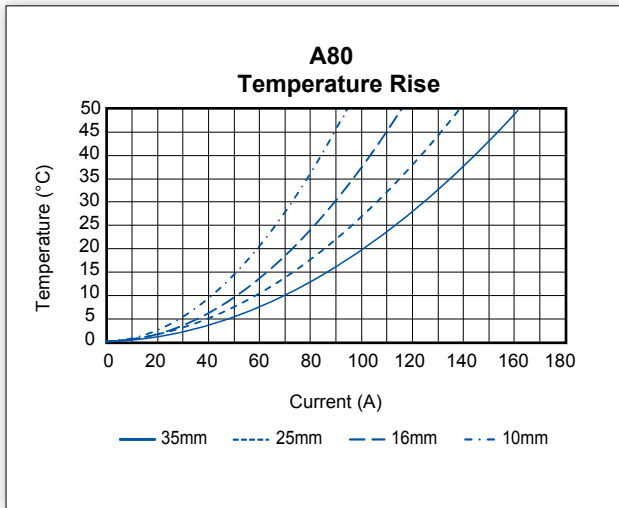

<sup>1</sup> 0.8 Derating per IEC 60512-3

NOTE 1: Temperature ratings based on power contacts energized only.

NOTE 2: Temperature rise charts are based on a 25°C ambient temperature.

# ORDERING INFORMATION

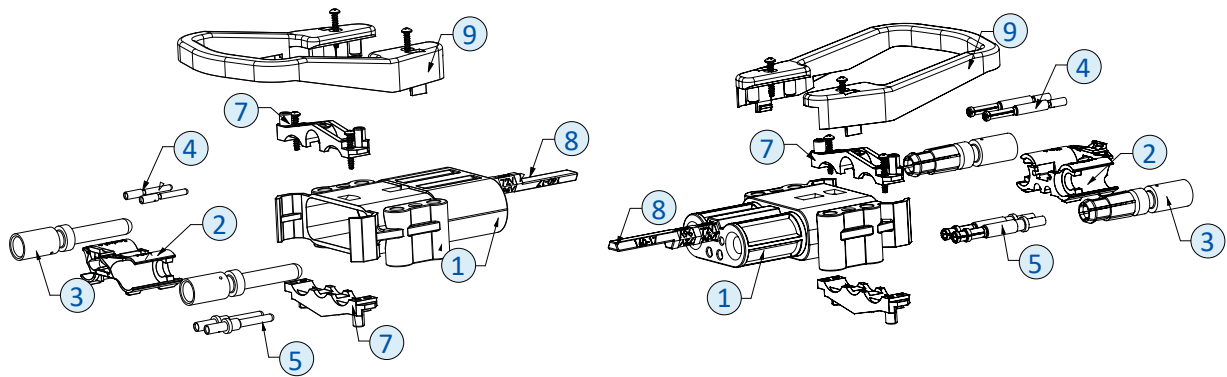

## Components

Item Number	Description - mm <sup>2</sup> (AWG)	A80		A160		A320	
		Male	Female	Male	Female	Male	Female
3	<b>Power Contacts</b>						
	Power Contact 10 mm <sup>2</sup> (8 AWG)	80-1010	80-1110	N/A	N/A	N/A	N/A
	Power Contact 16 mm <sup>2</sup> (6 AWG)	80-1016	80-1116	160-1016	160-1116	N/A	N/A
	Power Contact 25 mm <sup>2</sup> (4 AWG)	80-1025	80-1125	160-1025	160-1125	N/A	N/A
	Power Contact 35 mm <sup>2</sup> (2 AWG)	80-1035	80-1135	160-1035	160-1135	N/A	N/A
	Power Contact 50 mm <sup>2</sup> (1 AWG to 1/0)	N/A	N/A	160-1050	160-1150	320-1050	320-1150
	Power Contact 70 mm <sup>2</sup> (2/0 to 3/0)	N/A	N/A	N/A	N/A	320-1070	320-1170
	Power Contact 95 mm <sup>2</sup> (3/0 to 4/0)	N/A	N/A	N/A	N/A	320-1095	320-1195
	Power Contact 120 mm <sup>2</sup> (4/0)	N/A	N/A	N/A	N/A	320-1004	320-1104
4	Upper Auxiliary Contact 4mm <sup>2</sup> (12 AWG)	NA	NA	160-14	160-15	160-14	160-15
	Upper Auxiliary Contact 1.5mm/2.5 mm - (18/14 AWG)	E80-32	E80-33	320-24	320-25	320-24	320-25
5	Lower Pilot Auxiliary Contact 6mm <sup>2</sup> (10 AWG)	NA	NA	160-12	160-13	160-12	160-13
	Lower Pilot Auxiliary Contact 1.5mm / 2.5 mm - (18/14 AWG)	E80-30	E80-31	320-22	320-23	320-22	320-23
8	<b>Voltage Coding Pins</b>						
	Grey Coding Pin - Wet (160 and 320 use same Coding Pins)	80-9	80-9	160-9	160-9	160-9	160-9
	Green Coding Pin - Dry (160 and 320 use same Coding Pins)	80-17	80-17	160-17	160-17	160-17	160-17
	* Yellow Coding Pin - Universal (160 and 320 use same Coding Pins)	80-19	Not Used	160-19	Not Used	160-19	Not Used
9	** Handle - High Profile with screws	N/A	N/A	32-89	32-89	32-89	32-89
	** Handle - Low Profile with screws	80-89	80-89	16-89	16-89	16-89	16-89
	Handle Red - Low Profile with screws	80-8-R	80-8-R	N/A	N/A	N/A	N/A
1	Housing Only	80-1	80-2	160-1	160-2	320-1	320-2
2	Contact Holder	80-5B	80-5B	160-5	160-5	320-5	320-5
7	Cable Clamps with Screws	80-67	80-67	160-67	160-67	320-67	320-67
1+2+7+8	Male Housing with Contact Holder and Cable Clamp with Screws (Gray Key) - Individual Pack	A80400-0009		A16400-0009		A32400-0009	
1+2+7+8	Female Housing with Contact Holder, **** Lower Pilot Auxiliary Holder, Cable Clamps with Screws - (Gray Key) - Individual Pack		A80500-0009		A16500-0009		A32500-0009
1+2+7+8	Male Housing with Contact Holder and Cable Clamp with Screws (Green Key) - Individual Pack	A80400-0209		A16400-0209		A32400-0209	
1+2+7+8	Female Housing with Contact Holder, **** Lower Pilot Auxiliary Holder, Cable Clamps with Screws - (Green Key) - Individual Pack		A80500-0209		A16500-0209		A32500-0209
1+2+7+8	Male Housing with Contact Holder and Cable Clamp with Screws (Yellow Key) - Individual Pack	A80400-0309		A16400-0309		A32400-0309	

\* Universal yellow coding key is only used on male connectors

\*\* ABC 160 and ABC 320 handles work with both the ABC 160 and ABC 320 series connectors

# PART NUMBER CONFIGURATOR

## A80 Connector Part Number Selection

Series	Gender	Main Contact	Handle	Coding Key	Auxiliary Contacts	Packing
A80	4 or 5	25	- 1	0	0	9
4	Male					9 Individual
5	Female					8 Bulk
00	None - Order Separately				0 None	
10	10 mm <sup>2</sup> (#8 AWG)				A (2) Lower Pilot Auxiliary Contacts	
16	16 mm <sup>2</sup> (#6 AWG)				B (2) Upper Auxiliary Contacts	
25	25 mm <sup>2</sup> (#4 AWG)				C (2) Lower Pilot Auxiliary Contacts & (2) Upper Auxiliary Contacts	
35	35 mm <sup>2</sup> (#2 AWG)					
0	No		0	Grey, Wet Cell		
1	Black		2	Green, Dry Cell		
2	Red		3	Yellow, Universal (use with male housing only)		

## A160 Connector Part Number Selection

Series	Gender	Main Contact	Handle	Coding Key	Auxiliary Contacts	Packing
A16	4 or 5	25	- 1	0	0	9
4	Male					9 Individual
5	Female					8 Bulk
00	None - Order Separately				0 None	
16	16 mm <sup>2</sup> (#6 AWG)					mm <sup>2</sup> AWG
25	25 mm <sup>2</sup> (#4 AWG)				A (2) Lower Auxiliary Contacts	6 10
35	35 mm <sup>2</sup> (#2 AWG)				B (2) Upper Auxiliary Contacts	4 12
50	50 mm <sup>2</sup> (1/0 AWG to #1 AWG)				C (2) Lower Auxiliary Contacts & (2) Upper Auxiliary Contacts	6 10
0	No				D (2) Lower Auxiliary Contacts	4 12
1	Black				E (2) Upper Auxiliary Contacts	1.5/2.5 18/14
			0	Grey, Wet Cell	F (2) Lower Auxiliary Contacts & (2) Upper Auxiliary Contacts	1.5/2.5 18/14
			2	Green, Dry Cell		1.5/2.5 18/14
			3	Yellow, Universal (use with male housing only)		1.5/2.5 18/14

## A320 Connector Part Number Selection

Series	Gender	Main Contact	Handle	Coding Key	Auxiliary Contacts	Packing
A32	4 or 5	50	- 1	0	0	9
4	Male					9 Individual
5	Female					8 Bulk
00	None - Order Separately				0 None	
50	50 mm <sup>2</sup> (1/0 AWG to #1 AWG)					mm <sup>2</sup> AWG
70	70 mm <sup>2</sup> (2/0 AWG to 3/0 AWG)				A (2) Lower Auxiliary Contacts	1.5/2.5 18/14
95	95 mm <sup>2</sup> (3/0 AWG to 4/0 AWG)				B (2) Upper Auxiliary Contacts	1.5/2.5 18/14
12	120 mm <sup>2</sup> (4/0 AWG)				C (2) Lower Auxiliary Contacts & (2) Upper Auxiliary Contacts	1.5/2.5 18/14
0	No				D (2) Lower Auxiliary Contacts	6 10
1	Black				E (2) Upper Auxiliary Contacts	4 12
			0	Grey, Wet Cell	F (2) Lower Auxiliary Contacts & (2) Upper Auxiliary Contacts	6 10
			2	Green, Dry Cell		4 12
			3	Yellow, Universal (use with male housing only)		

**Packaging:** Individual (Kits) - all components for a complete connector are packaged together in individual bags within one box. Bulk (Kits) - all components required are packaged separately by part number selected in one bag/box. **Handles:** A80 comes with the low profile T handle • A160 comes with the low profile handle • A320 comes with the high profile handle.

# DRAWINGS



Housing Dimensions							
		A80		A160		A320	
		mm	in	mm	in	mm	in
<b>Male Housings</b>	A	68.0	2.68	83.5	3.29	89.5	3.52
	B	74.4	2.93	103.8	4.09	123.5	4.86
	C	26.1	1.03	33.4	1.31	40.8	1.61
<b>Female Housings</b>	A	68.0	2.68	83.5	3.29	89.5	3.52
	B	73.8	2.91	104.0	4.09	117.0	4.61
	C	26.1	1.03	32.6	1.28	37.6	1.48

**Male Front View**

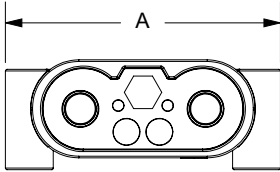

**Male Top View**

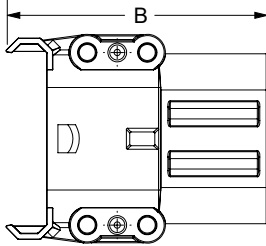

**Male Side View**

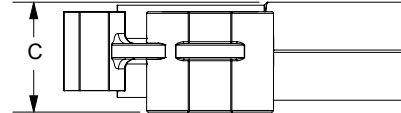

**Female Front View**

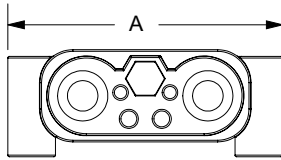

**Female Top View**

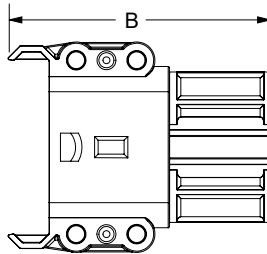

**Female Side View**

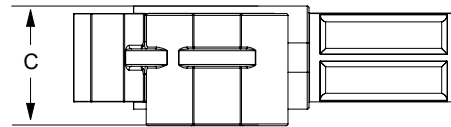

## Dimensions of Housings With Handles

		A80	
		mm	in
<b>Male Housings</b>	D	68.0	2.68
	E	41.2	1.62
	F	110.6	4.35
<b>Female Housings</b>	D	70.0	2.76
	E	41.2	1.62
	F	110.6	4.35

**A80 Male Housing with Handle**

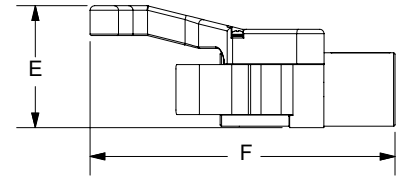
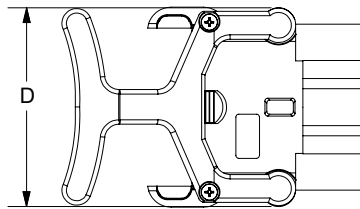

**A80 Female Housing with Handle**

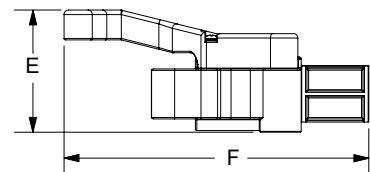
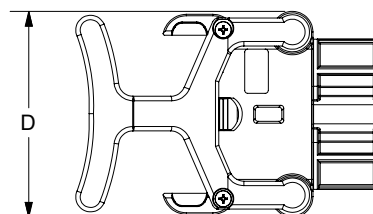

## A160 Handles

		Low Profile		High Profile				Low Profile		High Profile	
		mm	in	mm	in			mm	in	mm	in
<b>Male Housings</b>	D	101	4.0	106	4.2	<b>Female Housings</b>	D	101	4.0	106	4.2
	E	46	1.8	64	2.5		E	46	1.8	64	2.5
	F	168	6.6	167	6.6		F	173	6.8	172	6.8

### Male Housing Low Profile Handle

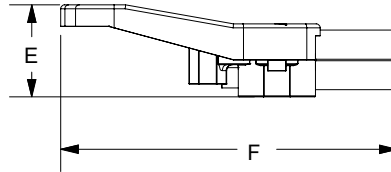
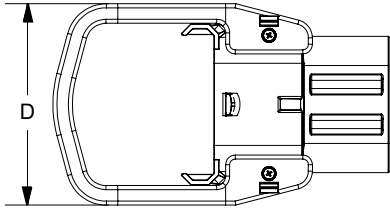

### Male Housing High Profile Handle

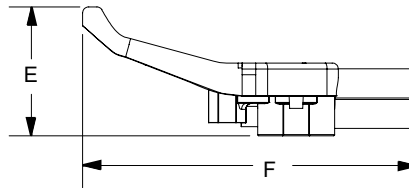
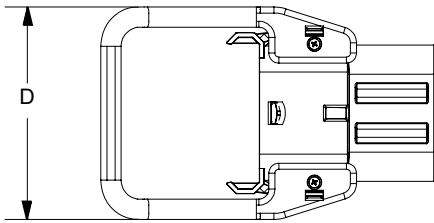

### Female Housing Low Profile Handle

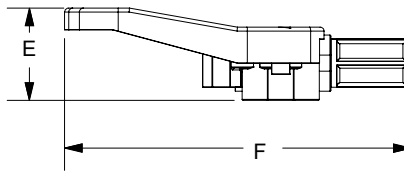
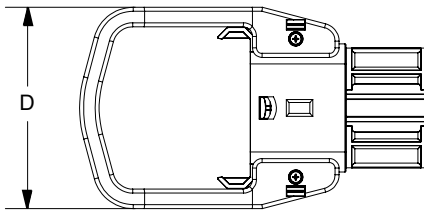

### Female Housing High Profile Handle

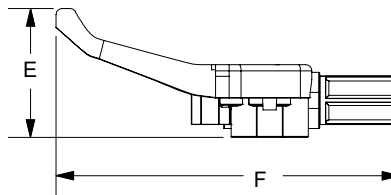
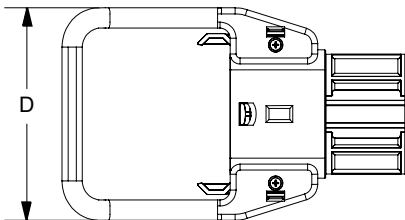



## A320 Handles

		Low Profile		High Profile				Low Profile		High Profile	
		mm	in	mm	in			mm	in	mm	in
<b>Male Housings</b>	D	101	4.0	106	4.2	<b>Female Housings</b>	D	101	4.0	106	4.2
	E	54	2.1	72	2.8		E	53	2.1	71	2.8
	F	175	6.9	174	6.9		F	171	6.7	173	6.8

### Male Housing Low Profile Handle

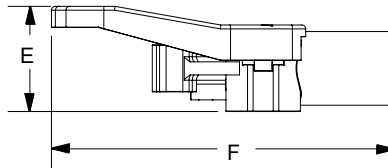
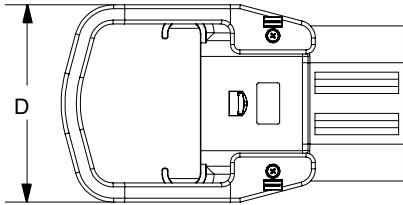

### Male Housing High Profile Handle

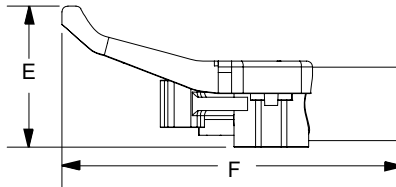
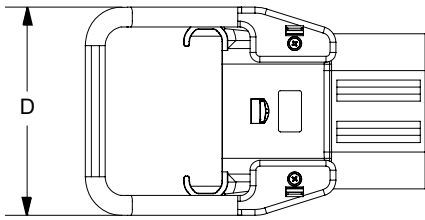

### Female Housing Low Profile Handle

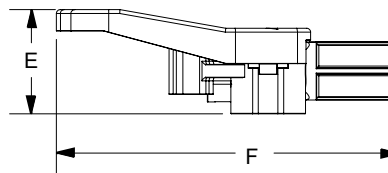
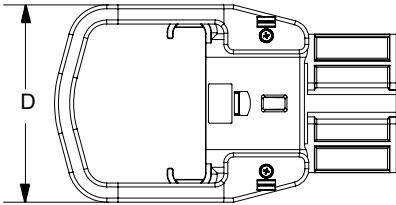

### Female Housing High Profile Handle

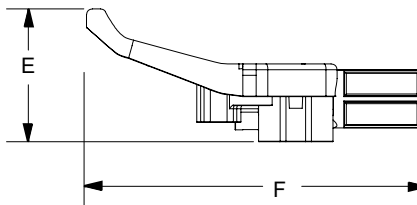
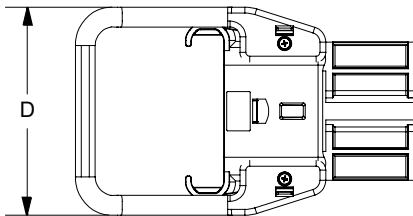

**Latch Plate 160 & 320**  
**P/N: A320-LP**

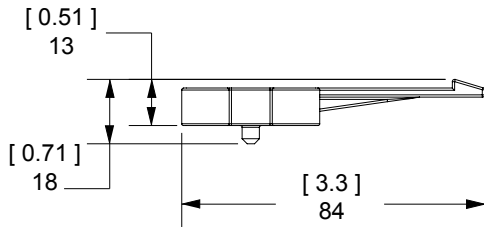
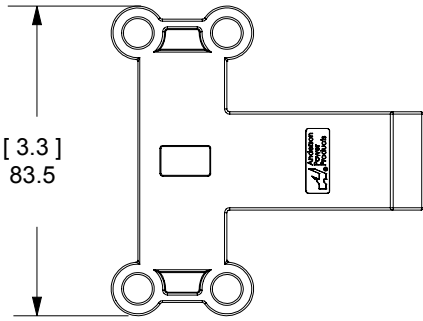

**Latch Plate on**  
**A160 & 320 Male Housing**

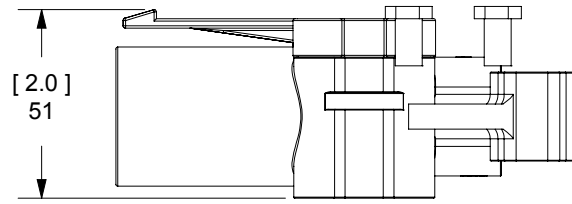

**Handle & Lever Assembly**  
**on A160 & 320 Female Housing:**  
**P/N: A320HL**

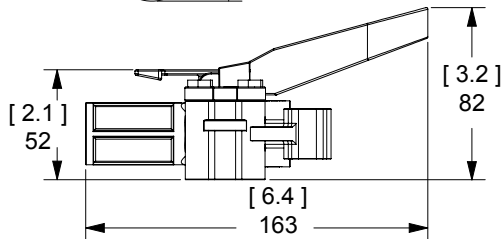
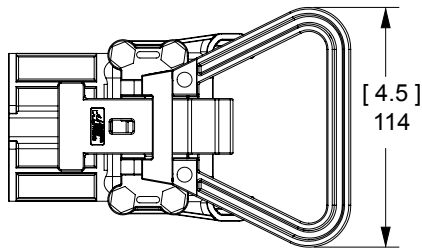

**Manual Release for A160 & 320  
P/N: 994G4**

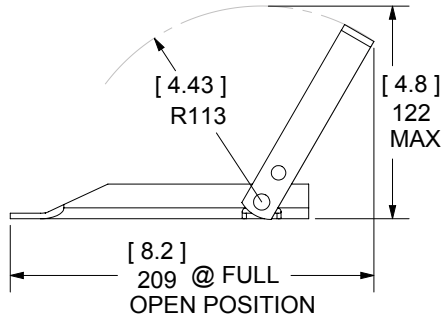
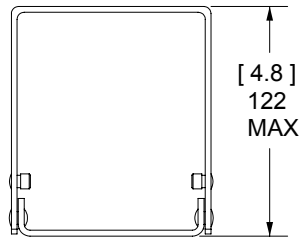
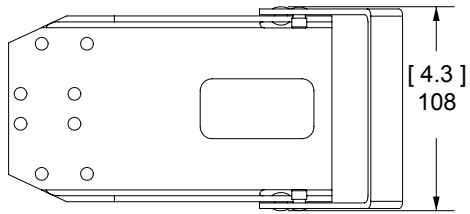

**Battery Bracket - P/N: 993G4**

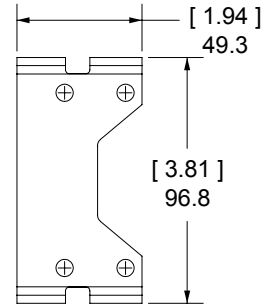

**Manual Release with Connectors**

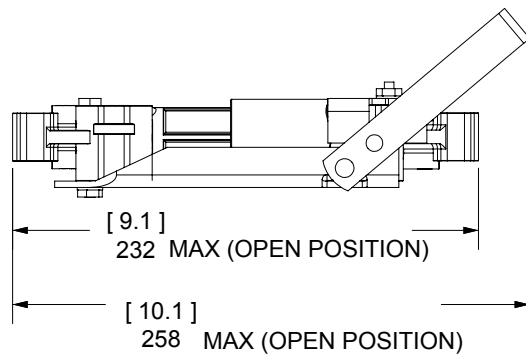
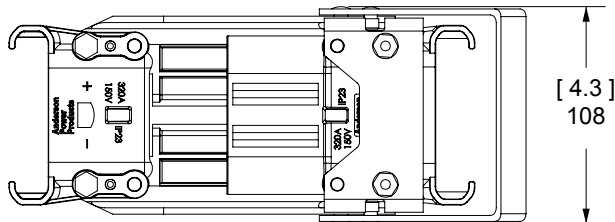

Contacts						
Series	Wire Size		OD		ID	
	Metric	AWG	mm	in	mm	in
A80	10 mm <sup>2</sup>	#6 to 8	6.0	0.24	4.5	0.18
A80 / 160	16 mm <sup>2</sup>	#4 to 6	8.4	0.33	6.0	0.24
	25 mm <sup>2</sup>	#2 to 4	11.0	0.43	8.0	0.31
A160 / 320	35 mm <sup>2</sup>	#1 to 2	12.5	0.49	9.0	0.35
	50 mm <sup>2</sup>	#1 to 1/0	14.5	0.57	11.0	0.43
A320	70 mm <sup>2</sup>	2/0 to 3/0	17.0	0.67	13.0	0.51
	95 mm <sup>2</sup>	3/0 to 4/0	19.8	0.78	15.0	0.59
	120 mm <sup>2</sup>	4/0	19.8	0.78	15.6	0.61



### Male Power Contact

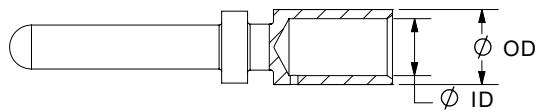

### Female Power Contact

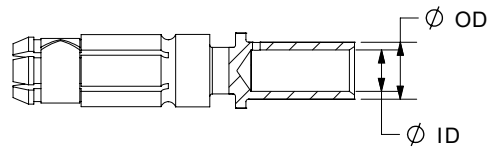

### Auxiliary Contacts

Series	Part Number	Position	mm <sup>2</sup>	AWG	OD		ID	
					mm	IN	mm	IN
A80	E80-32 / E80-33	Upper	1.5 / 2.5	18 / 14	3.9	0.15	2.2	0.09
	E80-30 / E80-31	Lower	1.5 / 2.5	18 / 14	3.9	0.15	2.2	0.09
A160	160-14 / 160-15	Upper	4	12	4.1	0.16	2.9	0.11
	320-24 / 320-25	Upper	1.5 / 2.5	18 / 14	4.6	0.18	2.2	0.09
A320	160-12 / 160-13	Lower	6	10	5	0.2	3.9	0.15
	320-22 / 320-23	Lower	1.5 / 2.5	18 / 14	4.6	0.18	2.2	0.09

### Upper Auxiliary Pin Typical of A80

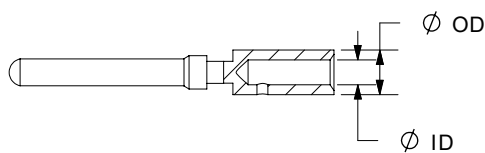

### Upper Auxiliary Socket Typical of A80

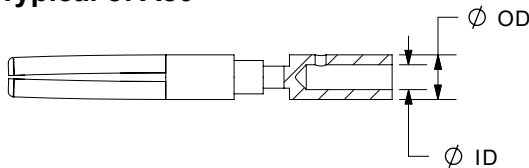

### Upper Auxiliary Pin Typical of A160 / 320

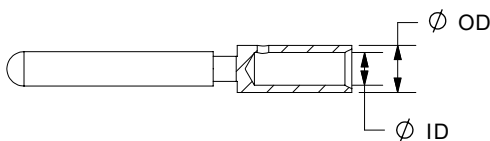

### Upper Auxiliary Socket Typical of A 160/ 320

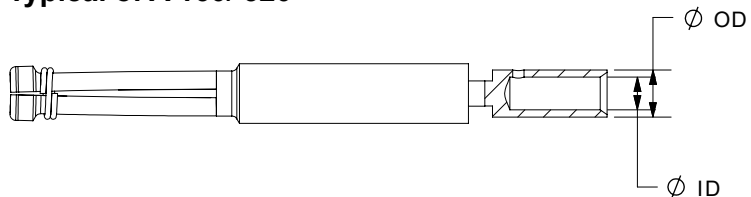

**Lower Pilot Auxiliary Pin  
Typical of A80**

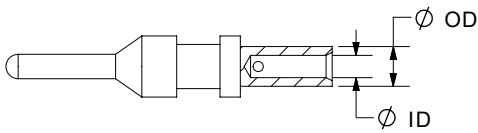

**Lower Auxiliary Socket  
Typical of A80**

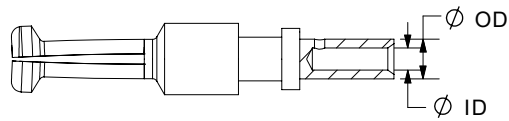

**Lower Pilot Auxiliary Pin  
Typical of A160 / 320**

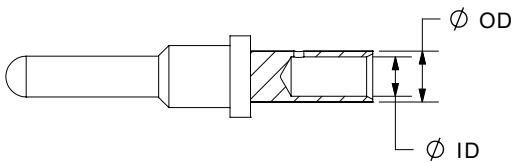

**Lower Auxiliary Socket  
Typical of A160 / 320**

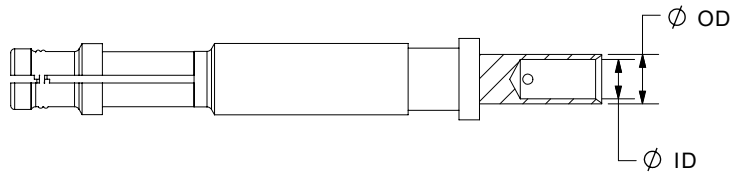

Wet / Dry Voltage Key					Universal Voltage Key				
Series	K		L		K		L		
	mm	in	mm	in	mm	in	mm	in	
A80	8.0	0.31	46	1.77	8.0	0.31	46	1.77	
A160 / 320	9.3	0.37	69	2.72	9.3	0.37	69	2.72	

**Wet / Dry Voltage Key - Grey or Green**

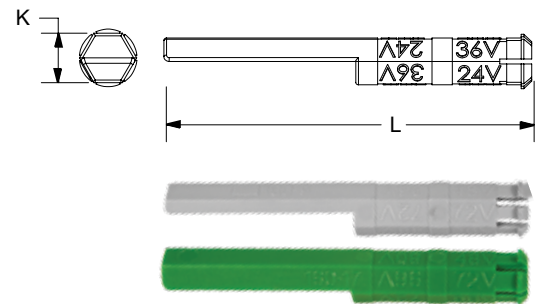

Keying Plug	Identification	Assembled In
	Used for Wet Cell Battery /Charger - Color Grey	Battery Receptacle and Charging Plug
	Used for Dry Cell Battery/Charger - Color Green	Battery Receptacle and Charging Plug
	Used for Vehicle only - Yellow (Universal)	Vehicle Plug only - used when vehicle may use wet or dry cell batteries.

**Universal Voltage Key - Yellow**  
(Use with male housing only)

Universal (Yellow) voltage keys are to be used exclusively at the vehicle side to permit both the use of wet-cell and dry-cell batteries.

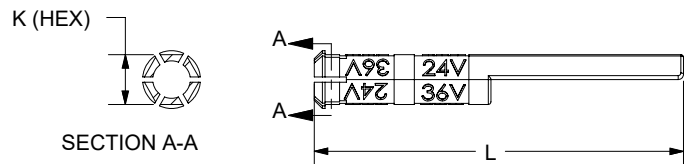

# TOOLING INFORMATION

A Series 80A, 160A, & 320A Hydraulic Tooling									
Wire Size		Part Numbers	Loose Piece Contact Crimp Tools						
mm <sup>2</sup>	AWG	Power Contact	Hydraulic Hand Bench Tool	+	Die	OR	Hydraulic Hand Bench Tool		
10 mm <sup>2</sup>	#8 to #6	80-1010	1387G3 OR 1370G1		1322G16		N/A		
		80-1110			1322G9				
	#6	80-1016			1322G10				
		80-1116							
16 mm <sup>2</sup>		80-1016			1322G15				
		80-1116							
25 mm <sup>2</sup>	#4 to #2	80-1025			N/A			N/A	
		80-1125							
35 mm <sup>2</sup>	#2 to #1	80-1035			1387G3 OR 1370G1				1322G9
		80-1135							
16 mm <sup>2</sup>	#6 to #4	160-1016	1322G12						
		160-1116							
25 mm <sup>2</sup>	#4 to #2	160-1025	1322G7						
		160-1125							
35 mm <sup>2</sup>	#2 to #1	160-1035	1322G4						
		160-1135							
50 mm <sup>2</sup>	#1 to 1/0	160-1050	1387G3 OR 1370G1			1322G4			
		160-1150							
50 mm <sup>2</sup>	1/0 AWG	320-1050			1322G3 (K) 8*				
		320-1150							
70 mm <sup>2</sup>	2/0 AWG	320-1070			1322G2				
		320-1170							
95 mm <sup>2</sup>	3/0 AWG	320-1095			1322G1				
		320-1195							
120 mm <sup>2</sup>	4/0 AWG	320-1004			N/A		N/A		
		320-1104							
Pilot/Auxiliary Contacts									
ALL	Pins		SOLDER ONLY						
	Sockets								

\*Use 1322G3 with K stranded wire only.



1370G1 & 1387G3



1368



1368-NL



1368-B

## A Series 80A, 160A, & 320A Pneumatic Tooling

Wire Size		Part Numbers	Loose Piece Contact Crimp Tools									
mm <sup>2</sup>	AWG	Power Contact	Pneumatic Bench Tool	+	Die	+	Locator (Single Crimp)					
10 mm <sup>2</sup>	#8 to #6	80-1010	N/A	+	N/A	+	N/A					
		80-1110										
16 mm <sup>2</sup>	#6 to #4	80-1016										
		80-1116										
25 mm <sup>2</sup>	#4 to #2	80-1025										
		80-1125										
35 mm <sup>2</sup>	#2 to #1	80-1035										
		80-1135										
mm <sup>2</sup>	AWG	Power Contact						Pneumatic Bench Tool	+	Die	+	Locator (Double Crimp)
16 mm <sup>2</sup>	#6 to #4	160-1016						1387G2	+	1303G14	+	1304G21 SOCKET 1304G20 PIN
		160-1116	1303G13									
25 mm <sup>2</sup>	#4 to #2	160-1025										
		160-1125										
35 mm <sup>2</sup>	#2 to #1	160-1035										
		160-1135										
50 mm <sup>2</sup>	#1 to 1/0	160-1050										
		160-1150	1303G8									
50 mm <sup>2</sup>	#1 to 1/0	320-1050	1387G2	+	1303G8	+	1304G29 Pins 1304G18 Sockets					
		320-1150			1303G11							
70 mm <sup>2</sup>	2/0 AWG	320-1070										
		320-1170										
95 mm <sup>2</sup>	3/0 AWG	320-1095										
	4/0 AWG	320-1195										
120 mm <sup>2</sup>	4/0 AWG	320-1004										
		320-1104			1303G3							
Pilot/Auxiliary Contacts												
ALL		All Crimp Pins			SOLDER ONLY							
		All Crimp Sockets										



1387G1 & 1387G2

# ADDITIONAL PRODUCTS FOR INDUSTRIAL VEHICLES

## EBC Series

- Meets DIN 43589-1
- Meets EN1175-1
- Chemical Resistant Plastic
- RoHS Compliant



### HEADQUARTERS

Anderson Power Products®  
13 Pratts Junction Road  
Sterling, MA 01564-2305 USA  
T: 978-422-3600  
F: 978-422-0128

### EUROPE

Anderson Power Products® Ltd.  
Unit 3 Europa Court  
Europa Boulevard  
Westbrook, Warrington  
Cheshire, WA5 7TN United Kingdom  
T: +44 (0) 1925 428390  
F: +44 (0) 1925 520203

### ASIA / PACIFIC

IDEAL Anderson Asia Pacific Ltd.  
Unit 922-928, Topsail Plaza  
11 On Sum Street  
Shatin N.T., Hong Kong  
T: +(852) 2636 0836  
F: +(852) 2635 9036

### CHINA

IDEAL Anderson Technologies (Shenzhen) Ltd.  
Block A8, Tantou Western Industrial Park  
Songgang, Baoan District  
Shenzhen, P.R. China 518105  
T: +(86) 755 2768 2118/3393 2388  
F: +(86) 755 2768 2218

### TAIWAN

IDEAL Anderson Asia Pacific Ltd.  
Taiwan Branch, 4F.-2, No.116  
Dadun 20th St., Situn District  
Taichung City 407, Taiwan (R.O.C.)  
T: +(886) 4 2310 6451  
F: +(886) 4 2310 6460

### INDIA

IDEAL INDUSTRIES India Private Limited  
229-230, SPAZEDGE, Tower B  
Sector 47, Sohna Road, Gurgaon – 122018  
Haryana, India  
T: +(91) 956 007 5905  
www.ideal-Industries.in



An IDEAL Company

2020-0013

DS-DIN-A REV 2

VISIT US AT [WWW.ANDERSONPOWER.COM](http://WWW.ANDERSONPOWER.COM)





# Mouser Electronics

Authorized Distributor

Click to View Pricing, Inventory, Delivery & Lifecycle Information:

## Anderson Power Products:

[160-12](#) [160-13](#) [160-14](#) [160-15](#) [320-1004](#) [320-1050](#) [320-1070](#) [320-1095](#) [320-1104](#) [320-1150](#) [320-1170](#) [320-1195](#) [320-22](#) [320-23](#) [320-24](#) [320-25](#) [32-89](#) [80-89](#) [A16400-0009](#) [A16500-0009](#) [A320HL-MK](#) [A320LP-MK](#) [A32400-0009](#) [A32404-00C9](#) [A32500-0009](#) [1322G15](#) [1322G4](#) [1387G3](#) [16-89](#) [994G4](#) [993G4](#) [A32400-0309](#) [320-67](#) [80-67](#) [160-67](#) [A32400-0008](#) [A80400-0009](#) [A80500-0009](#) [A16435-10C9](#) [A16535-00A9](#) [A16535-10C9](#) [A32401-0209](#) [A32401-0309](#) [A32401-10B9](#) [A32402-0309](#) [A32403-1309](#) [A32404-10A9](#) [A32495-10C9](#) [A32501-10B9](#) [A32502-0209](#) [A32503-00A9](#) [A32503-13C9](#) [A32504-00A9](#) [A32550-0309](#) [A32595-10C9](#)