

1.Physical Characteristics(mm)

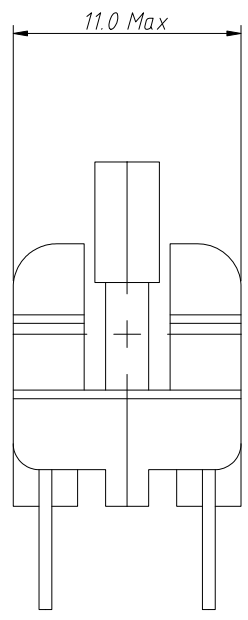

2.Electrical Schematic

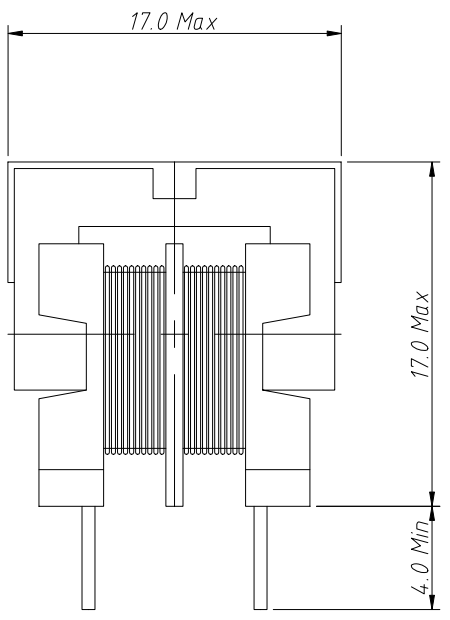
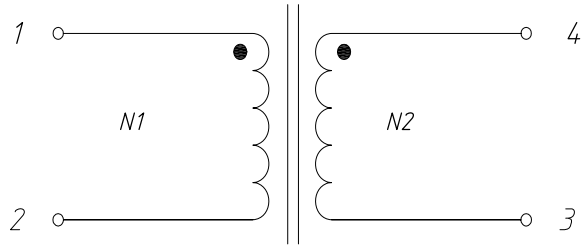

3.Electrical Specifications
 L:0.5mHMin@1.0KHz,1V
 DCR:0.3 Ω Max
 IDC:1.0A Max(Temp.Rise 40° Max)
 Rated Voltage: 250V AC
 Hi-Pot:Prito Sec:2400V AC,2S
 Insulation Resistance:100MΩ Min,500V DC
 Operating Temperature:-40°C ~ +105°C,

Note:
 1.Solderability:Leads Shall Meet MIL-STD-202 Method 208D for Solderability
 2.Flammability:UL 94 V-0
 3.ASTM Oxygen Index:>28%

Test Instrument:L:HP4284A RDC:HM2540

Order Information

L-KLS18-LF1717-501Y-1.0A

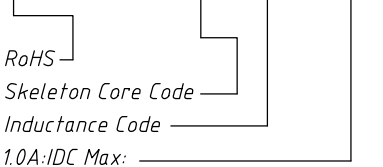

Rating AC/DC Current A @ 40 Hi-Pot
 2500V AC Winding To Winding 3S

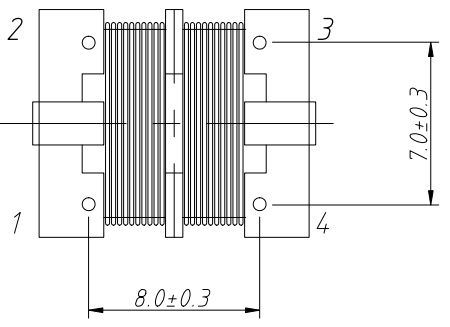

ANGLE TOLERANCE	PROJECTION	Description:	Common Mode Inductor	
±3°				
GENERAL TOLERANCE	UNITS	mm	KLS P/N:	L-KLS18-LF1717-501Y-1.0A
x.x ±0.30	SHEET SIZE	A4		
x.xx ±0.20	Draw:	Song	2023-08-04	
x.xxx ±0.10	Check:	Daniel	2023-08-04	

NingBo KLS ELECTRONIC CO.,L TD.