

# KLS ELECTRONIC CO., LTD.

TEL: 86-574-86828566

## SPECIFICATION 仕様图

FAX: 86-574-86824882

SPECIFICATION FOR:		DATE: 2013. 12. 31
KLS P/N: AC9E-101K	ISSUE NO:	SAMPLE QTY: PCS

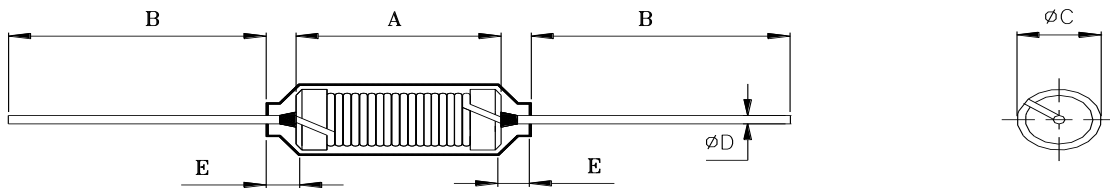

A: 13.0Max	B: 20.0±2.0	C: 10.0 Max	D: 0.6±0.05
E: 2.5±0.5			

### 2. ELECTRIC CHARACTERISTICS: (电气特性)

INDUCTANCE: 100UH±10%	TEST FREQ: 1KHZ/0.25V	DCR: Ω Max
URNS: 51.5T (REF)	IDC: mA Max	RDC:
Q:	SRF:	TEMP:

### 3. TEST EQUIPMENT: (测试仪器)

<input type="checkbox"/> MQ-1601 (Q-METER)	<input type="checkbox"/> CH-301A (CURRENT METER)
<input type="checkbox"/> HL-2801 (ANALIZER)	<input type="checkbox"/> SK-3005 (INSULATION ESTER)
<input type="checkbox"/> CH-100 (LCR-METER)	<input type="checkbox"/> CH-852A (HIGH POT TEST METER)
<input type="checkbox"/> CH-1062 (LCZ-METER)	<input type="checkbox"/> OTHERS

### 4. MATERIALS: ( ) (材料)

CORE: AC9e LIWANDA	PIN:	
WIRE: ∅ 0.45m/m 2UEW	KG/KPC	
SLEEVE: UL TUBE (∅ MARK G: AC9E-101K	COLOR : BLACK ) MM/PCS	
VARNISH:	BOBBIN & BASE:	
COATING:	N. W: KG/PCS	PACKING: 胶袋

### 5. REVISION FROM: TO: REV, DATE:

6. APPROVED BY CUSTOMER:	DRAWN BY:	CHECKED BY:	APPROVED BY:
	ZhuanJiaHao	ChengHaiLan	FangShuXian