

ASS'Y P/N	CABLE O.D.
8280-XPG-513	.13-.15 [3.3-3.8]
8280-XPG-516	.16-.18 [4.1-4.6]
8280-XPG-519	.19-.21 [4.8-5.3]
8280-XPG-522	.22-.25 [5.6-6.4]
8280-XPG-526	.25-.27 [6.3-6.8]
8280-XPG-528	.265-.285 [6.6-7.1]

ASSEMBLY P/N	CONTACT QTY
8280-2PG-5XX	2 #20
8280-3PG-5XX	3 #20
8280-4PG-5XX	4 #20
8280-5PG-5XX	5 #20
8280-6PG-5XX	6 #20
8280-7PG-5XX	7 #20
8280-8PG-5XX	8 #20
8280-XPG-5XX	

NOTES:
 1. ALL PARTS TO BE BULK PACKED
 2. CONTACTS SHIPPED UNASSEMBLED
 3. ALL DIMENSIONS ARE REFERENCE EXCEPT THOSE WITH A TOLERANCE

CUSTOMER APPROVAL

THIS DOCUMENT CONTAINS CONFIDENTIAL INFORMATION PROPRIETARY TO CONXALL CORPORATION. ANY REPRODUCTION, DISCLOSURE, OR USE OF THIS DOCUMENT /INFORMATION IS EXPRESSLY PROHIBITED UNLESS AUTHORIZED IN WRITING BY CONXALL CORPORATION.

APPROVED BY: _____
 DATE: _____

CUSTOMER PRINT

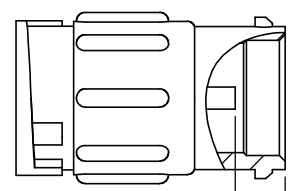

.173±.015
CONTACT HEIGHT

(2-8) #20 PIN CONTCT, CRIMP
 MAT'L: GOLD PLATED COPPER ALLOY

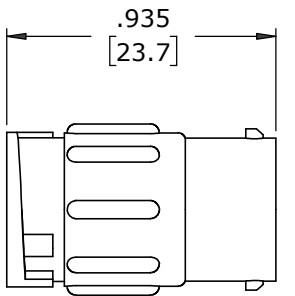

.935
[23.7]

IN-LINE CONNECTOR, MALE
 MAT'L: NYLON, BLACK

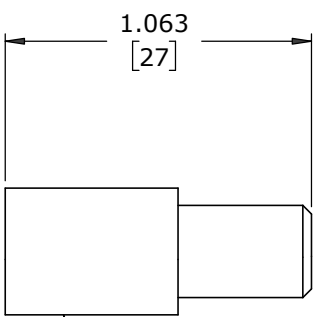

1.063
[27]

GROMMET
 MAT'L: RUBBER, BLACK

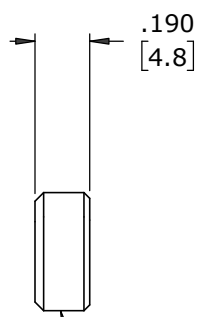

.190
[4.8]

CABLE GRIP
 MAT'L: POLYPROPYLENE, BLACK

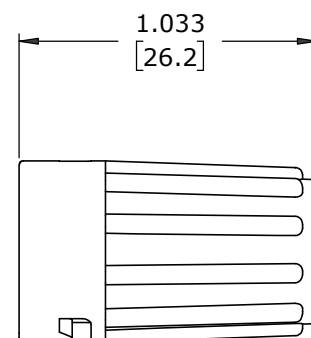

1.033
[26.2]

BACKSHELL
 MAT'L: NYLON, BLACK

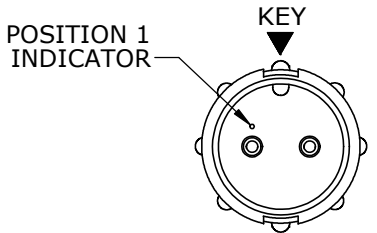

FACE VIEW
 8280-2PG-5XX SHOWN

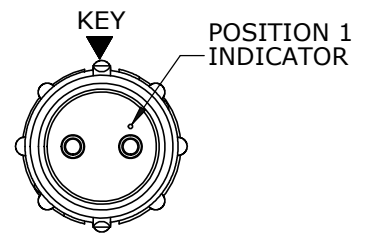

WIRE VIEW
 8280-2PG-5XX SHOWN

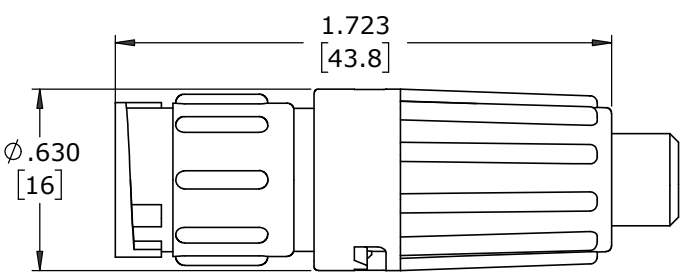

SHOWN ASSEMBLED
 FOR CUSTOMER REFERENCE ONLY

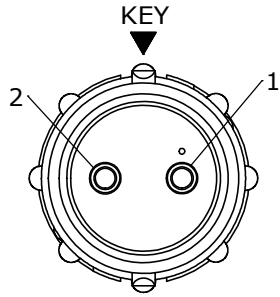

WIRE VIEW
 8280-2PG-5XX

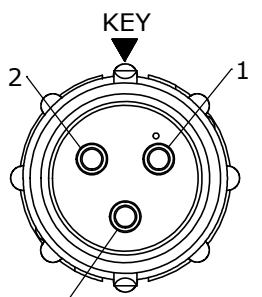

WIRE VIEW
 8280-3PG-5XX

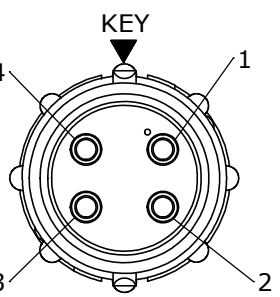

WIRE VIEW
 8280-4PG-5XX

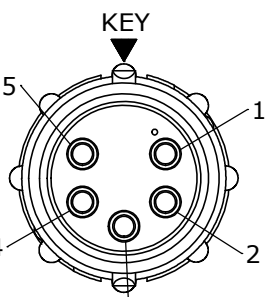

WIRE VIEW
 8280-5PG-5XX

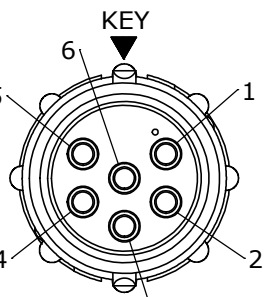

WIRE VIEW
 8280-6PG-5XX

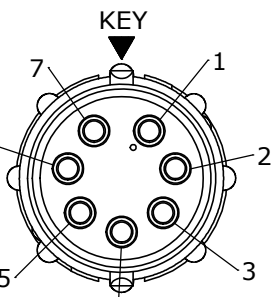

WIRE VIEW
 8280-7PG-5XX

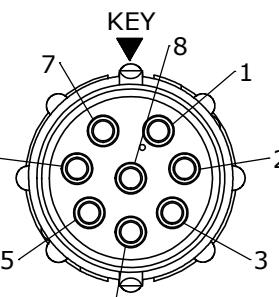

WIRE VIEW
 8280-8PG-5XX

DIMENSIONS IN BRACKETS [] ARE IN MILLIMETERS UNLESS INDICATED

RoHS COMPLIANT

PART NUMBER: 8280-XPG-5XX

A	MA	02-04-21	DRAWING CREATED PER DOR 21-S149SL-2	
REV.	INIT.	DATE	DESCRIPTION	
			ORIG. DRAWN BY: MA	DATE: 02-04-21
ALL INFORMATION ILLUSTRATED IS THE PROPERTY OF "CONXALL CORPORATION". UNAUTHORIZED DUPLICATION OR DISTRIBUTION OF THIS DOCUMENT IS PROHIBITED.			 601 E. WILDWOOD VILLA PARK, IL 60181	
ALL UNITS ARE IN FEET, INCHES, FRACTION OF INCHES AND DECIMALS.				
APPROVED BY:			TITLE: IN-LINE CONNECTOR ASS'Y (2-8) #20 PIN CONTACTS, CRIMP MINI-CON-X	
SCALE: NTS			CUSTOMER: STANDARD PRODUCT	
SIZE: B			PART NUMBER: 8280-XPG-5XX	
SHEET: 1 OF 1			REV: A	
FILE: 8280-XPG-5XX			DIRECTORY: SLW	

Mouser Electronics

Authorized Distributor

Click to View Pricing, Inventory, Delivery & Lifecycle Information:

[Switchcraft:](#)

[8280-4PG-516](#) [8280-7PG-519](#) [8280-2PG-528](#)