

**DESCRIPTIONS:**

- Zinc alloy die cast housing and cylinder.
- Bright chrome plated standard.
- 7 pin tumbler mechanism.
- Steel made tubular keys, chrome plated, with plastic cover.
- Key may be withdrawn in one or both positions.
- Silver plated contacts and terminals.
- 2 position (off-on) 2 terminals.
- Hex nut mounted.
- 10000 combinations available.

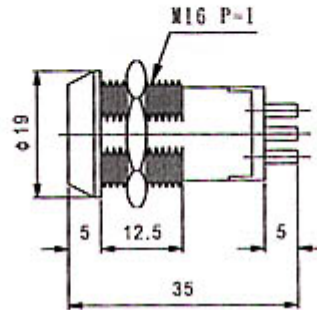

Unit: mm

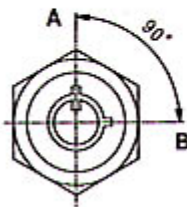

HOLE SIZE

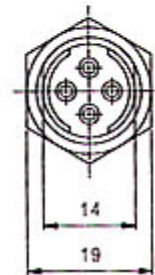
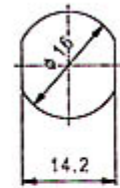

**KEY-PULL FIGURES**

- Off Position
- ┃-Indicates Key-Pull
- Indicates No Key-Pull

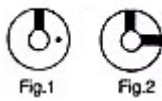

Fig. No.	Lock Number	Pole	Positions	Terminals	Key Pulls	Turn	⬆	⬇	Type
1	S314-1	1	2	4	1	90 °	On	On	SPDT
2	S314-2	1	2	4	2	90 °	On	On	SPDT