

<b>Technical Data Sheet:</b>	<b>DS563/0512</b>
<b>Product Description</b>	<b>Straight, fixed, external thread, nickel plated brass, FSU, FNU, FPU and LFHU conduit fitting.</b>
<b>Product Range</b>	<b>FSU - M Type fitting (Metric Threads)</b>

Roman Way, Coleshill  
Birmingham  
B46 1HG, United Kingdom  
Tel: 00 44 (0)1675 466900  
Website: www.flexicon.uk.com

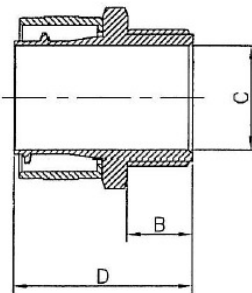
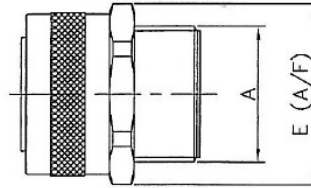
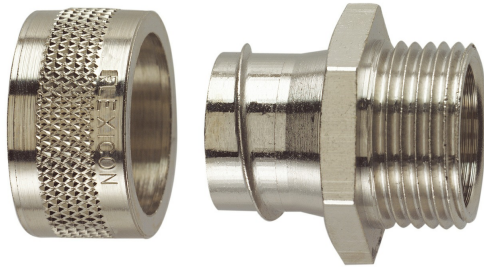

Conduit Size	Part No.	Metric Thread	Nominal Dimension (mm)			
			A	B	C	D
10	FSU10-M12-M	M12 X 1.5	8.0	5.6	21.0	13.0
12	FSU12-M16-M	M16 X 1.5	8.0	8.5	23.0	17.0
16	FSU16-M16-M	M16 X 1.5	10.0	11.5	25.0	20.0
16	FSU16-M20-M	M20 X 1.5	10.0	11.5	25.0	22.0
20	FSU20-M20-M	M20 X 1.5	10.0	15.3	26.3	24.0
25	FSU25-M25-M	M25 X 1.5	10.0	19.1	32.5	29.0
32	FSU32-M32-M	M32 X 1.5	13.0	26.2	36.8	36.0
40	FSU40-M40-M	M40 X 1.5	14.0	34.6	39.0	48.0
50	FSU50-M50-M	M50 X 1.5	15.0	44.7	42.0	58.0
63	FSU63-M63-M	M63 X 1.5	18.0	54.5	50.0	70.0
75	FSU75-M75-M	M75 X 1.5	20.0	66.5	60.0	84.0

**Material:**

Nickel Plated Brass

**Colour:**

Self colour

**Fire Performance:**

Inherently Low Fire Hazard



**IP Rating:**

• IP54

**Applications:**

Suitable for knockouts.  
Two part fitting comprising of shell and body.

**Features:**

- High tensile strength
- Oil resistant
- Corrosion resistant
- Conforms to EN 61386

Note: also available in PG and stainless steel versions and swivel versions.

**Temperature Performance:**

-50°C to +300°C

**Compliance, Approvals & Accreditation;**



**Typical Applications;**



Errors, omissions and amendments excepted. As part of continuing product development Flexicon Ltd reserve the right to alter product specifications without prior notice. Data given is correct at time of compilation. Product specification and application data is for guidance only and does not constitute a warranty of any kind, either expressed or implied for Flexicon products or their suitability for a specific purpose. Third party approvals maybe limited to certain sizes within a product range.