

escap 26N58 & 26N48

Precious metal commutation system - 9 segments

D.C. Motor
5,7 Watt

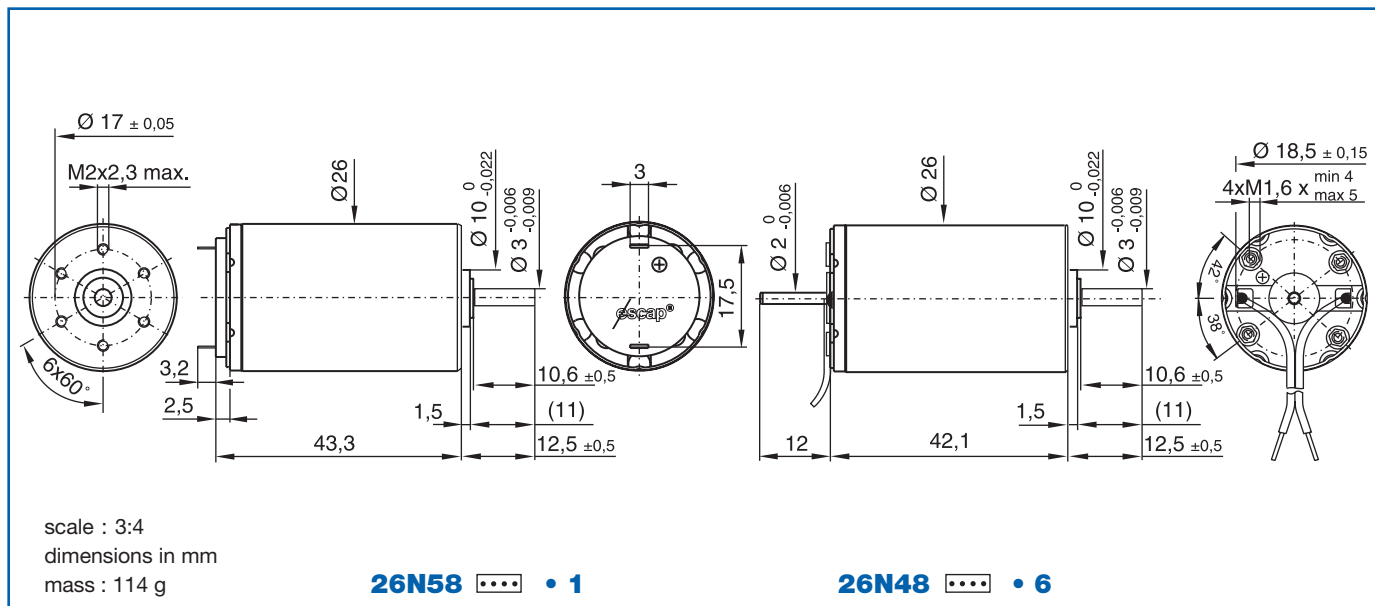

Winding types	[]	-216P	-113P	-216E	-113	-110
Measured values						
1 Measuring voltage	V	6	7.5	12	15	24
2 No-load speed	rpm	4500	5500	4700	5400	6700
3 Stall torque	mNm (oz-in)	29.6 (4.19)	25.5 (3.6)	28.6 (4.06)	26 (3.7)	25 (3.54)
4 Average no-load current	mA	31	30	16	15	12
5 Typical starting voltage	V	0.08	0.1	0.15	0.2	0.28
Max. recommended values						
6 Max. continuous current	A	1.26	1.25	0.86	0.64	0.34
7 Max. continuous torque	mNm (oz-in)	15.2 (2.2)	15.7 (2.2)	20 (2.8)	16.2 (2.3)	11 (1.56)
8 Max. angular acceleration	10 ³ rad/s ²	63	66	84	68	46
Intrinsic parameters						
9 Back-EMF constant	V/1000 rpm	1.29	1.35	2.5	2.7	3.5
10 Torque constant	mNm/A (oz-in/A)	12.3 (1.74)	12.9 (1.83)	23.9 (3.38)	25.8 (3.65)	33.5 (4.74)
11 Terminal resistance	ohm	2.5	3.8	10	16	32
12 Motor regulation R/k ²	10 ³ /Nms	16	23	17	24	29
13 Rotor inductance	mH	0.2	0.3	0.8	1.1	1.7
14 Rotor inertia	kgm ² · 10 ⁻⁷	8.5	6.7	8.5	6.7	5.3
15 Mechanical time constant	ms	14	15	15	15	19

Availability: see enclosed document at the end of the catalogue

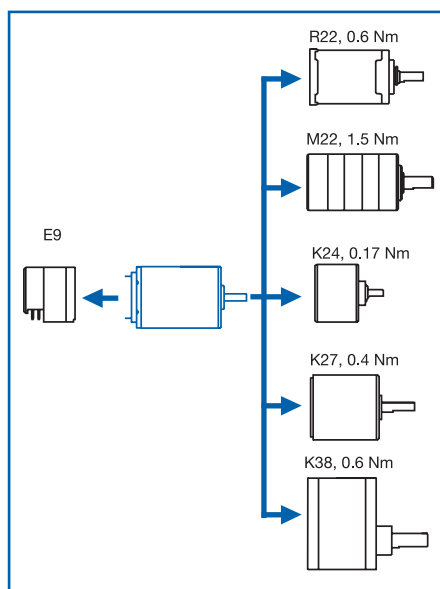

- Thermal resistance :
rotor-body 5 °C/W
body-ambient 12 °C/W
- Thermal time constant - rotor / stator :
10 s / 640 s
- Max. rated coil temperature : 100°C (210°F)
- Recom. ambient temperature range :
-30 °C to +65 °C (-22 °F to +150 °F)
- Viscous damping constant :
0.45 x 10⁻⁶ Nms
- Max. axial static force for press-fit : 250 N
- End play : ≤ 150 µm
Radial play : ≤ 30 µm
Shaft runout : ≤ 10 µm
- Max. side load at 5 mm from mounting face
- sleeve bearings 6 N
- ball bearings 8 N
- Motor fitted with sleeve bearings
(ball bearings optional)

