

IT-1102W~1102WA

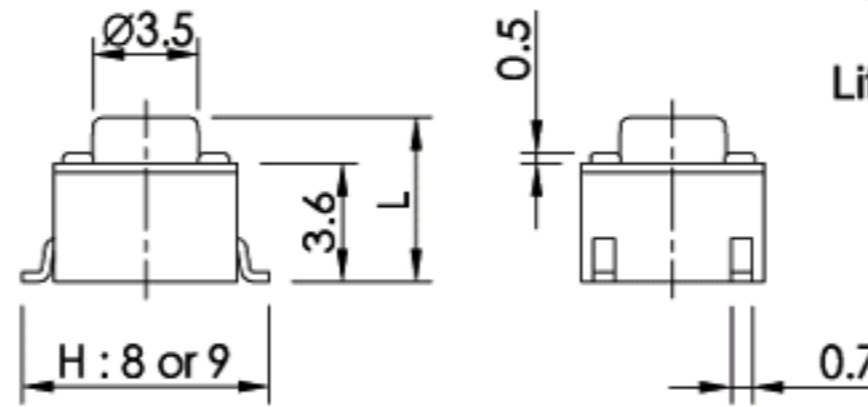

MODEL NO.	STEM (L)
IT-1102W	4.3
IT-1102WA	5.0

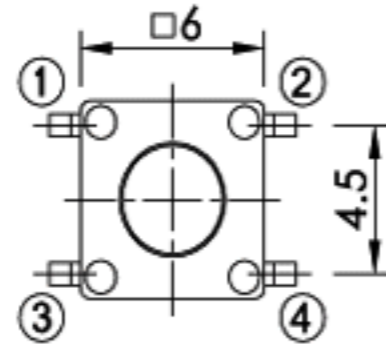

Rating : 50mA 12V DC.
 Travel : 0.25±0.15 mm.
 Contact resistance : 100mΩ Max.
 Operating force : 100, 130, 160, 250±50g.
 Life : 100,000 Cycles Min.

CIRCUIT DIAGRAM

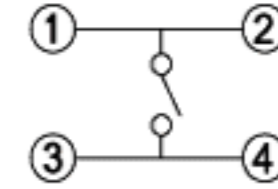

IT-1102WB~1102WE



MODEL NO.	STEM (L)
IT-1102WB	7.0
IT-1102WC	8.0
IT-1102WD	9.5
IT-1102WDL	10.0
IT-1102WE	7.3 x Ø3.4
IT-1102WF	12.5
IT-1102WG	13.5
IT-1102WH	9.7
IT-1102WI	17.0
IT-1102WJ	16.3
IT-1102WK	13.0
IT-1102WL	21.0
IT-1102WR	6.0
IT-1102WZ	8.5

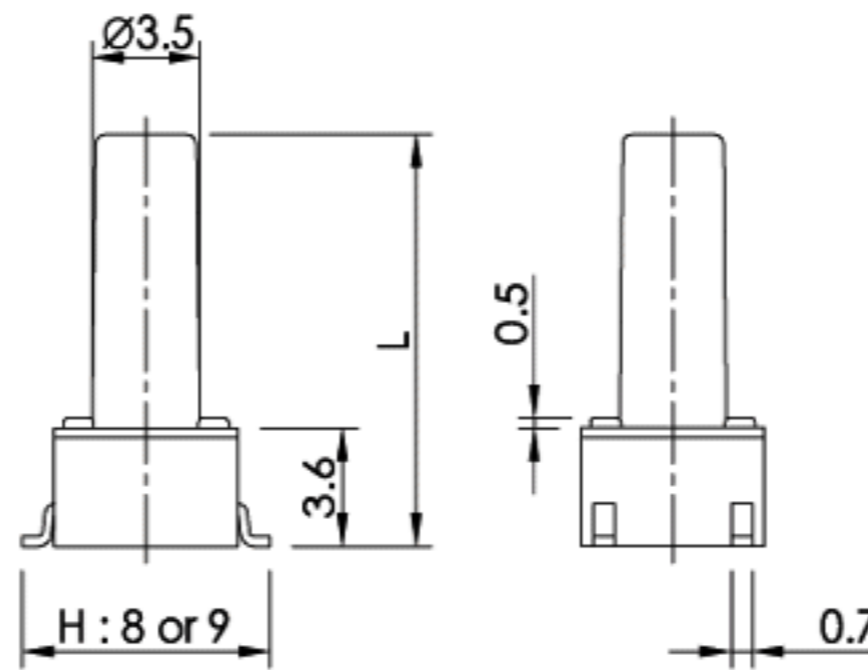

IT-1102WF~1102WZ



IT-1102WT

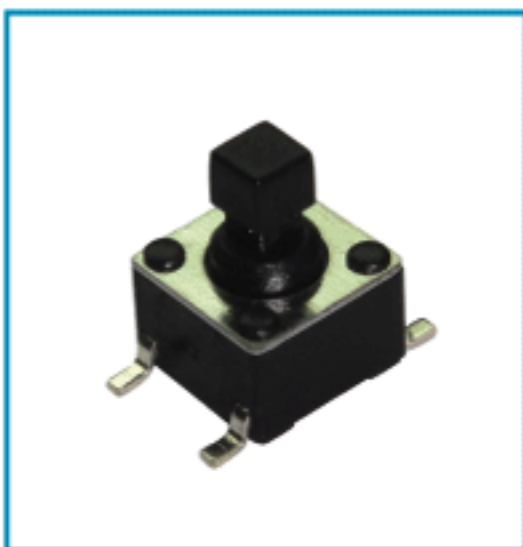

MODEL NO.	STEM (L)
IT-1102WT	7.3 x □2.4

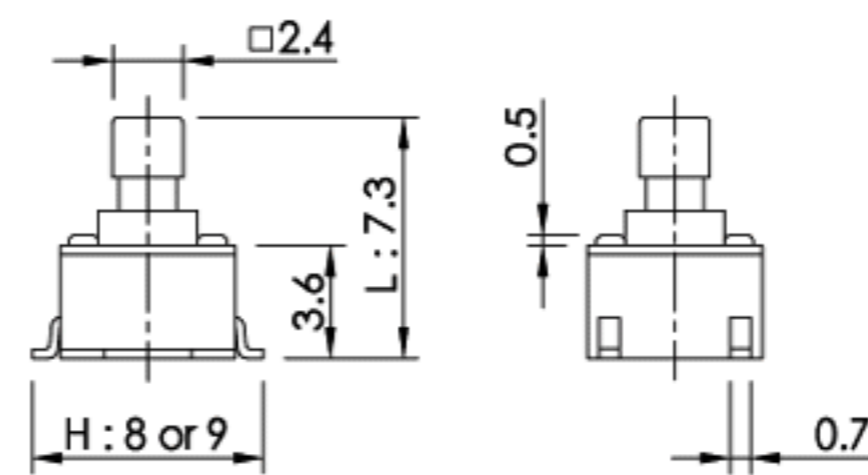
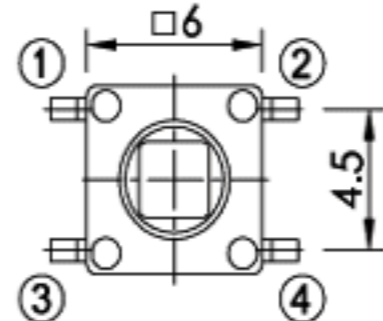

P.C.B. LAYOUT

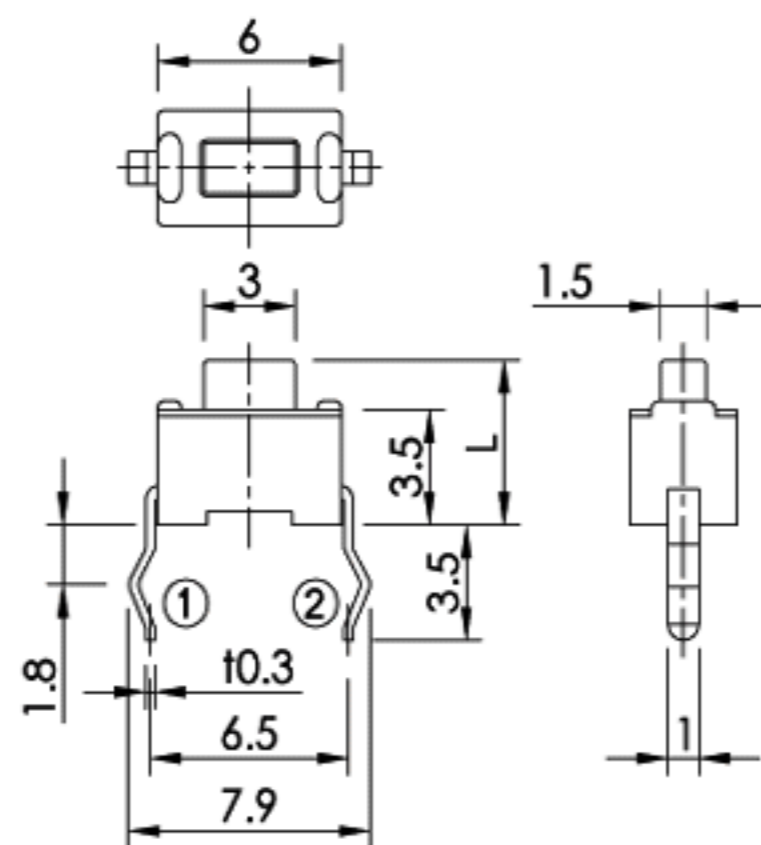
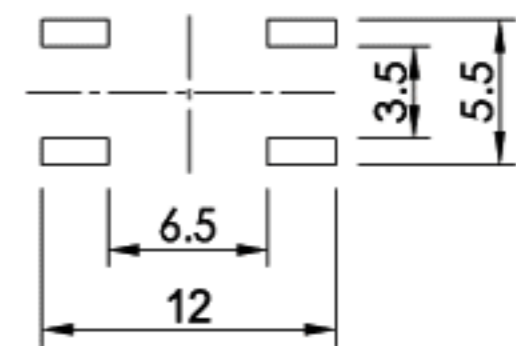

CIRCUIT DIAGRAM

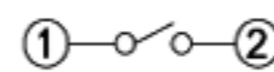

P.C.B. LAYOUT

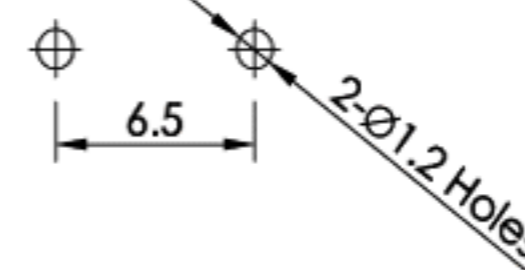

MODEL NO.	STEM (L)
0343	4.3
0350	5.0

Rating : 50mA 12V DC.
 Travel : 0.25±0.1mm.
 Contact resistance : 100mΩ Max.
 Operating force : 130, 180, 250±50g.
 Life : 130g, 180g : 50,000 Cycles Min.
 250g : 30,000 Cycles Min.

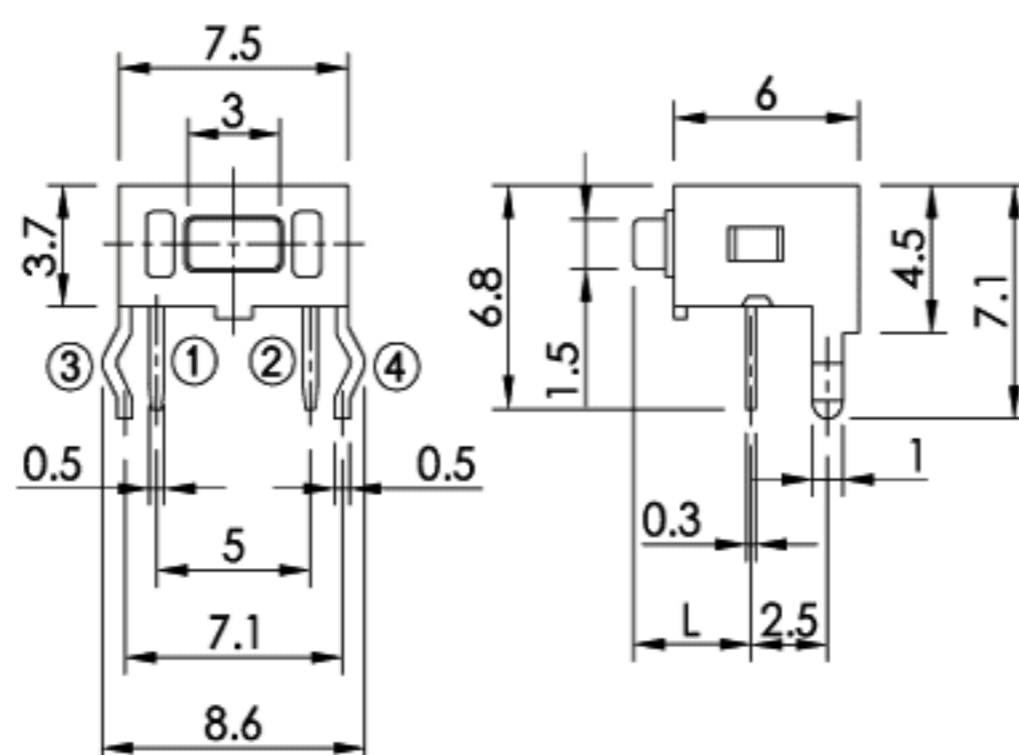

CIRCUIT DIAGRAM

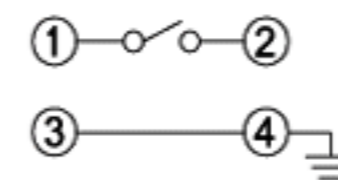

P.C.B. LAYOUT

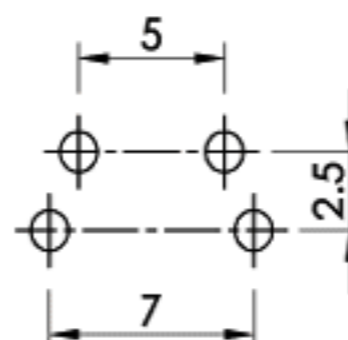

MODEL NO.	STEM (L)
IT-1101V	3.15
IT-1101VA	3.85

Rating : 50mA 12V DC.
 Travel : 0.25±0.1mm.
 Contact resistance : 100mΩ Max.
 Operating force : 130, 180±30g, 250±50g.
 Life : 130g, 180g : 50,000 Cycles Min.
 250g : 30,000 Cycles Min.