

**SPECIFICATIONS**  
 Current Rating: 2A AC,DC  
 Voltage Rating: 250V AC,DC  
 Temperature Range: -25°C ~ +85°C  
 Contact Resistance: 30mΩ Max.  
 Insulation Resistance: 1000MΩ Min.  
 Withstanding Voltage: 800V AC/minute  
 Pin Material: Brass/Tin-plated  
 Material: Nylon 66,UL94V-0  
 Color: Black

**Ordering Information & Dimensions**

PART NO.	Dimensions	
	A	B
A2211WV-2X02P	2.00	6.00
A2211WV-2X03P	4.00	8.00
A2211WV-2X04P	6.00	10.00
A2211WV-2X05P	8.00	12.00
A2211WV-2X06P	10.00	14.00
A2211WV-2X07P	12.00	16.00
A2211WV-2X08P	14.00	18.00
A2211WV-2X09P	16.00	20.00
A2211WV-2X10P	18.00	22.00
A2211WV-2X11P	20.00	24.00
A2211WV-2X12P	22.00	26.00
A2211WV-2X13P	24.00	28.00
A2211WV-2X14P	26.00	30.00
A2211WV-2X15P	28.00	32.00
A2211WV-2X16P	30.00	34.00
A2211WV-2X17P	32.00	36.00
A2211WV-2X18P	34.00	38.00
A2211WV-2X19P	36.00	40.00
A2211WV-2X20P	38.00	42.00

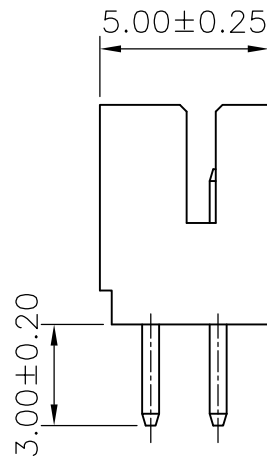
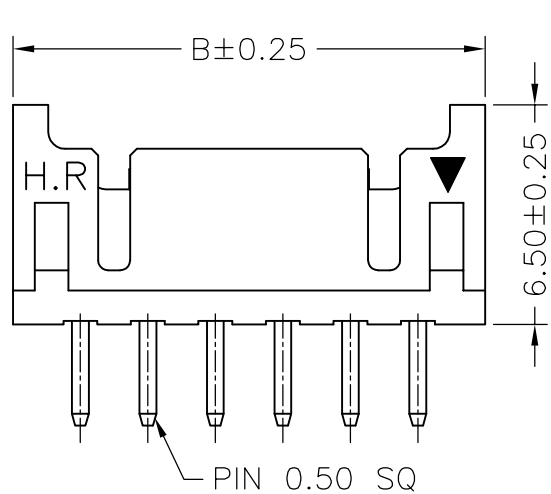
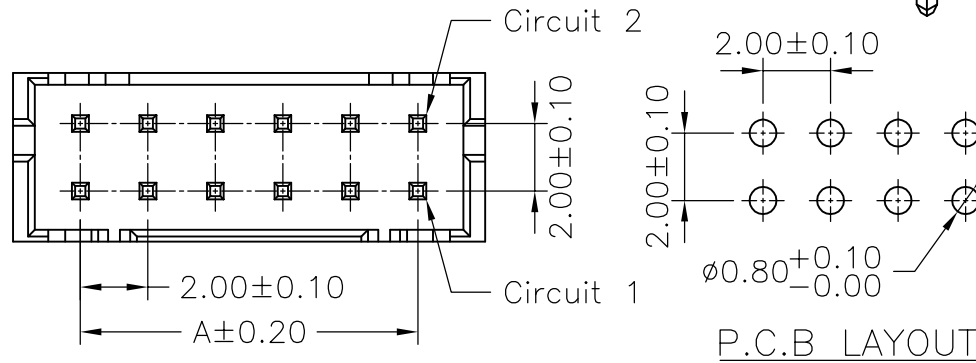

				JOINT TECH ELECTRONIC IND. CO., LTD. JOY DAY INDUSTRIAL CO., LTD.	
				UNIT	SCALE
		mm		1 of 1	2.00mm PITCH 180° WAFER
		DRAWN BY		APPROVED BY	
		董正一		董正一	
		2001.02.01		2001.02.01	
		GENERAL TOLERANCE			
B1	REVISE	2007.02.27	X. X±0.25	ANGLE±	DRAW NO.: A2211WV-2XNP
B0	NEW RELEASE	2005.12.05	X. XX±0.15		
REV.	DESCRIPTION	DATE	X. XXX±0.05		
					REV. B1