

With Panel

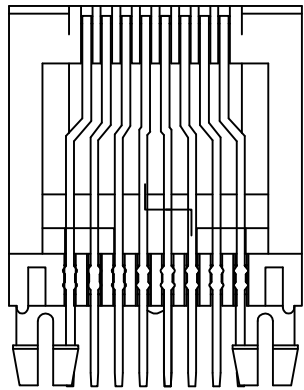

Without Panel

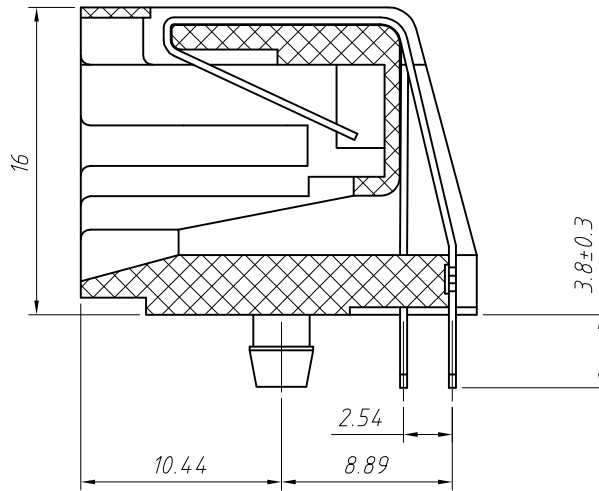

SECTION A-A

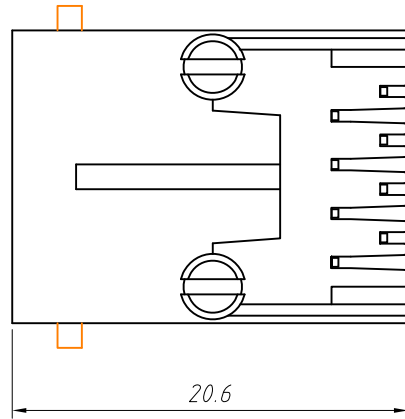

PCB Layout

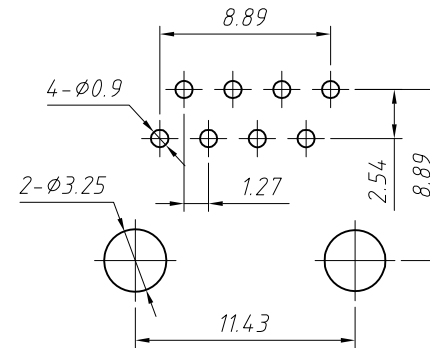

Material:
 Housing: PBT+Glass Filled Polyester
 Flammability Rating : UL 94V-0
 Contacts: Phosphor Bronze
 Plating: Gold Plating

Electrical:
 Voltage Rating: 125VAC
 Current Rating: 1.5A
 Contact Resistance: 30mΩ Max.
 Insulation Resistance: 500MΩ Min.
 Dielectric Strength: 1000VAC Rms
 50Hz, 1 Min.
 Durability: 600 cycles Min.
 Operation Temperature: -40°C ~ +70°C

Order Information

L-KLS12-145-8P8C - W- 1- XX

RoHS
 Contacts: 8P8C
 Panel: W-With Panel
 W/O-Without Panel
 Color Code:
 1-Black

Plating Code:
 01-Fu" Gold Plating
 02-3u" Gold Plating
 03-6u" Gold Plating
 04-15u" Gold Plating
 05-30u" Gold Plating

GENERAL TOLERANCE	PROJECTION		Description:
X. ±0.30	UNITS	mm	RJ45-8P8C Modular jacks KLS P/N: L-KLS12-145-8P8C-X-X-XX
.X ±0.25	SCALE	1:1	
.XX ±0.20	Draw by:	Jenny	
ANGLE TOLERANCE	Check by:	Daniel	NingBo KLS ELECTRONIC CO.,LTD.
X. ±3°	Date	2018-03-01	
.X ±2°	SHEET	1 OF 1	
.XX ±1°			