

DIL - SOLDER TAIL

Series 150 DIL - Solder tail
2.54 mm, Solder tail

DIL pin headers with male contacts pluggable into standard female socket contacts

Technical specs.:

Insulator: Black glass filled polyester
PCT-GF30-FR
UL 94V-O
Flammability:
Contact: Brass CuZn36Pb3 (C36000)
Connecting pin Ø: 0.47 mm
Mechanical life: Min. 100 cycles
Rated current: 1 A
Dielectric strength: Min. 1000 V RMS

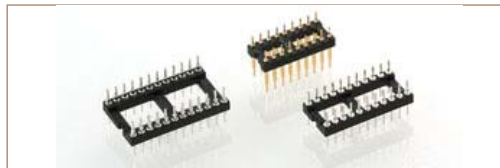

Ordering information RoHS-compliant parts

PP Plating code	Termination	Connecting pin
10	Gold 0.25 µm	Gold 0.25 µm
80	Tin	Tin

For complete part number replace X-...-XXX with the code given below left

General technical specs. ...

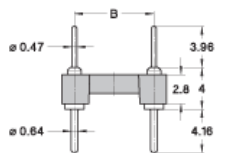

Fig. 1

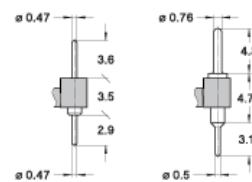

Fig. 2

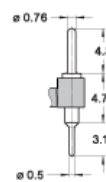
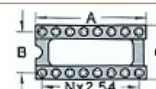

Fig. 3

Available versions

Standard header	
150-...-001101	see Fig. 1
150-...-006101	see Fig. 2
150-...-018101	see Fig. 3



	Poles	A	B	C	D	E	See	Order Codes
Ⓟ	10	12.6	5.08	7.6				150-PP-210-00-XXX101
Ⓟ	4	5.0	7.62	10.1				150-PP-304-00-XXX101
Ⓟ	6	7.6	7.62	10.1				150-PP-306-00-XXX101
Ⓟ	8	10.1	7.62	10.1				150-PP-308-00-XXX101
Ⓟ	10	12.6	7.62	10.1				150-PP-310-00-XXX101
Ⓟ	12	15.2	7.62	10.1				150-PP-312-00-XXX101
Ⓟ	14	17.7	7.62	10.1				150-PP-314-00-XXX101
Ⓟ	16	20.3	7.62	10.1				150-PP-316-00-XXX101
Ⓟ	18	22.8	7.62	10.1				150-PP-318-00-XXX101
Ⓟ	20	25.3	7.62	10.1				150-PP-320-00-XXX101
Ⓟ	22	27.8	7.62	10.1				150-PP-322-00-XXX101
Ⓟ	24	30.4	7.62	10.1				150-PP-324-00-XXX101
Ⓟ	28	35.5	7.62	10.1				150-PP-328-00-XXX101
Ⓟ	20	25.4	10.16	12.6				150-PP-420-00-XXX101
Ⓟ	22	27.8	10.16	12.6				150-PP-422-00-XXX101
Ⓟ	24	30.4	10.16	12.6				150-PP-424-00-XXX101
Ⓟ	28	35.5	10.16	12.6				150-PP-428-00-XXX101
Ⓟ	32	40.6	10.16	12.6				150-PP-432-00-XXX101
Ⓟ	10	12.7	15.24	17.7				150-PP-610-00-XXX101
Ⓟ	24	30.5	15.24	17.7				150-PP-624-00-XXX101
Ⓟ	28	35.5	15.24	17.7				150-PP-628-00-XXX101
Ⓟ	32	40.6	15.24	17.7				150-PP-632-00-XXX101
Ⓟ	36	45.7	15.24	17.7				150-PP-636-00-XXX101
Ⓟ	40	50.8	15.24	17.7				150-PP-640-00-XXX101
Ⓟ	42	53.3	15.24	17.7				150-PP-642-00-XXX101
Ⓟ	48	60.9	15.24	17.7				150-PP-648-00-XXX101
Ⓟ	50	63.5	15.24	17.7				150-PP-650-00-XXX101
Ⓟ	52	66.0	15.24	17.7				150-PP-652-00-XXX101
Ⓟ	50	63.5	22.86	25.3				150-PP-950-00-XXX101
Ⓟ	52	66.0	22.86	25.3				150-PP-952-00-XXX101
Ⓟ	64	81.2	22.86	25.3				150-PP-964-00-XXX101

Mouser Electronics

Authorized Distributor

Click to View Pricing, Inventory, Delivery & Lifecycle Information:

Preci-dip:

[150-80-308-00-001101](#) [150-10-648-00-001101](#)