

N° C141603

A4

- 1 SENS DE BOBINAGE STANDARD (POUR APPLICATEUR STANDARD).
- 2 SENS DE BOBINAGE INVERSE (POUR MINI-APPLICATEUR).

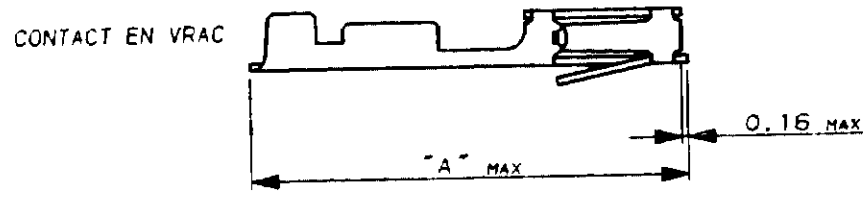
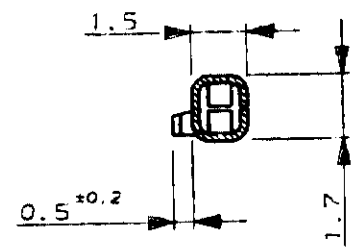
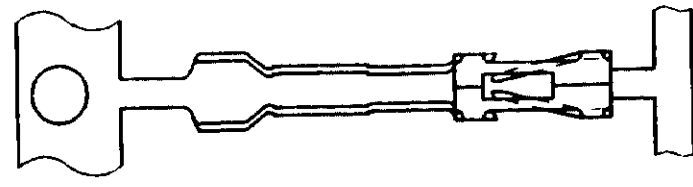
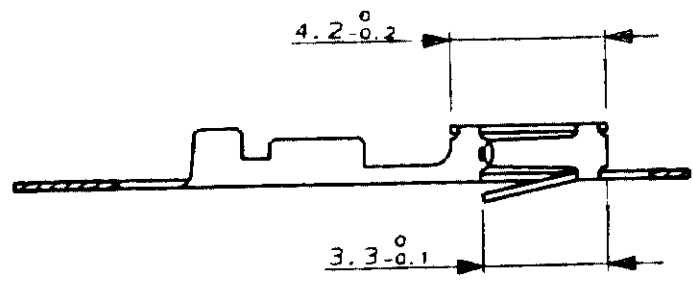
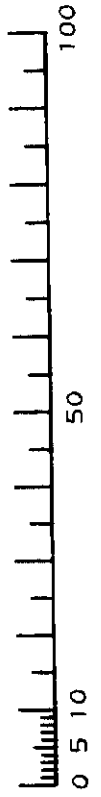

|                       |                          |   |            |                              |                               |            |
|-----------------------|--------------------------|---|------------|------------------------------|-------------------------------|------------|
| 28-32                 | 0.5-1.0                  | DORE 0.8µM DANS LA ZONE DE CONTACT<br>FLASH D'OR SUR LE RESTE<br>SOUS-COUCHE 1.27µM NI. | 11.7       | 0-167023-2                   | 2                             | 0-167020-2 |
|                       |                          |   |            |                              | 1                             | -          |
| 28-32                 | 0.5-1.0                  | DORE 0.8µM DANS LA ZONE DE CONTACT<br>ETAIN SUR LE FUT<br>SOUS-COUCHE 1.27µM NI.        | 11.7       | 0-167023-1                   | 2                             | 0-167020-1 |
|                       |                          |   |            |                              | 1                             | -          |
| 20-26<br>(0.5mm² MAX) | 1.40 MAX                 | DORE 0.8µM DANS LA ZONE DE CONTACT<br>ETAIN SUR LE FUT<br>SOUS-COUCHE 1.27µM NI.        | 12.3       | 0-141603-4                   | 2                             | 0-167300-8 |
|                       |                          |   |            |                              | 1                             | 0-167300-7 |
| 20-26<br>(0.5mm² MAX) | 1.40 MAX                 | DORE 0.8µM DANS LA ZONE DE CONTACT<br>FLASH D'OR SUR LE RESTE<br>SOUS-COUCHE 1.27µM NI. | 12.3       | 0-141603-3                   | 2                             | 0-167300-6 |
|                       |                          |   |            |                              | 1                             | 0-167300-5 |
| JAUGE AWG<br>FIL      | DIAMETRE<br>ISOLANT (MM) | FINITION  | DIM<br>"A" | REFERENCE<br>CONTACT EN VRAC | REFERENCE<br>CONTACT EN BANDE |            |

|  |  |  |  |  |  |                |                                 |
|--|--|--|--|--|--|----------------|---------------------------------|
|  |  |  |  | NUMERO   | DESCRIPTION                            | OBSERVATION    | REP.                            |
|  |  |  |  | © 1989 BY AMP INCORPORATED ALL RIGHTS RESERVED. AMP PRODUCTS COVERED BY PATENTS AND/OR PATENTS PENDING |  |                |                                 |
|  |  |  |  | DESSIN CLIENT UNIQUEMENT POUR REFERENCE  |  |                |                                 |
|  |  |  |  | DESSINE LE<br>20. MAR. 89<br>PAR<br>A. CAMEL   | MATIERE<br>BRONZE PHOSPHOREUX          | <b>AMP</b>     | AMP DE FRANCE<br>95301 PONTOISE |
|  |  |  |  | VERIFIE LE<br>PAR  | FINITION<br>VOIR CI-DESSUS             |                | CLASSE                          |
|  |  |  |  |  | DIMENS. FIL                            | ISOLANT        | TYPE                            |
|  |  |  |  |  | VOIR CI-DESSUS                         |                |                                 |
|  |  |  |  | PLAN FAIT EN<br>CAO  | TOLERANCES<br>SAUF INDICATION<br>± 0.3 | ECHELLE<br>5:1 | REV<br>0                        |
|  |  |  |  | ne pas modifier le calque  |  |                |                                 |
|  |  |  |  | CONTACT AMPMODU MOD. IV  |  |                |                                 |

Dimensions en mm.  
 Révision par le client

DIST  
7