

BU-1420711821

(PCB Edge Mount SMA Jack with Round Contact)

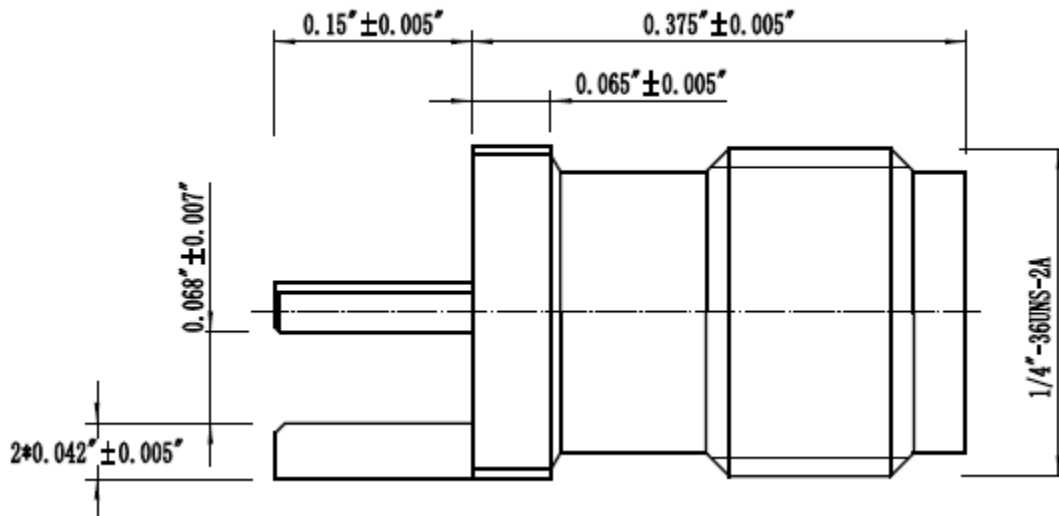

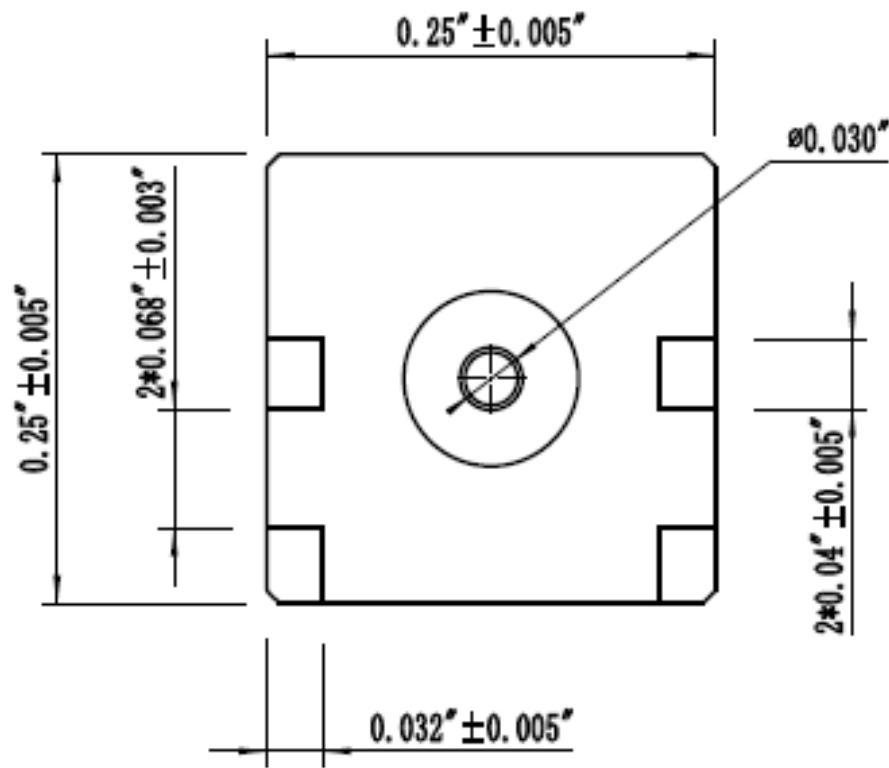

(Dimensions in Inches)

- End launch mounting
- Designed to mount on .063" (1.57 mm) Circuit Boards.
- Impedance: 50 Ω
- Frequency: DC to 18 Ghz.
- Working Voltage: 335 VRMS Max
- Dielectric Withstand: 1000 VRMS
- Contact Resistance: 3 milliohms
- Mating Cycles: 500 Minimum
- Meets or exceeds the applicable paragraph of MIL-C-39012
- Operating Temperature: -65°C to 150°C
- RoHS 3 Compliant

Mouser Electronics

Authorized Distributor

Click to View Pricing, Inventory, Delivery & Lifecycle Information:

[Mueller Electric:](#)

[BU-1420711821](#)