

| LOC | DIST | REVISIONS | | | |
|-----|------|---------------------------|---------|-----|------|
| P | LTR | DESCRIPTION | DATE | DMN | APVD |
| B1 | | REVISED PER ECO-11-004835 | 11MAR11 | RK | HMR |

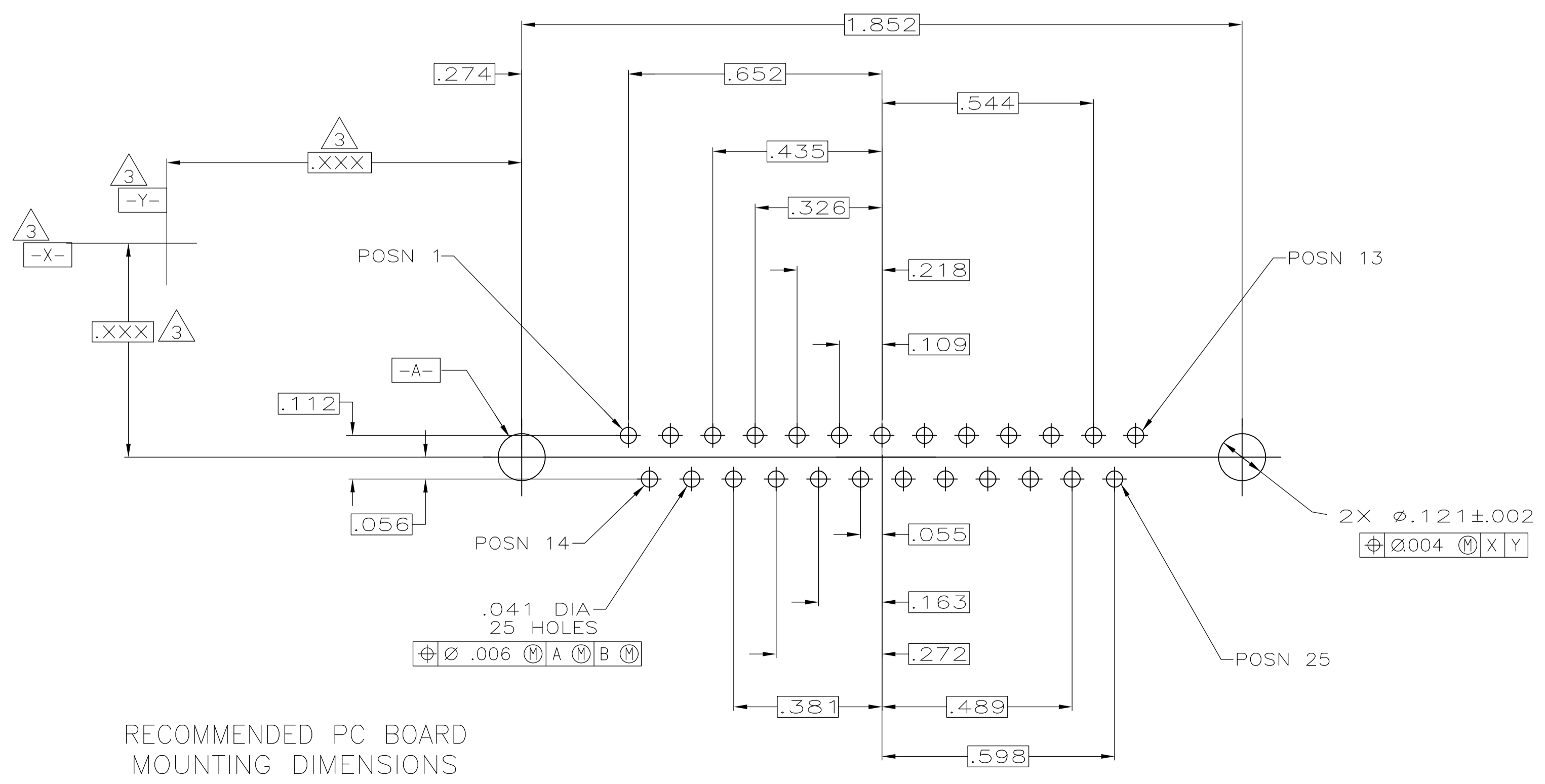
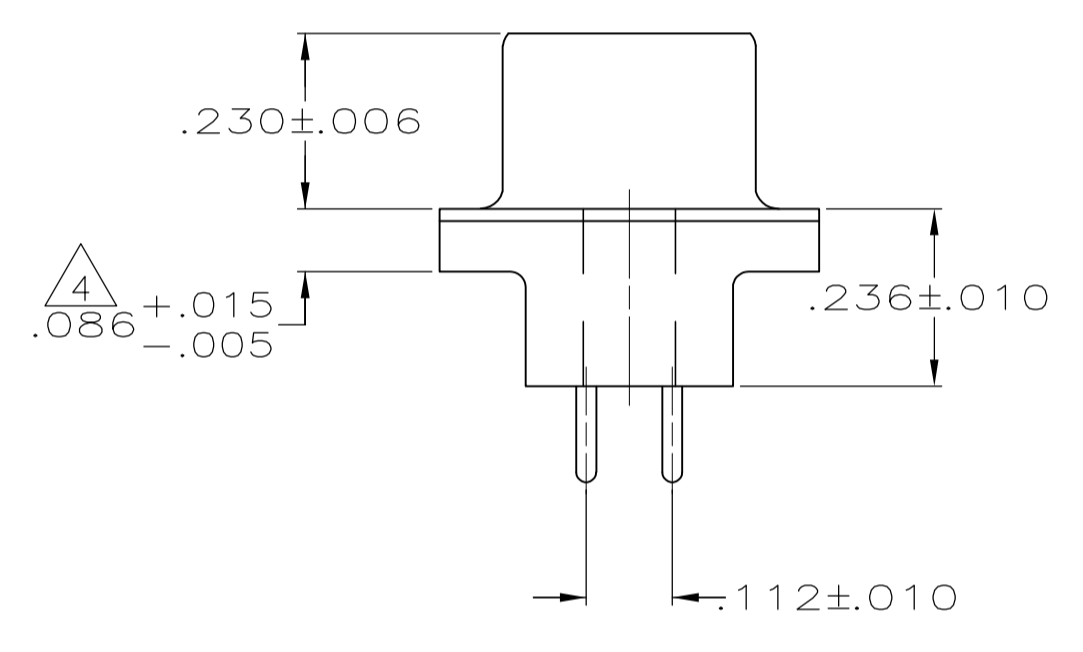
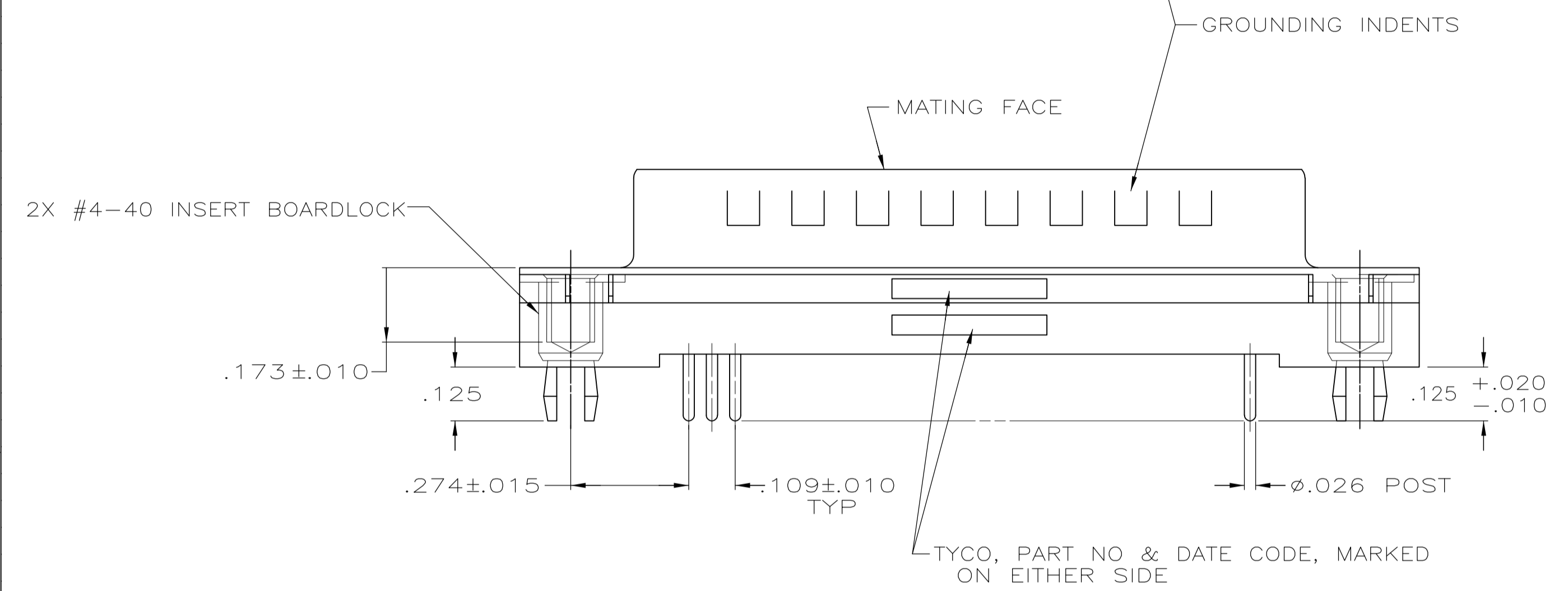
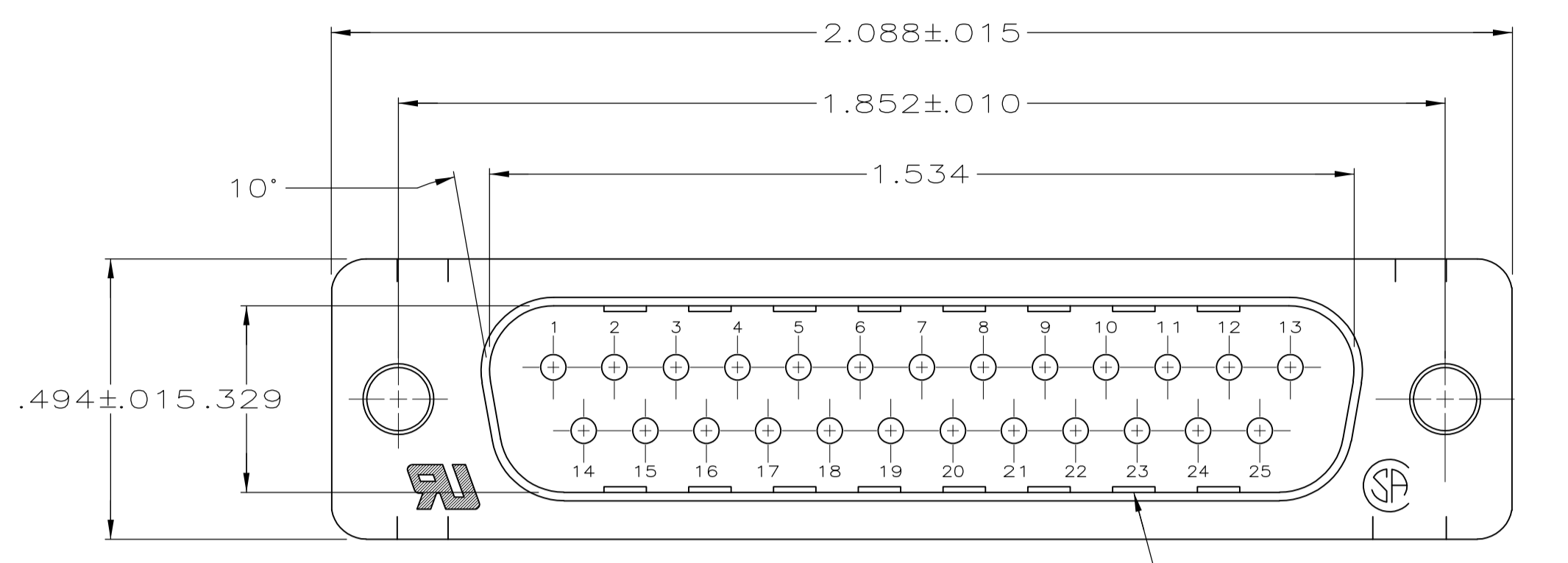

- 1 HOUSING: POLYESTER, UL 94V-0 RATED, COLOR BLACK.
SHELL: CARBON STEEL.
CONTACTS: BRASS.
INSERT BOARDLOCKS: BRASS.
- 2 SHELLS: .000200 MIN TIN OVER .000100 MIN COPPER.
CONTACTS: GOLD PLATED FOR A LENGTH OF .150 MIN FROM MATING END, .000030 MIN GOLD IN MATED AREA, .000100 MIN TIN ON TERMINATION END, ALL OVER .000050 MIN NICKEL ON ENTIRE CONTACT.
-OR-
GOLD FLASH OVER PALLADIUM NICKEL PLATED FOR A LENGTH OF .150 MIN FROM MATING END, .000030 MIN PALLADIUM NICKEL IN MATED AREA, .000100 MIN TIN ON TERMINATION END, ALL OVER .000050 MIN NICKEL ON ENTIRE CONTACT.
INSERT BOARDLOCKS: .000150 MIN TIN OVER .000100 MIN COPPER.
- 3 DATUMS AND BASIC DIMENSIONS ESTABLISHED BY CUSTOMER.
- 4 .110 MAX IN SHELL TAB CLINCH AREAS.

RECOMMENDED PC BOARD MOUNTING DIMENSIONS

2-5747704-0
PART NO

| | | | |
|--|--------|--------------------------|---|
| THIS DRAWING IS A CONTROLLED DOCUMENT. | | DIN B LATTUCA 26SEPT05 | TE Connectivity |
| DIMENSIONS: INCHES | | CHK S BOLASH 26SEPT05 | |
| TOLERANCES UNLESS OTHERWISE SPECIFIED: | | APPD M WALMSLEY 26SEPT05 | NAME |
| 0 PLC ± - | | | PLUG ASSEMBLY, SIZE 3, 25 POS., |
| 1 PLC ± - | | | VERTICAL, .026 DIAMETER POSTS, RETENTION INSERTS, |
| 2 PLC ± - | | | FRONT METAL SHELL, AMPLIMITE HD-20 |
| 3 PLC ± .005 | | | PRODUCT SPEC 108-40025 |
| 4 PLC ± - | | | APPLICATION SPEC 114-40023 |
| ANGLES ± ± | | | SIZE CAGE CODE DRAWING NO RESTRICTED TO |
| MATERIAL | FINISH | WEIGHT | A1 00779 C=5747704 |
| CUSTOMER DRAWING | | SCALE 1:1 | SHEET 1 OF 1 REV B1 |