

KEMET Part Number: TRS5-50BLRVU
(USEH50BLR00000)

KEMET, TRS, Thermal Reed Switch, Axial, 2.5C Temperature Accuracy, High Reliability, High-Speed Response, Long Operational Life, Excellent Environmental Durability, High Temperature Accuracy, 50°C, Break

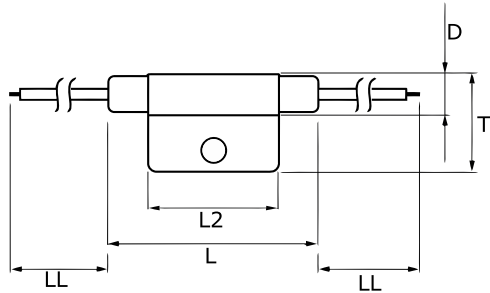

| Dimensions | |
|------------|-----------|
| D | 8.2mm MAX |
| L | 50mm MAX |
| L2 | 29mm MAX |
| T | 20mm MAX |
| LL | 200mm |

| Packaging Specifications | |
|--------------------------|----------------|
| Packaging: | Rubberband Box |
| Packaging Quantity: | 600 |
| Weight: | 8.5 g |

| General Information | |
|---------------------|---|
| Series: | TRS |
| Type: | Thermal Reed Switch |
| Style: | Axial |
| Description: | Thermal Reed Switch |
| Features: | High Reliability, High-Speed Response, Long Operational Life, Excellent Environmental Durability, High Temperature Accuracy |
| Lead: | Cables |
| RoHS: | Yes |
| Qualifications: | UL, CSA, VDE |

| Specifications | |
|------------------------------|---|
| Switching Temperature: | 50C +/-2.5C |
| Temperature Range: | -20/+130C |
| Contact Type: | Break |
| Voltage AC: | 264 VAC MAX (Opening/Closing) |
| Current: | 0.275 Amps MAX (Make/Break), 1 mAmps MIN (5VDC, Opening/ Closing) |
| Resistance: | 150 mOhms MAX (Contact Resistance) |
| Max Opening/Closing Power: | 60.5 W (AC/DC) |
| Max Opening/Closing Voltage: | 264 V (AC) |