

SMD Terminal Blocks

Small is Big



WAGO®

SMD Terminal Blocks

A compact and flat printed circuit board connection is required to achieve the most uniform light distribution, while minimizing shadowing. WAGO's SMD terminal blocks, with their combination of flat design and wide range of potential uses, completely cover these functionality demands.

Furthermore, assembling 1-, 2- and 3-pole terminal blocks without losing any poles provides complete flexibility with a reduced number of variants. All SMD terminal blocks come in tape-and-reel packaging to ensure full integration into an automated assembly process.

Applications:

The SMD family offers many advantages allowing for a wide range of applications. From compact, conventionally wired LED spotlights up to industrially wired, recessed ceiling luminaires, WAGO's three SMD terminal block series are the perfect connection between driver and module.

The terminal blocks accommodate a broad range of conductors making them highly versatile for worldwide applications.



Benefits:

- Low profile minimizes on-board shadowing
- Direct push-in of solid conductors
- Terminal strips of different lengths can be mounted without losing any poles allowing for a reduced number of variants and lower production costs
- Available in 1-3 pole configurations
- Delivery in tape-and-reel packaging for full integration into SMT soldering process
- Potential for significant savings via automated pick-and-place assembly



Surface Mount Technology

Surface Mount Technology (SMT) means soldering electronic components directly onto PCB surface pads without drilling holes. The basic SMT process consists of applying solder paste to the PCB via solder dispensing equipment, screen or stencil printing.

SMT assembly is performed using fully automated placement machines. Surface mount components are soldered to the board in infrared, convection or vapor phase ovens.

Reflow Soldering Process:

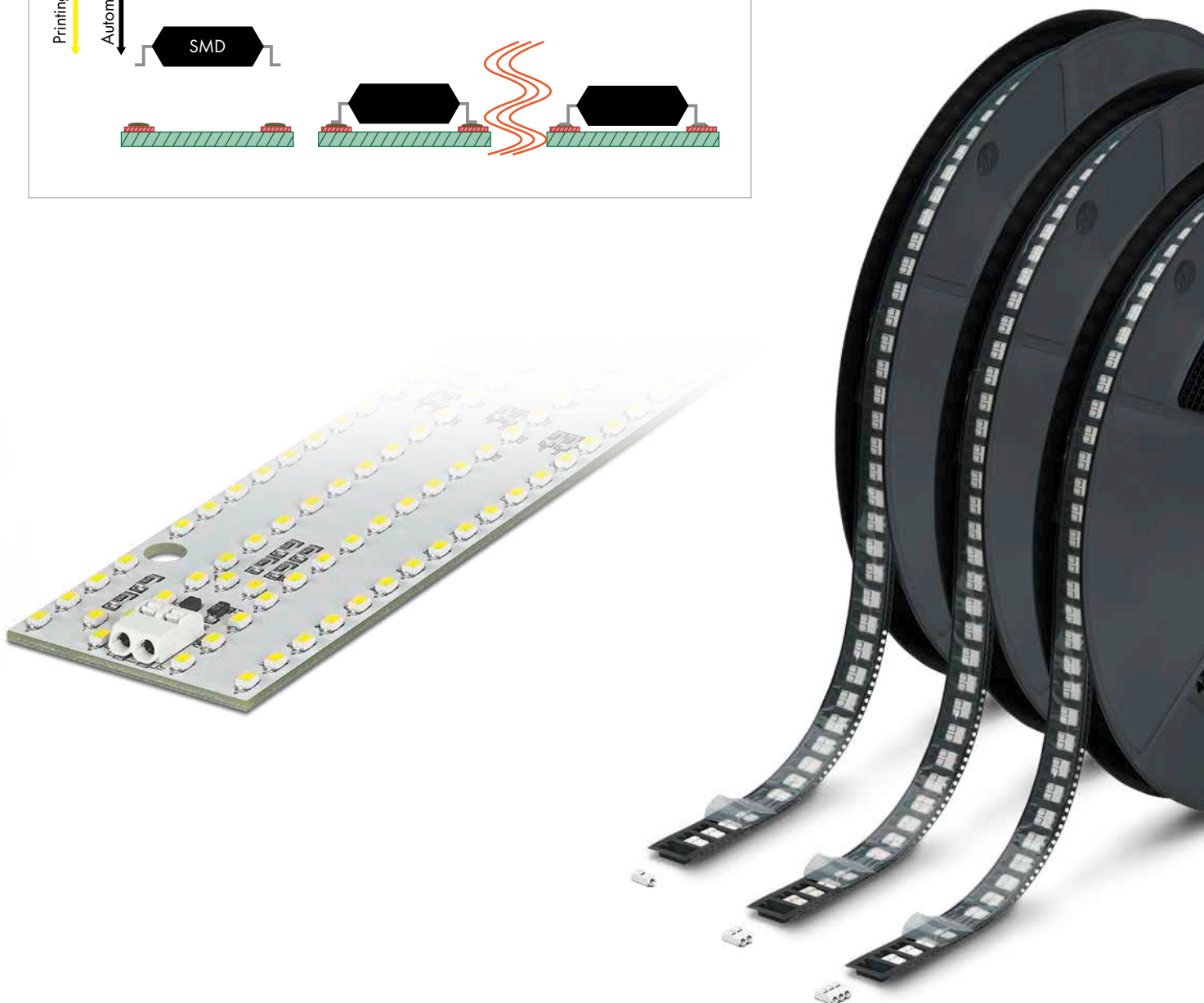
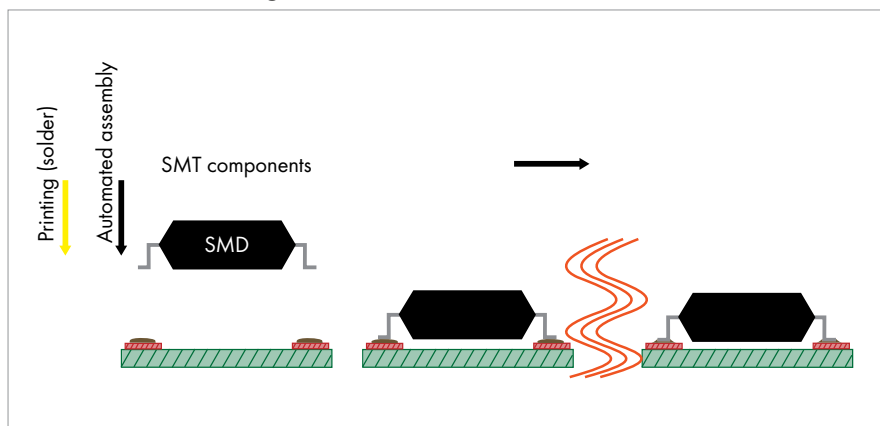

2059 Series

For the Smallest Installation Spaces

- Low profile of just 2.7 mm
- Pin spacing: 3 mm
- Terminates solid conductors from 26 to 22 AWG (0.14 - 0.34 mm²)
- Direct push-in of solid conductors
- Easy conductor removal via operating tool
- Rated data: 160 V, 2.5 kV/2 (III), 3 A
- Available in 1-, 2- and 3-pole configurations
- Group arrangement is possible without losing any poles
- Available in tape-and-reel packaging

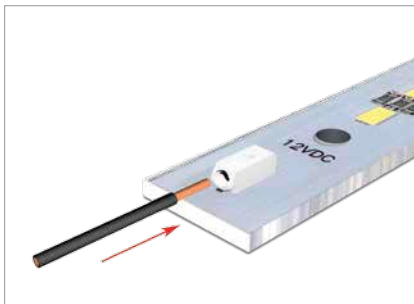

Inserting solid conductors via push-in termination.

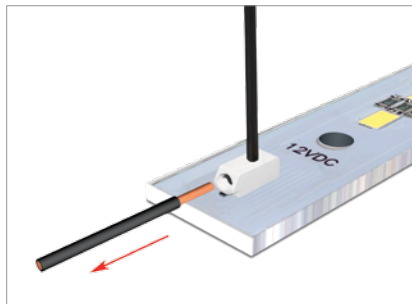

Easy conductor removal, e.g., via 206-859 operating tool.



2059 Series, 3 mm Pin Spacing

Pin Spacing	3 mm / 0.118 in			Conductor Data	
Ratings per	IEC/EN 60664-1			Connection technology	PUSH WIRE®
Overtoltage category	III	III	II	Conductor size: solid	0.14 - 0.34 mm ²
Pollution degree	3	2	2	AWG	26 - 22 "sol."
Rated voltage	63 V	160 V	320 V	Strip length	4 - 5.5 mm / 0.16 - 0.22 in
Rated surge voltage	2.5 kV	2.5 kV	2.5 kV		
Rated current	3 A	3 A	3 A		

Pole No.	Item No.	Pack.	Unit
SMD terminal blocks in tape-and-reel packaging, white			
Reel diameter: 330 mm			
1	2059-301/998-403	31800	(12 x 2650)
2	2059-302/998-403	21000	(12 x 1750)
3	2059-303/998-403	21000	(12 x 1750)

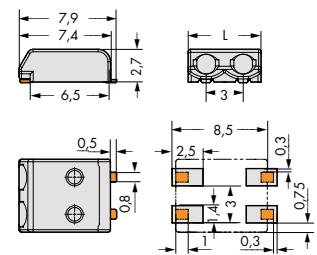

$$L = (\text{pole no.} \times \text{pin spacing}) - 0.1 \text{ mm}$$