

LOW VOLTAGE DC CABLE

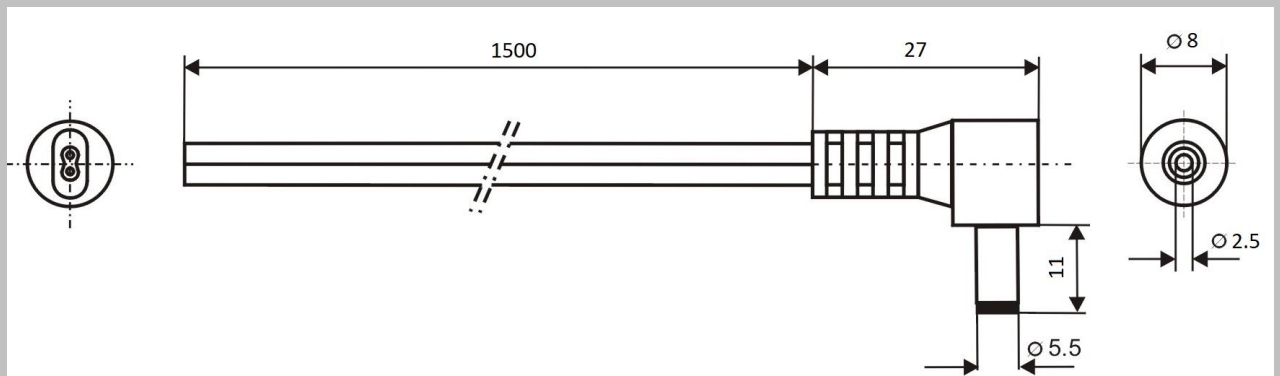

Specification:

Model	DC.CAB.6601.0150
DC PLUG	5.5/2.5 mm
Recommended voltage	0 - 48V
Max Current	3 A
Dielectric Strength	500 VDC
Operating temperature	-25°C to +70°C
Cord Length	1500 mm
Cable Diameter	1,62 x 3,42 mm
Wire Diameter	2x0,35mm ²
ROHS	+



Made in Poland