

Compact, low-profile type with a height of 0.4mm



TACT Switch™

Sharp Feeling

Soft Feeling

Snap-In Type

Surface Mount Type

Radial Type

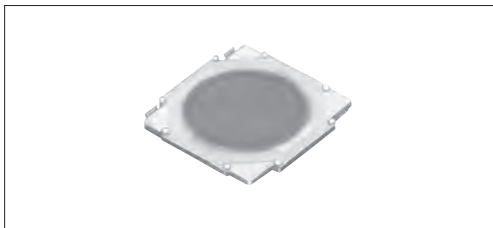

### Typical Specifications

| Items                      | Specifications     |
|----------------------------|--------------------|
| Rating (max.)              | 50mA 12V DC        |
| Rating (min.)              | 10 $\mu$ A 1V DC   |
| Initial contact resistance | 100m $\Omega$ max. |

### Product Line

| Product No.       | Operating force | Operating direction | Travel (mm) | Operating life (5mA 5V DC) | Minimum order unit (pcs.) |        |
|-------------------|-----------------|---------------------|-------------|----------------------------|---------------------------|--------|
|                   |                 |                     |             |                            | Japan                     | Export |
| <b>SKRMAAE010</b> | 1.57N           | Top push            | 0.15        | 500,000 cycles             | 10,000                    | 10,000 |
| <b>SKRMABE010</b> | 2.55N           |                     | 0.2         | 100,000 cycles             |                           |        |

### Packing Specifications

Taping

| Number of packages (pcs.) |                |                         | Tape width (mm) | Export package measurements (mm) |
|---------------------------|----------------|-------------------------|-----------------|----------------------------------|
| 1 reel                    | 1 case / Japan | 1 case / export packing |                 |                                  |
| 10,000                    | 100,000        | 100,000                 | 12              | 395×395×205                      |

#### Note

For reels of 330mm diameter, please inquire.

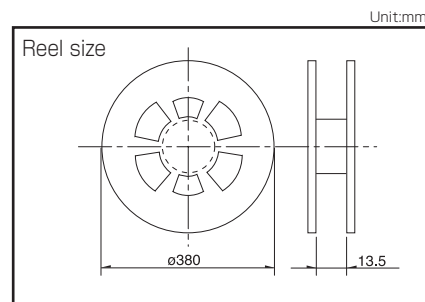

### Dimensions

| Style | PC board land dimensions (Viewed from switch mounting face) |
|-------|---|
|       |   |

### Circuit Diagram

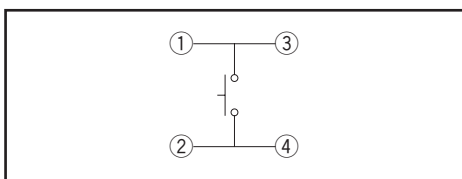

Refer to P.235 for soldering conditions.

# TACT Switch™

## List of Varieties

TACT Switch™















Sharp Feeling

Soft Feeling

Snap-In Type

Surface Mount Type

Radial Type

| Type                        |                                | Sharp Feeling Type   |   |   |   |   |   | SKTC  |
|-----------------------------|--------------------------------|--|---|---|---|---|---|---|
|                             |                                | Surface Mount  |   |   |   |   |   |   |
| Series                      |                                | SKSH   | SKRW  | SKRM  | SKRB  | SKRR  | SKQG  | SKTC  |
| Photo                       |                                |   |    |    |    |    |    |    |
| Features                    |                                | Low-profile  |   |   |   | Low-profile and long life   | Low-profile   | Double action   |
| Water-proof                 |                                | —  | —   | —   | —   | —   | —   | ●   |
| Dustproof                   |                                | —  | —   | —   | —   | —   | —   | ●   |
| IP standard                 |                                | —  | —   | —   | —   | —   | —   | 67 equivalent   |
| Operating direction         | Top push                       | ●  | ●   | ●   | ●   | ●   | ●   | ●   |
|                             | Side push                      | —  | —   | —   | —   | —   | —   | —   |
| Dimensions (mm)             | W                              | 3.3  | □3.7  | □4.5  | □4.8  | 7.5   | □5.2  | 3.4   |
|                             | D                              | 2.9  |   |   |   | 7   |   | 2.2   |
|                             | H                              | 0.35   |   | 0.4   | 0.55  | 0.6   | 1.5   | 0.62  |
| Operation force coverage    | 1N max.                        | ↕  | ↕   | ↕   | ↕   | ↕   | ↕   | See the relevant pages for respective product descriptions                            |
|                             | 1N to 2N                       |  |   |   |   |   |   |   |
|                             | 2N to 3N                       |  |   |   |   |   |   |   |
|                             | 3N to 4N                       |  |   |   |   |   |   |   |
| 4N to 5N                    |                                |  |   |   |   |   |   |   |
| Travel (mm)                 |                                | 0.15   |   | 0.15/0.2  |   | 0.25  |   | See the relevant pages for respective product descriptions                            |
| Ground terminal             |                                | —  | —   | —   | —   | —   | —   | —   |
| Operating temperature range |                                | -30°C to +85°C   |   |   | -40°C to +85°C  |   | -40°C to +90°C  | -30°C to +85°C  |
| Automotive use              |                                | —  | —   | —   | ●   | —   | ●   | —   |
| Life Cycle                  |                                |   |  |  |  |  |  |  |
| Electrical performance      | Rating (max.) (Resistive load) | 50mA 12V DC  |   |   |   |   |   |   |
|                             | Rating (min.) (Resistive load) | 10μA 1V DC   |   |   |   |   |   |   |
|                             | Insulation resistance          | 100MΩ min. 100V DC 1min.   |   |   |   |   |   |   |
|                             | Voltage proof                  | 100V AC 1min.  |   |   |   | 250V AC 1min.   |   | 100V AC 1min.   |
| Durability                  | Vibration                      | 10 to 55 to 10Hz/min., the amplitude is 1.5mm for all the frequencies, in the 3 direction of X, Y and Z for 2 hours respectively |   |   |   |   |   |   |
|                             | Lifetime                       | Shall be in accordance with individual specifications.   |   |   |   |   |   |   |
| Environmental performance   | Cold                           | -40°C 96h  |   |   |   |   |   |   |
|                             | Dry heat                       | 90°C 96h   |   |   |   |   |   |   |
|                             | Damp heat                      | 60°C, 90 to 95%RH 96h  |   |   |   |   |   |   |
| Page                        |                                | 188  | 189   | 190   | 191   | 192   | 193   | 194   |

W : Width. The most outer dimension excluding terminal portion.  
D : Depth. The most outer dimension excluding terminal portion.  
H : Height. The minimum dimension if there are variances.

TACT Switch™ Soldering Conditions . . . . . 235  
TACT Switch™ Cautions . . . . . 236

### Notes

- The automotive operating temperature range to be individually discussed upon request.
- Indicates applicability to all products in the series.

## Condition for Reflow

Available for Surface Mount Type.

Temperature profile

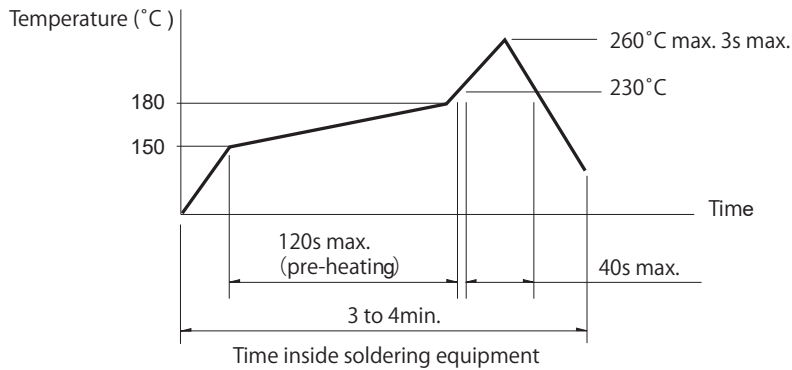

### Notes

1. Please confirm the specifications of our product for the detailed condition.
2. Soldering conditions differ depending on reflow soldering machines.  
Prior verification of soldering condition is highly recommended.

## Conditions for Auto-dip

Available for Snap-in Type and Radial Type.

| Items                  | Condition   |
|------------------------|---|
| Flux built-up          | Mounting surface should not be exposed to flux                      |
| Preheating temperature | Ambient temperature of the soldered surface of PC board. 100°C max. |
| Preheating time        | 60s max.  |
| Soldering temperature  | 260°C max.  |
| Duration of immersion  | 5s max.   |
| Number of soldering    | 2times max.   |

### SKHH Series

| Items                  | Condition   |
|------------------------|---|
| Flux built-up          | Mounting surface should not be exposed to flux                      |
| Preheating temperature | Ambient temperature of the soldered surface of PC board. 110°C max. |
| Preheating time        | 60s max.  |
| Soldering temperature  | 260°C max.  |
| Duration of immersion  | 5s max.   |
| Number of soldering    | 2times max.   |

### SKHL Top Push Type, SKQJ Series

| Items                  | Condition   |
|------------------------|---|
| Flux built-up          | Mounting surface should not be exposed to flux                      |
| Preheating temperature | Ambient temperature of the soldered surface of PC board. 100°C max. |
| Preheating time        | 45s max.  |
| Soldering temperature  | 255°C max.  |
| Duration of immersion  | 5s max.   |
| Number of soldering    | 2times max.   |

### Notes

1. Prevent flux penetration from the top side of the TACT Switch™.
2. Switch terminals and a PC board should not be coated with flux prior to soldering.
3. The second soldering should be done after the switch is stable with normal temperature.
4. Use the flux with a specific gravity of min 0.81.  
(EC-19S-8 by TAMURA CORPORATION, or equivalents.)

## Manual Soldering

| Items                      | Condition  |
|----------------------------|------------|
| Soldering temperature      | 350°C max. |
| Duration of soldering      | 3s max.    |
| Capacity of soldering iron | 60W max.   |

### SKHH, SKHW Series

| Items                      | Condition  |
|----------------------------|------------|
| Soldering temperature      | 360°C max. |
| Duration of soldering      | 3s max.    |
| Capacity of soldering iron | 60W max.   |

### SKTD, SKTG, SKQJ, SKSN Series

| Items                      | Condition  |
|----------------------------|------------|
| Soldering temperature      | 350°C max. |
| Duration of soldering      | 3s max.    |
| Capacity of soldering iron | 20W max.   |