

**STRAIGHT JACK CRIMP TYPE**

**R125.237.000**

**CABLE 5/50 S**

Series : SMA

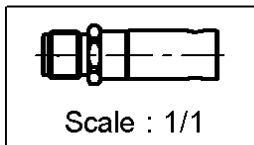
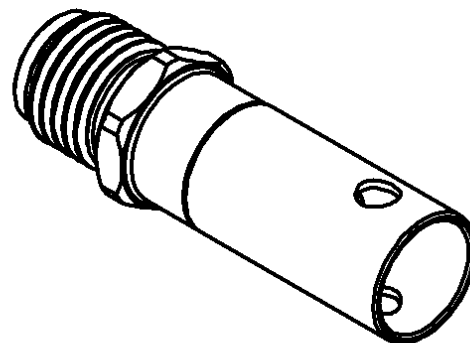
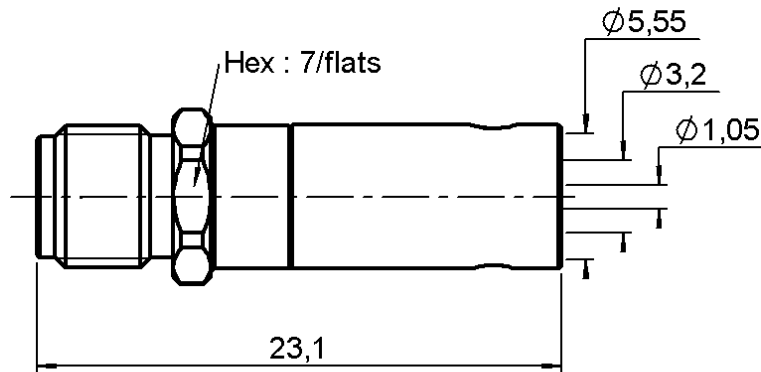

All dimensions are in mm.

COMPONENTS	MATERIALS	PLATING
<b>BODY</b>	<b>STAINLESS STEEL</b>	<b>GOLD 0.5 OVER NICKEL 2 µm</b>
<b>CENTRE CONTACT</b>	<b>BERYLLIUM COPPER</b>	<b>GOLD 1.3 OVER NICKEL 2 µm</b>
<b>OUTER CONTACT</b>	-	- µm
<b>INSULATOR</b>	<b>PTFE</b>	
<b>GASKET</b>	-	
<b>OTHERS PARTS</b>	<b>BRASS</b>	<b>GOLD 0.2 OVER NICKEL 2 µm</b>
-	-	-
-	-	-



Issue : 9840 J

Design changes may be in order to improve the product.

# Crimp 01 : Soldered contact

## COMPONENTS

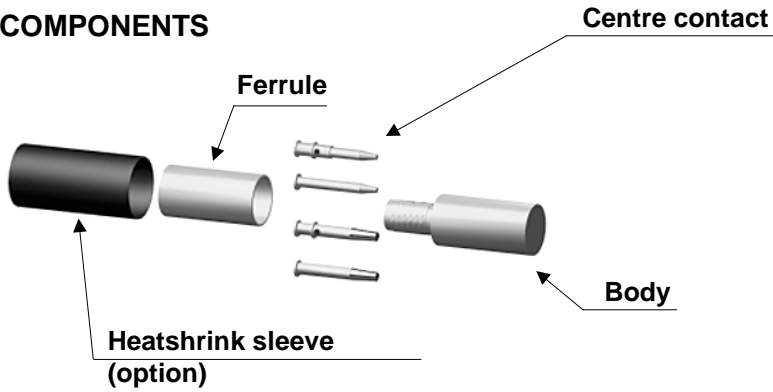

## STRIPPING DIMENSIONS

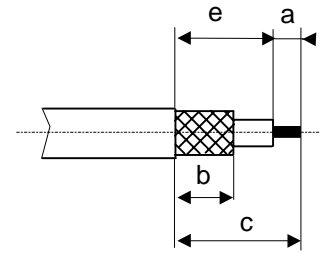

1

Slide the heatshrink sleeve onto the cable (Option).  
Slide the ferrule onto the cable.  
Strip the cable.

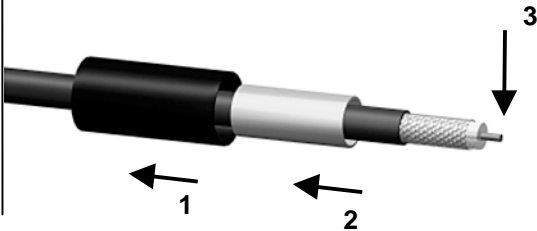

4

Slide the cable into the body until it bottoms against the insulator.

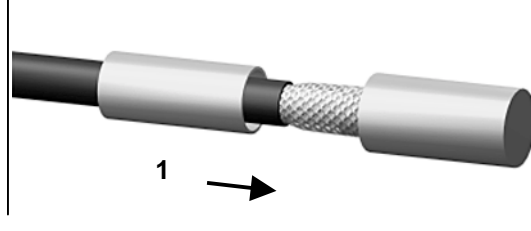

2

Slide the centre contact on until it bottoms against the cable dielectric.  
Solder the centre contact.  
Clean solder area.

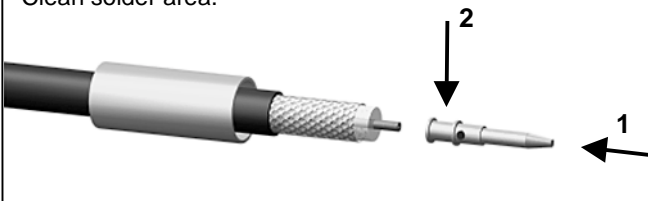

5

Slide the ferrule over the braid.  
Crimp the ferrule with crimping tool ( see connector TDS ).

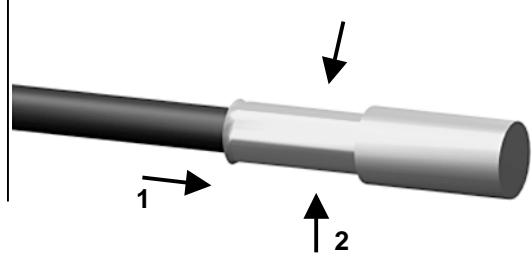

3

Fan the braid.

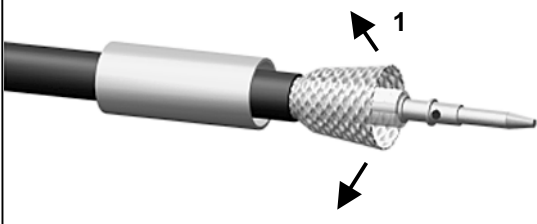

6

Cut the excess of braid if necessary.  
Slide the sleeve over the ferrule and heatshrink it in place (Option).

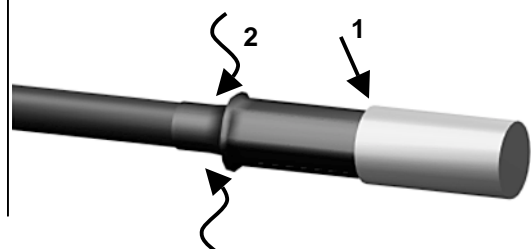

**STRAIGHT JACK CRIMP TYPE**

**R125.237.000**

**CABLE 5/50 S**

Series : SMA

**ELECTRICAL CHARACTERISTICS**

Impedance **50** Ω  
 Frequency **0-12.4** GHz  
 VSWR **1.15 + 0.010** x F(GHz) Maxi  
 Insertion loss **0.06** √F(GHz) dB  
 RF leakage - ( **60** - F(GHz)) dB mini  
 Voltage rating **335** Veff Maxi  
 Dielectric withstanding voltage **1000** Veff mini  
 Insulation resistance **5000** MΩ mini

**SPECIFICATION**

Stripping	a	b	c	d	e	f
mm	3.50	7.00	13.5	0.00	10.0	0.00

Assembly instruction : **Crimp 01**

Recommended cable(s)  
 KX 15  
 RG 58  
 RG 141

Cable retention  
 - pull off **180** N mini  
 - torque **NA** N.cm

**MECHANICAL CHARACTERISTICS**

Centre contact retention  
 Axial force – Mating end **NA** N mini  
 Axial force – Opposite end **NA** N mini  
 Torque **NA** N.cm mini

**TOOLING**

Part Number	Description	Hexagon
.	.	.
R282.223.000	CRIMPING TOOL	5.40
R282.293.000	CRIMPING TOOL	-
R282.235.011	CRIMPING DIES	5.40

Recommended torque  
 Mating **NA** N.cm  
 Panel nut **NA** N.cm  
 Clamp nut **NA** N.cm  
 A/F clamp nut **0.000** mm

**OTHERS CHARACTERISTICS**

Mating life **500** Cycles mini  
 Weight **3.100** g

**ENVIRONMENTAL**

Operating temperature **-65/+165** °C  
 Leakage – pressurised only **NA** Atm.cm3/s  
 Hermetic seal **NA** Mpa



Issue : 9840 J

Design changes may be in order to improve the product.