

REVISIONS				
REV	ECO	DESCRIPTION	DATE	BY APPR
A1	-	RELEASED DRAWING	Nov-9-17	Rookie Tommy
A2	-	ADD THE G5 PART NUMBER	Jan-28-19	Blink Tommy
A3	-	CHANGE HAND CRIMPER	Nov-8-19	Flan Tommy

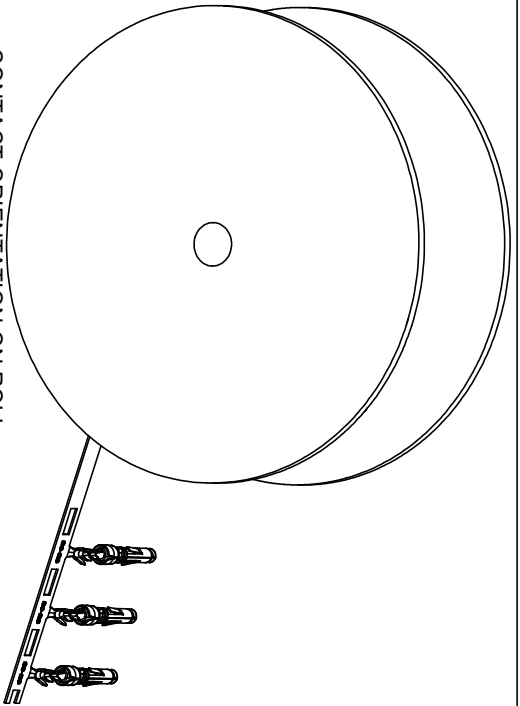

CONTACT ORIENTATION ON ROLL  
 NOTES: (UNLESS OTHERWISE SPECIFIED)

- MATERIAL:
  - CONTACT BODY: COPPER ALLOY.
  - OUTER SPRING: STAINLESS STEEL.
- SPECIFICATIONS:
  - CURRENT RATING: 5A MAX.
  - TERMINATION TYPE: CRIMPING.
  - WIRE RANGE: 30~28AWG.
  - WIRE INSULATION DIA(MAX):  $\varnothing 1.8\text{mm}$ .
- ROHS COMPLIANT.
- ALL DIMENSIONS ARE FOR REFERENCE USE ONLY.
- AVAILABLE TOOLS:
  - HAND CRIMPER: MFX-3958. <sup>(A3)</sup>
  - CRIMP APPLICATOR: MFX-3957.
  - EXTRACTION TOOL: QXRT20.

P/N	CONTACT PLATING(MATING AREA)
SS28W2T	TIN PLATING OVER NICKEL.
SS28W2N	NICKEL PLATING OVER COPPERIZE.
SS28W2F	GOLD FLASH PLATING OVER NICKEL.
SS28W2G5	5 $\mu$ " GOLD PLATING OVER NICKEL.
SS28W2G10	10 $\mu$ " GOLD PLATING OVER NICKEL.
SS28W2G15	15 $\mu$ " GOLD PLATING OVER NICKEL.
SS28W2G30	30 $\mu$ " GOLD PLATING OVER NICKEL.

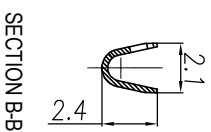
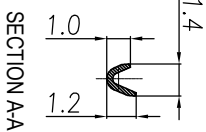
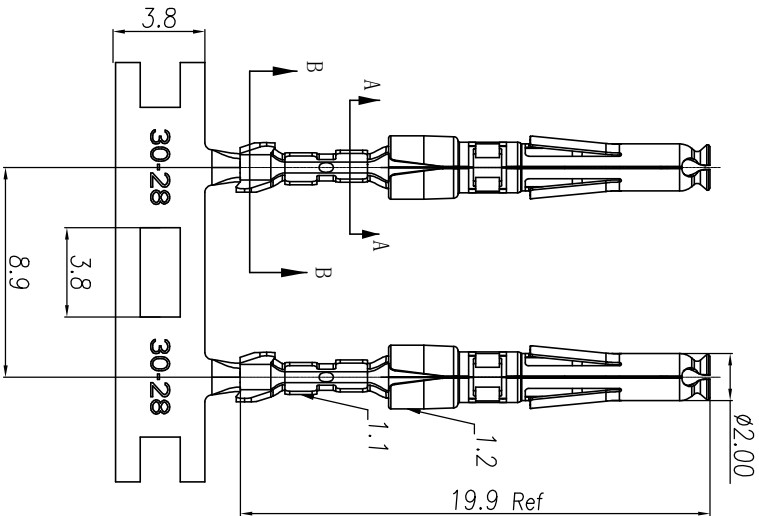

QUANTITY	PART NUMBER	DESCRIPTION	ITEM
		<b>MATERIALS LIST</b>	
UNLESS OTHERWISE SPECIFIED 1) ALL DIMENSIONS ARE IN MILLIMETERS. 2) TOLERANCES ARE AS SHOWN. 3) PL: DEC 2019 4) FPC: DEC 2019 5) FPC: DEC 2019 6) Note reference =			
SIGNATURES DRAWN: <b>Rli</b> CHECKED: <b>MWh</b> ENGINEER: _____ APPROVE: <b>Tommy</b>		DATE Nov-8-19 Nov-8-19 Nov-8-19	
PROCESS SPECIFICATIONS MATERIAL SPECIFICATIONS NEXT ASBY: _____		CUSTOMER: _____ THE DRAWING IS SUPPLIED FOR SPECIFICATIONS AND PERFORMANCE DATA. THE MANUFACTURER ASSUMES NO RESPONSIBILITY FOR REPRODUCTION AND ALL RIGHTS RESERVED. MANUFACTURING VARIATIONS.	
ECO-MATE SOCKET CONTACT, STAMPED, 28-30AWG, SIZE 20		SIZE TYPE <b>B C-</b>	DRAWING NO. <b>SS28W2XX</b>
SCALE: NONE		SHEET 1 OF 1	REVISION <b>A3</b>

**Amphenol**

Sine Systems - www.amphenol-sine.com  
 44724 Morley Drive  
 Clinton Township, MI 48038

ECO-MATE SOCKET CONTACT,  
 STAMPED, 28-30AWG, SIZE 20

SCALE: NONE

SHEET 1 OF 1

REVISION  
**A3**