

THIS DRAWING IS UNPUBLISHED. RELEASED FOR PUBLICATION  
 © COPYRIGHT - By - ALL RIGHTS RESERVED.

LOC	DIST	REVISIONS					
		P	LTR	DESCRIPTION	DATE	DWN	APVD
G	14		F2	REVISED PER ECO-11-004917	11MAR11	RK	HMR

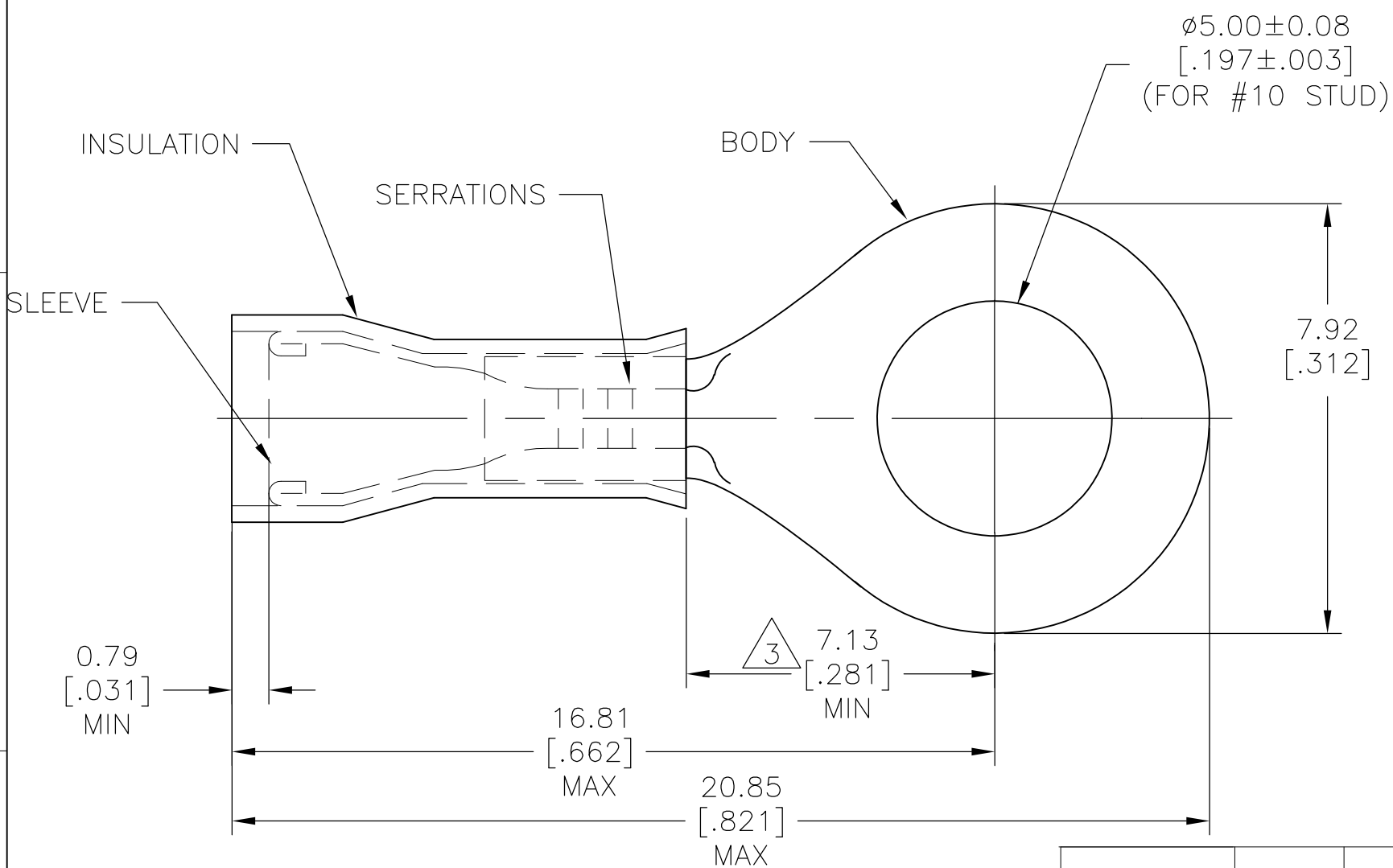

- 1 FOR 1.02 [.040] TO 2.54 [.100] WIRE INSULATION DIA
- 2 TONGUE MATERIAL THK = 0.58 ± 0.05 [.023 ± 0.002]
- 3 APPLIES FROM THE METAL EDGE OF THE BARREL TO THE CENTER OF THE STUD
- 4 SUPERCEDED BY 323990

4	OBSOLETE	5000	2-323990-2 ON TAPE	BODY & SLEEVE: COPPER (ASTM-B152) TIN PL (ASTM-B545) INSULATION: BLACK NYLON (ASTM-D4066) TYPE 1	2-323990-3
	4	OBSOLETE	1000		LOOSE PC
4	OBSOLETE	5000	323990 ON TAPE	BODY & SLEEVE: COPPER (ASTM-B152) TIN PL (ASTM-B545) INSULATION: NATURAL NYLON (ASTM-D4066) TYPE 1	2-323990-1
			1000		LOOSE PC
		QTY	PACKAGE TYPE	MATERIAL & FINISH	PART NO

THIS DRAWING IS A CONTROLLED DOCUMENT.		DWN R.GRZYBOWSKI 9NOV2009	<b>STE</b> TE Connectivity			
DIMENSIONS: mm [INCHES]		CHK TOM MICHIELUTTI 9NOV2009				
TOLERANCES UNLESS OTHERWISE SPECIFIED:		APVD M.PERCHERKE 9NOV2009	NAME			
0 PLC ± -		PRODUCT SPEC	WIRE TERMINAL			
1 PLC ± -		APPLICATION SPEC	PIDG - RING TONGUE			
2 PLC ± -		WEIGHT	WIRE SIZE: 24-20			
3 PLC ± 0.20 [.008]		MATERIAL SEE TABLE	SIZE	CAGE CODE	DRAWING NO	RESTRICTED TO
4 PLC ± -			FINISH	SEE TABLE	SEE TABLE	SEE TABLE
ANGLES ± 0° 30'		CUSTOMER DRAWING		SCALE	SHEET	REV
				8:1	1 OF 1	F2