

THIS COPY IS PROVIDED ON A RESTRICTED BASIS AND IS NOT TO BE USED IN ANY WAY DETRIMENTAL TO THE INTERESTS OF PANDUIT CORP.

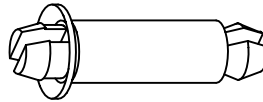
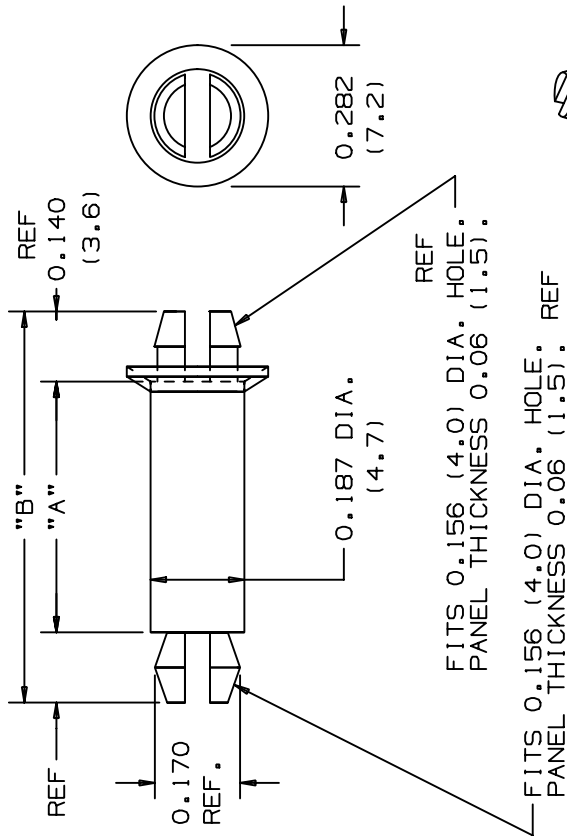

NOTE:

- \*1. SEE CURRENT PRICE SHEET FOR PART NUMBER SUFFIX DESIGNATION FOR PACKAGE SIZE AND PART NUMBER.

*PANDUIT PART NO.	A (REF) in/(mm) HEIGHT	B in/(mm)	WEIGHT lbs (g)/100pcs
CBP12	0.12(3.0)	0.40(10.2)	0.029(13)
CBP25	0.25(6.4)	0.53(13.5)	0.042(19)
CBP31	0.31(7.9)	0.59(15.0)	0.048(22)
CBP37	0.37(9.4)	0.62(15.7)	0.055(25)
CBP50	0.50(12.7)	0.78(19.8)	0.068(31)
CBP62	0.62(15.7)	0.90(22.9)	0.081(37)
CBP75	0.75(19.1)	1.03(26.2)	0.090(41)
CBP87	0.87(22.1)	1.15(29.2)	0.106(48)
CBP100	1.00(25.4)	1.28(32.5)	0.119(54)

(DIMENSIONS IN PARENTHESES ARE IN METRIC.)  
 CAD FILENAME/LAYERS G00239BK\_PB\_CBP\_03



TINLEY PARK, ILLINOIS

CBP - CIRCUIT BOARD POST

UNLESS OTHERWISE SPECIFIED, DIMENSIONAL TOLERANCES ARE: (.X) ±0.1(2.5) (-XXX) ± 0.020(.5) (.XX) ±0.05(1.3)/ANGLES ± 5°		UNLESS OTHERWISE SPECIFIED, ALL DIMENSIONS ARE GIVEN IN INCHES, THIRD ANGLE PROJECTION.	
DRAWN BY	JRL	MAT'L:	NONE
DATE	1/8/93		
CHK'D			
		NYLON 6/6	
		DRIVING NO.	GBO239BK
		DWG	A
		SCALE	SIZE

REV	DATE	BY	CHK	DESCRIPTION	ECN	R	CUST	SUP
3	5-2-02	LGG		ADDED HEIGHT AND REFERENCE TO DIM 'A' TABLE	GBO239BK	3		
2	6-26-01	LGG		ADDED REF TO DIM UPDATED FOR WEB	GBO239BK	2		
1	6-26-96	CJG		ADDED .170 REF. DIM.	GBO239BK	1		
R	1-9-93	JRL		INITIAL RELEASE	GBO239BK	R		