

## FEATURES AND SPECIFICATIONS

### Features and Benefits

- Sizes 2 to 24 circuits available
- Optional voided circuits available
- Various pin lengths available (contact Inside Sales)
- May be purchased in full 24 circuit sticks and broken into required circuit sizes
- 41661 has square pins and 41701 has round pins

### Reference Information

Product Specification: PS-41186/08-50

Packaging: Bag

Tooling Information: See cutting tool section

UL File No.: E29179

CSA File No.: LR19980

TUV File No.: R75108

Mates With: .156" Crimp/IDT/PCB connectors

Designed In: Inches

### Electrical

Voltage: 250V AC max.

Current: 7.0A max.\*

Contact Resistance: 6mΩ max.

Dielectric Withstanding Voltage: 1500V

Insulation Resistance: 50K MΩ min.

### Mechanical

Durability:

Tin—25 cycles max.

Gold—100 cycles max.

### Physical

Housing: Black glass-filled polyester, UL 94V-0

Contact: Brass, 1.14mm (.045") pins

Plating: See Table

Temperature: 0 to +75°C

**molex**® 3.96mm (.156") Pitch  
KK®

**Breakaway Header**

**41661/41701**

**Vertical**

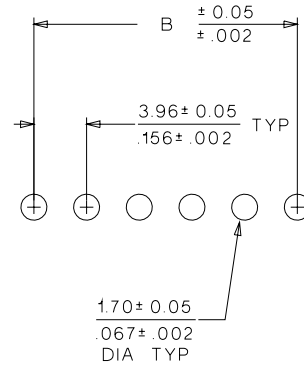
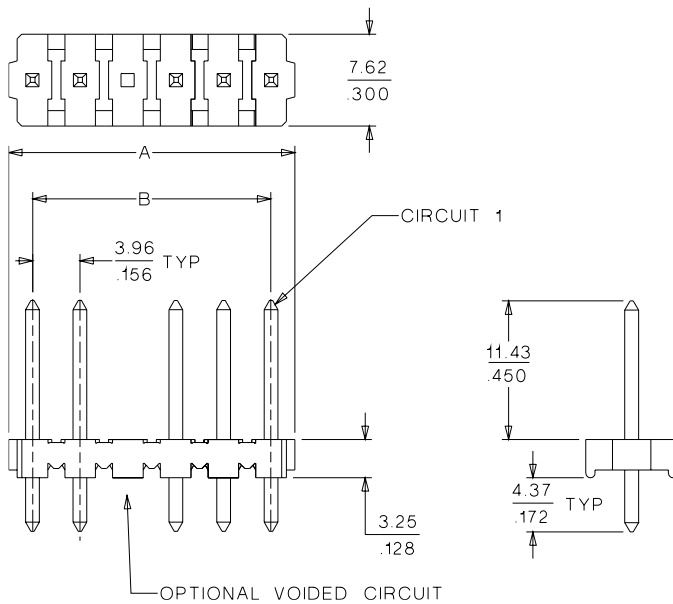
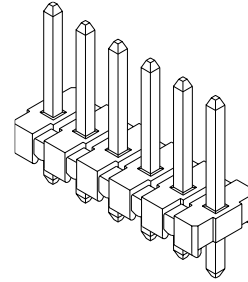

PCB LAYOUT: COMPONENT SIDE  
RECOMMENDED PCB THICKNESS 1.57 ± 0.18 / .062 ± .007

Note: 41661 shown

## ORDERING INFORMATION AND DIMENSIONS

Circuits	Order No.						Dimension	
	Square Pin			Round Pin			A	B
	Tin	15µm Select Gold	30µm Select Gold	Tin	Overall Gold	Overall Gold		
2	26-48-1021	41661-0001	41661-0024	26-51-0021	26-51-2020	6.78 (.267)	3.96 (.156)	
3	26-48-1031	41661-0002	41661-0025	26-51-0031	26-51-2030	10.74 (.423)	7.92 (.312)	
4	26-48-1041	41661-0003	41661-0026	26-51-0041	26-51-2040	14.71 (.579)	11.89 (.468)	
5	26-48-1051	41661-0004	41661-0027	26-51-0051	26-51-2050	18.67 (.735)	15.85 (.624)	
6	26-48-1061	41661-0005	41661-0028	26-51-0061	26-51-2060	22.63 (.891)	19.81 (.780)	
7	26-48-1071	41661-0006	41661-0029	26-51-0071	26-51-2070	26.59 (1.047)	23.77 (.936)	
8	26-48-1081	41661-0007	41661-0030	26-51-0081	26-51-2080	30.56 (1.203)	27.74 (1.092)	
9	26-48-1091	41661-0008	41661-0031	26-51-0091	26-51-2090	34.52 (1.359)	31.71 (1.248)	
10	26-48-1101	41661-0009	41661-0032	26-51-0101	26-51-2100	38.48 (1.515)	35.66 (1.404)	
11	26-48-1111	41661-0010	41661-0033	26-51-0111	26-51-2110	42.44 (1.671)	39.62 (1.560)	
12	26-48-1121	41661-0011	41661-0034	26-51-0121	26-51-2120	46.41 (1.827)	43.59 (1.716)	
13	26-48-1131	41661-0012	41661-0035	26-51-0131	26-51-2130	50.37 (1.983)	47.55 (1.872)	

Circuits	Order No.						Dimension	
	Square Pin			Round Pin			A	B
	Tin	15µm Select Gold	30µm Select Gold	Tin	Overall Gold	Overall Gold		
14	26-48-1141	41661-0013	41661-0036	26-51-0141	26-51-2140	54.33 (2.139)	51.51 (2.028)	
15	26-48-1151	41661-0014	41661-0037	26-51-0151	26-51-2150	58.29 (2.295)	55.47 (2.184)	
16	26-48-1161	41661-0015	41661-0038	26-51-0161	26-51-2160	62.26 (2.451)	59.44 (2.340)	
17	26-48-1171	41661-0016	41661-0039	26-51-0171	26-51-2170	66.22 (2.607)	63.40 (2.496)	
18	26-48-1181	41661-0017	41661-0040	26-51-0181	26-51-2180	70.18 (2.763)	67.36 (2.652)	
19	26-48-1191	41661-0018	41661-0041	26-51-0191	26-51-2190	74.14 (2.919)	71.32 (2.808)	
20	26-48-1201	41661-0019	41661-0042	26-51-0201	26-51-2200	78.11 (3.075)	75.29 (2.964)	
21	26-48-1211	41661-0020	41661-0043	26-51-0211	26-51-2210	82.07 (3.231)	79.25 (3.120)	
22	26-48-1221	41661-0021	41661-0044	26-51-0221	26-51-2220	86.03 (3.387)	83.21 (3.276)	
23	26-48-1231	41661-0022	41661-0045	26-51-0231	26-51-2230	89.94 (3.541)	87.17 (3.432)	
24	26-48-1241	41661-0023	41661-0046	26-51-0241	26-51-2240	93.85 (3.695)	91.14 (3.588)	

\* Dependent upon connector and PC board

Circuit number designation is for ordering purposes only, check corresponding circuit designation on mating connector

## FEATURES AND SPECIFICATIONS

### Features and Benefits

- Sizes 2 to 24 circuits available
- Optional voided circuits available
- Various pin lengths available (contact Inside Sales)
- May be purchased in full 24 circuit sticks and broken into required circuit sizes

### Reference Information

Product Specification: PS-41186/08-50  
 Packaging: Bag  
 Tooling Information: See cutting tool section  
 UL File No.: E29179  
 CSA File No.: LR19980  
 TUV File No.: R75108  
 Mates With: .156" Crimp/IDT/PCB connectors  
 Designed In: Inches

### Electrical

Voltage: 250V AC max.  
 Current: 7.0A max.\*  
 Contact Resistance: 6mΩ max.  
 Dielectric Withstanding Voltage: 1500V  
 Insulation Resistance: 50K MΩ min.

### Mechanical

Durability:  
 Tin—25 cycles max.  
 Gold—100 cycles max.

### Physical

Housing: Black glass-filled polyester, UL 94V-0  
 Contact: Brass, 1.14mm (.045") pins  
 Plating: See Table  
 Temperature: 0 to +75°C

# molex® 3.96mm (.156") Pitch KK® Breakaway Header

## 41662 Right Angle

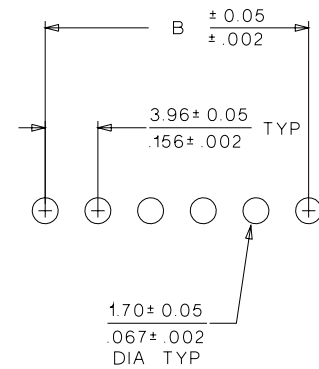
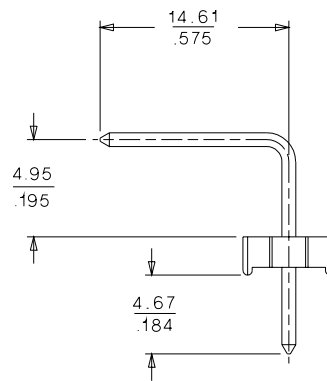
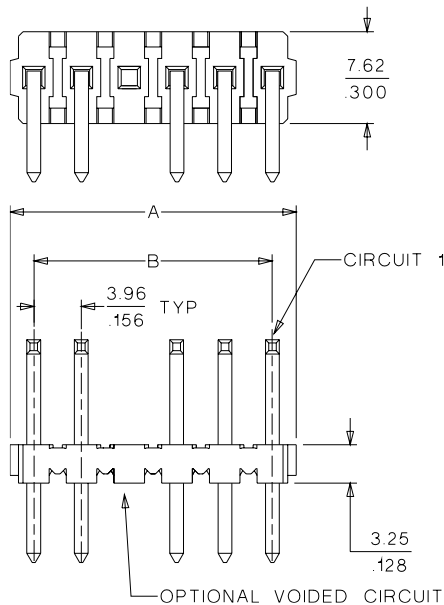
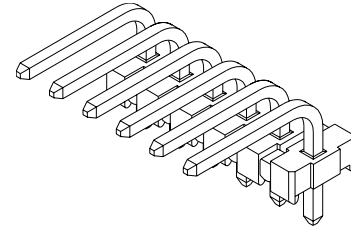

PCB LAYOUT: COMPONENT SIDE  
 RECOMMENDED PCB THICKNESS  $\frac{1.57 \pm 0.18}{.062 \pm .007}$

## ORDERING INFORMATION AND DIMENSIONS

Circuits	Order No.				Dimension	
	Square Pin				A	B
	Tin	15µ" Select Gold	30µ" Select Gold	Overall Gold		
2	26-48-1022	41662-0001	41662-0024	26-48-2022	6.78 (.267)	3.96 (.156)
3	26-48-1032	41662-0002	41662-0025	26-48-2032	10.74 (.423)	7.92 (.312)
4	26-48-1042	41662-0003	41662-0026	26-48-2042	14.71 (.579)	11.89 (.468)
5	26-48-1052	41662-0004	41662-0027	26-48-2052	18.67 (.735)	15.85 (.624)
6	26-48-1062	41662-0005	41662-0028	26-48-2062	22.63 (.891)	19.81 (.780)
7	26-48-1072	41662-0006	41662-0029	26-48-2072	26.59 (1.047)	23.77 (.936)
8	26-48-1082	41662-0007	41662-0030	26-48-2082	30.56 (1.203)	27.74 (1.092)
9	26-48-1092	41662-0008	41662-0031	26-48-2092	34.52 (1.359)	31.71 (1.248)
10	26-48-1102	41662-0009	41662-0032	26-48-2102	38.48 (1.515)	35.66 (1.404)
11	26-48-1112	41662-0010	41662-0033	26-48-2112	42.44 (1.671)	39.62 (1.560)
12	26-48-1122	41662-0011	41662-0034	26-48-2122	46.41 (1.827)	43.59 (1.716)
13	26-48-1132	41662-0012	41662-0035	26-48-2132	50.37 (1.983)	47.55 (1.872)

Circuits	Order No.				Dimension	
	Square Pin				A	B
	Tin	15µ" Select Gold	30µ" Select Gold	Overall Gold		
14	26-48-1142	41662-0013	41662-0036	26-48-2142	54.33 (2.139)	51.51 (2.028)
15	26-48-1152	41662-0014	41662-0037	26-48-2152	58.29 (2.295)	55.47 (2.184)
16	26-48-1162	41662-0015	41662-0038	26-48-2162	62.26 (2.451)	59.44 (2.340)
17	26-48-1172	41662-0016	41662-0039	26-48-2172	66.22 (2.607)	63.40 (2.496)
18	26-48-1182	41662-0017	41662-0040	26-48-2182	70.18 (2.763)	67.36 (2.652)
19	26-48-1192	41662-0018	41662-0041	26-48-2192	74.14 (2.919)	71.32 (2.808)
20	26-48-1202	41662-0019	41662-0042	26-48-2202	78.11 (3.075)	75.29 (2.964)
21	26-48-1212	41662-0020	41662-0043	26-48-2212	82.07 (3.231)	79.25 (3.120)
22	26-48-1222	41662-0021	41662-0044	26-48-2222	86.03 (3.387)	83.21 (3.276)
23	26-48-1232	41662-0022	41662-0045	26-48-2232	89.94 (3.541)	87.17 (3.432)
24	26-48-1242	41662-0023	41662-0046	26-48-2242	93.85 (3.695)	91.14 (3.588)

\* Dependent upon connector and PC board

Circuit number designation is for ordering purposes only, check corresponding circuit designation on mating connector

## FEATURES AND SPECIFICATIONS

### Features and Benefits

- Sizes 2 to 24 circuits available
- Optional voided circuits available
- Various pin lengths available (contact Inside Sales)
- May be purchased in full 24 circuit sticks and broken into required circuit sizes
- Passive locking feature is used to maintain interconnection and is ideal for high vibration applications
- 41671 has square pins and 41711 has round pins

### Reference Information

Product Specification: PS-41186/08-50

Packaging: Bag

Tooling Information: See cutting tool section

UL File No.: E29179

CSA File No.: LR19980

TUV File No.: R75108

Mates With: 2139, 2145, 3069, 3215, 6442, 41695 and 41815

Designed In: Inches

### Electrical

Voltage: 250V AC max.

Current: 7.0A max.\*

Contact Resistance: 6mΩ max.

Dielectric Withstanding Voltage: 1500V

Insulation Resistance: 50K MΩ min.

### Mechanical

Durability:

Tin—25 cycles max.

Gold—100 cycles max.

### Physical

Housing: Black glass-filled polyester, UL 94V-0

Contact: Brass, 1.14mm (.045") pins

Plating: See Table

Temperature: 0 to +75°C

**molex**® 3.96mm (.156") Pitch  
KK®

**Breakaway Header**

**41671/41711**

**Vertical  
Friction Lock**

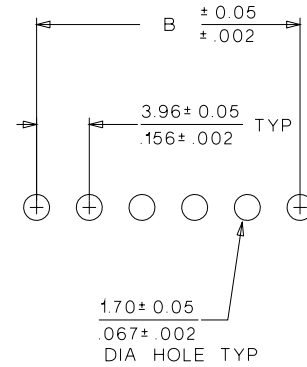
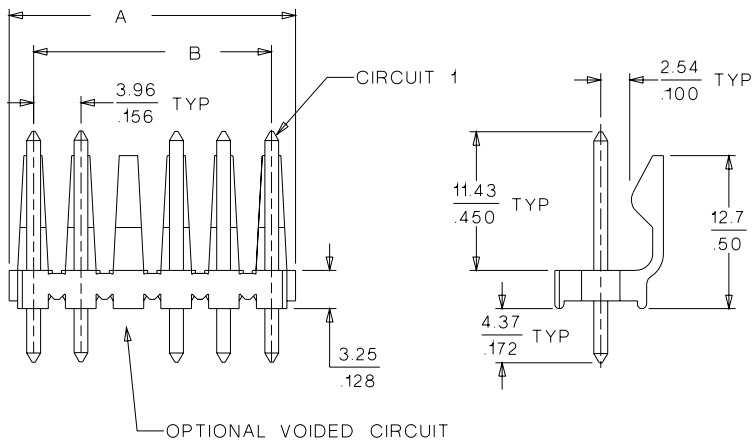
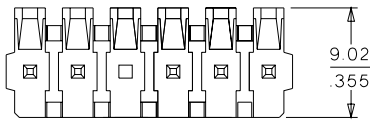
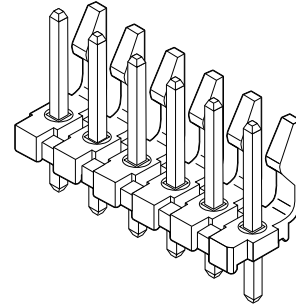

PCB LAYOUT: COMPONENT SIDE  
RECOMMENDED PCB THICKNESS  $\frac{1.57 \pm 0.18}{.062 \pm .007}$

Note: 41671 shown

## ORDERING INFORMATION AND DIMENSIONS

Circuits	Order No.					Dimension	
	Square Pin			Round Pin		A	B
	Tin	15µ" Select Gold	30µ" Select Gold	Tin	Overall Gold		
2	26-48-1025	41671-0001	41671-0024	26-51-0022	26-51-2022	6.78 (.267)	3.96 (.156)
3	26-48-1035	41671-0002	41671-0025	26-51-0032	26-51-2032	10.74 (.423)	7.92 (.312)
4	26-48-1045	41671-0003	41671-0026	26-51-0042	26-51-2042	14.71 (.579)	11.89 (.468)
5	26-48-1055	41671-0004	41671-0027	26-51-0052	26-51-2052	18.67 (.735)	15.85 (.624)
6	26-48-1065	41671-0005	41671-0028	26-51-0062	26-51-2062	22.63 (.891)	19.81 (.780)
7	26-48-1075	41671-0006	41671-0029	26-51-0072	26-51-2072	26.59 (1.047)	23.77 (.936)
8	26-48-1085	41671-0007	41671-0030	26-51-0082	26-51-2082	30.56 (1.203)	27.74 (1.092)
9	26-48-1095	41671-0008	41671-0031	26-51-0092	26-51-2092	34.52 (1.359)	31.71 (1.248)
10	26-48-1105	41671-0009	41671-0032	26-51-0102	26-51-2102	38.48 (1.515)	35.66 (1.404)
11	26-48-1115	41671-0010	41671-0033	26-51-0112	26-51-2112	42.44 (1.671)	39.62 (1.560)
12	26-48-1125	41671-0011	41671-0034	26-51-0122	26-51-2122	46.41 (1.827)	43.59 (1.716)
13	26-48-1135	41671-0012	41671-0035	26-51-0132	26-51-2132	50.37 (1.983)	47.55 (1.872)

Circuits	Order No.					Dimension	
	Square Pin			Round Pin		A	B
	Tin	15µ" Select Gold	30µ" Select Gold	Tin	Overall Gold		
14	26-48-1145	41671-0013	41671-0036	26-51-0142	26-51-2142	54.33 (2.139)	51.51 (2.028)
15	26-48-1155	41671-0014	41671-0037	26-51-0152	26-51-2152	58.29 (2.295)	55.47 (2.184)
16	26-48-1165	41671-0015	41671-0038	26-51-0162	26-51-2162	62.26 (2.451)	59.44 (2.340)
17	26-48-1175	41671-0016	41671-0039	26-51-0172	26-51-2172	66.22 (2.607)	63.40 (2.496)
18	26-48-1185	41671-0017	41671-0040	26-51-0182	26-51-2182	70.18 (2.763)	67.36 (2.652)
19	26-48-1195	41671-0018	41671-0041	26-51-0192	26-51-2192	74.14 (2.919)	71.32 (2.808)
20	26-48-1205	41671-0019	41671-0042	26-51-0202	26-51-2202	78.11 (3.075)	75.29 (2.964)
21	26-48-1215	41671-0020	41671-0043	26-51-0212	26-51-2212	82.07 (3.231)	79.25 (3.120)
22	26-48-1225	41671-0021	41671-0044	26-51-0222	26-51-2222	86.03 (3.387)	83.21 (3.276)
23	26-48-1235	41671-0022	41671-0045	26-51-0232	26-51-2232	89.94 (3.541)	87.17 (3.432)
24	26-48-1245	41671-0023	41671-0046	26-51-0242	26-51-2242	93.85 (3.695)	91.14 (3.588)

\* Dependent upon connector and PC board

Circuit number designation is for ordering purposes only, check corresponding circuit designation on mating connector

## FEATURES AND SPECIFICATIONS

### Features and Benefits

- Sizes 2 to 24 circuits available
- Optional voided circuits available
- Various pin lengths available (contact Inside Sales)
- PCB edge mount only
- May be purchased in full 24 circuit sticks and broken into required circuit sizes

### Reference Information

Product Specification: PS-41186/08-50

Packaging: Bag

Tooling Information: See cutting tool section

UL File No.: E29179

CSA File No.: LR19980

TUV File No.: R75108

Mates With: 2139, 2145, 3069, 3215, 6442,  
41695 and 41815

Designed In: Inches

### Electrical

Voltage: 250V

Current: 7.0A

Contact Resistance: 6mΩ max.

Dielectric Withstanding Voltage: 1500V

Insulation Resistance: 50K MΩ min.

### Mechanical

Durability:

Tin—25 cycles max.

Gold—100 cycles max.

### Physical

Housing: Black glass-filled polyester, UL 94V-0

Contact: Brass, 1.14mm (.045") pins

Plating: See Table

Temperature: 0 to +105°C

# molex® 3.96mm (.156") Pitch KK® Breakaway Header

## 41672

## Right Angle Friction Lock

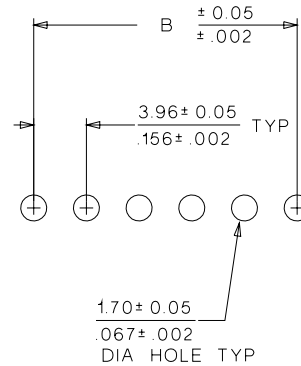
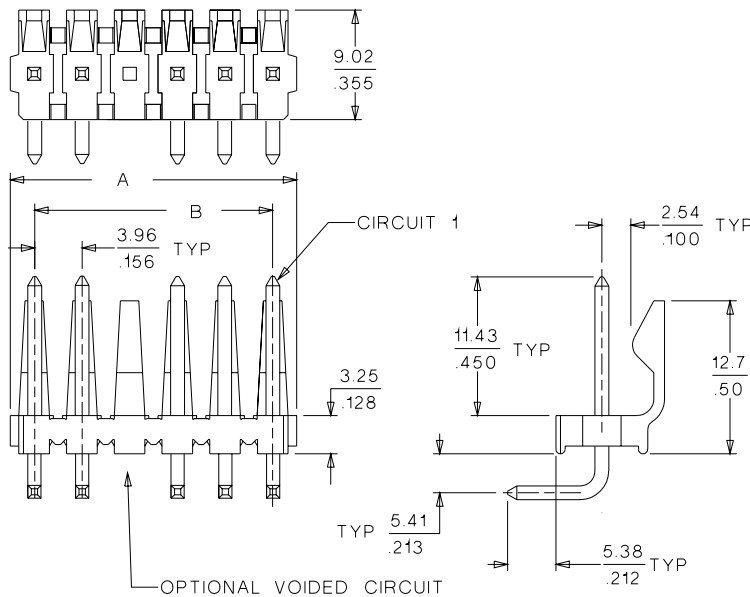
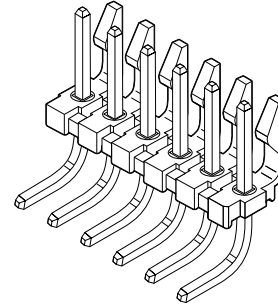

PCB LAYOUT: COMPONENT SIDE  
RECOMMENDED PCB THICKNESS 1.57 ± 0.18  
.062 ± .007

## ORDERING INFORMATION AND DIMENSIONS

Circuits	Order No.				Dimension	
	Square Pin				A	B
	Tin	15µ" Select Gold	30µ" Select Gold	Overall Gold		
2	26-48-1026	41672-0001	41672-0024	26-48-2026	6.78 (.267)	3.96 (.156)
3	26-48-1036	41672-0002	41672-0025	26-48-2036	10.74 (.423)	7.92 (.312)
4	26-48-1046	41672-0003	41672-0026	26-48-2046	14.71 (.579)	11.89 (.468)
5	26-48-1056	41672-0004	41672-0027	26-48-2056	18.67 (.735)	15.85 (.624)
6	26-48-1066	41672-0005	41672-0028	26-48-2066	22.63 (.891)	19.81 (.780)
7	26-48-1076	41672-0006	41672-0029	26-48-2076	26.59 (1.047)	23.77 (.936)
8	26-48-1086	41672-0007	41672-0030	26-48-2086	30.56 (1.203)	27.74 (1.092)
9	26-48-1096	41672-0008	41672-0031	26-48-2096	34.52 (1.359)	31.71 (1.248)
10	26-48-1106	41672-0009	41672-0032	26-48-2106	38.48 (1.515)	35.66 (1.404)
11	26-48-1116	41672-0010	41672-0033	26-48-2116	42.44 (1.671)	39.62 (1.560)
12	26-48-1126	41672-0011	41672-0034	26-48-2126	46.41 (1.827)	43.59 (1.716)
13	26-48-1136	41672-0012	41672-0035	26-48-2136	50.37 (1.983)	47.55 (1.872)

Circuits	Order No.				Dimension	
	Square Pin				A	B
	Tin	15µ" Select Gold	30µ" Select Gold	Overall Gold		
14	26-48-1146	41672-0013	41672-0036	26-48-2146	54.33 (2.139)	51.51 (2.028)
15	26-48-1156	41672-0014	41672-0037	26-48-2156	58.29 (2.295)	55.47 (2.184)
16	26-48-1166	41672-0015	41672-0038	26-48-2166	62.26 (2.451)	59.44 (2.340)
17	26-48-1176	41672-0016	41672-0039	26-48-2176	66.22 (2.607)	63.40 (2.496)
18	26-48-1186	41672-0017	41672-0040	26-48-2186	70.18 (2.763)	67.36 (2.652)
19	26-48-1196	41672-0018	41672-0041	26-48-2196	74.14 (2.919)	71.32 (2.808)
20	26-48-1206	41672-0019	41672-0042	26-48-2206	78.11 (3.075)	75.29 (2.964)
21	26-48-1216	41672-0020	41672-0043	26-48-2216	82.07 (3.231)	79.25 (3.120)
22	26-48-1226	41672-0021	41672-0044	26-48-2226	86.03 (3.387)	83.21 (3.276)
23	26-48-1236	41672-0022	41672-0045	26-48-2236	89.94 (3.541)	87.17 (3.432)
24	26-48-1246	41672-0023	41672-0046	26-48-2246	93.85 (3.695)	91.14 (3.588)

Circuit number designation is for ordering purposes only, check corresponding circuit designation on mating connector