

**MPLAB[®] Starter Kit for
Serial Memory Products
User's Guide**

Note the following details of the code protection feature on Microchip devices:

- Microchip products meet the specification contained in their particular Microchip Data Sheet.
- Microchip believes that its family of products is one of the most secure families of its kind on the market today, when used in the intended manner and under normal conditions.
- There are dishonest and possibly illegal methods used to breach the code protection feature. All of these methods, to our knowledge, require using the Microchip products in a manner outside the operating specifications contained in Microchip's Data Sheets. Most likely, the person doing so is engaged in theft of intellectual property.
- Microchip is willing to work with the customer who is concerned about the integrity of their code.
- Neither Microchip nor any other semiconductor manufacturer can guarantee the security of their code. Code protection does not mean that we are guaranteeing the product as "unbreakable."

Code protection is constantly evolving. We at Microchip are committed to continuously improving the code protection features of our products. Attempts to break Microchip's code protection feature may be a violation of the Digital Millennium Copyright Act. If such acts allow unauthorized access to your software or other copyrighted work, you may have a right to sue for relief under that Act.

Information contained in this publication regarding device applications and the like is provided only for your convenience and may be superseded by updates. It is your responsibility to ensure that your application meets with your specifications. MICROCHIP MAKES NO REPRESENTATIONS OR WARRANTIES OF ANY KIND WHETHER EXPRESS OR IMPLIED, WRITTEN OR ORAL, STATUTORY OR OTHERWISE, RELATED TO THE INFORMATION, INCLUDING BUT NOT LIMITED TO ITS CONDITION, QUALITY, PERFORMANCE, MERCHANTABILITY OR FITNESS FOR PURPOSE. Microchip disclaims all liability arising from this information and its use. Use of Microchip devices in life support and/or safety applications is entirely at the buyer's risk, and the buyer agrees to defend, indemnify and hold harmless Microchip from any and all damages, claims, suits, or expenses resulting from such use. No licenses are conveyed, implicitly or otherwise, under any Microchip intellectual property rights.

Trademarks

The Microchip name and logo, the Microchip logo, Accuron, dsPIC, KEELOQ, KEELOQ logo, MPLAB, PIC, PICmicro, PICSTART, PRO MATE, rPIC and SmartShunt are registered trademarks of Microchip Technology Incorporated in the U.S.A. and other countries.

FilterLab, Linear Active Thermistor, MXDEV, MXLAB, SEEVAL, SmartSensor and The Embedded Control Solutions Company are registered trademarks of Microchip Technology Incorporated in the U.S.A.

Analog-for-the-Digital Age, Application Maestro, CodeGuard, dsPICDEM, dsPICDEM.net, dsPICworks, dsSPEAK, ECAN, ECONOMONITOR, FanSense, In-Circuit Serial Programming, ICSP, ICEPIC, Mindi, MiWi, MPASM, MPLAB Certified logo, MPLIB, MPLINK, mTouch, PICkit, PICDEM, PICDEM.net, PICTail, PIC³² logo, PowerCal, PowerInfo, PowerMate, PowerTool, REAL ICE, rLAB, Select Mode, Total Endurance, UNI/O, WiperLock and ZENA are trademarks of Microchip Technology Incorporated in the U.S.A. and other countries.

SQTP is a service mark of Microchip Technology Incorporated in the U.S.A.

All other trademarks mentioned herein are property of their respective companies.

© 2008, Microchip Technology Incorporated, Printed in the U.S.A., All Rights Reserved.

 Printed on recycled paper.

**QUALITY MANAGEMENT SYSTEM
CERTIFIED BY DNV
== ISO/TS 16949:2002 ==**

Microchip received ISO/TS-16949:2002 certification for its worldwide headquarters, design and wafer fabrication facilities in Chandler and Tempe, Arizona; Gresham, Oregon and design centers in California and India. The Company's quality system processes and procedures are for its PIC[®] MCUs and dsPIC[®] DSCs, KEELOQ[®] code hopping devices, Serial EEPROMs, microperipherals, nonvolatile memory and analog products. In addition, Microchip's quality system for the design and manufacture of development systems is ISO 9001:2000 certified.



MPLAB[®] STARTER KIT FOR SERIAL MEMORY PRODUCTS USER'S GUIDE

Table of Contents

Preface	1
Chapter 1. Introduction	
1.1 Overview	7
1.2 Operational Requirements	8
1.3 Board Setup	8
Chapter 2. Using the Memory Starter Kit	
2.1 Connect the board to the PC	9
2.2 Selecting a Device, Writing and Reading	9
2.3 Using the Endurance Utility	9
2.4 Changing the Voltage and SPI Mode	10
Worldwide Sales and Service	12

MPLAB[®] Starter Kit for Serial Memory Products User's Guide

NOTES:



MPLAB STARTER KIT FOR SERIAL MEMORY PRODUCTS USER'S GUIDE

Preface

NOTICE TO CUSTOMERS

All documentation becomes dated, and this manual is no exception. Microchip tools and documentation are constantly evolving to meet customer needs, so some actual dialogs and/or tool descriptions may differ from those in this document. Please refer to our web site (www.microchip.com) to obtain the latest documentation available.

Documents are identified with a "DS" number. This number is located on the bottom of each page, in front of the page number. The numbering convention for the DS number is "DSXXXXA", where "XXXX" is the document number and "A" is the revision level of the document.

For the most up-to-date information on development tools, see the MPLAB® IDE online help. Select the Help menu, and then Topics to open a list of available online help files.

INTRODUCTION

This chapter contains general information that will be useful to know before you use the MPLAB Starter Kit for Serial Memory Products. Items discussed in this chapter include:

- Document Layout
- Conventions Used in this Guide
- Warranty Registration
- Recommended Reading
- The Microchip Web Site
- Development Systems Customer Change Notification Service
- Customer Support
- Document Revision History

DOCUMENT LAYOUT

This document describes how to use the starter kit as a programmer and debug tool for serial memory products and their capabilities. The manual layout is as follows:

- **Chapter 1. Introduction** – This chapter introduces the starter kit and provides an overview of its features.
- **Chapter 2. Using the Memory Starter Kit** – This chapter describes the Memory Starter Kit functionality.

MPLAB Starter Kit for Serial Memory Products User's Guide

CONVENTIONS USED IN THIS GUIDE

This manual uses the following documentation conventions:

DOCUMENTATION CONVENTIONS

Description	Represents	Examples
Arial font:		
Italic characters	Referenced books	<i>MPLAB[®] IDE User's Guide</i>
	Emphasized text	...is the <i>only</i> compiler...
Initial caps	A window	the Output window
	A dialog	the Settings dialog
	A menu selection	select Enable Programmer
Quotes	A field name in a window or dialog	"Save project before build"
Underlined, italic text with right angle bracket	A menu path	<u><i>File>Save</i></u>
Bold characters	A dialog button	Click OK
	A tab	Click the Power tab
N'Rnnnn	A number in verilog format, where N is the total number of digits, R is the radix and n is a digit.	4'b0010, 2'hF1
Text in angle brackets < >	A key on the keyboard	Press <Enter>, <F1>
Courier New font:		
Plain Courier New	Sample source code	#define START
	Filenames	autoexec.bat
	File paths	c:\mcc18\h
	Keywords	_asm, _endasm, static
	Command-line options	-Opa+, -Opa-
	Bit values	0, 1
	Constants	0xFF, 'A'
Italic Courier New	A variable argument	<i>file.o</i> , where <i>file</i> can be any valid filename
Square brackets []	Optional arguments	mcc18 [options] <i>file</i> [options]
Curly brackets and pipe character: { }	Choice of mutually exclusive arguments; an OR selection	errorlevel {0 1}
Ellipses...	Replaces repeated text	var_name [, var_name...]
	Represents code supplied by user	void main (void) { ... }

WARRANTY REGISTRATION

Please complete the enclosed Warranty Registration Card and mail it promptly. Sending in the Warranty Registration Card entitles you to receive new product updates. Interim software releases are available at the Microchip web site.

RECOMMENDED READING

This user's guide describes how to use the MPLAB Starter Kit for Serial Memory Products. Other useful documents are listed below. The following Microchip documents are available and recommended as supplemental reference resources.

Readme Files

For the latest information on using other tools, read the tool-specific Readme files in the Readmes subdirectory of the MPLAB IDE installation directory. The Readme files contain update information and known issues that may not be included in this user's guide.

- **I²C™ Serial EEPROM Family Data Sheet (DS21930)**
- **SPI Serial EEPROM Family Data Sheet (DS22040)**
- **Microwire Serial EEPROM Family Data Sheet (DS21929)**
- **UNI/O™ Serial EEPROM Family Data Sheet (DS22067)**
- **MPLAB® IDE User's Guide (DS51519)**
- **Recommended Usage of Microchip I²C™ Serial EEPROM Devices (DS01028)**
- **Recommended Usage of Microchip SPI Serial EEPROM Devices (DS01040)**
- **Recommended Usage of Microchip Microwire Serial EEPROM Devices (DS01029)**

THE MICROCHIP WEB SITE

Microchip provides online support via our web site at www.microchip.com. This web site is used as a means to make files and information easily available to customers. Accessible by using your favorite Internet browser, the web site contains the following information:

- **Product Support** – Data sheets and errata, application notes and sample programs, design resources, user's guides and hardware support documents, latest software releases and archived software
- **General Technical Support** – Frequently Asked Questions (FAQs), technical support requests, online discussion groups, Microchip consultant program member listing
- **Business of Microchip** – Product selector and ordering guides, latest Microchip press releases, listing of seminars and events, listings of Microchip sales offices, distributors and factory representatives

DEVELOPMENT SYSTEMS CUSTOMER CHANGE NOTIFICATION SERVICE

Microchip's customer notification service helps keep customers current on Microchip products. Subscribers will receive e-mail notification whenever there are changes, updates, revisions or errata related to a specified product family or development tool of interest.

To register, access the Microchip web site at www.microchip.com, click on Customer Change Notification and follow the registration instructions.

The Development Systems product group categories are:

- **Compilers** – The latest information on Microchip C compilers and other language tools. These include the MPASM™, MPLINK™ object linkers, and MPLIB™ object librarians.
- **In-Circuit Emulators** – The latest information on Microchip in-circuit emulators. These include the MPLAB REAL ICE and MPLAB ICE 2000 in-circuit emulators.

MPLAB Starter Kit for Serial Memory Products User's Guide

- **In-Circuit Debuggers** – The latest information on Microchip in-circuit debuggers. These include MPLAB ICD 2 and PICKit™ 2.
- **MPLAB IDE** – The latest information on Microchip MPLAB IDE, the Windows® Integrated Development Environment for development systems tools. This list is focused on the MPLAB IDE, MPLAB IDE Project Manager, MPLAB Editor and MPLAB SIM simulator, as well as general editing and debugging features.
- **Programmiers** – The latest information on Microchip programmers. These include the MPLAB PM3 device programmer and the PICSTART® Plus and 2 development programmers.

CUSTOMER SUPPORT

Users of Microchip products can receive assistance through several channels:

- Distributor or Representative
- Local Sales Office
- Field Application Engineer (FAE)
- Technical Support

Customers should contact their distributor, representative or field application engineer (FAE) for support. Local sales offices are also available to help customers. A listing of sales offices and locations is included in the back of this document.

Technical support is available through the web site at: <http://support.microchip.com>

DOCUMENT REVISION HISTORY

Revision A (April 2008)

- Initial Release of this Document

MPLAB Starter Kit for Serial Memory Products User's Guide

NOTES:



MPLAB STARTER KIT FOR SERIAL MEMORY PRODUCTS USER'S GUIDE

Chapter 1. Introduction

Thank you for purchasing Microchip Technology's MPLAB® Starter Kit for Serial Memory Products. This kit allows the user to read, write and verify any Microchip serial memory product including I²C™, SPI, Microwire, and UNI/O™ bus protocols. It also includes a built-in utility that tests EEPROM endurance.

This chapter introduces the Memory Starter Kit and provides an overview of its features. Topics covered include:

- Overview
- Operational Requirements
- Board Setup

1.1 OVERVIEW

The MPLAB Starter Kit for Serial Memory Products connects directly to the USB port on a computer. The PC USB connection supplies communications and power to the board.

The Memory Starter Kit includes programmer circuitry that allows data to be programmed onto the serial memory device and to verify its contents, all using MPLAB IDE.

The MPLAB Starter Kit for Serial Memory Products was designed to be a simple to use, yet powerful tool for people designing or troubleshooting serial memory applications. Apart from programming and reading the contents of all Microchip serial memory devices, it can help understand the communications between the memory device and a microcontroller, and to troubleshoot application problems.

MPLAB Starter Kit for Serial Memory Products User's Guide

1.2 OPERATIONAL REQUIREMENTS

To communicate with and program the MPLAB Starter Kit for Serial Memory Products, the following hardware and software requirements must be met:

- PC compatible system
- An available USB port on PC or powered USB hub
- CD-ROM drive
- Windows® 2000 SP4, Windows XP SP2, and Windows Vista™ (32-Bit)*
Operating Systems

* Only initial testing has been performed on 32-bit Vista for this release. 64-bit Vista is not supported at this time.

1.3 BOARD SETUP

Figure 1-1 is a drawing of a set up MPLAB Starter Kit for Serial Memory Products. The USB connection provides communication and power to the board.

FIGURE 1-1: MPLAB STARTER KIT FOR SERIAL MEMORY PRODUCTS SETUP

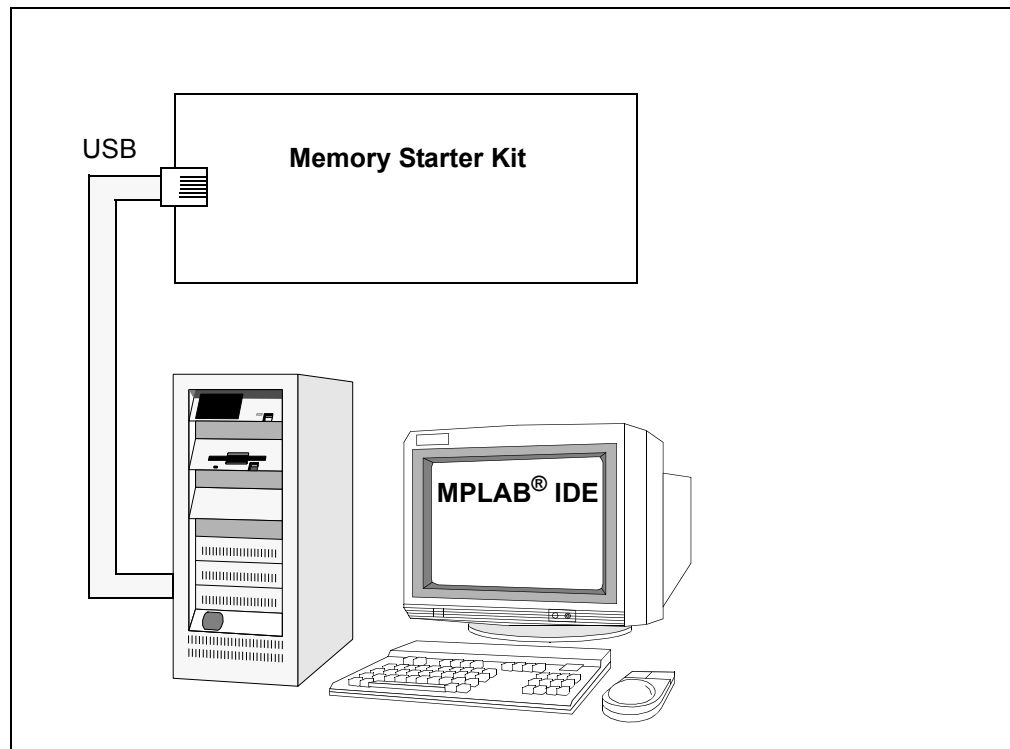

Chapter 2. Using the Memory Starter Kit

This chapter describes the Memory Starter Kit functionality and how to:

- Connect the board to the PC
- Select a Device, Write and Read
- Use the Endurance Utility
- Change the Voltage and SPI Mode

2.1 CONNECT THE BOARD TO THE PC

To run the Memory Starter Kit take these basic steps:

1. Power up the starter kit by connecting the board to the USB port of a computer.
You should briefly see a pop-up balloon in the system tray (lower right of desktop) that states (1) new hardware has been found, (2) drivers are being installed, and (3) new hardware is ready for use. If you do not see these messages and then the Memory Starter Kit does not work, try reconnecting the USB.
2. Start the MPLAB program and select the Memory Starter Kit from the “Tools” pull-down menu. You should then see “Memory Starter Kit connected” in the output window.

2.2 SELECT A DEVICE, WRITE AND READ

Once you have the board connected, select a device:

- Go to the Configure tool bar and the Select Device window will open. Select “SEExxx” from the Device Family pull-down menu if it is not already selected.
- Next, Select the memory device from the Devices menu.
- Now you are ready to use the Memory Starter Kit.
- Install the device into the 16-pin socket on the board. Be sure to place all Microwire devices in the upper half of the socket, all other devices including SPI, I²C, and UNI/O bus parts will go into the bottom half of the socket.
- Read or write to the device by using the Read and Write icons on the top of the GUI. These buttons work in conjunction with the “Read/Write options” pull-downs on the upper left. You can write a pattern or the buffer contents to the array. Select Entire Device or Selected Range for either writing or reading. Check the pull-down menus before reading or writing to get the desired operation.

2.3 USE THE ENDURANCE UTILITY

The Memory Starter Kit includes a utility that will allow you to test the endurance of any of the serial memory products that Microchip offers. By clicking on the Endurance button, you may select a user defined pattern or select from one of the patterns provided. When writing you have the ability to continuously write, read in between cycles, or even alternate data patterns. The endurance utility will automatically stop whenever a failure occurs.

2.4 CHANGE THE VOLTAGE AND SPI MODE

The Memory Starter Kit also gives you the ability to change voltage or change SPI modes by clicking on the Settings button. If you are using SPI you can select Mode 1,1 or Mode 0,0. If your device has the ability to work at multiple voltages you can select from two on-board voltages, either 3.3V or 5.0V. In addition, the Memory Starter Kit can be used with external voltages by changing the jumper to External VDD and using the provided power and ground connections. It is up to the user to make sure that his/her device can support voltages lower than 3.3V.

MPLAB[®] Starter Kit for Serial Memory Products User's Guide

NOTES:



WORLDWIDE SALES AND SERVICE

AMERICAS

Corporate Office
2355 West Chandler Blvd.
Chandler, AZ 85224-6199
Tel: 480-792-7200
Fax: 480-792-7277
Technical Support:
<http://support.microchip.com>
Web Address:
www.microchip.com

Atlanta

Duluth, GA
Tel: 678-957-9614
Fax: 678-957-1455

Boston

Westborough, MA
Tel: 774-760-0087
Fax: 774-760-0088

Chicago

Itasca, IL
Tel: 630-285-0071
Fax: 630-285-0075

Dallas

Addison, TX
Tel: 972-818-7423
Fax: 972-818-2924

Detroit

Farmington Hills, MI
Tel: 248-538-2250
Fax: 248-538-2260

Kokomo

Kokomo, IN
Tel: 765-864-8360
Fax: 765-864-8387

Los Angeles

Mission Viejo, CA
Tel: 949-462-9523
Fax: 949-462-9608

Santa Clara

Santa Clara, CA
Tel: 408-961-6444
Fax: 408-961-6445

Toronto

Mississauga, Ontario,
Canada
Tel: 905-673-0699
Fax: 905-673-6509

ASIA/PACIFIC

Asia Pacific Office
Suites 3707-14, 37th Floor
Tower 6, The Gateway
Harbour City, Kowloon
Hong Kong
Tel: 852-2401-1200
Fax: 852-2401-3431

Australia - Sydney
Tel: 61-2-9868-6733
Fax: 61-2-9868-6755

China - Beijing
Tel: 86-10-8528-2100
Fax: 86-10-8528-2104

China - Chengdu
Tel: 86-28-8665-5511
Fax: 86-28-8665-7889

China - Hong Kong SAR
Tel: 852-2401-1200
Fax: 852-2401-3431

China - Nanjing
Tel: 86-25-8473-2460
Fax: 86-25-8473-2470

China - Qingdao
Tel: 86-532-8502-7355
Fax: 86-532-8502-7205

China - Shanghai
Tel: 86-21-5407-5533
Fax: 86-21-5407-5066

China - Shenyang
Tel: 86-24-2334-2829
Fax: 86-24-2334-2393

China - Shenzhen
Tel: 86-755-8203-2660
Fax: 86-755-8203-1760

China - Wuhan
Tel: 86-27-5980-5300
Fax: 86-27-5980-5118

China - Xiamen
Tel: 86-592-2388138
Fax: 86-592-2388130

China - Xian
Tel: 86-29-8833-7252
Fax: 86-29-8833-7256

China - Zhuhai
Tel: 86-756-3210040
Fax: 86-756-3210049

ASIA/PACIFIC

India - Bangalore
Tel: 91-80-4182-8400
Fax: 91-80-4182-8422

India - New Delhi
Tel: 91-11-4160-8631
Fax: 91-11-4160-8632

India - Pune
Tel: 91-20-2566-1512
Fax: 91-20-2566-1513

Japan - Yokohama
Tel: 81-45-471- 6166
Fax: 81-45-471-6122

Korea - Daegu
Tel: 82-53-744-4301
Fax: 82-53-744-4302

Korea - Seoul
Tel: 82-2-554-7200
Fax: 82-2-558-5932 or
82-2-558-5934

Malaysia - Kuala Lumpur
Tel: 60-3-6201-9857
Fax: 60-3-6201-9859

Malaysia - Penang
Tel: 60-4-227-8870
Fax: 60-4-227-4068

Philippines - Manila
Tel: 63-2-634-9065
Fax: 63-2-634-9069

Singapore
Tel: 65-6334-8870
Fax: 65-6334-8850

Taiwan - Hsin Chu
Tel: 886-3-572-9526
Fax: 886-3-572-6459

Taiwan - Kaohsiung
Tel: 886-7-536-4818
Fax: 886-7-536-4803

Taiwan - Taipei
Tel: 886-2-2500-6610
Fax: 886-2-2508-0102

Thailand - Bangkok
Tel: 66-2-694-1351
Fax: 66-2-694-1350

EUROPE

Austria - Wels
Tel: 43-7242-2244-39
Fax: 43-7242-2244-393

Denmark - Copenhagen
Tel: 45-4450-2828
Fax: 45-4485-2829

France - Paris
Tel: 33-1-69-53-63-20
Fax: 33-1-69-30-90-79

Germany - Munich
Tel: 49-89-627-144-0
Fax: 49-89-627-144-44

Italy - Milan
Tel: 39-0331-742611
Fax: 39-0331-466781

Netherlands - Drunen
Tel: 31-416-690399
Fax: 31-416-690340

Spain - Madrid
Tel: 34-91-708-08-90
Fax: 34-91-708-08-91

UK - Wokingham
Tel: 44-118-921-5869
Fax: 44-118-921-5820