

Customer Information Sheet

DRAWING No.: M50-19X0005

IF IN DOUBT - ASK

©

NOT TO SCALE

THIRD ANGLE PROJECTION

ALL DIMENSIONS IN mm

SPECIFICATION.

MATERIAL:

INSULATOR = PBT, UL94V-0

FOR COLOUR SEE TABLE

CONTACT = COPPER ALLOY

FINISH:

0.025µ MIN GOLD FLASH OVER

0.81µ MIN NICKEL

ELECTRICAL:

CURRENT RATING = 1 AMP

INSULATION RESISTANCE = 1000M Ω MIN.

CONTACT RESISTANCE = 20m Ω MAX

DIELECTRIC VOLTAGE = 500V AC FOR ONE MINUTE

MECHANICAL:

INSERTION FORCE = 10.0N MAX

WITHDRAWAL FORCE = 0.6N MIN

DURABILITY = 300 OPERATIONS

ENVIRONMENTAL:

OPERATING TEMPERATURE = -40°C TO +105°C

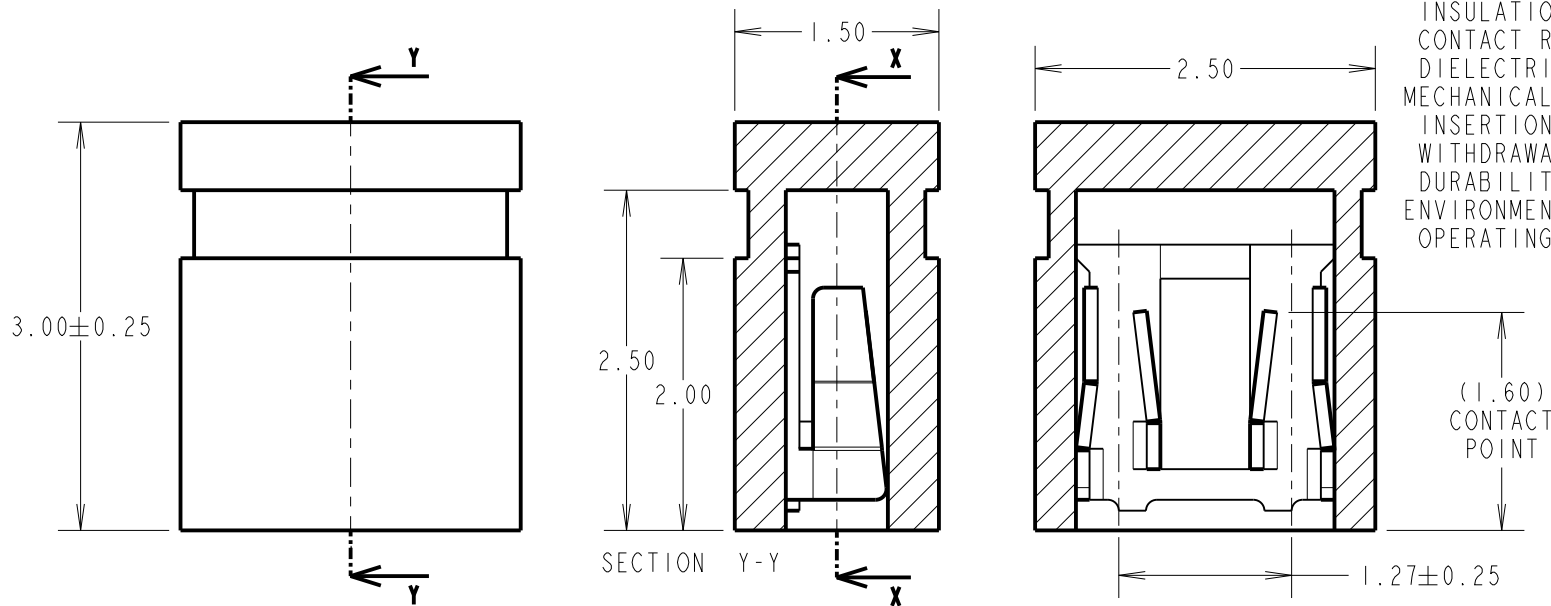

NOTES:
1. ALL TOLERANCES ARE ±0.38 UNLESS OTHERWISE STATED.

RA	4	12.04.22	31445
NAME	ISS.	DATE	CN/CO
APPROVED:		R.ALEXANDER	
CHECKED:		R.PORTLOCK	
DRAWN:		R.ADDE	
CUSTOMER REF.:			
ASSEMBLY DRG:			

PART No.	COLOUR
M50-1900005	BLACK
M50-1920005	RED
M50-1930005	BLUE

HARWIN

www.harwin.com
technical@harwin.com

THIS DRAWING AND ANY INFORMATION OR DESCRIPTIVE MATTER SET OUT HEREON ARE CONFIDENTIAL AND COPYRIGHT PROPERTY OF THE HARWIN GROUP AND MUST NOT BE DISCLOSED, LOANED, COPIED OR USED FOR MANUFACTURING, TENDERING OR FOR ANY OTHER PURPOSE WITHOUT THEIR WRITTEN PERMISSION.

TOLERANCES
~~Y. = ±1mm
X.X = ±0.50mm
X.XX = ±0.20mm
X.XXX = ±0.01mm
ANGLES = ±5°
UNLESS STATED~~

MATERIAL:
SEE ABOVE
FINISH: SEE ABOVE
S/AREA: mm²

TITLE:
1.27mm JUMPER SOCKET
DRAWING NUMBER:
M50-19X0005
SHT 2 OF 2

Mouser Electronics

Authorized Distributor

Click to View Pricing, Inventory, Delivery & Lifecycle Information:

[Harwin:](#)

[M50-1900005](#) [M50-1920005](#) [M50-1930005](#)