

X	
PART NO	vigor
2	G2
3	G3
4	G4
5	G5
6	G6
7	G7
8	G8

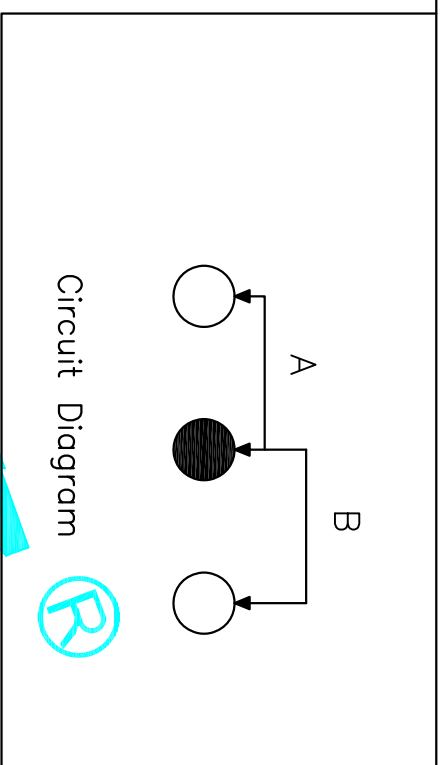

- Specification:
1. Rating: DC 30V 50mA
 2. Travel: 2.5 ± 0.1 mm
 3. Operating Force: A-B 150gf ± 7.5 gf
B-A 150gf ± 7.5 gf
 4. Contact Resistance: 100m Ω Max
 5. Life: 10,000 Cycles Min

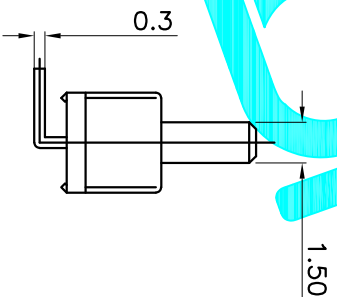
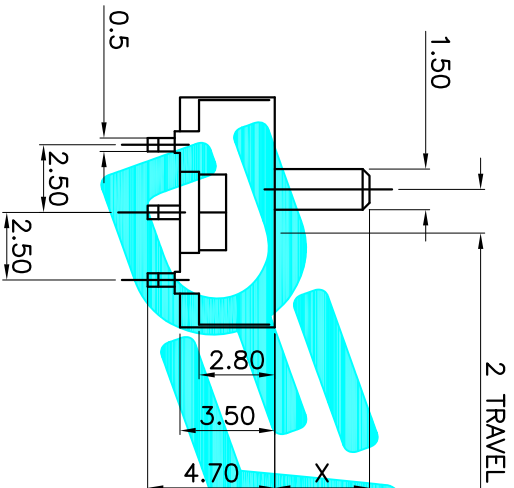
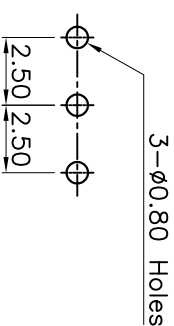

P.C.B Layout

ITEM	PART NAME	QTY.	MATERIAL	FINISHING
⑤	Contact	1	Phosphor Bronze	Ag Plated
④	Terminal	3	Brass Strip	Ag Plated
③	Base	1	Phenolic Resin	Natural
②	Frame	1	STEEL STRIP	Ni Plated
①	Knob	1	POM	Black

APPROVALS		DATE	TITLE:		PART NO.	SCALE:	SHEET
DRAWN	G.M.Chen	2014/11/25	VERTICAL SLIDE SWITCHES		SS-12D03-GX	1:1	1 OF 1
CHECKED							
APPROVALS							
TOLERANCES ARE		30 ^{±0.15}	±0.30	ANGLE	±2°	DRAWING NO.	PROJ.
		10 ^{±0.10}	±0.20				
		5 ^{±0.10}	±0.15				
ECN NO.	REV.	DATE.	DESCRIPTION.		CHANGE.	CHECK.	APPRO.
	A		NEW				