

Series 18X Hi-Amp Circuit Breaker

Auto, Manual & Switchable Reset Circuit Breakers

Specifications

Single Pole Thermal Type Breakers

Applications: Typically used in auxiliary and accessory circuits in truck, bus', RVs and marine systems. Others include battery chargers and DC audio systems. Series 181, 184 & 185 are sealed for engine compartment and bilge area applications.

Rating: 25-150A, 30Vdc; 48Vdc (Series 184 & 185)

Interrupt Rating: 3000A @ 30Vdc

Operating Temperature Rating: -25°F (-32°C) to 180°F (82°C)

Storage Temperature Rating: -30°F (-34°C) to 300°F (149°C)

Materials: Black UL-rated 94V0 thermoset plastic. Thermoplastic elastomer stud insulators are provided on covered units with F-style (surface-mount) bases

Marking: Standard marking includes amp ratings and part numbers. Custom markings also available.

Termination: 1/4-28 threaded studs

Torque Rating: 50 in-lbs (5.6N•m) max

Mounting Torque Rating: Panel or surface-mount options; 50 in-lbs (5.6N•m) max. Threaded insert option has a max torque of 25 in-lbs (2.8N•m).

Ingress Protection Rating: IP67

Features / Options: Series 184 & 185 have a unique reset mechanism which provides visual indication of tripped condition. Series 185 also features a push-to-trip option

Compliances: SAE J1625; ABYC E-11; CE; SAE J1171 (ignition protected)

Dimensions - in(mm) (Dims. shown are for reference only. Consult factory for latest prints)

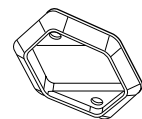
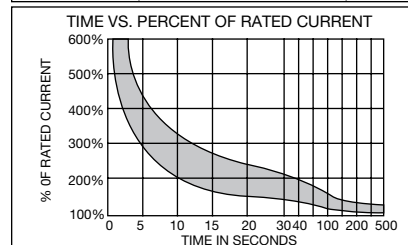
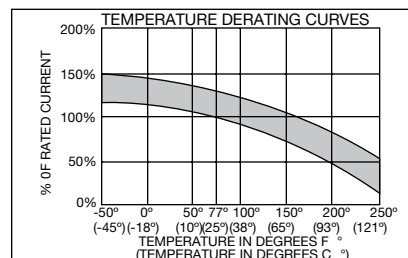
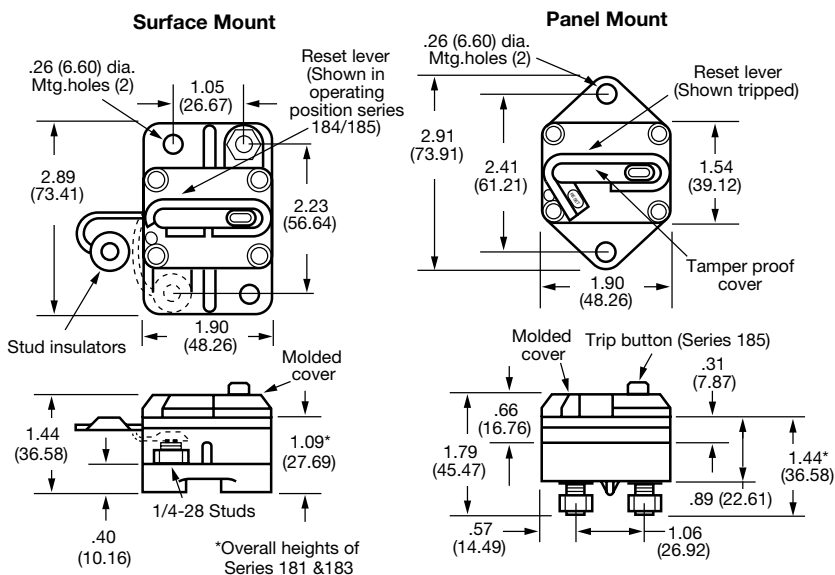

Flange mount gasket for thru-wall applications (option 07)

Part Numbering System

Series	Rating	Mounting	Terminal Hdwr.	Marking
1 8		-		-
181 - Type I, 30V	025 - 25 amps	F - Surface Mount	00 - Ship w/o nuts	0 - Blank cover
183 - Type I*, 30V	030 - 30 amps	P - Panel Mount	01 - Sems nuts installed	1 - Standard Marking; Part Number,
184 - Type III, 42V	035 - 35 amps		02 - Sems nuts shipped bulk	Amp Rating
185 - Type III-PTT, 42V	040 - 40 amps		03 - Stainless Steel Std. nuts & washers installed	181, 184, 185 Series - Top Surface
	050 - 50 amps		04 - Stainless Steel Std. nuts & washers shipped bulk	183 Series - Side Surface
	060 - 60 amps		07 - Flange gasket & Sems nuts installed (Panel Mount Only)	S - Standard Ignition Protected Marking
	070 - 70 amps		08 - Threaded insert and Sems nuts installed	(Consult factory for special markings.)
	080 - 80 amps		12 - Stainless steel nuts and lockwashers installed	
	090 - 90 amps		13 - Stainless steel Sems nut installed	
*183 Available in Panel Mount Only (Coverless)	100 - 100 amps			
	110 - 110 amps			
	120 - 120 amps			
	135 - 135 amps			
	150 - 150 amps			

Mouser Electronics

Authorized Distributor

Click to View Pricing, Inventory, Delivery & Lifecycle Information:

Eaton:

[184090F-03-1](#) [185135P-01-1](#) [185120F-01-1](#) [184150F-03-1](#) [185060F-04-1](#) [185080F-01-1](#) [181080F-01-1](#) [184100P-07-1](#) [181150F-03-1](#) [185070F-13-1](#) [184100P-01-1](#) [184120P-01-1](#) [185150F-01-S](#) [185050F-01-S](#) [184060F-03-1](#) [185070F-01-1](#) [184090F-01-S](#) [184060F-01-S](#) [184030F-00-1](#) [181060F-01-1](#) [185080F-01-S](#) [184040F-01-S](#) [181050P-01-1](#) [181070P-07-0](#) [181070P-01-1](#) [185120P-01-1](#) [185120P-07-1](#) [184110F-01-S](#) [185100F-01-1](#) [185050F-01-1](#) [187070P-04-1](#) [187100P-04-1](#) [187150P-04-1](#) [181090F-01-1](#) [185100F-01-S](#) [181100F-01-1](#) [185150P-01-S](#) [181120F-01-1](#) [185150F-01-1](#) [184080F-03-1](#) [184150F-00-1](#) [184040P-04-S](#) [184050P-04-S](#) [184030F-01-S](#) [184030F-03-1](#) [184030F-04-S](#) [184070P-04-S](#) [184150F-01-S](#) [184150F-04-S](#) [184150P-00-1](#) [184150P-01-1](#) [184150P-07-1](#) [184070P-04-1](#) [184135F-00-1](#) [184135F-01-S](#) [184135F-03-1](#) [184135F-04-1](#) [184135F-09-1](#) [184135P-01-1](#) [184110P-01-1](#) [184120F-00-0](#) [184120F-00-1](#) [184120F-01-1](#) [184120F-03-1](#) [184120P-02-1](#) [184100F-03-1](#) [184100F-04-0](#) [184100F-04-S](#) [184100P-03-1](#) [184100P-04-S](#) [184110F-01-1](#) [184090F-12-1](#) [184090P-01-1](#) [184100F-00-1](#) [184100F-01-1](#) [184100F-01-S](#) [184100F-02-1](#) [184080P-01-1](#) [184080P-03-1](#) [184080P-04-S](#) [184080P-07-1](#) [184090F-01-0](#) [184090F-01-1](#) [184080F-00-1](#) [184080F-01-1](#) [184080F-01-S](#) [184080F-04-1](#) [184080F-04-S](#) [184080P-01-0](#) [184025F-03-1](#) [184030F-01-1](#) [184070F-03-1](#) [184070F-04-1](#) [184070P-00-1](#) [184070P-01-1](#) [184060P-03-1](#) [184060P-04-S](#) [184060P-07-1](#) [184070F-01-1](#) [184070F-01-S](#)