

QUICK-FIT TERMINALS

Designers' Choice



.250 "STURDI-MOUNT" PC QUICK-FIT HEADERS

- Ideal for rugged multi-insertion applications
- Pre-assembled header reduces PC assembly costs
- Increases PC board retention strength
- Keeps terminals perpendicular
- Maintains position for wave soldering

AVAILABLE WITH TIN PLATED BRASS OR STEEL TABS



SPECIFICATIONS

Material: .032, Brass or Steel, Tin Plated

Insulator: Thermoplastic, UL Rated 94V-0

Voltage Rating: 500VAC Current Rating: 15 Amps

Temperature Rating: -58°F to +292°F (-50°C to +145°C)

.250 HORIZONTAL

BRASS TABS CAT. NO.	STEEL TABS CAT. NO.	NO. TABS	A DIM.
7802	7822	2	.362
7803	7823	3	.562
7804	7824	4	.762
7805	7825	5	.962
7806	7826	6	1.162

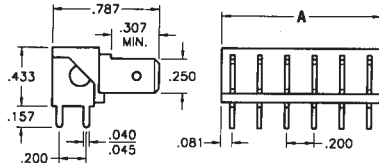

.250 VERTICAL

BRASS TABS CAT. NO.	STEEL TABS CAT. NO.	NO. TABS	A DIM.
7812	7832	2	.362
7813	7833	3	.562
7814	7834	4	.762
7815	7835	5	.962
7816	7836	6	1.162

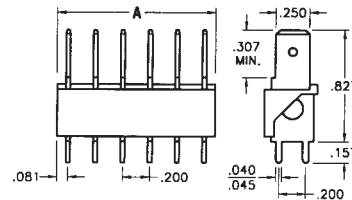

Mtg. Holes: .052 Dia. x .200 Centers

.110 / .187 / .205 QUICK-FIT RIVET TYPES

.110 TABS

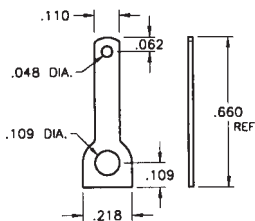

.110 TABS

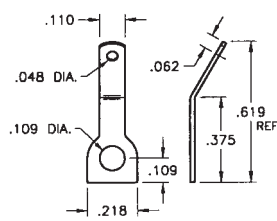

.187 / .205 TABS

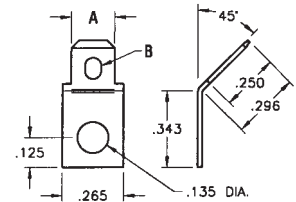

CAT. NO.	MATERIAL	A	B
4005	.020 Brass, Tin Plate	.205	.132 x .070 Slot
4095	.020 Brass, Tin Plate	.187	.078 Dia. Hole

CAT. NO.	MATERIAL
1269	.020 Brass, Tin Plate

CAT. NO.	MATERIAL
1270	.020 Brass, Tin Plate



45° & 90° QUICK-FIT RIVET TYPES



.110 / .187 / .250 TABS

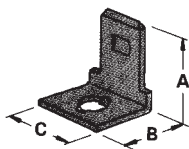

.110 / .187 / .250 TABS

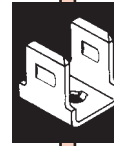
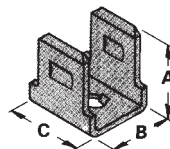

.250 TAB

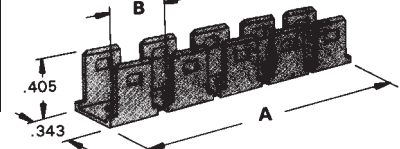

90 Degree MATERIAL: Bright Brass

CAT. NO.	TAB SIZE	MAT'L THICK	A	B	C	HOLE DIA.
2002	.110	.020	.350	.383	.180	.096
1261	.187	.020	.375	.250	.250	.099
1256	.250	.032	.405	.312	.312	.130

90 Degree MATERIAL: Bright Brass

CAT. NO.	TAB SIZE	MAT'L THICK	A	B	C	HOLE DIA.
2003	.110	.020	.350	.383	.180	.096
1262	.187	.020	.312	.250	.250	.099
1257	.250	.032	.405	.343	.312	.130

MULTIPLE 90° MATERIAL: Bright Brass

CAT. NO.	TAB SIZE	MAT'L THICK	A	B	HOLE DIA.	PAIRS
1005	.250	.032	.703	.375	.130	2
1006	.250	.032	1.075	.375	.130	3
1007	.250	.032	1.422	.375	.130	4
1008	.250	.032	1.837	.375	.130	5

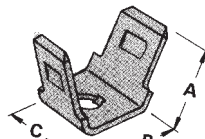
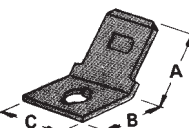

45 Degree MATERIAL: Bright Brass

CAT. NO.	TAB SIZE	MAT'L THICK	A	B	C	HOLE DIA.
2004	.110	.020	.350	.270	.180	.096
1271	.187	.020	.375	.250	.250	.099
1280	.250	.032	.405	.312	.312	.130

45 Degree MATERIAL: Bright Brass

CAT. NO.	TAB SIZE	MAT'L THICK	A	B	C	HOLE DIA.
2005	.110	.020	.350	.383	.180	.096
1263	.187	.020	.312	.375	.265	.135
1258	.250	.032	.405	.343	.312	.130

CUSTOM QUICK-FIT TERMINALS

Keystone is fully integrated to meet your total design & production needs.

Manufacturing custom designs & modifications of standard items is our specialty.

Quotations on special stampings furnished promptly upon receipt of sample, sketch, print or CAD drawings.



Designers' Choice

PC QUICK-FIT TERMINALS

Underwriters Laboratories, Inc.

Recognized Component Program — UL File Number E201546

UL file number **E201546** has been assigned to Keystone Electronics' "Quick-Fit" terminals (see pages 29-31) indicating recognition by Underwriters Laboratories Inc. that they are in compliance with their component program.



Underwriters Laboratories Inc. component program assures that "Quick-Fit" terminals meet the dimensional and performance requirements of the National Electrical Manufacturers Association specification number NEMA2-1982-(1988) and UL310.

.250 TAB			.250 TAB			DUAL .110/.250 TAB		
CAT. NO. 1287	MATERIAL .032 Brass, Tin Plate	MTG. HOLES .052 Dia.	CAT. NO. 1287-ST	MATERIAL .032 Brass, Tin Plate	MTG. HOLES .052 Dia.	CAT. NO. 1282	MATERIAL .032 Brass, Tin Plate	MTG. HOLES .052 Dia.
Sturdi-Mount			Sturdi-Mount			Sturdi-Mount		
.250 TAB			.250 TAB			.250 TAB		
CAT. NO. 4901	MATERIAL .032 Brass, Tin Plate	MTG. HOLES .067 Dia.	CAT. NO. 4902	MATERIAL .032 Brass, Tin Plate	MTG. HOLES .067 Dia.	CAT. NO. 4908	MATERIAL .032 Brass, Tin Plate	MTG. HOLES .052 Dia.
Sturdi-Mount			Sturdi-Mount			Sturdi-Mount		
.250 TAB			.250 TAB			.250 TAB		
CAT. NO. 1289	MATERIAL .032 Brass, Tin Plate	MTG. HOLES .052 Dia.	CAT. NO. 1289-ST	MATERIAL .032 Brass, Tin Plate	MTG. HOLES .052 Dia.	CAT. NO. 1281	MATERIAL .032 Brass, Tin Plate	MTG. HOLES .052 Dia.
Sturdi-Mount			Sturdi-Mount			Sturdi-Mount		

NOTE: .250" TAB HAND INSERTION TOOL; CAT. NO. 1288, SEE PAGE 32

PC QUICK-FIT TERMINALS

Designers' Choice



.110/ .187/ .205/ .250 PC QUICK-FIT MALE TYPES



.205 TAB

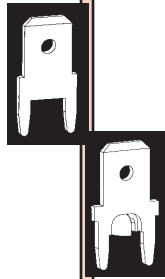
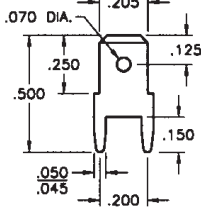

CAT. NO.	MATERIAL	MTG. HOLES
1286	.020 Brass, Tin Plate	.046 Dia.
1213	.032 Brass, Tin Plate	.052 Dia.

.205 TAB

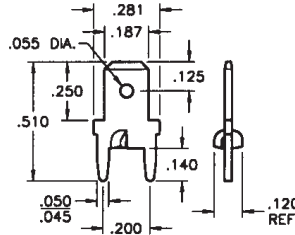

Sturdi-Mount

CAT. NO.	MATERIAL	MTG. HOLES
1286-ST	.020 Brass, Tin Plate	.046 Dia.
1213-ST	.032 Brass, Tin Plate	.052 Dia.

.187 TAB

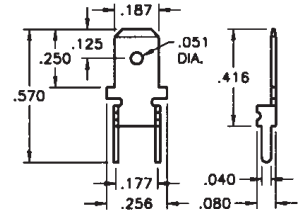

Sturdi-Mount

CAT. NO.	MATERIAL	MTG. HOLES
4900	.020 Brass, Tin Plate	.043 Dia.

.187 TAB

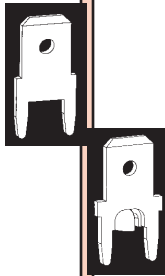
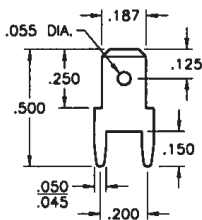

CAT. NO.	MATERIAL	MTG. HOLES
1285	.020 Brass, Tin Plate	.046 Dia.
1212	.032 Brass, Tin Plate	.052 Dia.

.187 TAB

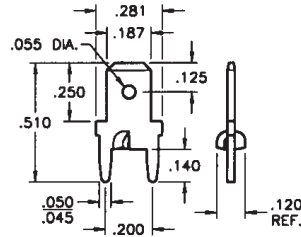

Sturdi-Mount

CAT. NO.	MATERIAL	MTG. HOLES
1285-ST	.020 Brass, Tin Plate	.046 Dia.
1212-ST	.032 Brass, Tin Plate	.052 Dia.

.110 TAB

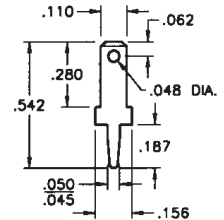

CAT. NO.	MATERIAL	MTG. HOLE
1267	.020 Brass, Tin Plate	.046 Dia.
1211	.032 Brass, Tin Plate	.052 Dia.

.110 TAB

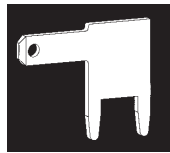
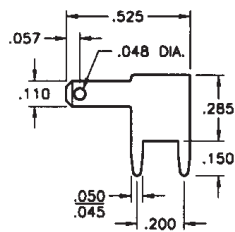

CAT. NO.	MATERIAL	MTG. HOLES
4903	.020 Brass, Tin Plate	.046 Dia.
4906	.032 Brass, Tin Plate	.052 Dia.

.187 TAB

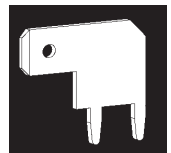
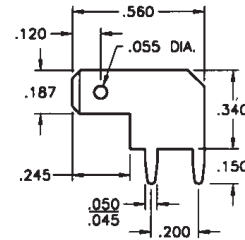

CAT. NO.	MATERIAL	MTG. HOLES
4904	.020 Brass, Tin Plate	.046 Dia.
4907	.032 Brass, Tin Plate	.052 Dia.

.250 TAB

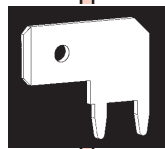
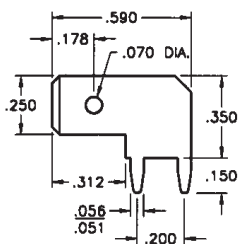

CAT. NO.	MATERIAL	MTG. HOLES
4966	.032 Brass, Tin Plate	.056 Dia.

.250 TAB

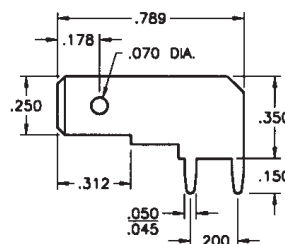

CAT. NO.	MATERIAL	MTG. HOLES
1266	.032 Brass, Tin Plate	.052 Dia.

.250 TAB

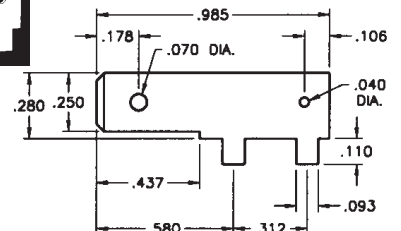

CAT. NO.	MATERIAL	MTG. HOLES
1265	.032 Brass, Tin Plate	.106 Dia.