

MHDPPK Series

Plastic Hood & D-Sub Connector Kit | S&F



Description

- Stamped & Formed D-Sub contacts, selective Gold plated contacts, Tin plated solder buckets
- Black plastic clamshell design
- Quick snap together locking system
- Straight cable entry
- Will accommodate up to 11.5mm diameter cable
- Cable clamp is secured with 2 screws
- 4-40 UNC jackscrews

Specification

D-Sub	
Voltage Rating	250V
Current Rating	5 Amps
Contact Resistance	25mΩ Max
Insulation Resistance	1000MΩ
Operating Temperature	-55°C to 105°C
Shell	Tin plated Steel
Insulator Material	Glass filled Polyester
Contact Material	Copper alloy
Contact Plating	Selective Gold over Nickel, solder bucket: Tin plated



Hood	
No. Contacts	9, 15 & 25
Kit Type	D-Sub connector kit
Housing Material	Polyamide, UL recognised
Cable Entry	Straight
Cable OD	Up to 11.5mm

The Kit Contains		
Backshell Halves		x 2
D-Sub connector		x 1
Strain relief screws		x 2
Housing screws		x 2
4-40 UNC jackscrews		x 2
Metallised plastic compression inserts		x 1

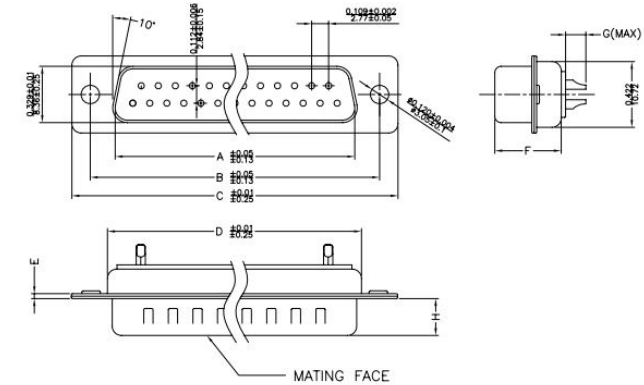
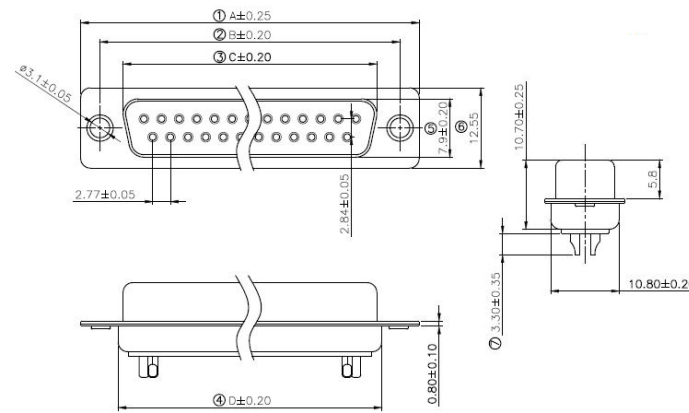
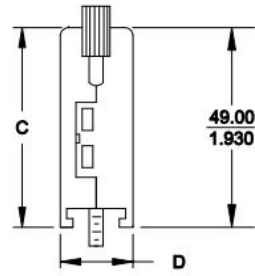
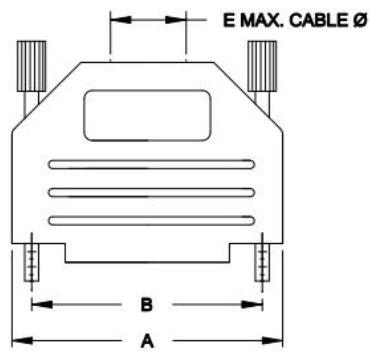

Hood Dimensions					
Size	A	B	C	D	E
09	31.50mm	24.99mm	34.00mm	15.00mm	8.00mm
	1.240"	0.984"	1.339"	0.591"	0.315"
15	40.00mm	33.32mm	34.00mm	15.00mm	11.50mm
	1.575"	1.312"	1.339"	0.591"	0.453"
25	53.50mm	47.04mm	40.00mm	15.00mm	11.50mm
	2.106"	1.852"	1.575"	0.591"	0.453"

Male Dimensions			
	09	15	25
A	16.92mm	25.25mm	38.96mm
B	24.99mm	33.32mm	47.04mm
C	30.81mm	39.14mm	53.04mm
D	19.23mm	27.56mm	41.30mm
E	1.0mm	1.0mm	1.0mm
F	10.8mm	10.8mm	10.8mm
G	2.7mm	2.7mm	2.7mm
H	5.84mm	5.84mm	5.84mm

Female Dimensions			
	09	15	25
A	30.88mm	39.20mm	53.02mm
B	24.88mm	33.30mm	47.04mm
C	19.28mm	27.75mm	41.30mm
D	18.94mm	27.50mm	41.20mm

Part No.	Norcomp Part No.	Positions	Male/Female	Contact Type	Hood Part No.	Norcomp Part No.	D-Sub Part No.	Norcomp Part No.
MHDPPK9-DB9P-K	999-009-C10S102	9 Pin	Male	Stamped & Formed	MHDPPK-09-K	972-009-015R011	MHDB9SP	171-009-102L001
MHDPPK15-DB15P-K	999-015-C10S102	15 Pin	Male	Stamped & Formed	MHDPPK-15-K	972-015-015R011	MHDB15SP	171-015-102L001
MHDPPK25-DB25P-K	999-025-C10S102	25 Pin	Male	Stamped & Formed	MHDPPK-25-K	972-025-015R011	MHDB25SP	171-025-102L001
MHDPPK9-DB9S-K	999-009-C10S202	9 Pin	Female	Stamped & Formed	MHDPPK-09-K	972-009-015R011	MHDB9SS	171-009-202L001
MHDPPK15-DB15S-K	999-015-C10S202	15 Pin	Female	Stamped & Formed	MHDPPK-15-K	972-015-015R011	MHDB15SS	171-015-202L001
MHDPPK25-DB25S-K	999-025-C10S202	25 Pin	Female	Stamped & Formed	MHDPPK-25-K	972-025-015R011	MHDB25SS	171-025-202L001