

DBL Distribution Terminal Blocks

Single pole

- Save installation time with our modular solutions,
- Ease the installation with plate or rail mounting options on our modular blocks.

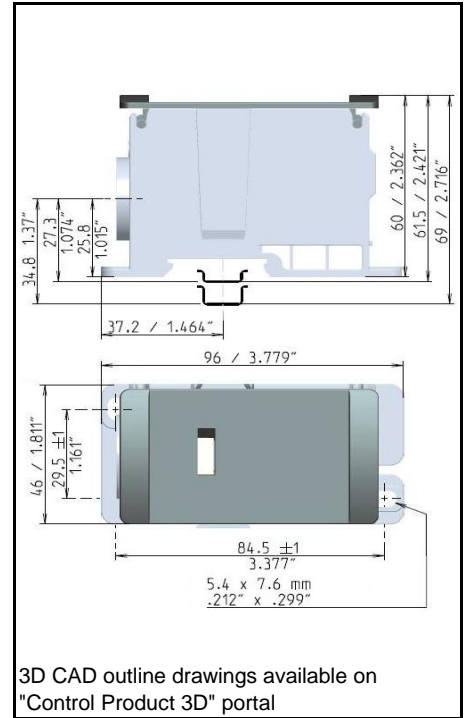

		120 mm ²
		250 kcmil
46 mm	1.81 in	Spacing

Ordering Details

Color	Type	Order Code	EAN Code	Pack ^(ing)	Weight (1 pce) g
Grey	DBL250	1SNC166016B0203	3472599856554	1	425

Declarations and Certificates

		RoHS			EAC			
CE	CB	RoHS	USR					

Declarations and Certificates

	CE	1SND225171C10*
	CB	1SND166005A02*
	RoHS	1SND230557F02*
	USR	1SND166006A02*
	CSA	1SND166007A02*
	EAC	1SND161009A11*

General Information

The following information must be strictly adhered to in order to guarantee the terminal block electrical, mechanical and environmental performance.

Protection	IEC 60947-1	IP10		NEMA 1			
Rail		TH 35-7.5, TH 35-15					

Mounting Instructions

	Circuit 1			Circuit 2			
Operating tool	Allen key			Flat screwdriver			
		6 mm	0.24 in		5.5 mm	0.22 in	
Torque		19 .. 21 N.m	168.. 185 lb.in		3.5 .. 5 N.m	31 .. 44 lb.in	
Wire stripping length		28 mm	1.092 in		11 mm	0.43 in	
	Circuit 3			Circuit 4			
Operating tool	Flat screwdriver			Flat screwdriver			
		4 mm	0.16 in		4 mm	0.16 in	
Torque		2 .. 3 N.m	18 .. 26.5 lb.in		2 .. 3 N.m	18 .. 26.5 lb.in	
Wire stripping length		11 mm	0.43 in		11 mm	0.43 in	

Material Specifications

Insulating material	Polyamide
CTI	600 V
Flammability	UL94 V0
	NF F 16101 I2F2
	Needle flame test :C 60615-11-5 Compliant

Connecting capacity per circuit

		Circuit 1		Circuit 2	
1 Rigid - Solid / Stranded conductor	Norme	IEC60947-7-1	UL1059	IEC60947-7-1	UL1059
	Value	35 .. 120 mm ²	2 ... 250 kcmil	2.5 ... 35 mm ²	14 ... 2 AWG
1 Flexible conductor	Norme	IEC60947-7-1	UL1059	IEC60947-7-1	UL1059
	Value	35 ... 95 mm ²	2 ... 3/0 AWG	2.5 ... 25 mm ²	14 ... 4 AWG
		Circuit 3		Circuit 4	
1 Rigid - Solid / Stranded conductor	Norme	IEC60947-7-1	UL1059	IEC60947-7-1	UL1059
	Value	2.5 .. 16 mm ²	14 .. 6 AWG	2.5 .. 10 mm ²	14 .. 8 AWG
1 Flexible conductor	Norme	IEC60947-7-1	UL1059	IEC60947-7-1	UL1059
	Value	2.5 .. 16 mm ²	14 .. 6 AWG	2.5 .. 10 mm ²	14 .. 8 AWG

Ferrule maximum outer diameter or conductor insulation maximum outer diameter



As part of its on-going product improvement, ABB reserves the right to modify the characteristics or the products described in this document. The information given is not contractual. For further details please contact the ABB company marketing these products in your country.

Multi Connecting capacity per clamp

2 Rigid - Solid / Stranded conductors	Norme			
	Value			
2 Flexible conductors	Norme			
	Value			
2 Flexible conductors with twin ferrule	Norme			
	Value			

Don't mix **solid and flexible** conductors **in the same clamp**

Don't mix **solid or flexible** conductors of different sizes **in the same clamp**

The "Connecting capacity with ferrule" data is guaranteed with ABB crimping tool PS-3 (crimping capacity up to 10 mm²)

Cross section

Rated cross section	IEC60947-7-1	95 mm ²	UL1059	250 AWG
Maximum Cross section	Manufacturer data	120 mm ²	Manufacturer data	250 AWG

Electrical characteristics

Current

Rated current		IEC60947-7-1	250 A
	Field and factory wiring Cat.2	UL 1059	255 A
	Factory wiring Cat.1	UL 1059	
		CSA-C-22.2 n°158	255 A
Maximum Exe current		IEC/EN 60079-7	
Rated short-time withstand current 1 s (I _{cw})		IEC60947-7-1	21000 A
Short-time withstand current	0.5 s	Manufacturer data	
	5 s	Manufacturer data	
	10 s	Manufacturer data	
	30 s	Manufacturer data	
	1 min	Manufacturer data	
Rated short-circuit withstand current		UL 1059	
Max. current (45° temperature increase) / Max. cross section (mm ²)		Manufacturer data	250A 120 mm ²
Maximum short circuit current (1s)		Manufacturer data	21000 A

Short Circuit Current Rating (SCCR) SA UL 1059 supplement

SCCR		UL 1059	100 kA
With the following configurations:			
Suitable conductor wire range			2 ... 250kcmil AWG
Maximum voltage			600 V
Fuse class / Max. amp. Rating		J	600 A
		T	450 A
		RK1	400 A
		RK5	200 A
		G	60 A
		CC	30 A

Voltage

Rated voltage	IEC 60947-1	1500 V DC / 1000 V AC
Rated voltage	UL 1059	1000 V
Use Group	UL 1059	E
Rated voltage	CSA-C-22.2 n°158	1000 V
Rated voltage Ex e	IEC/ EN 60079-7	
Rated impulse withstand voltage	IEC 60947-1	8000 V
Dielectric test voltage	IEC 60947-1	2200 V
Pollution degree	IEC 60947-1	3
Overvoltage category	IEC 60947-1	III

Temperature range

Ambient temperature min/max	Storage	-55 ... +110 °C	-67 ... +230 °F
	Installing	-5 ... +40 °C	+23 ... +104 °F
	Service	-55 ... +110 °C	-67 ... +230 °F

Current Derating curve for continuous service temperature

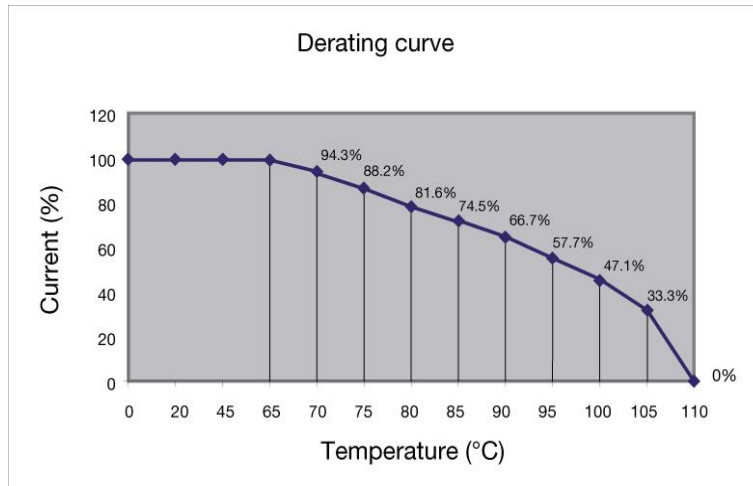

Dissipated power

Maximum dissipated power at rated current	IEC 60947-1	8 W
Maximum dissipated power at maximum Exe current	IEC 60079-7	

Terminal Block Accessories Compatibility

Some accessories may modify the terminal block's rating. See complete information in the accessories catalog page.

Description	Type	Order Code	Pack ^(ing) pieces	Weight g (1 pce)
1 End Stops	BAM2	1SNA206351R1600	50	12
	BADL	1SNA399903R0200	50	4.7
	BADH	1SNA116900R2700	50	20
2 Terminal block markers	MC512PA	1SNK149002R0000	1	10
	MC512	1SNK140000R0000	22	9

As part of its on-going product improvement, ABB reserves the right to modify the characteristics or the products described in this document. The information given is not contractual. For further details please contact the ABB company marketing these products in your country.

Contact us

ABB France
Low Voltage Products Division
Export Department
10, rue Ampère Z.I. - B.P. 114
F-69685 Chassieu cedex / France
Tel. +33 (0)4 7222 1722
Fax +33 (0)4 7222 1935

Note

We reserve the right to make technical changes or modify the contents of this document without prior notice. With regard to purchase orders, the agreed particulars shall prevail. ABB does not accept any responsibility whatsoever for potential errors or possible lack of information in this document.

We reserve all rights in this document and in the subject matter and illustrations contained therein. Any reproduction, disclosure to third parties or utilization of its contents – in whole or in parts – is forbidden without prior written consent of ABB.

Copyright© 2011 ABB
All rights reserved

1SNC160016B0203 - PDF