

CINCH PART NUMBER MATRIX

DRAWING REVISIONS

REV	DOCUMENT	APP	DATE
A	D.O. 05-1217	A.C.	9/9/05
B	ECN: 06A116 MOD. NOTE 4, A8 MOD. HOLE CALLOUT, A5 ADDED TORQUE PATTERN NOTE ADDED TORQUE SPEC. NOTE CHANGED HEAT SINK CONTACT AREA, 3.45 WAS 3.60, .40 WAS .57	A.C.	5/1/06
C	ECN: 08A055 ADDED PART NUMBERS: 581 01 60 037 581 01 60 038 581 01 60 039 ONE HEAT SINK VERSIONS NOW USE SPACER: REVISED TORQUE NOTE	A.C.	2/22/08

P/N: 581 01 60 031

ENCLOSURE WITH TWO HEAT SINKS

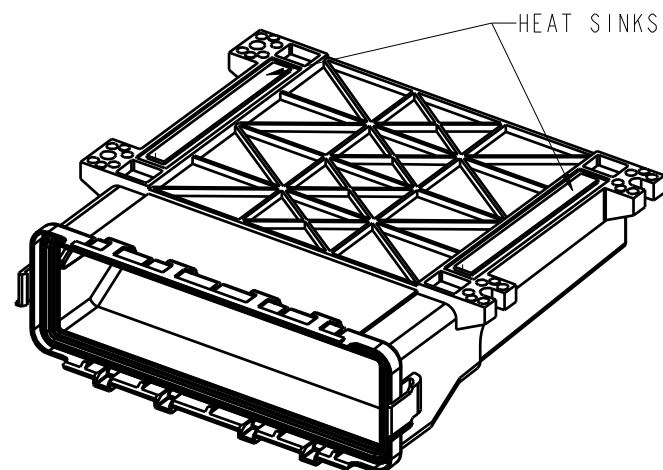

P/N: 581 01 60 032

ENCLOSURE WITH ONE HEAT SINK

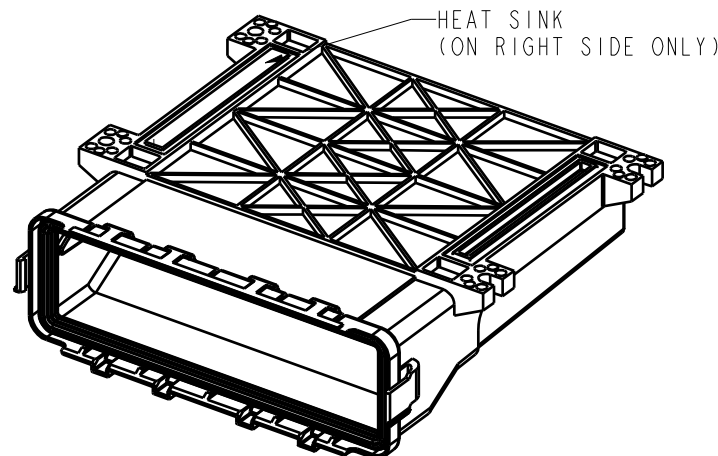

P/N: 581 01 60 033

ENCLOSURE WITHOUT HEAT SINKS

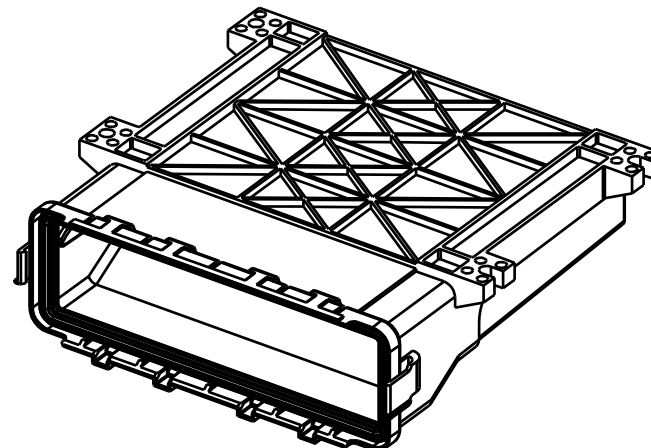

P/N: 581 01 60 037

ENCLOSURE WITH TWO HEAT SINKS & MEMBRANE VENT

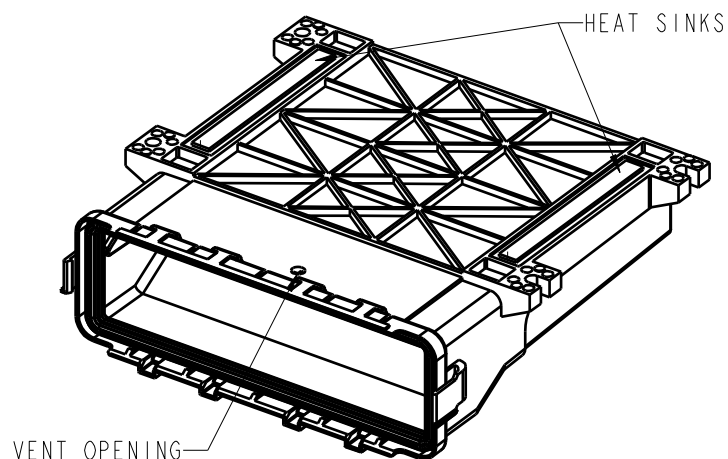

P/N: 581 01 60 038

ENCLOSURE WITH ONE HEAT SINK & MEMBRANE VENT

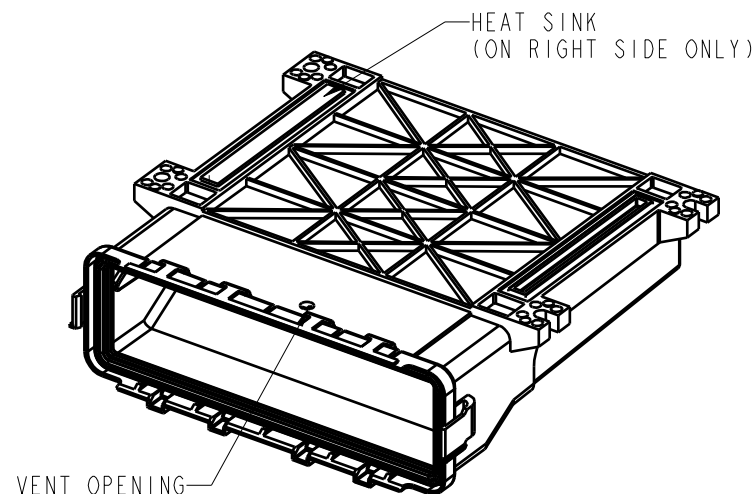

P/N: 581 01 60 039

ENCLOSURE WITHOUT HEAT SINKS & MEMBRANE VENT

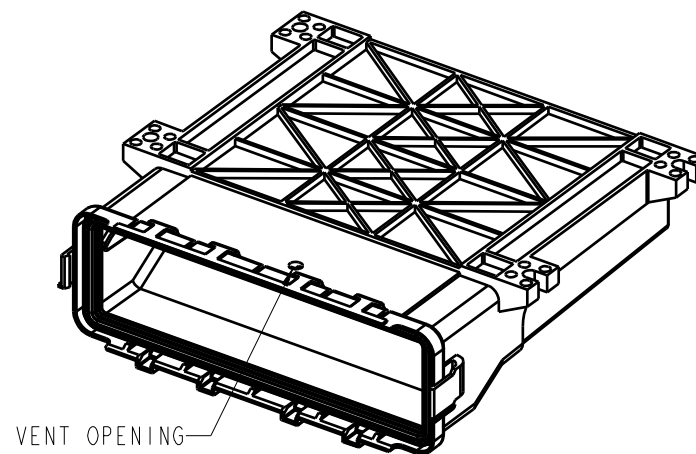

NOTE:

- ALL DIMENSIONS ARE IN INCHES; DIMENSIONS IN [.XX] ARE IN mm AS REF. ONLY.
- MATERIALS:
ENCLOSURE: 30 % GLASS FILLED POLYMER, COLOR BLACK;
PERIPHERAL SEAL: SILICONE RUBBER, COLOR BLUE.
HEAT SINK: ANODIZED ALUMINUM ALLOY.
- HEADERS ARE SOLD SEPARATELY (CONSULT FACTORY FOR P/N);
FOR PCB SIZE AND REQUIREMENTS REFER TO HEADER DRAWINGS.
- STANDARD PACKAGE SIZE: 21 PARTS / CARTON BOX.

RoHS COMPLIANT

MODELED BY:

UNITS	ENGLISH	PRO/E	Cinch		1700 FINLEY RD LOMBARD, IL. 60148
DO NOT SCALE DRAWING	DRAWN BY B. KOSTIC	DATE 11/09/04	ENCLOSURE ASSEMBLY MODICE LE		
UNLESS OTHERWISE SPECIFIED: ALL DIMENSIONS ARE IN INCHES	DESIGN ENGINEER B. KOSTIC	11/09/04	MATERIAL		CONTROL SPEC NUMBER
FILLET/RADII .02 MAX	DESIGN ENGINEERING MGR. A. CAINES	9/9/05	MATERIAL SPEC NUMBER	FINISH	PROJECT NUMBER A 14562
TOLERANCES AND LIMITS APPLY OVER ADDITIVE FINISH	MFG. ENGINEERING R. GARZA	9/15/05	CAD FILE NUMBER 5810160031s_ICE60	DRAWING NUMBER 581 01 60 031S	
THIS DOCUMENT IS THE PROPERTY OF CINCH. NEITHER THIS DOCUMENT NOR ANY OF THE INFORMATION CONTAINED IN IT MAY BE DUPLICATED OR DISCLOSED WITHOUT PRIOR WRITTEN CONSENT OF CINCH.	QUALITY ASSURANCE R. QUIROZ	9/15/05	CAGE IDENT NO. SIZE 71785 B	SCALE 1:3	SHEET 1 OF 2

AREA SPECIFIED FOR LABELS
(APPROX. 4.00" X 3.25" MAX.)

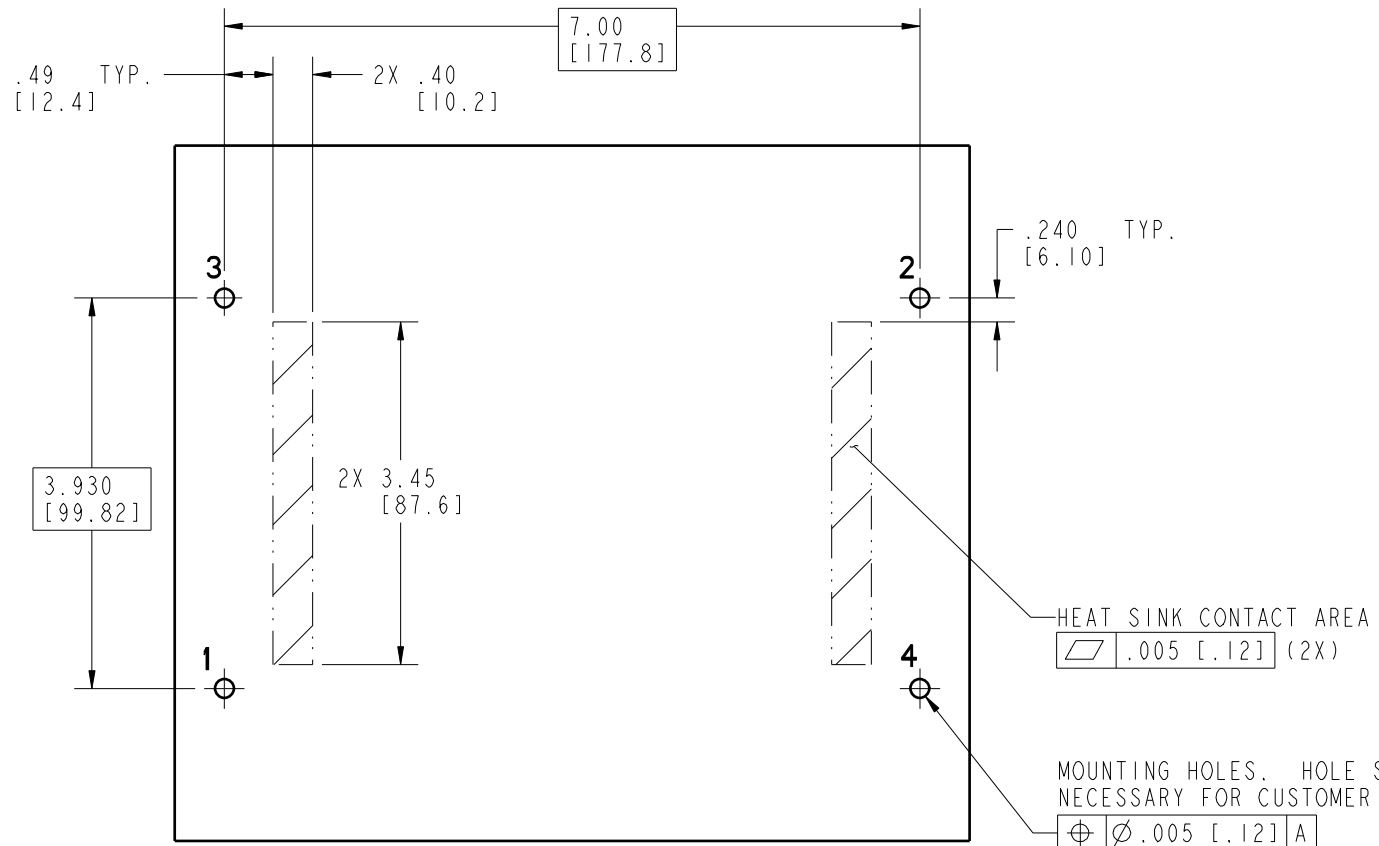
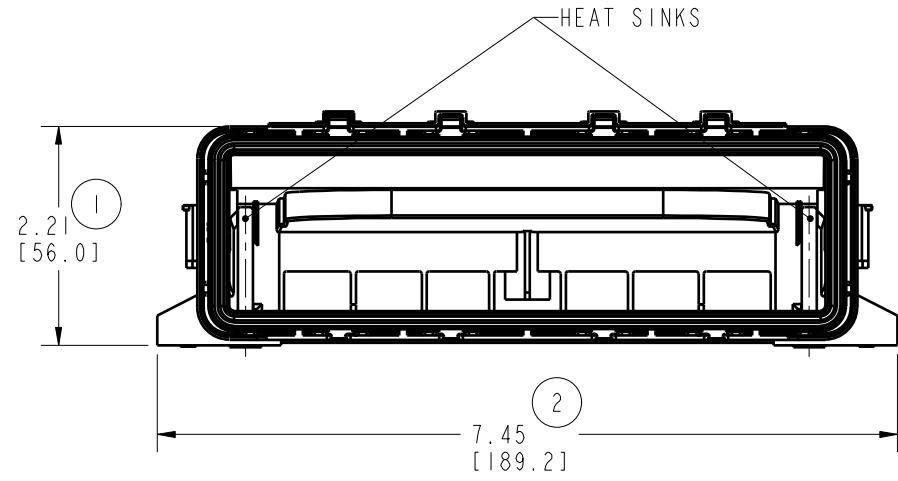
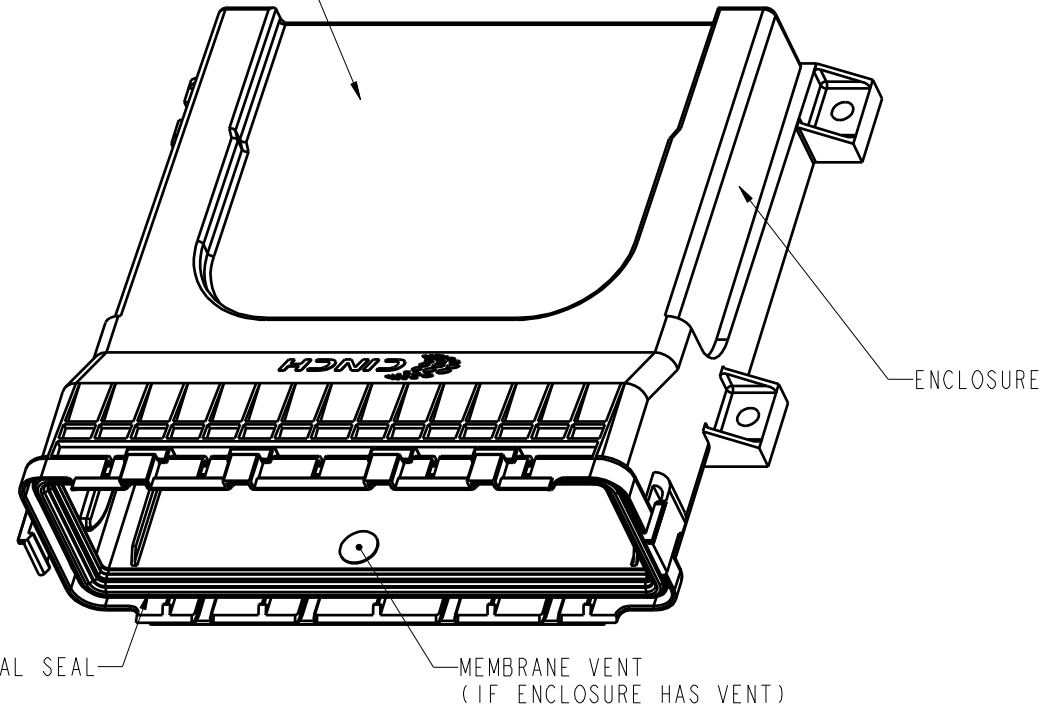

MOUNTING BRACKET LAY-OUT
SCALE 1:2

MOUNTING HOLES. HOLE SIZING AND / OR TAPPING AS NECESSARY FOR CUSTOMER MOUNTING HARDWARE

FASTENERS SHOULD BE TIGHTENED BY HAND AT EACH LOCATION, APPLYING EQUAL PRESSURE AGAINST MOUNTING SURFACE IN ALL LOCATIONS, THEN TORQUE TO 10-12 IN. LB. [1.13-1.36 Nm] FOLLOWING THE PATTERN SHOWN.

TORQUE PATTERN: 1, 2, 3, 4

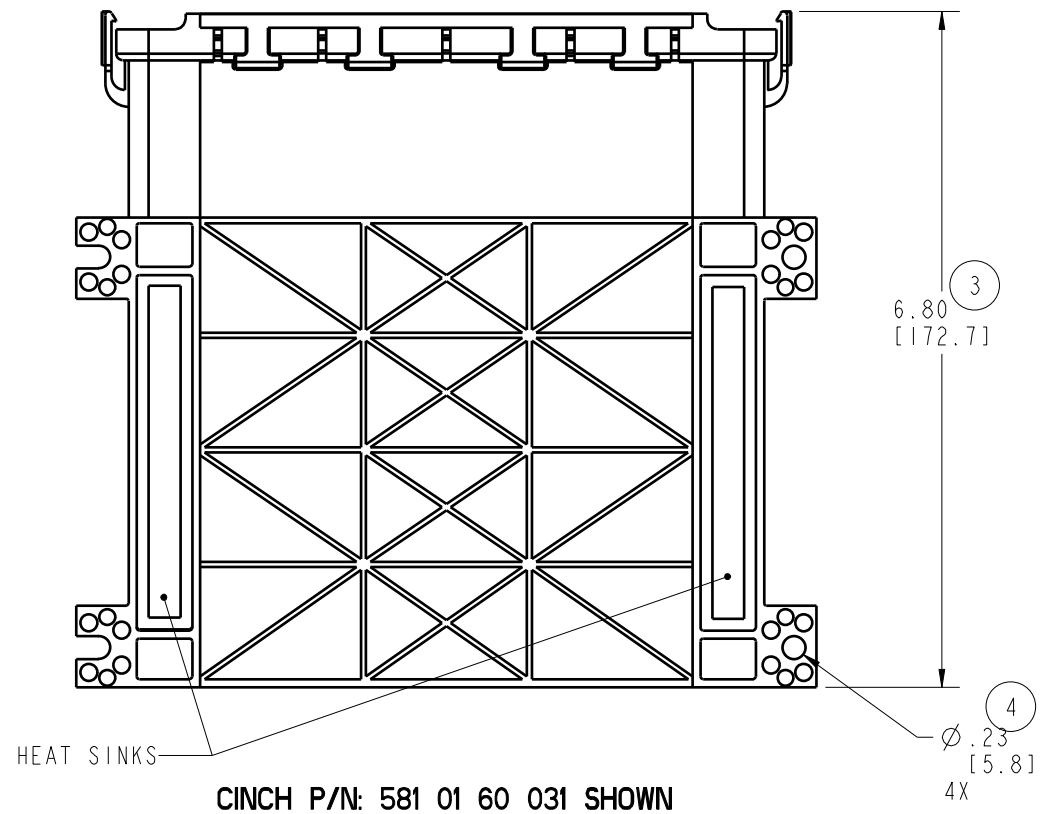

CINCH P/N: 581 01 60 031 SHOWN

UNITS ENGLISH		Cinch		1700 FINLEY RD. LOMBARD, IL. 60148	
DO NOT SCALE DRAWING		TITLE ENCLOSURE ASSEMBLY MODICE LE			
UNLESS OTHERWISE SPECIFIED: ALL DIMENSIONS ARE IN INCHES		PRO/E DRAWING			
FILLET/RADII .02 MAX	TOLERANCES .X ± .1 .XX ± .01 .XXX ± .005 ANGULAR ± .5°	CAD FILE NUMBER 5810160031s_ICE60	DRAWING NUMBER 581 01 60 031S	REV C	
THIS DOCUMENT IS THE PROPERTY OF CINCH. NEITHER THIS DOCUMENT NOR ANY OF THE INFORMATION CONTAINED IN IT MAY BE DUPLICATED OR DISCLOSED WITHOUT PRIOR WRITTEN CONSENT OF CINCH.		CAGE IDENT NO. SIZE 71785 B	SCALE 1:2	SHEET 2 OF 2	