

2191 11

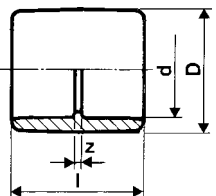
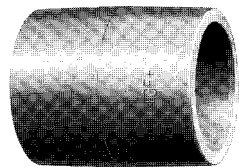

Socket

d	PN	Code	£	SP	GP	g	z	D	l
3/8	15	721.911.105		10		10	3	23	35
1/2	15	721.911.106		10		10	3	27	38
3/4	15	721.911.107		10		16	3	33	45
1	15	721.911.108		10		28	3	41	51
1 1/4	15	721.911.109		5		60	3	51	60
1 1/2	15	721.911.110		5		65	3	58	64
2	15	721.911.111		10		125	5	72	78
2 1/2	15	721.910.112		1		280	4	88	92
3	15	721.911.113		5		340	7	104	108
4	15	721.911.115		2		860	8	134	135
5	15	721.910.116		1		1190	7	164	159
6	15	721.911.117		1		2570	11	197	192
8*	9	721.911.117		1		4140	10	253	248

*Maximum working pressure for size 8 inch: 9 bar (130 lbf/in²) at 20°C.

2191 13

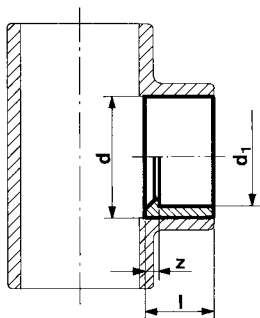
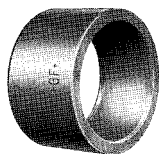

Reducing Bush (short pattern)

d	PN	Code	£	SP	GP	g	z	l
1/2 x 3/8	15	721.901.334		10		4	2	18
3/4 x 3/8	15	721.901.338		10		12	5	21
3/4 x 1/2	15	721.901.337		10		6	3	21
1 x 3/8	15	721.901.343		10		13	8	24
1 x 1/2	15	721.901.342		10		15	6	24
1 x 3/4	15	721.901.341		10		11	3	24
1 1/4 x 3/8	15	721.901.349		10		24	13	29
1 1/4 x 1/2	15	721.901.348		10		24	11	29
1 1/4 x 3/4	15	721.901.347		10		22	8	29
1 1/4 x 1	15	721.901.346		10		18	5	29
1 1/2 x 1/2	15	721.901.355		10		45	13	30
1 1/2 x 3/4	15	721.901.354		10		37	10	30
1 1/2 x 1	15	721.901.353		10		36	6	30
1 1/2 x 1 1/4	15	721.901.352		10		14	2	30
2 x 3/4	15	721.901.361		10		66	16	37
2 x 1	15	721.901.360		10		64	13	37
2 x 1 1/4	15	721.901.359		10		70	8	37
2 x 1 1/2	15	721.901.358		10		52	6	37
2 1/2 x 2	15	721.901.364		5		100	8	45
3 x 2 1/2	15	721.901.370		5		124	6	51
4 x 3	15	721.901.381		1		350	13	64
5 x 4	15	721.901.384		1		734	13	76
6 x 5	15	721.901.388		1		800	15	91
8 x 6*	9	721.901.396		1		1780	33	119

*Maximum working pressure for size 8 inch: 9 bar (130 lbf/in²) at 20°C.

2191 13

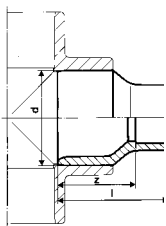
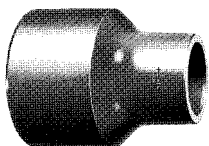

Reducing Bush (long pattern)

d	PN	Code	£	SP	GP	g	z	l
3 x 1	15	721.911.374		5		250	73	97
3 x 1 1/4	15	721.911.363		2		190	73	101
3 x 1 1/2	15	721.911.372		5		190	73	103
3 x 2	15	721.911.372		5		220	73	110
5 x 3	15	721.911.386		1		783	111	162
6 x 4	15	721.911.389		2		1392	133	197