

PART NO.
20021311

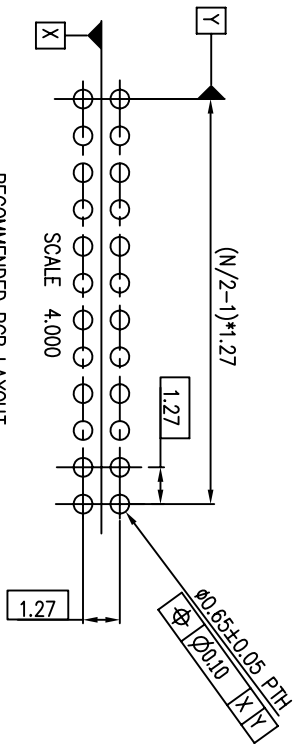

RECOMMENDED PCB LAYOUT
LAYOUT TOLERANCE = ±0.05mm

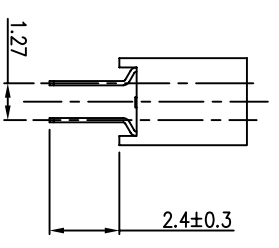
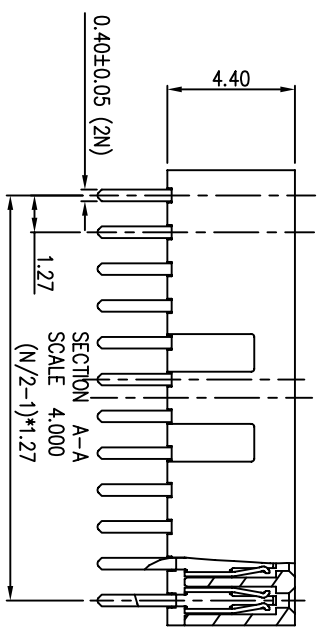
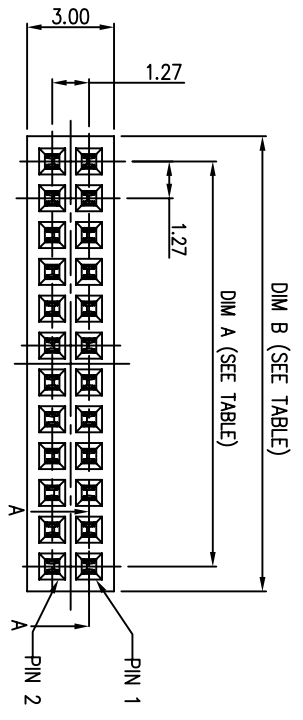
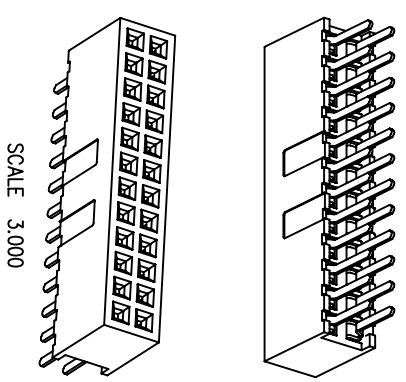

mat'l. code		surface		tolerance		projection		product family	
itr	ecn no	dr	date	ISO 1302	ISO 406	ISO 1104	MINITEK127®	MINITEK127®	
E	EX-4-2358	TM	03/21/16	tolerances unless otherwise specified		0.05:30		RECEPTACLE VT TH	
				angle	linear	0.00±.20	mm	dwg no	
				0±.2°	0.00±.10	scale 1:1		20021311	
				dr	ANDY ZHANG	10/29/12		sheet 1 of 3	
				eng	ANDY ZHANG	10/29/12		size	
				chr	BIAN RICK	10/29/12		A3	
				appd	BIAN RICK	10/29/12		type	
				sheet				Product Customer Drawing	
				index					

TABLE 1

PRODUCT NO.	POSITIONS	DIM. A	DIM. B
20021311-XXX06XXXLF	2 X 3	2.54	4.27
20021311-XXX08XXXLF	2 X 4	3.81	5.54
20021311-XXX10XXXLF	2 X 5	5.08	6.81
20021311-XXX12XXXLF	2 X 6	6.35	8.08
20021311-XXX14XXXLF	2 X 7	7.62	9.35
20021311-XXX16XXXLF	2 X 8	8.89	10.62
20021311-XXX18XXXLF	2 X 9	10.16	11.89
20021311-XXX20XXXLF	2 X 10	11.43	13.16
20021311-XXX22XXXLF	2 X 11	12.7	14.43
20021311-XXX24XXXLF	2 X 12	13.97	15.7
20021311-XXX26XXXLF	2 X 13	15.24	16.97
20021311-XXX28XXXLF	2 X 14	16.51	18.24
20021311-XXX30XXXLF	2 X 15	17.78	19.51
20021311-XXX32XXXLF	2 X 16	19.05	20.78
20021311-XXX34XXXLF	2 X 17	20.32	22.05
20021311-XXX36XXXLF	2 X 18	21.59	23.32
20021311-XXX38XXXLF	2 X 19	22.86	24.59
20021311-XXX40XXXLF	2 X 20	24.13	25.86
20021311-XXX42XXXLF	2 X 21	25.4	27.13
20021311-XXX44XXXLF	2 X 22	26.67	28.4
20021311-XXX46XXXLF	2 X 23	27.94	29.67
20021311-XXX48XXXLF	2 X 24	29.21	30.94
20021311-XXX50XXXLF	2 X 25	30.48	32.21
20021311-XXX52XXXLF	2 X 26	31.75	33.48
20021311-XXX54XXXLF	2 X 27	33.02	34.75
20021311-XXX56XXXLF	2 X 28	34.29	36.02
20021311-XXX58XXXLF	2 X 29	35.56	37.29
20021311-XXX60XXXLF	2 X 30	36.83	38.56
20021311-XXX62XXXLF	2 X 31	38.1	39.83
20021311-XXX64XXXLF	2 X 32	39.37	41.1
20021311-XXX66XXXLF	2 X 33	40.64	42.37
20021311-XXX68XXXLF	2 X 34	41.91	43.64

PRODUCT NO.	POSITIONS	DIM. A	DIM. B
20021311-XXX70XXXLF	2 X 35	43.18	44.91
20021311-XXX72XXXLF	2 X 36	44.45	46.18
20021311-XXX74XXXLF	2 X 37	45.72	47.45
20021311-XXX76XXXLF	2 X 38	46.99	48.72
20021311-XXX78XXXLF	2 X 39	48.26	49.99
20021311-XXX80XXXLF	2 X 40	49.53	51.26
20021311-XXX82XXXLF	2 X 41	50.8	52.53
20021311-XXX84XXXLF	2 X 42	52.07	53.8
20021311-XXX86XXXLF	2 X 43	53.34	55.07
20021311-XXX88XXXLF	2 X 44	54.61	56.34
20021311-XXX90XXXLF	2 X 45	55.88	57.61
20021311-XXX92XXXLF	2 X 46	57.15	58.88
20021311-XXX94XXXLF	2 X 47	58.42	60.15
20021311-XXX96XXXLF	2 X 48	59.69	61.42
20021311-XXX98XXXLF	2 X 49	60.96	62.69
20021311-XXXA0XXXLF	2 X 50	62.23	63.96

mat'l. code	surface tolerance	ISO 1302	ISO 406	ISO 11081	projection	product family	MINITEK127®
itr ecn no dr	date	ISO 1302	ISO 406	ISO 11081	projection	product family	MINITEK127®
E		tolerances unless otherwise specified			11081		
	angle	.05:30			mm		
	linear	.00±.20			mm		
	0±.2°	0.00±.10			scale 1:1		
	dr	ANDY ZHANG 10/29/12				dwg no	sheet 2 of 3
	eng	ANDY ZHANG 10/29/12				20021311	size
	chr	BIAN RICK 10/29/12					A3
	appp	BIAN RICK 10/29/12				type	Product Customer Drawing
sheet	revision						
index	sheet						

NOTES:

1. MATERIAL:
HOUSING: HIGH TEMPERATURE PLASTIC; UL94-V0; BLACK.
TERMINAL: PHOSPHOR BRONZE.
2. FINISH:
TERMINAL: GOLD OR GXT PLATING AT CONTACT AREA (SEE TABLE);
2.54um/100u" MIN MATTE TIN OR GOLD FLASH AT SOLDER TAIL AREA;
1.27um/50u" MIN NI OVER ALL AS UNDERPLATING
3. PRODUCT SPEC PER GS-12-629;
4. PACKAGE SPEC PER GS-14-1420;
5. RECOMMENDED PCB THICKNESS IS 1.6MM.
6. THE HOUSING WILL WITHSTAND EXPOSURE TO 260-C PEAK TEMPERATURE FOR 10 SECONDS IN A CONVECTION INFRA-RED OR VAPOR PHASE REFLOW OVEN.
7. PRODUCT MEETS EUROPEAN UNION DIRECTIVES AND OTHER COUNTRY REGULATIONS AS DESCRIBED IN GS-22-008.
8. PART NUMBER DESCRIPTION:

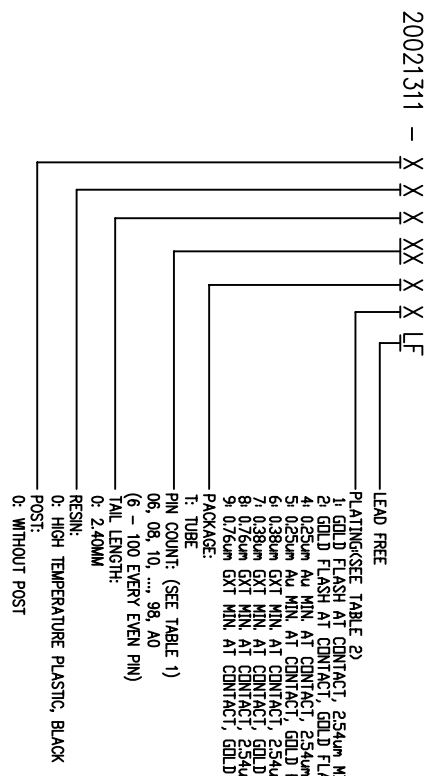

- LEAD FREE
- PLATING(SEE TABLE 2)
- 1: GOLD FLASH AT CONTACT, 254um MIN. MATTE TIN AT TAIL
 - 2: GOLD FLASH AT CONTACT, GOLD FLASH AT TAIL
 - 3: 0.25um Au MIN. AT CONTACT, 254um MIN/MATTE TIN AT TAIL
 - 4: 0.25um Au MIN. AT CONTACT, GOLD FLASH AT TAIL
 - 5: 0.38um GXT MIN. AT CONTACT, 254um MIN/MATTE TIN AT TAIL
 - 6: 0.38um GXT MIN. AT CONTACT, GOLD FLASH AT TAIL
 - 7: 0.38um GXT MIN. AT CONTACT, 254um MIN/MATTE TIN AT TAIL
 - 8: 0.76um GXT MIN. AT CONTACT, 254um MIN/MATTE TIN AT TAIL
 - 9: 0.76um GXT MIN. AT CONTACT, GOLD FLASH AT TAIL
- PACKAGE:
T: TUBE
- PIN COUNT: (SEE TABLE 1)
06, 08, 10, ... 98, AO
(6 - 100 EVERY EVEN PIN)
- TAIL LENGTH:
0: 2.40MM
- RESIN:
0: HIGH TEMPERATURE PLASTIC, BLACK
- POSTI:
0: WITHOUT POST

mat'l. code	surface	tolerance	projection	product family
	ISO 1302	ISO 406 ISO 1108		MINITEK127®
litr ecn no dr	tolerances unless otherwise specified	.05-.30	mm	title RECEPTACLE VT TH
E	angle	.00±.20	mm	dwg no 20021311
	linear	0.00±.10	mm	sheet 3 of 3
	dr	ANDY ZHANG 10/29/12	scale 1:1	size A3
	eng	ANDY ZHANG 10/29/12		type Product Customer Drawing
	chr	BIAN RICK 10/29/12		
	appp	BIAN RICK 10/29/12		
sheet	revision			
index	sheet			